

Longitude 80 20

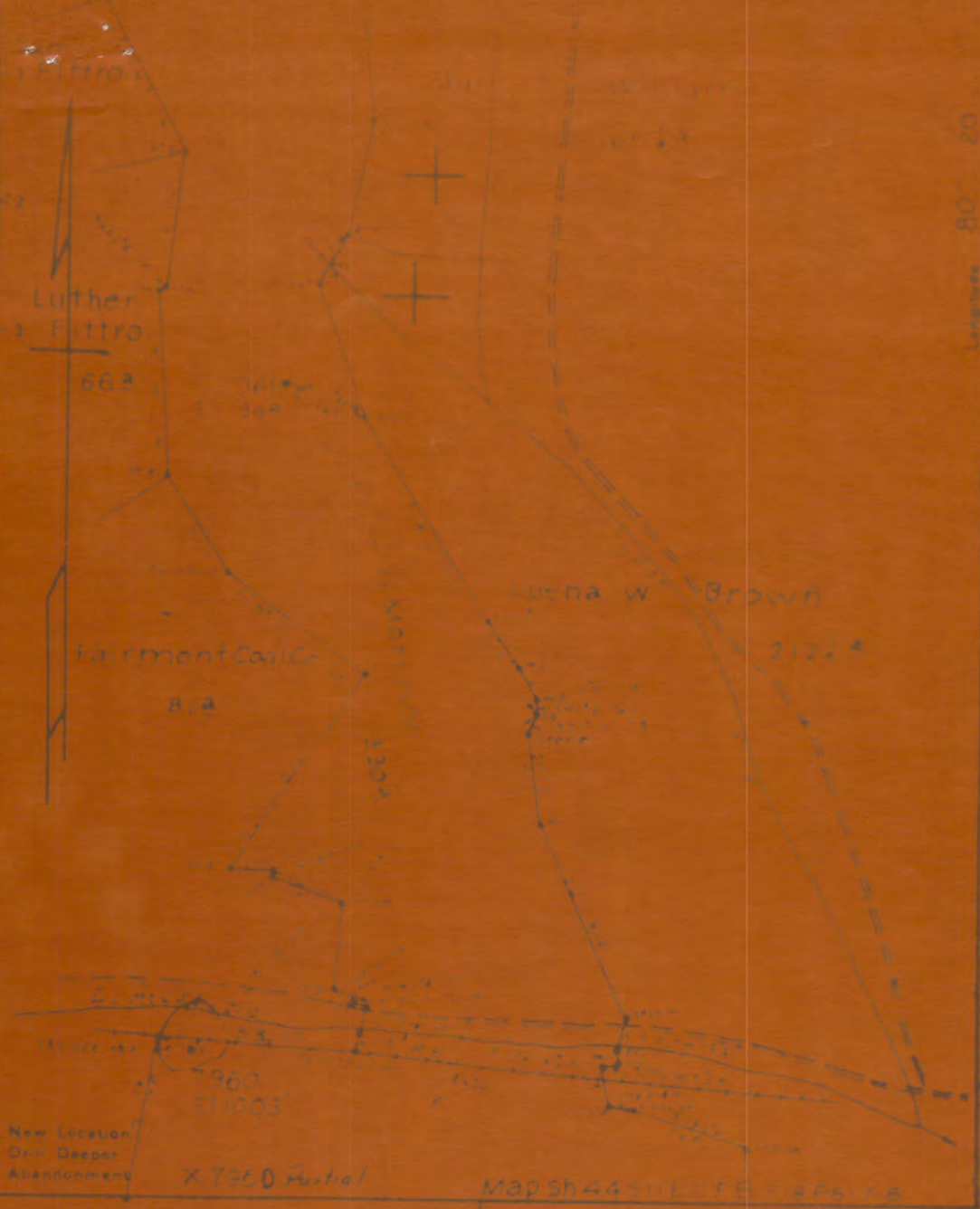

Company Hope Natural Gas Co
 Address Clarksburg, W. Va.
 Name H. Morrison
 Date 1938
 Sheet No. 330
 License No. 52700
 Well No. 10
 State No. 10000
 County Boone

Map Sh 44 511 E F S 1/4 R 6 E 1/4 N 8
 STATE OF WEST VIRGINIA
 DEPARTMENT OF MINES
 OIL AND GAS DIVISION
 CHARLESTON
 WELL LOCATION MAP
 No. 10 Hope 10 10 10

J. H. MERRISON NO. 7960 WELL.

Clark District, Harrison County, W. Va.
 By Hope Natural Gas Co., 445 W. Main St., Clarksburg, W. Va.
 Abandoned under permit Har-.....-A?; Clarksburg Quadrangle.
 On 330 acres.

1648A

Elevation,¹ L.

Drilling commenced Jan. 12, 1910; completed Feb. 18, 1910.

Shot Feb. 18, 1910, Fifth Sand, with 120 qts., three shots.

10" casing, 212'; 8 $\frac{1}{4}$ "¹, 840'; 6 $\frac{5}{8}$ "¹, 1264'; 5 $\frac{3}{16}$ "¹, 2018'; 2" tubing, 2901';
 all left in.

No record of cementing.

No coal was encountered. Starts below coal.

Gas well. Record to Dept. of Mines dated April 6, 1956.

Record to RCT from Mrs. Griffith Oct. 26, 1956. Old File No. 1532.

	Top.	Bottom.
Little Dunkard Sand	330	- 343
Big Dunkard Sand	390	- 440
Gas Sand	490	- 540
First Salt Sand	610	- 650
2nd Salt Sand (water, 730')	m705	- 820
Little Lime	1165	- 1175
Pencil Cave	1175	- 1182
Big Lime	1182	- 1245
Big Injun Sand	1245	- 1329
Squaw Sand	1365	- 1460
Berea Sand	1668	- 1690
Gantz Sand	1708	- 1752
Fifty-foot Sand (gas, 1818')	1764	- 1826
Thirty-foot Sand		None
Gordon Sand	2000	- 2070
Fourth Sand	2095	- 2115
Fifth Sand (gas, 2164')	2161	- 2179
DRILLED DEEPER:		
Fifth Sand	2179	- 2197
Speechley Sand (gas, 2862')	2860	- 2871
Total depth		2891



1597

STATE OF WEST VIRGINIA
DEPARTMENT OF MINES
OIL AND GAS DIVISION

Clarksburg

Quadrangle
Permit No. HAR-1648-A

WELL RECORD

Oil or Gas Well Gas
(KIND)

Company Hope Natural Gas Company
 Address 445 West Main Street
 Farm Clarksburg, W. Va. Acres 330
 Location (waters) J. H. Morrison
 Well No. 7960 Elev. _____
 District Clark County Harrison
 The surface of tract is owned in fee by _____
 Address _____
 Mineral rights are owned by _____
 Address _____
 Drilling commenced 1-12-10
 Drilling completed 2-18-10
 Date Shot 2-18-10 From _____ To 5th sand
 With 120 Qts Three Shots
 Open Flow /10ths Water in _____ Inch
 /10ths Merc. in _____ Inch
 Volume _____ Cu. Ft.
 Rock Pressure _____ lbs. _____ hrs.
 Oil _____ bbls., 1st 24 hrs.
 Fresh water _____ feet _____ feet
 Salt water _____ feet _____ feet

Casing and Tubing	Used in Drilling	Left in Well	Packers
Size			
16			Kind of Packer
13			
10	212	212	Size of
8 1/4	840	840	
6 3/4	1264	1264	Depth set
5 3/16	2018	2018	
3			Perf. top
2	2901	2901	Perf. bottom
Liners Used			Perf. top
			Perf. bottom

CASING CEMENTED _____ SIZE _____ No. Ft. _____ Date
No record of Cementing

COAL WAS ENCOUNTERED AT _____ FEET _____ INCHES
No Coal
_____ FEET _____ INCHES FEET _____ INCHES
_____ FEET _____ INCHES FEET _____ INCHES

Formation	Color	Hard or Soft	Top	Bottom	Oil, Gas or Water	Depth Found	Remarks
Below Coal							
Little Dunkard			330	343			
Big Dunkard			390	440			
Gas Sand			490	540			
First Salt			610	650			
2nd Salt			705	820	Water	730	
Little Lime			1165	1175			
Pencil Cave			1175	1182			
Big Lime			1182	1245			
Big Injun			1245	1329			
Squaw			1365	1460			
Berea			1668	1690			
Gantz			1708	1752			
Fifty Foot			1764	1826	Gas	1818	
Thirty Foot			None				
Gordon			2000	2070			
Fourth			2095	2115			
Fifth			2161	2179	Gas	2164	
<u>Drilled Deeper</u>							
Fifth			2179	2197			
Speeshley			2860	2871	Gas	2862	
TOTAL DEPTH				2891'			

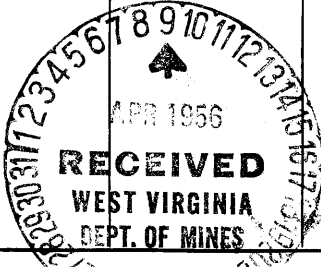

April 6, 1956
Hope Natural Gas Company
B. R. NUZUM
General Superintendent
By Jack Bailey