

LATITUDE 38° 45'

LONGITUDE 81° 45'

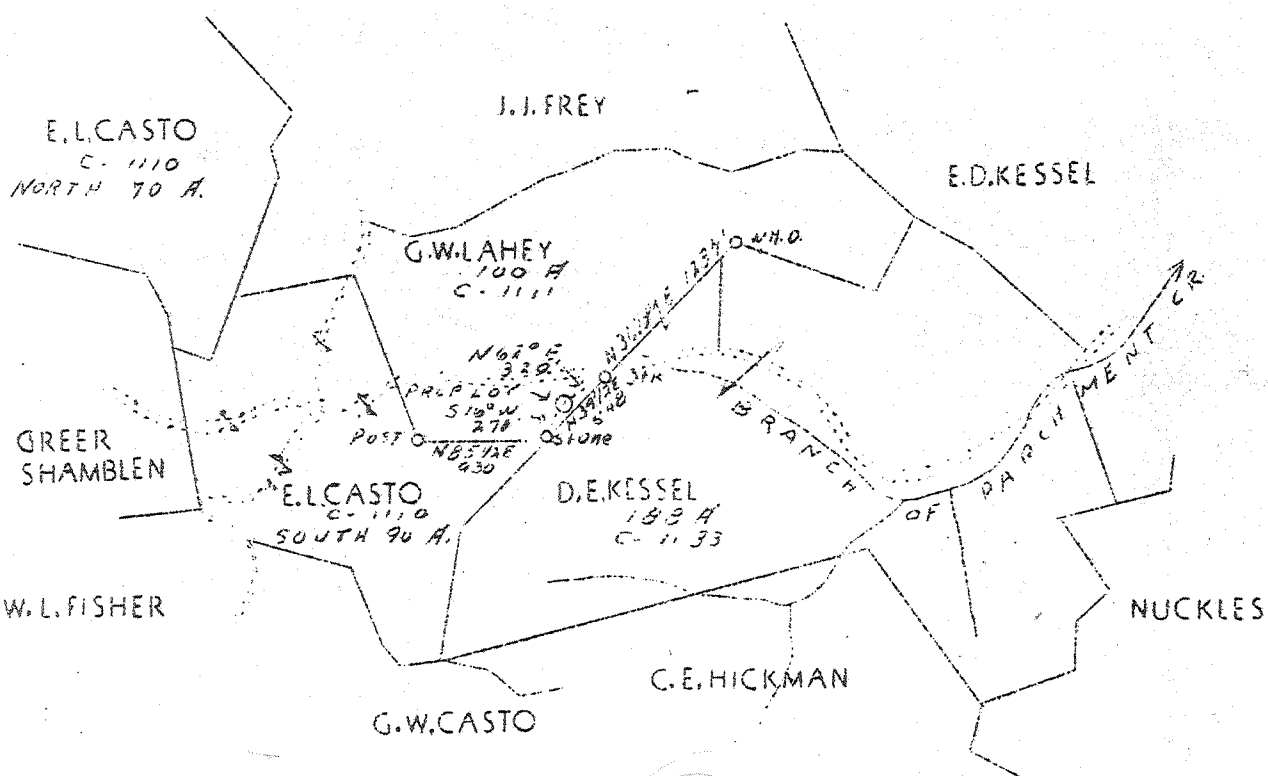

Permit Issued: 1-16-39
 Revising Permit Issued: 4-29-39
 PLUGGED: 5-7-39

ABD
 4/39

1.10-0
 W 1.08
 S 0.92

Vol. XVI, p. 158
 New location

1 NE (I-4)

NOTE - LOCATION 2.0 M. NE. ROCKCASTLE

Company	Columbian Carbon Co.
Address	Box 1240 Charleston, W. Va.
Farm	G.W. Lathey et al
Acres	378
Lease No.	C-1111, C-1133, Part C-1110
Well (Farm) No.	1
El. (Spirit Level)	810
Quadrangle	Winfield N.E.
County	Jackson
District	Ripley
Eng.	James N. Soll
Eng. Reg. No.	772
Date	12/31/38
Scale	1" - 1320

STATE OF WEST VIRGINIA
 Department of Mines
 OIL AND GAS DIVISION
 Charleston

WELL LOCATION MAP

File No. Jac. 42-P

x Denotes location of well on U.S. Topographic Maps, scale 1 to 62,500, latitude and longitude lines being represented by border lines as shown.

- Denotes one inch spaces on border line of original tracing.

5-5-192

Deep Well

WEST VIRGINIA DEPARTMENT OF MINES

OIL & GAS DIVISION

WELL RECORD

Permit No. Jac-42
- Quad.

Dry hole
CASING & LOGGING

Company	Columbia Carbon Co.	21-1/2	40-11
Address	Box 1240, Charleston, W. Va.	10-5/8	100-11
Turn	J. W. Lathrop, et al. ACRES 373.0	16	1120-3
Location	Purchment Pl. of Mill Creek	13-3/8	1027-5
Well No.	1 (21-423) ELW. 810	8-5/8	2543-5
District	Ridley - Jackson County	7	4369-5
Surface & Mineral	J. W. Lathrop, et al, Rock Castle, W. Va.		
Commenced	Jan. 25, 1939		
Completed	April 26, 1939		
Shot	Not shot		
Volume	Dry hole		
Rock Procedure	-		
Fresh Water	119' - 2-14 blrs. per hr.		
	1198 - 12-14" blrs. per hr.		
Salt Water	1360 WFW; 2055; 2093; 2490		

Formation	Top	Base	Formation	Top	Base	Result
Soil	0	12	Salt Sand	1650	1760	W-F 1360
Red Rock	12	43	Slate	1760	1770	
Slate	43	79	Lime	1770	1770	
Red Rock	79	99	Keaton Sand	1779	1817	SLM
White Lime	89	94	Big Lime	1897	1922	
Red Rock	94	109	Slate	1992	1996	
Sand	109	131	Keener	1996	2011	
Red Rock	131	155	Slate	2011	2016	
White Slate	155	165	Big Injun	2016	2143	W 2055
Lime	165	191	Slate&Shells	2143	2198	W 2093
Red Rock	191	238	Lime	2198	2271	
Blue Slate	238	253	Slate&Shells	2271	2463	W 2093
Red Rock	253	258				core show
Slate & Shells	258	291	Brown Shale	2463	2463	
Sand	291	306	Berea	2486	2506	W 2490
Red Rock	306	381	Slate	2506	2511	
Sand	381	399	Berea Grit	2511	2513	
Red Rock	399	435	Lime	2513	2550	
White Slate	435	430	Slate&Shells	2550	3726	
Red Rock	460	482	Shale	3726	3785	
Slate	482	506	Slate&Shells	3785	3859	
Sand	506	531	Brown Shale	3859	4021	
Slate	531	562	Slate&Shells	4021	4106	
Sand	562	602	Brown Shale	4106	4220	Sh. Gas
Slate	602	657				4171
Red Rock	657	722	Slate&Shells	4220	4615	
Slate&Shells	722	735	Brown Shale	4615	4822	SLM
Sand	735	748	Corniferous Lime	4822	4931	SLM
Red Rock	748	794	Criskany	4931	4950	
Sand	794	814	Black Lime	4950	5053	
Slate	814	839	Hotel Death		5053	
Sand	839	845				485
Slate	845	863				
Red Rock	863	898				
Blue Slate	898	940				
Lime	940	983				
Slate	983	1091				
Sand	1091	1190				
Lime	1190	1203				
Shale	1203	1244				
Lime	1244	1265				
Sand	1265	1292				
Slate	1292	1304				
Sand	1304	1340				
Slate	1340	1365				
Sand	1365	1440				
Slate&Shells	1440	1489				
Lime	1489	1536				
Slate&Shells	1536	1650				

CEMENT RECORD: 2/17/39 - Ran 10 sacks
Aquadel 4% mixture between 16" & 18"
strings. Plug to bottom O.K.
Pat Patterson, Cementer, Halliburton
Oil Well Cementing Co.

3/10/39 Ran 21 sacks Aquadel 4% mixture.
10' spacer with wood plug. Aquadel plug
4' off bottom. Pat Patterson, Cementer,
Halliburton Oil Well Cementing Co.

4/14/39 Ran 20 Sacks cement 7" casing.
60' solid cement in hole. Dellar Hollar,
Cementer, Halliburton Oil Well Cementing
Company.

4822 4931
810 810

4017 4121

Sample studies