

22.81-W  
2.86 W  
1.03-S

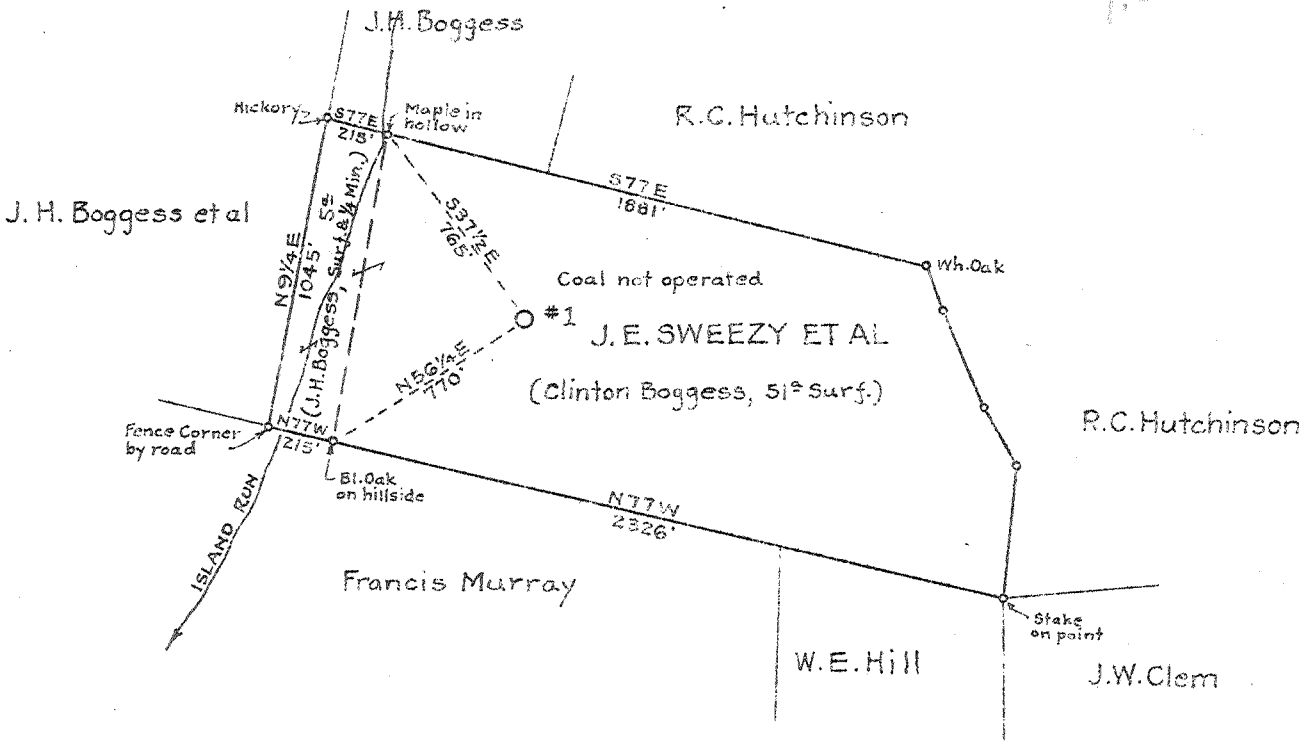

ABD  
5/50

New Location    
 Drill Deeper    
 Abandonment

Company	MULLINS GAS CO. 3/4 INTEREST HAYS OIL & GAS CO. 1/4 "
Address	CHARLESTON, W.VA.
Farm	J. E. SWEEZY ETAL
Tract	Acres 56 Lease No.
Well (Farm) No.	1 Serial No.
Elevation (Spirit Level)	726.8
Quadrangle	RIPLEY C
County	JACKSON District RAVENSWOOD
Engineer	<i>G. W. Cunningham</i>
Engineer's Registration No.	659
File No.	60-97 Drawing No.
Date	JUNE 5, 1941 Scale 1" = 660'

STATE OF WEST VIRGINIA  
 DEPARTMENT OF MINES  
 OIL AND GAS DIVISION  
 CHARLESTON

WELL LOCATION MAP  
 FILE NO. JAC-162

+ Denotes location of well on United States Topographic Maps, scale 1 to 62,500, latitude and longitude lines being represented by border lines as shown.  
 - Denotes one inch spaces on border line of original tracing.

WEST VIRGINIA DEPARTMENT OF MINES  
OIL & GAS DIVISION  
W E L L R E C O R D

Permit No Jac-162

Company	Mullins Gas Co & Hays Oil & Gas Co.
Address	Box 28, Charleston, W.Va.
Farm	J.E. Sweezy Acres 56
Location	Sandy Creek
Well No	1 Elev. 726.8 DF
District	Ravenswood Jackson County
Surface	Clinton R. Boggess, Sandyville, W.Va.
Mineral	J.E. Sweezy et al, Sandyville
Commenced	June 30, 1941
Completed	Sept. 23, 1941
Flow	44/10ths M in 7"
Volume	10,560,000 C.F.
Rock Pressure	1900 lbs 48 hrs.

Gas Well

Casing & Tubing		
18	24"10"	24"10"
16	259'	Pulled
13	625'	"
10	1096'	"
8 5/8	2058'	2058'
7"	4900'5"	4900'5"
2 3/8	5005'	5005'

(Hung 5 ft. from bottom; perforated 6 ft. with 42 1/2" holes.

No packers used in well.

Casing cemented: 7"-4900'--25 sacks cement

Surface	0	24"10"
Sand	25	125
Red Rock	125	135
Sand	135	170 Water 165
Red Rock	170	180
Sand	180	280
Slate	280	290
Sand	290	330
Red Rock	330	350
Sand	350	365
Slate & Lime	365	395
Red Rock	395	405
Sand	405	495
Red Rock	495	505
Lime	505	548
Pitts. Sand	548	610
Shale	610	625
Shells	625	635
Sand	635	665
Red Rock	665	740
L. Dunkard	740	755
Red Rock	755	1005
Shells	1005	1076
Red Rock	1076	1082
B. Dunkard	1082	1151 Water 1133'
Slate	1151	1278
Salt Sand	1278	1415
Slate	1415	1535
Slate	1535	1678
Maxon Sand	1678	1825 - Salt Sand
Big Lime	1825	1928
Wh. Sand	1928	1943
Injun Sand	1943	1963
Wh. Slate	1963	1975
Injun Sand	1975	2004
Bk. Slate	2004	2005
Bk. Lime	2005	2105
Bk. Slate	2105	2390
Borea Grit	2390	2405
Wh. Lime	2405	2420
Slate Shells	2420	3660
Brown Shale	3660	3720
Wh. Slate	3720	3955
Br. Shale	3955	4239
Wh. Slate	4239	4665
Br. Shale	4665	4838
Bk. Shale	4838	4891 - MARCELLUS
Corniferous	4891	5007 Cased at 4906'
Oriskany Sand	5007	
TOTAL DEPTH		5010

475