

New Location
 Drill Deeper
 Abandonment issued 6-4-70

CABOT CORP
 Company GOFFREY L. CABOT INC
 Address Box 1473 924th Street CHARLESTON WVA
 Farm THE PUTNAM Co
 Tract _____ Acres _____ Lease No. 3-464
 Well (Farm) No. 29 Serial No. 1011
 Elevation (Spirit Level) 864.30
 Quadrangle KENNA C
 County JACKSON District RIPLEY
 Engineer R. Ritz Randolph
 Engineer's Registration No. 805
 File No. _____ Drawing No. _____
 Date Sept 29, 1941 Scale 1" = 1320

STATE OF WEST VIRGINIA
 DEPARTMENT OF MINES
 OIL AND GAS DIVISION
 CHARLESTON

WELL LOCATION MAP
 FILE NO. JAC-219-P

+ Denotes location of well on United States Topographic Maps, scale 1 to 62,500, latitude and longitude lines being represented by border lines as shown.
 - Denotes one inch spaces on border line of original tracing.

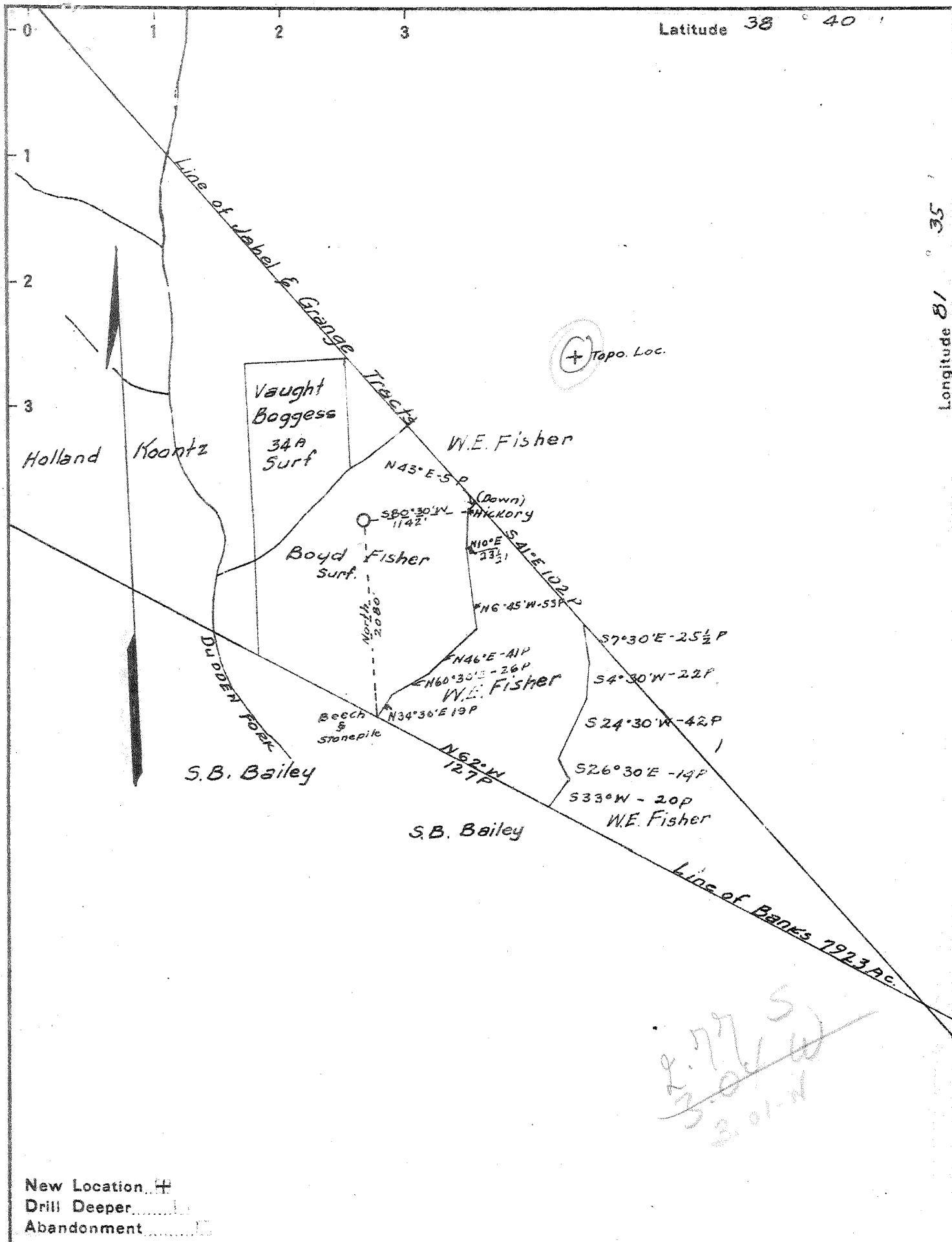

Company GODFREY L. CABOT INC.

Address 900 UNION BLDG CHARLESTON WVA,

Farm THE PUTNAM Co.
pt of 22000 Ac

Tract _____ Acres _____ Lease No. 3-464

Well (Farm) No. 29 Serial No. 1011

Elevation (Spirit Level) 864.30

Quadrangle KENNA

County JACKSON District RIPLEY

Engineer R. H. Randolph

Engineer's Registration No. 805

File No. _____ Drawing No. _____

Date Sept 29, 1941 Scale 1" = 1320

STATE OF WEST VIRGINIA
DEPARTMENT OF MINES
OIL AND GAS DIVISION
CHARLESTON

WELL LOCATION MAP

FILE NO. JAC-219

+ Denotes location of well on United States Topographic Maps, scale 1 to 62,500. Latitude and longitude lines being represented by border lines as shown.

- Denotes one inch spaces on border line of original tracing.

WEST VIRGINIA DEPARTMENT OF MINES
OIL & GAS DIVISION
W E L L R E C O R D

Permit No. JAC-219

Company Godfrey L. Cabot,
Address Charleston, W. Va.
Farm The Putnam Company
Well No. 29 Serial No. 1011 Elev. 864.3
District Ripley Jackson County
Commenced 10-20-41
Completed 2-6-42
Shot 1-6-42 from 5147 to 5157 with 20 Qts.
from 5163 to 5173 with 20 Qts.
Volume B.S. 561 MCF; 20 Min. A.S. 11,052 MCF
Rock Pressure 1590 lbs. in 20 hrs. Orisk. Sand
Fresh water 900'
Salt Water 1140'; 1575' HF

Gass Well
Casing Record
10 3/4 894 894
8 5/8 2067 -
7" 5060 5060
2 3/8" 5193 5193 Bot./
joint welded.
10 3/4" Casing shoe
8 5/8" Spang B.H.Packer,
28 sacks aquagol.
7" Spec. Orisk. B.H.Packer;
40 sacks aquagol; 4 sacks
fibortox
Tubar & Shut in 2-13-42
Perf. Top 5187 Bot. 5193

Red Rock	0	25	Br. Shale	3700	3786
Sand	25	75	Sl. & Sh.	3786	3946
Blue Slate	75	95	Br. Shale	3946	4043
Red Rock	95	170	Sl. & Sh.	4043	4070
Sl. & Sh.	170	190	Br. Shale	4070	4145
Red Rock	190	237	Wh. Slate	4145	4165
Slate	237	257	Br. Shale	4165	4230
Red Rock	257	300	Lime	4230	4255
Slate	300	318	Br. Shale	4255	4320
Red Rock	318	382	Slate, Wh.	4320	4450
Slate, Wh.	382	390	Br. Shale	4450	4470
Red Rock	390	400	Wh. Slate	4470	4505
Wh. Slate	400	410	Lime	4505	4520
Red Rock	410	422	Slate	4520	4775
Wh. Slate	422	515	Br. Shale	4775	4945
Sand	515	537	Dark Shale	4945	5039 - MARCELLUS?
Slate	537	555	Lime - 463	5039	5139 5060 S.L.
Red Rock	555	580	Orisk. Sand	5139	5201 5148 S.L. Gas 5147
Lime	580	600	Lime - 45	5201	5207 S.L. Oil 5189-92 35/ gals. in 2 hrs.
Red Rock	600	610			
Sand	610	620	Total Depth		5207 S.L.
Red Rock	620	660			
Wh. Sl. & Sh.	660	716	GAUGES IN ORISKANY SAND - BEFORE SHOT		
Red Rock	716	727	1-25-42	5147-48	231 M
Sl. & Sh.	727	780	Shut in testing casing		
Sand	780	795	1-29-42	5149	484 M
Lime	795	810		5152	1443 M
Red Rock	810	831		5154	722 M
Sl. & Sh.	831	860	1-30-42	5160	615 M
Pink Rock	860	875	1-31-42	5166	537 M
Wh. Slate	875	895		5166	553 M
Lime	895	916		5169	1107 M
Slate	916	955		5177	858 M
Sand	955	979	2-1-42	5184	710 M
Sl. & Sh.	979	1019	2-3-42	5189	684 M
Sand	1019	1051	2-4-42	5195	615 M
Black Slate	1051	1088	2-4-42	5195	684 M
Wh. Sl. & Sh.	1088	1108	2-5-42	5200	671 M
Bk. Slate	1108	1130		5206	671 M
Sand - Salt Sand	1130	1260			
Sl. & Sh.	1260	1400	GAUGES IN ORISKANY - AFTER SHOT		
Sand	1400	1425	Gauge Before Shot		561 M
Sl. & Sh.	1425	1500	5 Mins. A.S.		13,102 M
Sand - Salt Sand	1500	1926	10 " "		11,900 M
Big Lime	1926	1985	15 " "		11,672 M
Injun Sand	1985	2013	20 " "		11,052 M
Slate	2013	2017			
Sand	2017	2044			
Slate	2044	2048			
Sand	2048	2063			
Lime	2063	2070	2067 S.L.		
Sl. & Sh.	2070	2165			
Lime	2165	2210			
Sl. & Sh.	2210	2455			
Br. Shale	2455	2465	Gas 2467		
Berea Gritt	2465	2476			
Sl. & Sh.	2476	3700			