

New Location  *REDRILLED 1966*  
 Drill Deeper   
 Abandonment  *issued 2/16/74*

*Pat. 2,175,000*  
 Company WEST VIRGINIA GAS CORPORATION  
 Address P.O. Box 1433 CHARLESTON 25, W.VA. 26101  
 Farm GEORGE W. CURRY JR. ET AL  
 Tract \_\_\_\_\_ Acres 90 Lease No. 1190  
 Well (Farm) No. ONE Serial No. 537  
 Elevation (Spirit Level) 697.47 (GROUND)  
 Quadrangle RIPLEY SW. 4 S36.1 W0.62 WC  
 County JACKSON District RAVENSWOOD  
 Engineer W.S. GRAVELY  
 Engineer's Registration No. \_\_\_\_\_  
 File No. \_\_\_\_\_ Drawing No. \_\_\_\_\_  
 Date JAN. 17, 1946. Scale 1" = 660'

STATE OF WEST VIRGINIA  
 DEPARTMENT OF MINES  
 OIL AND GAS DIVISION  
 CHARLESTON

**WELL LOCATION MAP**  
 FILE NO. JAC-510-P

+ Denotes location of well on United States Topographic Maps, scale 1 to 62,500, latitude and longitude lines being represented by border lines as shown.

- Denotes one inch spaces on border line of original tracing.

*47-035 AUG 26 1974*

*Deep well*

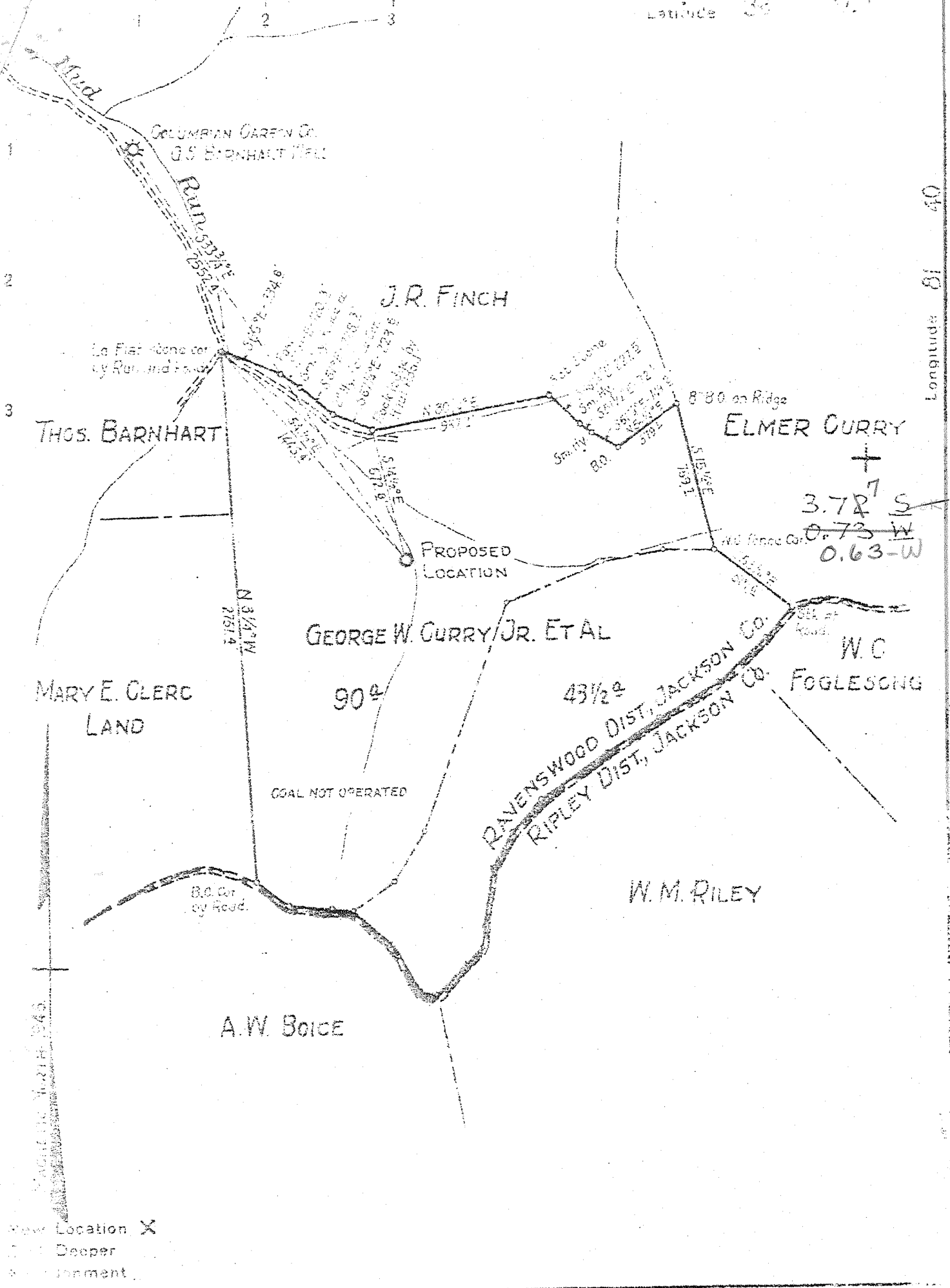

New Location X  
 20' Deeper  
 5' Settlement

Company WEST VIRGINIA GAS CORPORATION  
 Address P.O. Box 1433 CHARLESTON 25, W.VA.  
GEORGE W. CURRY JR. ETAL  
 Acres 90 Lease No. 1190  
 Farm No. ONE Serial No. 537  
 Spurt Level 697.47 (GROUND)  
 Locality RIPLEY SW. 4 S361 W0.42 - WE  
 County JACKSON District RAVENSWOOD  
 Inspector W.S. GRAVELY  
 Drilling No. \_\_\_\_\_  
 Driving No. \_\_\_\_\_  
 Date JAN. 17, 1948 Scale 1" = 660'

STATE OF WEST VIRGINIA  
 DEPARTMENT OF MINES  
 OIL AND GAS DIVISION  
 CHARLESTON

WELL LOCATION MAP  
 FILE NO GAC-510

+ Denotes location of well on United States  
 Topographic Maps, scale 1" to 62,500'  
 and the following lines being more or less  
 as shown.

- Denotes the high surface of the  
 ground.

1-0-192 DEEP WELLS

WEST VIRGINIA DEPARTMENT OF MINES  
OIL & GAS DIVISION  
W E L L R E C O R D

*See 200*

Permit No. Jac 510  
Ripley S.W. Quad.  
Company  
Address  
Farm  
Location  
Well No.  
District  
Surface  
Mineral  
Commenced  
Completed  
Date shot  
Volume  
Fresh Water

Dry Hole  
CASING & TUBING

West Virginia Gas Corporation  
P.O. Box 1433, Charleston, 25, W.Va. 16 27'6 27'6  
George W. Curry, Jr. et al Acres 97 13 3/8 590'9 -  
Mud Run 12 1044'2 -  
One ( Serial 537 ) Elev. 697.47 8 5/8 2051 2051\*  
Ravenswood Jackson County 7 4866 4866\*  
George W. Curry, Jr., 501 LaFayette Ave.  
Same \*Csg. point 2038'  
March 16, 1946 \*Csg. point 4832'  
July 6, 1946  
7-10-46 Depth 4940 to 4930 14 bags ag'el behind  
with 30 qts. 13", 12 bags ag'el.  
119 M Natural behind 10", 16 bags ag'el  
300' 4 blr. per hr.; 1342' H.F. behind 8", 12/bags behind  
7" cement

Red Rock	0	65	Sand-Keener	1940	1951
Slate	65	92	Slate	1951	1953
Red Rock	92	107	Sand-Injun	1953	2010
Lime Shell	107	117	Slate	2010	2015
Red Rock	117	160	Sand-Squaw	2015	2027
Slate & Shells	160	200	Lime	2027	2040
Fire Clay	200	210	Slate & Shells	2040	2385
Red Rock	210	260	Berea Sand	2385	2415
Slate	260	269	Slate & Shells	2415	3630
Sand	269	339	Brown Shale-441	3630	3740
Red Rock	339	352	White Slate	3740	3875
White Slate	352	365	Brown Shale	3875	4132
Red Rock	365	387	White Slate	4132	4150
Sand	387	403	Brown Shale	4150	4173
Red Rock	403	430	White Slate	4173	4570
Slate & Lime	430	469	Brown Shale	4570	4818
Red Rock	469	516	Corniferous Lime-483	4818	4931
Sand - 1st P.H.	516	603	Criskany	4931	4990
Slate	603	765	Lime-Head	4990	
Red Rock	765	773	Total Depth	485	5005
Slate	773	790			
Red Rock	790	835	Gas 1940-1945		
Sand	835	855	Gas 2390 smell		
Slate	855	920	Gas 4570-4818 Smell		
Red Rock	920	950	Gas 4931-4937 30/10 W 2" 231 M		
Slate	950	957	Gas 4937-4942 11/10 W 2" 140 M		
Red Rock	957	990	Now 8/10 W 2" 119 M		
Slate	990	1043	48 hr. R.P. 1200#		
Lime Shells	1043	1053			
Red Rock	1053	1063	Gauge B.S. 119 M		
Slate & Shells	1063	1103	Shot 7-10-46 30 qts.		
Red Rock	1103	1118	from 4930 to 4940		
Sand	1118	1140			
Slate	1140	1215	5 Min A.S. 100/10 W 2"		
Sand	1215	1245	25 Min A.S. 65/10 W 2"		
Slate	1245	1255	4 hrs. A.S. 30/10 W 2" ~ 231		
Sand	1255	1282			
Slate & Shells	1282	1332	To plug and abandon.		
Salt Sand	1332	1350			
Black Slate	1350	1366			
Lime	1366	1396			
Slate	1396	1405			
Sand - Salt Sand?	1405	1425			
Slate	1425	1480			
Sand - Salt Sand?	1480	1532			
Slate	1532	1655			
Sand - Salt Sand?	1655	1741			
Slate	1741	1745			
Sand	1745	1757			
Slate	1757	1762			
Sand	1762	1767			
Slate	1767	1776			
Sand - Biglime - 340	1776	1940			

4818 4931 4990  
697 697 697  
-----  
4121 4234 4293

\* REDRILLED AND LOGGED THROUGH BEREA

2-17-66

LOGGER TO 2455'