

9-19-66 = w3

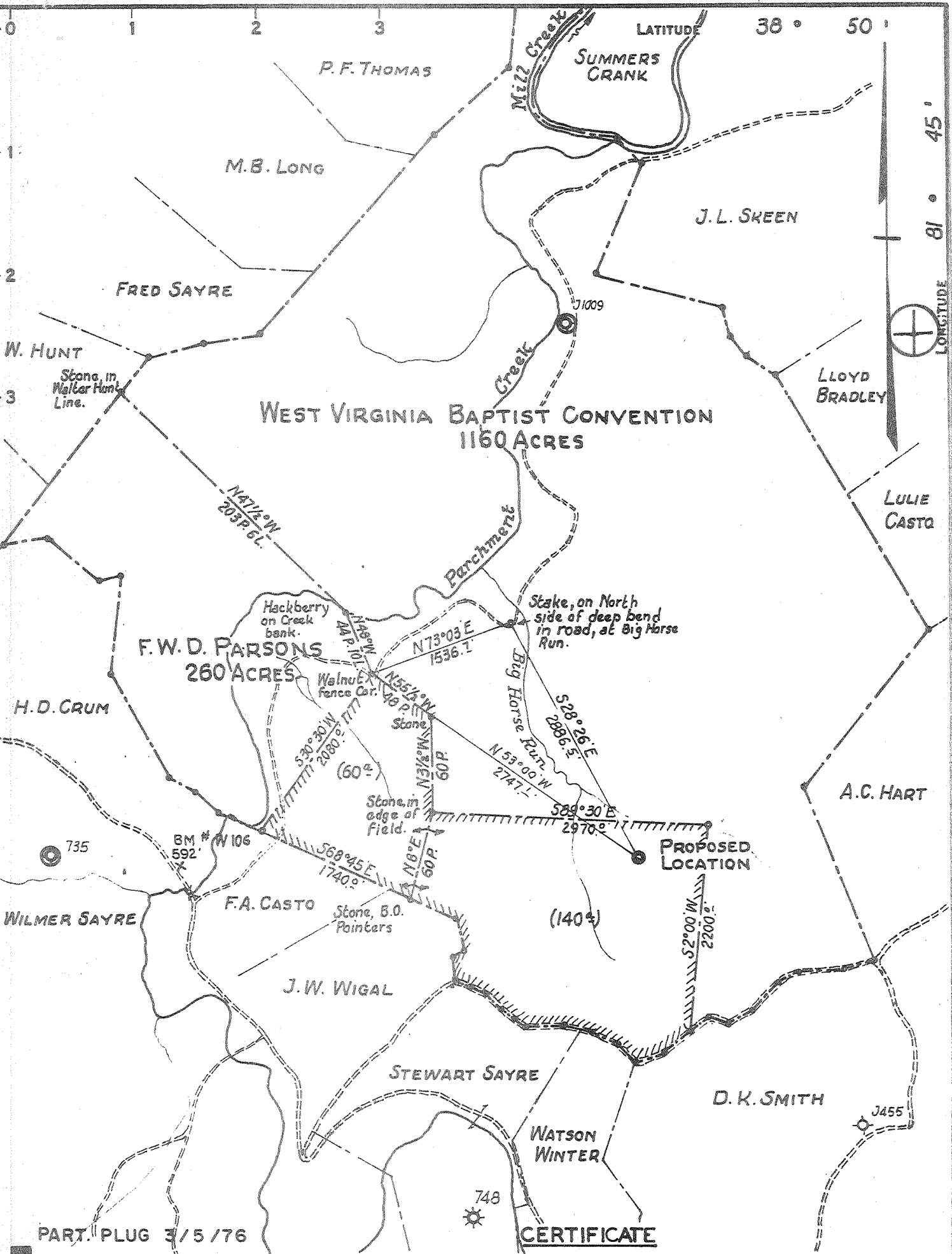

- NEW LOCATION
- RECONDITION
- DRILL DEEPER
- ABANDONMENT

"I, the undersigned, hereby certify that this map is correct to the best of my knowledge and belief and shows all the information required by paragraph 6 of the rules and regulations of the oil and gas section of the mining laws of West Virginia."
 Minimum degree of accuracy is one part in 500

Signed Ray Barney R.P.E. 2024

(W.S.G. - N.B. No. 95 Pg. 65)

PART PLUG 3/5/76

COMPANY COMMONWEALTH GAS CORPORATION
 ADDRESS P.O. BOX 1433 CHARLESTON, W.VA. 25325
 FARM WEST VIRGINIA BAPTIST CONVENTION ET AL
 MAP OV 26 ACRES 200 (UNIT) LEASE NO. 2406-2438
 WELL (FARM) NO. 1 SERIAL NO. 752
 ELEVATION (SPIRIT LEVEL) 735.34
 QUADRANGLE RAVENSWOOD (S.E.)
 COUNTY JACKSON DISTRICT RIPLEY
 POINT OF PROVEN ELEVATION U.S.G.S. BM No. W106 ELEV 692.2'
 (See Above)
 FILE NO. _____ DRAWING NO. _____
 DATE SEPTEMBER 12, 1966 SCALE 1" = 1320'

STATE OF WEST VIRGINIA
 DEPARTMENT OF MINES
 OIL AND GAS DIVISION
 CHARLESTON
WELL LOCATION MAP
 FILE NO. JAC-1128-PP
 MAR 15 1976
 + DENOTES LOCATION OF WELL ON UNITED STATES TOPOGRAPHIC MAPS. SCALE 1 TO 62,500. LATITUDE AND LONGITUDE LINES BEING REPRESENTED BY BORDER LINES AS SHOWN. **47-035**
 - DENOTES ONE INCH SPACES ON BORDER LINE OF ORIGINAL TRACING.

010W0 6-4 (311)

LATITUDE 38-50-00

WV BAPTIST CONVENTION

STAATS

MILL CREEK

WELL NO. 752
47-035-1128
1260 AC.

LEASE

HERSMAN
18" BLACK OAK

36" BLACK OAK
GARNES

SAYRE
N 81-54 E
879.5'

HUNT

2300

MILLS

2346

47-035-1134

PARCHMENT

S 83-23 W 4749.6'

HELMS

BUNNER

CENTER ROAD

N 35-24 E
3235'

STONE

N 53-00 W
2747'

HART

FENCE POST
34" BLACK OAK

WELL NO.
47-035-1128

METAL T-RAIL

WIGAL

SAYRE

KAY

SMITH

NORTH

00-54-18
LONGITUDE

13,700'

Cottageville Quad.
Ripley Quad.

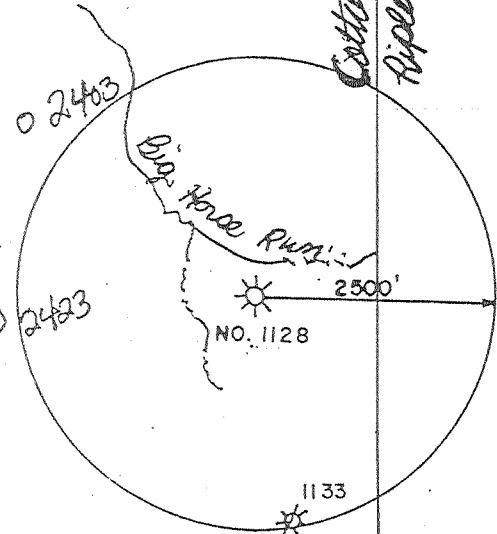

REFERENCES

2.54
0.24

ALL INFO TAKEN FROM 1967 PLAT

(+) DENOTES LOCATION OF WELL ON UNITED STATES TOPOGRAPHIC MAPS

FILE NO. _____
DRAWING NO. _____
SCALE 1" = 2000'
MINIMUM DEGREE OF ACCURACY 1/200
PROVEN SOURCE OF ELEVATION USGS BM 592'

I THE UNDERSIGNED, HEREBY CERTIFY THAT THIS PLAT IS CORRECT TO THE BEST OF MY KNOWLEDGE AND BELIEF AND SHOWS ALL THE INFORMATION REQUIRED BY LAW AND THE REGULATIONS ISSUED AND PRESCRIBED BY THE DEPARTMENT OF ENERGY.

(SIGNED) M. Allen Jerde
R.P.E. _____ L.L.S. 959

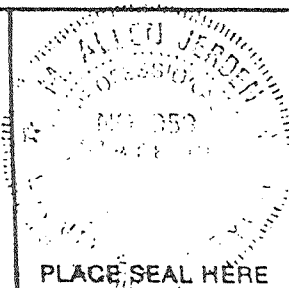

WEST VIRGINIA
DIVISION OF ENVIRONMENTAL PROTECTION
OFFICE OF OIL AND GAS
#10 McJUNKIN ROAD
NITRO, WEST VIRGINIA 25143-2506



DATE DEC. 1, 19 98
OPERATOR'S WELL NO. 752
API WELL NO. _____

WELL TYPE: OIL GAS LIQUID INJECTION WASTE DISPOSAL
(IF "GAS,") PRODUCTION STORAGE DEEP SHALLOW
LOCATION: ELEVATION 735' WATERSHED PARCHMENT CREEK (BIG HORSE RUN)
DISTRICT RIPLY COUNTY JACKSON
QUADRANGLE COTTAGEVILLE 7.5'

SURFACE OWNER WV BAPTIST CONVENTION ACREAGE 1260
OIL & GAS ROYALTY OWNER WV BAPTIST CONVENTION LEASE ACREAGE 1260
LEASE NO. 2406

PROPOSED WORK: DRILL CONVERT DRILL DEEPER REDRILL FRACTURE OR PLUG SQUEEZE STIMULATE PLUG OFF OLD FORMATION PERFORATE NEW FORMATION OTHER PHYSICAL CHANGE IN WELL (SPECIFY) Shale Coring

Existing Well drilled in 1966 by Commonwealth to 5608' plugged back to 4950' Produced Oil & Gas
PLUG AND ABANDON CLEAN OUT AND REPLUG
TARGET FORMATION Lower Huron & Devonian ESTIMATED DEPTH 5114'
WELL OPERATOR MOUNTAINEER GAS SERVICES DESIGNATED AGENT DANNY CHANDLER
ADDRESS P.O. BOX 1869 CHARLESTON, WV. 25327 ADDRESS P.O. BOX 1869 CHARLESTON, WV 25327

MAR 16 1999

COUNTY NAME

JAC

PERMIT

1128 F

9-19-66 - w3

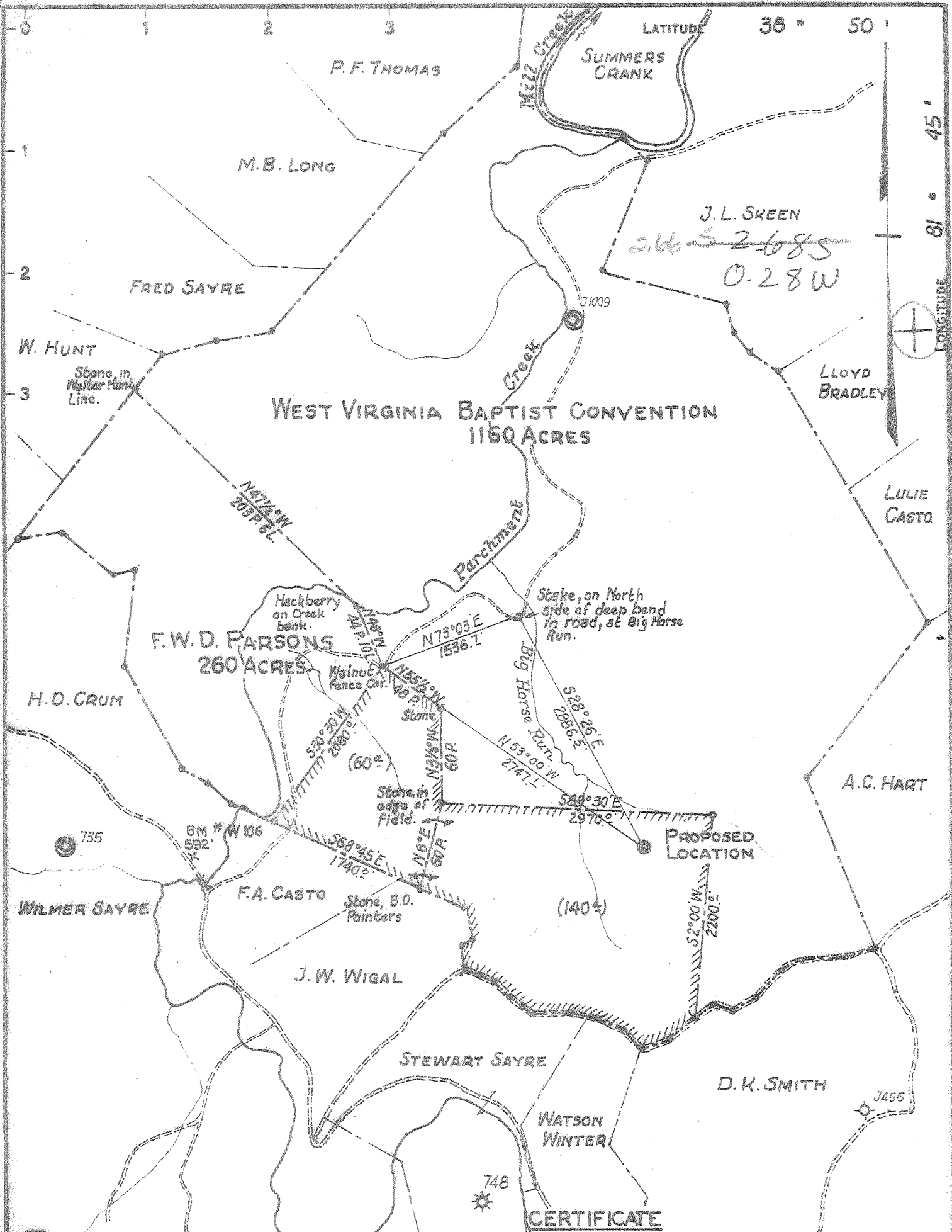

- NEW LOCATION
- RECONDITION
- DRILL DEEPER
- ABANDONMENT

"I, the undersigned, hereby certify that this map is correct to the best of my knowledge and belief and shows all the information required by paragraph 6 of the rules and regulations of the oil and gas section of the mining laws of West Virginia."
 Minimum degree of accuracy is one part in 500

Signed Ray B. Boney R.P.E. 2024

(W.S.G. - N.B. No. 95 P. 45)

COMPANY	COMMONWEALTH GAS CORPORATION		
ADDRESS	P.O. BOX 1433 CHARLESTON, W.VA. 25325		
FARM	WEST VIRGINIA BAPTIST CONVENTION ET AL		
MAP	OV 26	ACRES 200 (UNIT)	LEASE NO. 2406-2438
WELL (FARM) NO.	1	SERIAL NO.	752
ELEVATION (SPIRIT LEVEL)	735.34		
QUADRANGLE	RAVENSWOOD S.E.		
COUNTY	JACKSON	DISTRICT	RIPLEY
POINT OF PROVEN ELEVATION	U.S.G.S. BM No. W106 Elev 592' (See Above)		
FILE NO.	DRAWING NO.		
DATE	SEPTEMBER 12, 1966		
	SCALE 1" = 1320'		

STATE OF WEST VIRGINIA
 DEPARTMENT OF MINES
 OIL AND GAS DIVISION
 CHARLESTON
 WELL LOCATION MAP
 FILE NO. JAC-1128

+ DENOTES LOCATION OF WELL ON UNITED STATES TOPOGRAPHIC MAPS. SCALE 1 TO 62,500. LATITUDE AND LONGITUDE LINES BEING REPRESENTED BY BORDER LINES AS SHOWN.
 - DENOTES ONE INCH SPACES ON BORDER LINE OF ORIGINAL TRACING.

6-6 311 NEWBURG



STATE OF WEST VIRGINIA
DEPARTMENT OF MINES
OIL AND GAS DIVISION

RECEIVED

MAR 12 1979

Spudder
Cable Tools
Storage
Well Gas
Packers

Quadrangle Ravenswood S.E.

Permit No. JAC. 1128 - PP

OIL & GAS DIVISION
WELL RECORDED DEPT. OF MINES

Company Commonwealth Gas Corporation
Address P. O. Box 1133, Charleston, W. Va. 25325
Farm W. Va. Baptist Convention Acres 200
Location (waters) Parchment Creek
Well No. One (Serial No. 752) Elev. 735.34
District Ripley County Jackson
The surface of tract is owned in fee by W. Va. Baptist Convention
1019 Juliana Street Address Parkersburg, W. Va.
Mineral rights are owned by same and F.W.D. Parsons
Address Ripley, W. Va.

Casing and Tubing	Used in Drilling	Left in Well	Packers
Size	..		Kind of Packer
16			
13-3/8	31'-20"	31'-20"	Size of
8x5/8	2447'	2447'	Depth set
6x5/8			Perf. top
4-1/2	5598.67	5598.67	Perf. bottom
3			Perf. top
2			Perf. bottom
Liners Used			

Drilling commenced October 20, 1966
Drilling completed November 12, 1966
Date Shot From To
With

Open Flow /10ths Water in Inch
/10ths Merc. in Inch
Volume 539 MCF-Oriskany 793 MCF Newburg Cu. Ft.
Rock Pressure 2200 lbs. 48 hrs.
Oil bbls., 1st 24 hrs.
WELL ACIDIZED

CASING CEMENTED SIZE No. Ft. Date
220 Bags behind the 8-5/8" casing,
225 Bags behind the 4-1/2" casing.
COAL WAS ENCOUNTERED AT FEET INCHES
FEET INCHES FEET INCHES
FEET INCHES FEET INCHES

WELL FRACTURED Nov. 12, 1966 5531 to 5537; Sand 20-40, 2600#; Mud Acid 500 gal.; Nitrogen
86,000 SCF; Water 751 Bbls.
RESULT AFTER TREATMENT 1,604,000
ROCK PRESSURE AFTER TREATMENT 2200# 48 Hrs.
Fresh Water Feet Salt Water Feet

Formation	Color	Hard or Soft	Top	Bottom	Oil, Gas or Water	Depth	Remarks
Top Soil			0	42			
Red Rock & Shale			42	1090			
Sand			1090	1190			
Sand Shells			1190	1347			
Shale Slate			1347	1660			
Salt Sand			1660	1825			
Big Lime			1825	1880			
Injun Sand			1880	2150			
Slate & Shells			2150	2400			
Berea Sand			2400	2409			
Shale			2409	4706			
Corniferous Lime			4706	4826			
Oriskany Sand			4826	4840	Gas	4828-4837	539,000 cu. f
Lime & Shale			4840	5526			
Newburg Sand			5526	5547	Gas	5531-5537	793,000 cu. f
Lime & Chert			5547	5608			
			Total Depth	5608			

March 4, 1976 - Set cement plug in 4 1/2" casing, 5608' to 5418', filled hole with gel from 5418-4900'. Set wire line bridge plug at 4861'. Set cal seal plug 4850' to 4861'. Perforate 4 1/2" casing 4826-4831 with 20 shots. Fractured Oriskany with 724 bbls. water and 27,000# sand. Open flow = 150 MCF/Day from the Oriskany Sand.

DEVON CORPORATION
A. C. Youse
A. C. Youse,
District Geologist



STATE OF WEST VIRGINIA
DEPARTMENT OF MINES
OIL AND GAS DIVISION

Rotary
Spudder
Cable Tools
Storage

Quadrangle Ravenswood S.E.

WELL RECORD

Oil or Gas Well Gas
(KIND)

Permit No. JAG. 1128

Company Commonwealth Gas Corporation
Address P. O. Box 1433, Charleston, W. Va. 25325
Farm W. Va. Baptist Convention Acres 200
Location (waters) Parchment Creek
Well No. One (Serial No. 752) Elev. 735.34
District Ripley County Jackson
The surface of tract is owned in fee by W. Va. Baptist Convention
1019 Juliana Street Address Parkersburg, W. Va.
Mineral rights are owned by same and F.W.D. Parsons
Address Ripley, W. Va.

Casing and Tubing	Used in Drilling	Left in Well	Packers
Size			Kind of Packer
16			Size of
18-3/8	31'-20"	31'-20"	Depth set
8-5/8	2447'	2447'	Perf. top
6-5/8			Perf. bottom
4-1/2	5598.67	5598.67	Perf. top
3			Perf. bottom
2			
Liners Used			

Drilling commenced October 20, 1966
Drilling completed November 12, 1966
Date Shot From To
With
Open Flow /10ths Water in Inch
/10ths Merc. in Inch
Volume 539 MCF-Oriskany 793 MCF Newburg Cu. Ft.
Rock Pressure 2200 lbs. 48 hrs.
Oil bbls., 1st 24 hrs.
WELL ACIDIZED

CASING CEMENTED SIZE No. Ft. Date
220 Bags behind the 8-5/8" casing,
225 Bags behind the 4-1/2" casing.
COAL WAS ENCOUNTERED AT FEET INCHES
FEET INCHES FEET INCHES
FEET INCHES FEET INCHES

WELL FRACTURED Nov. 12, 1966 5531 to 5537; Sand 20-40, 2600#; Mud Acid 500 gal.; Nitrogen 86,000 SCF; Water 751 Bbls.
RESULT AFTER TREATMENT 1,604,000
ROCK PRESSURE AFTER TREATMENT 2200# 48 Hrs.
Fresh Water Feet Salt Water Feet

Formation	Color	Hard or Soft	Top	Bottom	Oil, Gas or Water	Depth	Remarks
Top Soil			0	42			
Red Rock & Shale			42	1090			
Sand			1090	1190			
Sand Shells			1190	1347			
Shale Slate			1347	1660			
✓ Salt Sand			1660	1825			
✓ Big Lime			1825	1880			
✓ Injun Sand			1880	2150			
Slate & Shells			2150	2400			
✓ Berea Sand			2400	2409			
Shale			2409	4706			
✓ Corniferous Lime -463			4706	4826			
✓ Oriskany Sand			4826	4840	Gas	4828-4837	539,000 cu.ft
✓ Lime & Shale -Helderberg & Salina			4840	5526			
✓ Newburg Sand			5526	5517	✓ 535 Gas	5531-5537	793,000 cu.ft
✓ Lime & Chert -McKenzie			5517	5608			
Total Depth				5608		545	

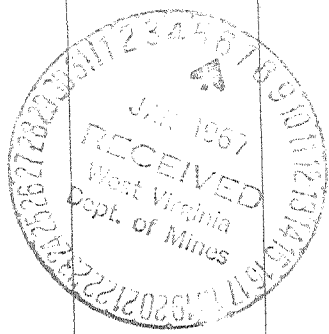

Final Gauge 1,604,000 cu.ft. after frac Newburg; Oriskany Sand not fractured.

P.I. card perfor in Oriskany @ 4830 to 4836