

Minimum Error of Closure 1' IN 200'
 Source of Elevation CARNEY WELL NO. 1 629.70

I, the undersigned, hereby certify that this map is correct to the best of my knowledge and belief and shows all the information required by paragraph 6 of the rules and regulations of the oil and gas section of the mining laws of West Virginia.

- Fracture
- New location
- Drill Deeper
- Abandonment

Signed: L. F. Dye
 Squares: N S E W

Map No. issued 3-25-69

Company EDISON J. PARSONS
 Address RIPLEY, W. VA.
 Farm GEORGE W. PARSONS HRS.
 Tract _____ Acres 304 Lease No. _____
 Well (Farm) No. 1 Serial No. _____
 Elevation (Spirit Level) 856.38
 Quadrangle RAVENSWOOD SE
 County JACKSON District RIPLEY
 Engineer L. F. Dye
 Engineer's Registration No. 804
 File No. _____ Drawing No. _____
 Date 5-22-67 Scale 1" = 50 FEET

STATE OF WEST VIRGINIA
 DEPARTMENT OF MINES
 OIL AND GAS DIVISION
 CHARLESTON

WELL LOCATION MAP
 FILE NO. JAC-1141-P

+ Denotes location of well on United States Topographic Maps, scale 1 to 62,500, latitude and longitude lines being represented by border lines as shown.
 - Denotes one inch spaces on border line of original tracing.

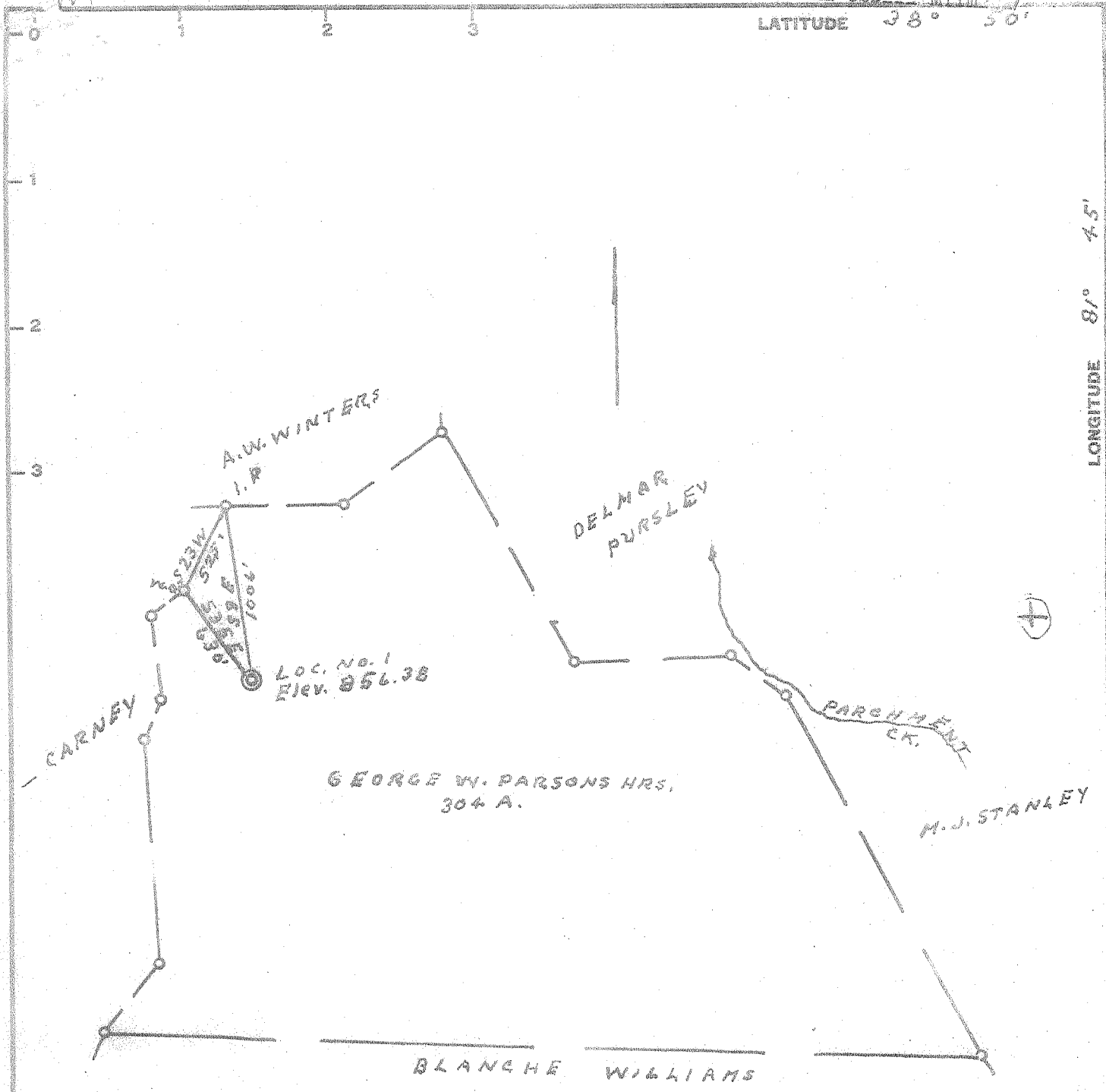

Minimum Error of Closure 1' IN 200'
 Source of Elevation CARNEY WELL NO. 1 629.70

- Fracture
- New Location
- Drill Deeper
- Abandonment

I, the undersigned, hereby certify that this map is correct to the best of my knowledge and belief and shows all the information required by paragraph 6 of the rules and regulations of the oil and gas section of the mining laws of West Virginia.

Signed: L. F. Byr
 Map No. _____ Squares: N S E W

Company EDISON J. PARSONS
 Address RIPLEY, W. VA.
 Farm GEORGE W. PARSONS HRS.
 Tract _____ Acres 304 Lease No. _____
 Well (Farm) No. 1 Serial No. _____
 Elevation (Spirit Level) 856.38
 Quadrangle RAYENSWOOD - SE
 County JACKSON District RIPLEY
 Engineer L. F. Byr
 Engineer's Registration No. 804
 File No. _____ Drawing No. _____
 Date 5-22-67 Scale 1" = 50 FEET

STATE OF WEST VIRGINIA
 DEPARTMENT OF MINES
 OIL AND GAS DIVISION
 CHARLESTON

WELL LOCATION MAP
 FILE NO. JAC-1141

+ Denotes location of well on United States Topographic Maps, scale 1 to 62,500, latitude and longitude lines being represented by border lines as shown.
 - Denotes one inch spaces on border line of original tracing.



STATE OF WEST VIRGINIA
DEPARTMENT OF MINES
OIL AND GAS DIVISION

Rotary
Spudder
Cable Tools
Storage

Quadrangle RAVENSWOOD
Permit No. JAC - 1141

WELL RECORD

Oil or Gas Well GAS
(KIND)

Company	Address	Farm	Location (waters)	Well No.	District	County	The surface of tract is owned in fee by	Address	Mineral rights are owned by	Address	Drilling commenced	Drilling completed	Date Shot	With	Open Flow	Volume	Rock Pressure	Oil	WELL ACIDIZED (DETAILS)	WELL FRACTURED (DETAILS)	RESULT AFTER TREATMENT (Initial open Flow or bbls.)	ROCK PRESSURE AFTER TREATMENT	Fresh Water	Producing Sand	
Edison J. Parsons	119 Highlawn Drive - Ripley, W. Va.	George W. Parsons, Thelma Kessel, Et. Al	Parchment Creek	I	Ripley	Jackson	Thelma Kessel Et. Al	Charleston, W. Va.	Thelma Kessel Et. Al.	Charleston, W. Va.	May 24, 1967	June 6, 1967	From To		3/10ths Water in Two Inch	75 McF					Dowell Water Frac. 18,000 Sand 464 Bbl. Water 1000 Gal. Mud Acid - Breakdown 2800 Treat 5300# Flowback Immediate	1,300 MFC	1660	Newburg	Depth 5707 to 5714

Casing and Tubing	Used in Drilling	Left in Well	Packers
Size			Kind of Packer
16			
13			
10	22'	21'/10SX	Contractor
8 1/4			
6 5/8 7"	2642' 10"	2642' 10"	40SX Dowell
5 3/16			
4 1/2			
3	5775	5775'/100	5707
2			5714
Liners Used			5713
			5720

Attach copy of cementing record.

CASING CEMENTED SIZE No. Ft. Date

Amount of cement used (bags)

Name of Service Co.

COAL WAS ENCOUNTERED AT FEET INCHES

FEET INCHES FEET INCHES

FEET INCHES FEET INCHES

Formation	Color	Hard or Soft	Top	Bottom	Oil, Gas or Water	Depth	Remarks
Clay	Red	Soft	0	26			
Sand	Light	Hard	26	65			
Red Rock	Red	Soft	65	90			
Sand Stone	Light	Hard	90	135			
Red Rock	Red	Soft	135	182			
Red Rock	Light	Med					
Slate & Sand to Drk		Hard	182	720			
Sndy lse & lt. to Blu sh.	Med Dk	Med.	720	1115			
Slate & Red Rock		Med.	1115	1185			
Slate	Gray	Med.	1185	1220			
Sand	Light	Hard	1220	1278			
Shale	Black	Soft	1278	1281			
Sndy	Light	Med.	1281	1375			
Silty Shale	Gray	Med	1375	1740			
Sand	Light	Med	1740	1755			
Sand	Light	Med. Hd.	1755	1800			
Sandy Line	Light	Med.	1800	1902			
Sdy lse & Sh.	Light	Med.	1902	2115			
Sand	Light	Med.	2115	2130			
Sndy Shles	Light & Drk.	Med	2130	2567			
Sand	Light	Med.	2567	2580			
Sndy shles	Lt. & Drk.	Med.	2580	2660			
Shale	Dark	Soft	2660	4899			
Line	Lt. Brn	Med.	4899	4994			
Sand	Light	Med.	4994	5000			

Same as Jack. 1139

SEP 1967 RECEIVED West Virginia Dept. of Mines

(over)

