

Long. - 81° 44' 58.0"

11,700'

LATITUDE 38° 52' 30"

NOTES

- 1 - The survey drawing shown hereon is from the original drilling permit plat dated 7/27/1970 by Wendell S. Moore. Current plat was re-drafted to show updated surface owner names and corrected Latitude and Longitude information.
- 2 - Surface owner information obtained from the operator contact and signed Surface Owner Waiver form.
- 3 - Well Latitude and Longitude established by scaling from Ripley 7.5' Quadrangle.

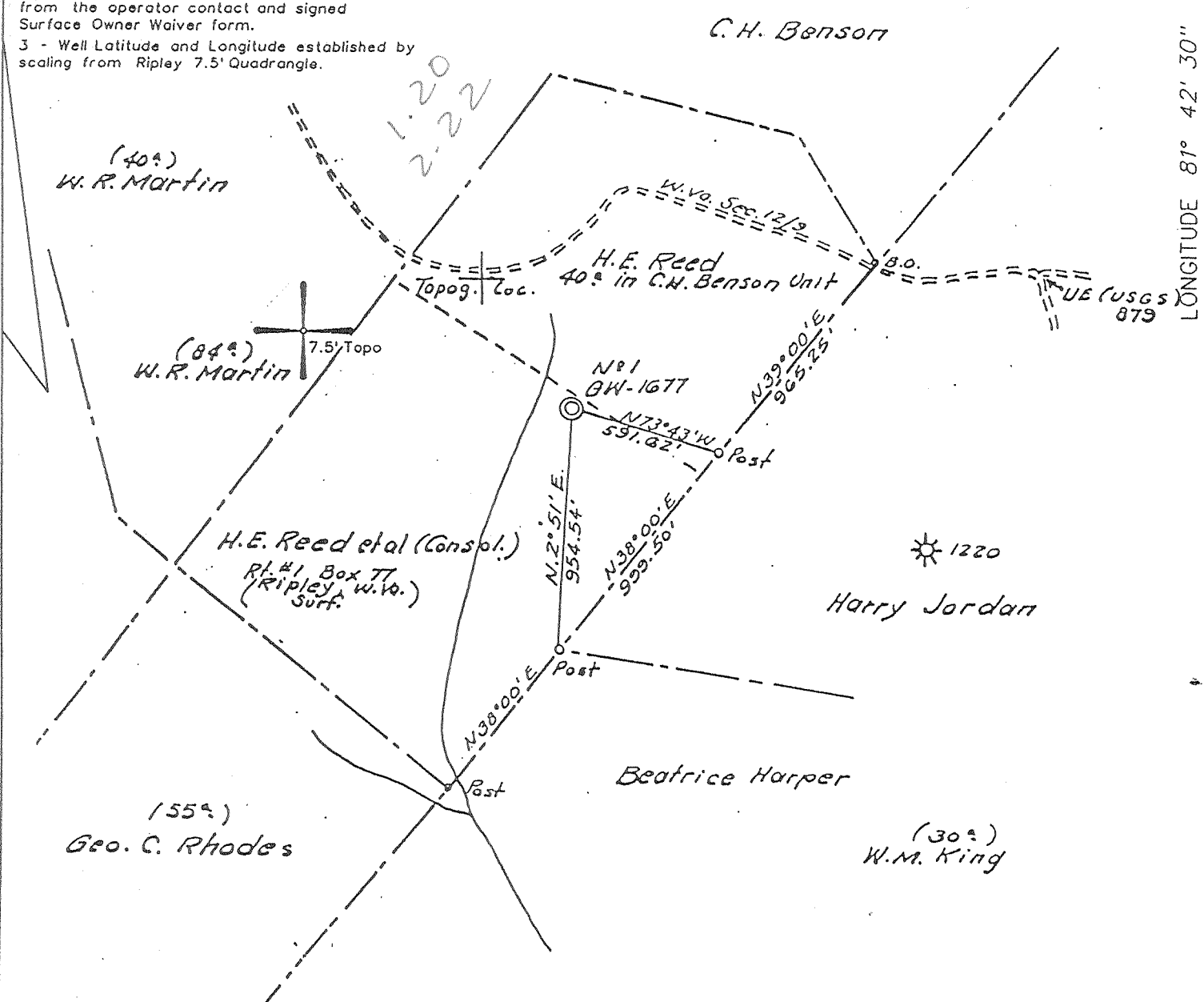

(+) DENOTES LOCATION OF WELL ON UNITED STATES TOPOGRAPHIC MAPS

FILE NO. 21-02
 DRAWING NO. _____
 SCALE 1" = 600'
 MINIMUM DEGREE OF ACCURACY 1 in 200
 PROVEN SOURCE OF ELEVATION WVDEP Records

I THE UNDERSIGNED, HEREBY CERTIFY THAT THIS PLAT IS CORRECT TO THE BEST OF MY KNOWLEDGE AND BELIEF AND SHOWS ALL THE INFORMATION REQUIRED BY LAW AND THE REGULATIONS ISSUED AND PRESCRIBED BY THE DEPARTMENT OF MINES.

(SIGNED) [Signature]
 TIMOTHY P. ROUSH PS 793

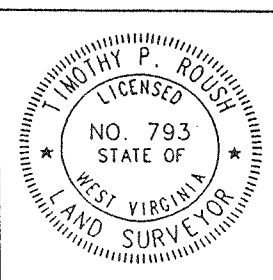

WEST VIRGINIA
 Division of Environmental Protection
 Office of Oil and Gas
 •10 McJunkin Road
 Nitro, West Virginia 25143-2506



DATE January 10, 2001
 FARM H.E. Reed NO. 1
 API WELL NO. 47-035-01223-W

WELL TYPE: OIL GAS X LIQUID INJECTION WASTE DISPOSAL
 (IF "GAS") PRODUCTION X STORAGE DEEP X SHALLOW
 LOCATION: ELEVATION 841.62' WATERSHED Right Fork of Mud Run
 DISTRICT Union COUNTY Jackson
 QUADRANGLE Ripley 7.5'
 SURFACE OWNER Hugh C. Ballard ACREAGE
 OIL & GAS ROYALTY OWNER LEASE ACREAGE
 LEASE NO.
 PROPOSED WORK: DRILL CONVERT DRILL DEEPER REDRILL FRACTURE OR
 STIMULATE X PLUG OFF OLD FORMATION PERFORATE NEW
 FORMATION X OTHER PHYSICAL CHANGE IN WELL (SPECIFY) Complete Oriskany Sand
 PLUG AND ABANDON CLEAN OUT AND REPLUG
 TARGET FORMATION Oriskany ESTIMATED DEPTH 4970'
 WELL OPERATOR Simcon Oil & Gas Corp. DESIGNATED AGENT John Wilcox
 ADDRESS Rt. 7, Box 407 1/2 ADDRESS Rt. 7, Box 407 1/2
South Chas., WV 25309 South Chas., WV 25309

FORM IV-6

JAC 1223 W

DEEP WELL

1-6 312

JAN 12 2001

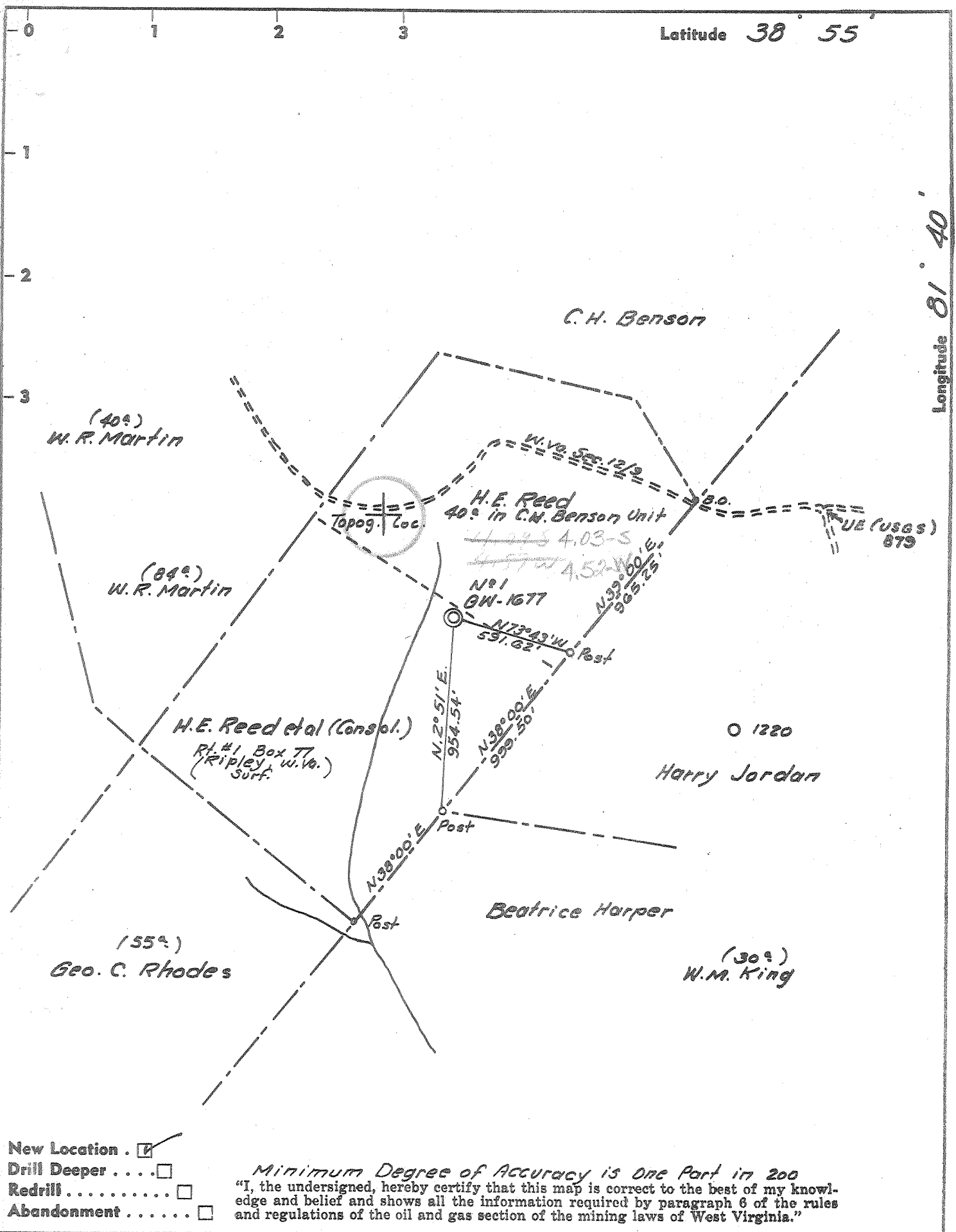

- New Location .
- Drill Deeper
- Redrill
- Abandonment

Minimum Degree of Accuracy is One Part in 200
 "I, the undersigned, hereby certify that this map is correct to the best of my knowledge and belief and shows all the information required by paragraph 6 of the rules and regulations of the oil and gas section of the mining laws of West Virginia."

Company CITIES SERVICE OIL COMPANY
 Address Box 873 CHARLESTON, W.VA.
 Farm H.E. REED, et al Consol.
 Tract _____ Acres 327 Lease No. WV-255
 Well (Farm) No. A-1 Serial No. GW-1677
 Elevation (Spirit Level) 841.62'
 Quadrangle RIPLEY & RAVENSWOOD WC
 County JACKSON District RIPLEY
 Engineer Wendell S. Moore
 Engineer's Registration No. 2113
 File No. _____ Drawing No. W-12-70
 Date JULY 27, 1970 Scale 1" = 600'

STATE OF WEST VIRGINIA
 DEPARTMENT OF MINES
 OIL AND GAS DIVISION
 CHARLESTON

WELL LOCATION MAP
 FILE NO. Jac-1223

+ Denotes location of well on United States Topographic Maps, scale 1 to 62,500, latitude and longitude lines being represented by border lines as shown.
 -- Denotes one inch spaces on border line of original tracing.



STATE OF WEST VIRGINIA
DEPARTMENT OF MINES
OIL AND GAS WELLS DIVISION 3

Rotary
Spudder
Cable Tools
Storage
Oil or Gas Well Gas (KIND)

Quadrangle Ripley
Permit No. JAC-1223

WELL RECORD

Company Cities Service Oil Company
Address Box 873, Charleston, W. Va. 25323
Farm H. E. Reed, et al Cons. Acres 327
Location (waters)
Well No. "A" #1, GW-1677 Elev. 841.62'
District Ripley County Jackson
The surface of tract is owned in fee by H. E. Reed
Route #1, Box 77 Address Ripley, W. Va.
Mineral rights are owned by H. E. Reed, et al
(for further add. contact C. S. O. C.)
Address
Drilling commenced 7-31-70
Drilling completed 8-20-70
Date Shot not shot From To
With
Open Flow /10ths Water in Inch
/10ths Merc. in Inch
Volume Cu. Ft.
Rock Pressure lbs. hrs.
Oil bbls., 1st 24 hrs.
WELL ACIDIZED (DETAILS) not acidized
WELL FRACTURED (DETAILS) see reverse side

| Casing and Tubing | Used in Drilling depth set | Left in Well | Packers |
|-------------------|----------------------------|--------------|----------------|
| Size | | | Kind of Packer |
| 16 | | | none |
| 13 3/8" 48# | 81' | 81' | Size of |
| 10 | | | Depth set |
| 8 1/4" 24# | 2286' | 2286' | Perf. top |
| 5 6/8" 17# | 5530' | 5530' | Perf. bottom |
| 4 1/2 | | | Perf. top |
| 3 | | | Perf. bottom |
| 2 3/8" 4.7# | 5612' | 5612' | |
| Liners Used | | | |

Attach copy of cementing record.
CASING CEMENTED SIZE No. Ft. Date
Amount of cement used (bags) see reverse side
Name of Service Co.
COAL WAS ENCOUNTERED AT none FEET INCHES
FEET INCHES FEET INCHES
FEET INCHES FEET INCHES

RESULT AFTER TREATMENT (Initial open Flow or bbls.) 33,000 MCFD (4 pt. CAOF) Newburg Sand
ROCK PRESSURE AFTER TREATMENT 1870# HOURS 33,000,000
Fresh Water Feet Salt Water Feet
Producing Sand Newburg Sand 5569-84' Depth per electric logs

| Formation | Color | Hard or Soft | Top | Bottom | Oil, Gas or Water | Depth | Remarks |
|----------------|-------|--------------|------|--------|-------------------|-------|---------|
| Shale | | | 0 | 30 | | | |
| Gray Sand | | | 30 | 81 | | | |
| Red Rock | | | 81 | 95 | | | |
| Gray Sand | | | 95 | 110 | | | |
| Red Rock | | | 110 | 114 | | | |
| Gray Sand | | | 114 | 129 | | | |
| Red Rock | | | 129 | 159 | | | |
| Gray Sand | | | 159 | 187 | | | |
| Red Rock | | | 187 | 216 | | | |
| Gray Sand | | | 216 | 273 | | | |
| Red Rock | | | 273 | 301 | | | |
| Gray Sand | | | 301 | 315 | | | |
| Red Rock | | | 315 | 379 | | | |
| Gray Sand | | | 379 | 394 | | | |
| Red Rock | | | 394 | 555 | | | |
| Shale | | | 555 | 721 | | | |
| Sandy Shale | | | 721 | 1069 | | | |
| Shale | | | 1069 | 1100 | | | |
| Sandy Shale | | | 1100 | 1203 | | | |
| Sand | | | 1203 | 1332 | | | |
| Sandy Shale | | | 1332 | 1447 | | | |
| Shale | | | 1447 | 1451 | | | |
| Sand | | | 1451 | 1547 | | | |
| Salt Sand | | | 1547 | 1632 | | | |
| Shale and Sand | | | 1632 | 1733 | | | |
| Sand | | | 1733 | 1880 | | | |

RECEIVED
SEP 1 1970

| Formation | Color | Hard or Soft | Top | Bottom | Oil, Gas or Water | Depth Found | Remarks |
|-----------------------|--|--------------|-------|---------|-------------------|-------------|---------|
| Big Lime | | | 1880 | 1978 | | | |
| Big Injun | | | 1978 | 2142 | | | |
| Shale | | | 2142 | 4745 | | | |
| Lime | | | 4745 | 5578 | | | |
| Newburg Sand | | | 5578 | 5585 | | | |
| Lime McKenzie | | | 5585 | 5627 | | | |
| Total depth ----- | | | | 5627' | Drillers' Meas. | | |
| | | | | = 5617' | Birdwell Meas. | | |
| Electric Logs showed: | | | | | | | |
| Onondaga | 463 | | 4745' | | | | |
| Oriskany | | | 4844' | | | | |
| Newburg Sand | | | 5569 | 5584' | | | |
| CASING RECORD | | | | | | | |
| 7-31-70 | Set and cemented 13-3/8" 48# H-40 B -grade casing at 81' with 65 sacks of regular cement with 3% ca. cl. Cement circulated to surface. | | | | | | |
| 8-11-70 | Set and cemented 8-5/8" 24# H-40 new casing with guide shoe at 2286' with 400 sacks Lite Poz-3 and 100 sacks regular cement with 3% ca. cl. Float at 2252'. Centralizers 2252', 2151' and 2059'. Good circulation of mud but cement did not circulate to surface. | | | | | | |
| 8-16-70 | Set and cemented 5-1/2" 17# N-80 new casing at 5530' with 114 sacks regular cement followed by 37 sacks Latex. Pumped 250 bbls. gel ahead of cement. Gel circulated to surface. Lost circulation just before plug bumped. Float at 5500'. Centralizers at 5500', 5409', 5318', 5228' and 5129' | | | | | | |
| 8-15-70 | Ran Birdwell Gamma Ray inside D. P. Top Onondaga by electric logs 4745'. Top of Oriskany 4844'. <u>Show of gas lit spontaneously at 4848' - burned continuously for 10 hours.</u> | | | | | | |
| 8-20-70 | Ran Birdwell Gamma Ray, Caliper and Density Logs. Birdwell T. D. 5617'. Newburg Sand by electric logs 5569-5584' with 8' of 8 to 21% porosity. | | | | | | |
| 8-26-70 | Fraced Newburg Sand 5569' to 5584'. Pumped 500 gallons mud acid and 1,000 gallons regular 15% acid and followed with 25,000# 20-40 sand in 21,000 gallons gelled water. Maximum treating pressure 6,000#. Average treating pressure 4,400#. AIR 12 bbls/min. | | | | | | |
| 9-3-70 | Turned into line. Gas measuring 6,800 MCFD against 890# line pressure with 1260# on tubing and 1700# on annulus. | | | | | | |
| 9-9-70 | United Fuel 4 pt. CAOF B. H. 33,000 MCFD, SIWHP 1870#. Cities Service' 4 pt. CAOF B. H. 31,000 MCFD. | | | | | | |

Date September 11, 19 70

APPROVED Cities Service Oil Company, Owner
 By L. D. Todd, Region Prod. Manager
 (Title)

State of West Virginia
Department of Environmental Protection
Office of Oil and Gas

br

Well Operator's Report of Well Work

Farm name: H. E. Reed Operator Well No.: Reed #1

LOCATION: Elevation: 841.62' G.L. Quadrangle: Cottageville

District: Ripley County: Jackson
Latitude: 6300 Feet South of 38 Deg. 51 Min. 27.6 Sec.
Longitude 11700 Feet West of 81 Deg. 44 Min. 58 Sec.

Company: Simcow Oil and Gas Corp.

| | Casing & Tubing | Used in drilling | Left in well | Cement fill up Cu. Ft. |
|--|-----------------|------------------|--------------|------------------------|
| Address: <u>RT. 7 Box 407 1/2</u> <u>5. Chas WV 25309</u> | | | | |
| Agent: <u>John Wilcox</u> | | | | |
| Inspector: <u>Larry Pawish</u> | | | | |
| Date Permit Issued: <u>1-10-2002</u> | | | | |
| Date Well Work Commenced: <u>1-19-2001</u> | | | | |
| Date Well Work Completed: <u>1-29-2001</u> | | | | |
| Verbal Plugging: <u>NA</u> | | | | |
| Date Permission granted on: <u>Rework</u> | | | | |
| Rotary Cable Rig | | | | |
| Total Depth (feet): | | | | |
| Fresh Water Depth (ft.): <u>110'</u> | | | | |
| Salt Water Depth (ft.): <u>NA</u> | | | | |
| Is coal being mined in area (N/Y)? <u>No</u> | | | | |
| Coal Depths (ft.): <u>NA</u> | | | | |

OPEN FLOW DATA

Producing formation ORISKANY Pay zone depth (ft) 4842-4862
Gas: Initial open flow 5/8 MCF/d Oil: Initial open flow 0 Bbl/d
Final open flow 300 MCF/d Final open flow 0 Bbl/d
Time of open flow between initial and final tests _____ Hours
Static rock Pressure 650 psig (surface pressure) after 48 Hours

Second producing formation _____ Pay zone depth (ft) _____
Gas: Initial open flow _____ MCF/d Oil: Initial open flow _____ Bbl/d
Final open flow _____ MCF/d Final open flow _____ Bbl/d
Time of open flow between initial and final tests _____ Hours
Static rock Pressure _____ psig (surface pressure) after _____ Hours

NOTE: ON BACK OF THIS FORM PUT THE FOLLOWING: 1). DETAILS OF PERFORATED INTERVALS, FRACTURING OR STIMULATING, PHYSICAL CHANGE, ETC. 2). THE WELL LOG WHICH IS A SYSTEMATIC DETAILED GEOLOGICAL RECORD OF ALL FORMATIONS, INCLUDING COAL ENCOUNTERED BY THE WELLBORE.

Signed: [Signature]
By: John B Wilcox - Agent
Date: 10-1-2001

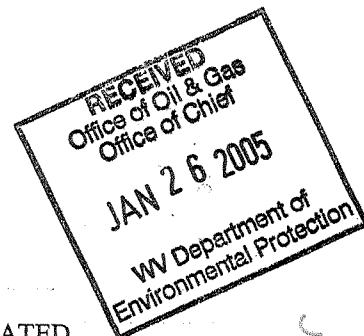

JAC 1223 W