

WELL REFERENCE Plot Card 050 (NO SCALE)

LATITUDE 38° 55'

LONGITUDE 81° 37' 30" 81° 35' 4600

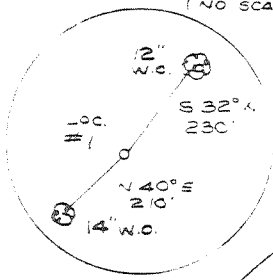

0.875
+ 2.58W

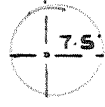

0.875
0.34W

NORTH

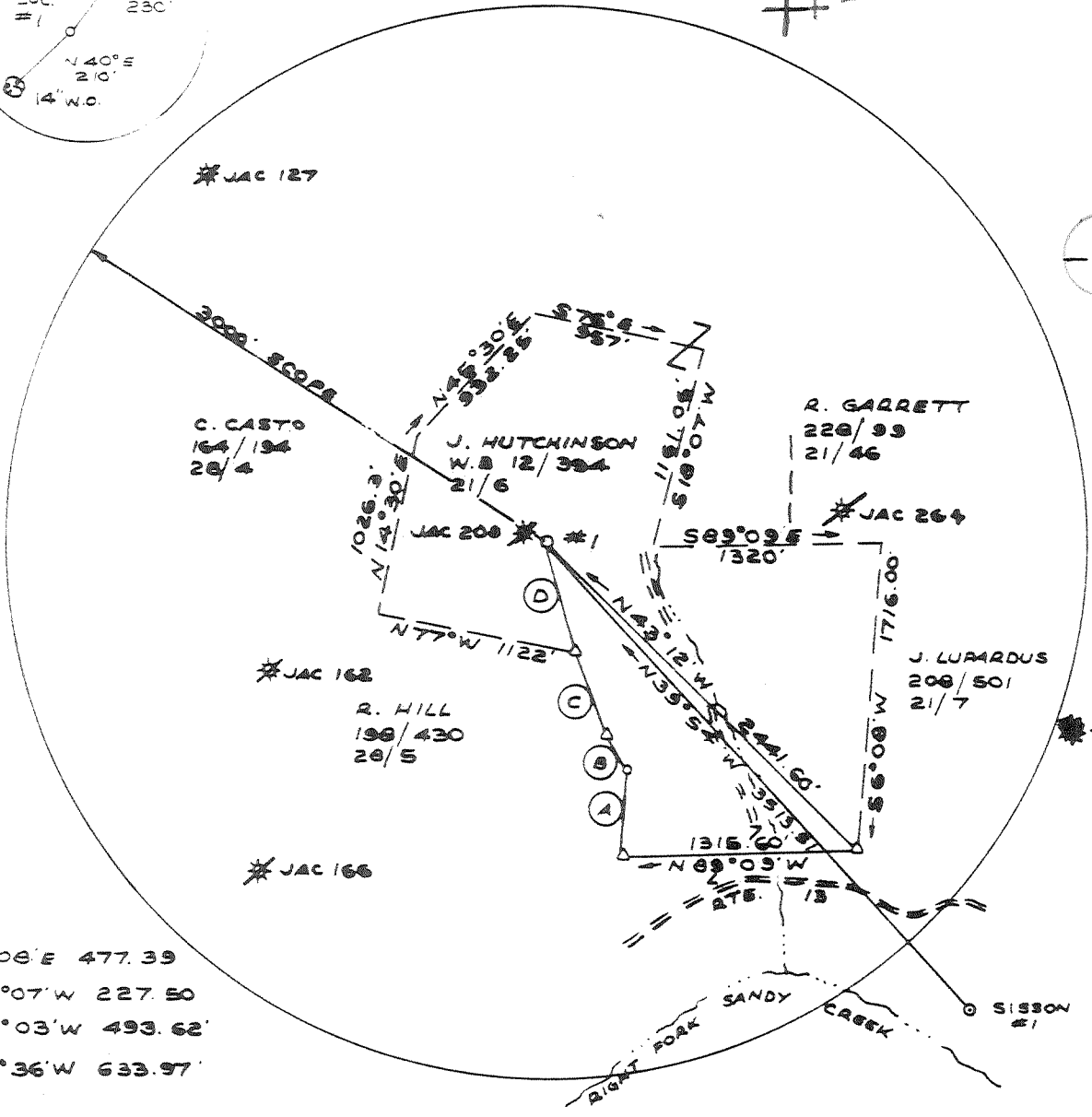

- (A) N 6° 08' E 477.39
- (B) N 28° 07' W 227.50
- (C) N 19° 03' W 493.62
- (D) N 12° 36' W 633.97

BOOK # 81-6

Δ DENOTES REED PIN.

FILE NO. 83-30
 DRAWING NO. _____
 SCALE 1" = 1000'
 MINIMUM DEGREE OF ACCURACY 1 IN 500
 PROVEN SOURCE OF ELEVATION ROAD INTERSECTION
FROM TOPO

I THE UNDERSIGNED, HEREBY CERTIFY THAT THIS PLAT IS CORRECT TO THE BEST OF MY KNOWLEDGE AND BELIEF AND SHOWS ALL THE INFORMATION REQUIRED BY LAW AND THE REGULATIONS ISSUED AND PRESCRIBED BY THE DEPARTMENT OF MINES.
 (SIGNED) William J. Whitson
 R.P.E. _____ L.L.S. 645



(+) DENOTES LOCATION OF WELL ON UNITED STATES TOPOGRAPHIC MAPS
 FORM IV-6 (8-78)



DATE JAN 26, 19 84
 OPERATOR'S WELL NO. HUTCHINSON #1
 API WELL NO. 47-035-1956
 STATE COUNTY PERMIT

STATE OF WEST VIRGINIA
 DEPARTMENT OF MINES
 OIL AND GAS DIVISION

WELL TYPE: OIL GAS LIQUID INJECTION _____ WASTE DISPOSAL _____
 (IF "GAS") PRODUCTION _____ STORAGE _____ DEEP SHALLOW _____
 LOCATION: ELEVATION 732' WATER SHED RIGHT FORK OF SANDY CREEK
 DISTRICT RAVENSWOOD 2 COUNTY JACKSON 35
 QUADRANGLE SANDYVILLE 598 (7.5) RIPLEY 112 15' 65
 SURFACE OWNER JACK HUTCHINSON ACREAGE 113
 OIL & GAS ROYALTY OWNER JACK HUTCHINSON et al LEASE ACREAGE 113
 LEASE NO. _____
 PROPOSED WORK: DRILL CONVERT _____ DRILL DEEPER _____ REDRILL _____ FRACTURE OR STIMULATE _____ PLUG OFF OLD FORMATION _____ PERFORATE NEW FORMATION _____ OTHER PHYSICAL CHANGE IN WELL (SPECIFY) _____
 PLUG AND ABANDON _____ CLEAN OUT AND REPLUG _____
 TARGET FORMATION NEW BUAG ESTIMATED DEPTH 5400'
 WELL OPERATOR CARL SMITH PETROLEUM INC. DESIGNATED AGENT CARL SMITH
 ADDRESS P.O. Bx. 4 817 SANDYVILLE W.V. 25275 ADDRESS SAME
deep well 6-0 Elk-Poca (Sissonville) (192)

21 1984

IV-35
(Rev 8-**RECEIVED**

DEC 14 1984

OIL & GAS DIVISION
DEPT. OF MINES

State of West Virginia

Department of Mines
Oil and Gas Division

Date December 12, 1984

Operator's

Well No. #271

Farm Jack Hutchinson

API No. 47 - 035 - 1956

WELL OPERATOR'S REPORT
OFDRILLING, FRACTURING AND/OR STIMULATING, OR PHYSICAL CHANGEWELL TYPE: Oil ___ / Gas X / Liquid Injection ___ / Waste Disposal ___ /
(If "Gas," Production X / Underground Storage ___ / Deep X / Shallow ___ /)LOCATION: Elevation: 752' Watershed Right Fork Sandy Creek
District: Ravenswood County Jackson Quadrangle Sandyville

COMPANY Carl E. Smith Petroleum, Inc.

ADDRESS P.O. Box 4
Sandyville, WV 25275

DESIGNATED AGENT Carl E. Smith

ADDRESS P.O. Box 4
Sandyville, WV 25275

SURFACE OWNER Jack Hutchinson

ADDRESS P.O. Box 202
Sandyville, WV 25275

MINERAL RIGHTS OWNER see attached sheet

ADDRESS see attached sheet

OIL AND GAS INSPECTOR FOR THIS WORK Jerry

Tephabock ADDRESS Rt. 1, Box 100A, Ripley, WV

PERMIT ISSUED May 14, 1984

DRILLING COMMENCED May 21, 1984

DRILLING COMPLETED June 7, 1984

IF APPLICABLE: PLUGGING OF DRY HOLE ON
CONTINUOUS PROGRESSION FROM DRILLING OR
REWORKING. VERBAL PERMISSION OBTAINED
ON

Casing & Tubing	Used in Drilling	Left in Well	Cement fill up Cu. ft.
Size 20-16 Cond.			
11 3/4 13-18 "	272	272	125 sks.
9 5/8			
8 5/8	2508	2508	125 sks.
7			
5 1/2			
4 1/2	5876	1642	255 sks.
3			
2			
Liners used			

GEOLOGICAL TARGET FORMATION Newburg (plugged back to Brown Shale) Depth 5920 feet Rotary X / Cable Tools
Plug back T.D. 4920' G.

Depth of completed well 5920 feet

Water strata depth: Fresh ___ feet; Salt ___ feet

Coal seam depths: ___ Is coal being mined in the area? ___

OPEN FLOW DATA

Producing formation Huron Brown Shale Pay zone depth 3957-4238 feet

Gas: Initial open flow 25 Mcf/d Oil: Initial open flow -0- Bbl/d

Final open flow (20) Mcf/d Final open flow -0- Bbl/d

Time of open flow between initial and final tests 48 hours

Static rock pressure 980 psig (surface measurement) after 48 hours shut in
(If applicable due to multiple completion--)

Second producing formation ___ Pay zone depth ___ feet

Gas: Initial open flow ___ Mcf/d Oil: Initial open flow ___ Bbl/d

Final open flow ___ Mcf/d Oil: Final open flow ___ Bbl/d

Time of open flow between initial and final tests ___ hours

Static rock pressure ___ psig (surface measurement) after ___ hours shut in

DETAILS OF PERFORATED INTERVALS, FRACTURING OR STIMULATING, PHYSICAL CHANGE, ETC.

Plugged back from Newburg to 5820' G.L. to isolate formation. Then perforated the Oriskany from 5047 to 5053 with 24 shots and acidized with 300 gal. of 15% HCL acid. Very slight gas show. Plugged back to 4920'. Treated Brown Shale with 1,500,000 SCF of nitrogen.

WELL LOG

FORMATION	COLOR	HARD OR SOFT	TOP FEET	BOTTOM FEET	REMARKS Including indication of all fresh and salt water, coal, oil and gas
Big Lime			1704	1813	
Little Lime			1814	1944	
Big Injun			1945	1995	
Shale			1996	2410	
Berea			2411	2413	
Shale			2414	3956	
Brown Shale			3957	4238	
Shale			4239	4938	
Coniferous Lime			4939	5055	
Oriskany			5056	5113	
Shale			5114	5703	
Trenton ?			5704	5750	
Shale			5751	5899	
Newburg			5900	5903	
Shale			5904	5920 T.D.	

LOG TO 5885'

3957
2413

1544

(Attach separate sheets as necessary)

Carl E. Smith Petroleum, Inc.

Well Operator

By: Lucy D. Smith
Date: December 12, 1984

Note: Regulation 2.02(i) provides as follows:
"The term 'log' or 'well log' shall mean a systematic detailed geological record of all formations, including coal, encountered in the drilling of a well."



1) Date: May 8, 19 84
 2) Operator's Well No. 271
 3) API Well No. 47 - 035 - 1956
 State County Permit

STATE OF WEST VIRGINIA
 DEPARTMENT OF MINES, OIL AND GAS DIVISION
 APPLICATION FOR A WELL WORK PERMIT

- 4) WELL TYPE: A Oil / Gas X /
 B (If "Gas", Production X / Underground storage / Deep X / Shallow)
- 5) LOCATION: Elevation: 752' Watershed: Right Fork Sandy Creek
 District: Ravenswood County: Jackson Quadrangle:
- 6) WELL OPERATOR Carl E. Smith Petroleum, Inc. 7) DESIGNATED AGENT Carl E. Smith
 Address P.O. Box 4 Address P.O. Box 4
Sandyville, WV 25275-0004 Sandyville, WV 25275
- 8) OIL & GAS INSPECTOR TO BE NOTIFIED 9) DRILLING CONTRACTOR:
 Name Jerry Tephabock Name Carl E. Smith Petroleum, Inc.
 Address Rt. 1, Box 100A Address P.O. Box 4
Ripley, WV 25271 Sandyville, WV 25275-0004
- 10) PROPOSED WELL WORK: Drill X / Drill deeper / Redrill / Stimulate X
 Plug off old formation / Perforate new formation
 Other physical change in well (specify)
- 11) GEOLOGICAL TARGET FORMATION, Newburg
 12) Estimated depth of completed well, 6000 feet
 13) Approximate trata depths: Fresh, 150 feet; salt, 1725 feet.
 14) Approximate coal seam depths: unknown Is coal being mined in the area? Yes
- 15) CASING AND TUBING PROGRAM

RECEIVED
 MAY 9 - 1984
 OIL & GAS DIVISION
 DEPT. OF MINES

CASING OR TUBING TYPE	SPECIFICATIONS				FOOTAGE INTERVALS		CEMENT FILL-UP OR SACKS (Cubic feet)	PACKERS
	Size	Grade	Weight per ft.	New	Used	For drilling		
Conductor	11 3/4				X	250'	To Surface	Kinds
Fresh water								
Coal								Sizes
Intermediate	8 5/8				X	2500	125	
Production	5 1/2				X	To TD	125	Depths set
Tubing							or as required by Rule 15.01	
Liners								Perforations:
								Top Bottom

OFFICE USE ONLY
 DRILLING PERMIT

Permit number 47-035-1956 Date May 14, 19 84

This permit covering the well operator and well location shown below is evidence of permission granted to drill in accordance with the pertinent legal requirements subject to the conditions contained herein and on the reverse hereof. Notification must be given to the District Oil and Gas Inspector. (Refer to No. 8) Prior to the construction of roads, locations and pits for any permitted work. In addition, the well operator or his contractor shall notify the proper district oil and gas inspector 24 hours before actual permitted work has commenced.)

The permitted work is as described in the Notice and Application, plat, and reclamation plan, subject to any modifications and conditions specified on the reverse hereof.

Permit expires May 14, 1986 unless well work is commenced prior to that date and prosecuted with due diligence.

BANKET	Agent: <u>[Signature]</u>	Plat: <u>[Signature]</u>	Casing: <u>[Signature]</u>	Fee: <u>7654</u>
---------------	---------------------------	--------------------------	----------------------------	------------------

[Signature]
 Administrator, Office of Oil and Gas

NOTE: Keep one copy of this permit posted at the drilling location.