

SURFACE HOLE	
STATE PLANE WV NORTH/SOUTH ZONE NAD 1927 N - 709,107.37 : E - 1,821,869.25	
LATITUDE: (N) 38.9456727 LONGITUDE: (W) 81.6262659	
UTM, NAD83 17 - 84W TO 78W, METERS N - 4,310,943.291 : E - 445,742.010	
BOTTOM HOLE	
STATE PLANE WV NORTH/SOUTH ZONE NAD 1927 N - 706,576.93 : E - 1,823,480.74	
LATITUDE: (N) 38.9387550 LONGITUDE: (W) 81.6205409	
UTM, NAD83 17 - 84W TO 78W, METERS N - 4,310,172.258 : E - 446,232.925	

( + ) DENOTES LOCATION OF WELL ON UNITED STATES TOPOGRAPHIC MAPS

FILE NO. HR-418A.DGN

DRAWING NO. HR-418A

SCALE 1" = 1000'

MINIMUM DEGREE OF ACCURACY 1:200

PROVEN SOURCE OF ELEVATION MAPPING GRADE GPS

I, THE UNDERSIGNED, HEREBY CERTIFY THAT THIS PLAT IS CORRECT TO THE BEST OF MY KNOWLEDGE AND BELIEF AND SHOWS ALL THE INFORMATION REQUIRED BY LAW AND THE REGULATIONS ISSUED AND PRESCRIBED BY THE DEPARTMENT OF ENVIRONMENTAL PROTECTION.

(SIGNED) Paul E. Miller

R.P.E. \_\_\_\_\_ L.L.S. 647

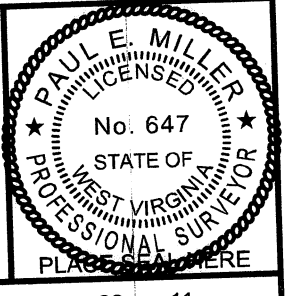

STATE OF WEST VIRGINIA  
DIVISION OF ENVIRONMENTAL PROTECTION  
OIL AND GAS DIVISION



DATE OCTOBER 14 REV. 20 11

OPERATOR'S WELL NO. HR-418A

API WELL NO. \_\_\_\_\_

WELL TYPE: OIL \_\_\_ GAS X LIQUID INJECTION \_\_\_ WASTE DISPOSAL \_\_\_  
(IF "GAS,") PRODUCTION X STORAGE \_\_\_ DEEP \_\_\_ SHALLOW X

LOCATION: ELEVATION 610' WATER SHED LEFT FORK OF SANDY CREEK

DISTRICT RAVENSWOOD COUNTY JACKSON

QUADRANGLE SANDYVILLE, WV 7.5'

SURFACE OWNER JOHN MORGAN ACREAGE 179.92

OIL & GAS ROYALTY OWNER John Morgan LEASE ACREAGE 179.92

LEASE NO. \_\_\_\_\_

PROPOSED WORK: DRILL X CONVERT \_\_\_ DRILL DEEPER \_\_\_ REDRILL \_\_\_ FRACTURE OR STIMULATE X PLUG OFF OLD FORMATION \_\_\_ PERFORATE NEW FORMATION \_\_\_ OTHER PHYSICAL CHANGE IN WELL (SPECIFY) \_\_\_\_\_

PLUG AND ABANDON \_\_\_ CLEAN OUT AND REPLUG \_\_\_

TARGET FORMATION LOWER HURON ESTIMATED DEPTH \_\_\_\_\_

WELL OPERATOR HARD ROCK EXPLORATION, INC. DESIGNATED AGENT JAMES L. STEPHENS

ADDRESS 1244 MARTINS BR. RD., CHARLESTON, WV 25312 ADDRESS SAME

FORM WW-6

COUNTY NAME

PERMIT



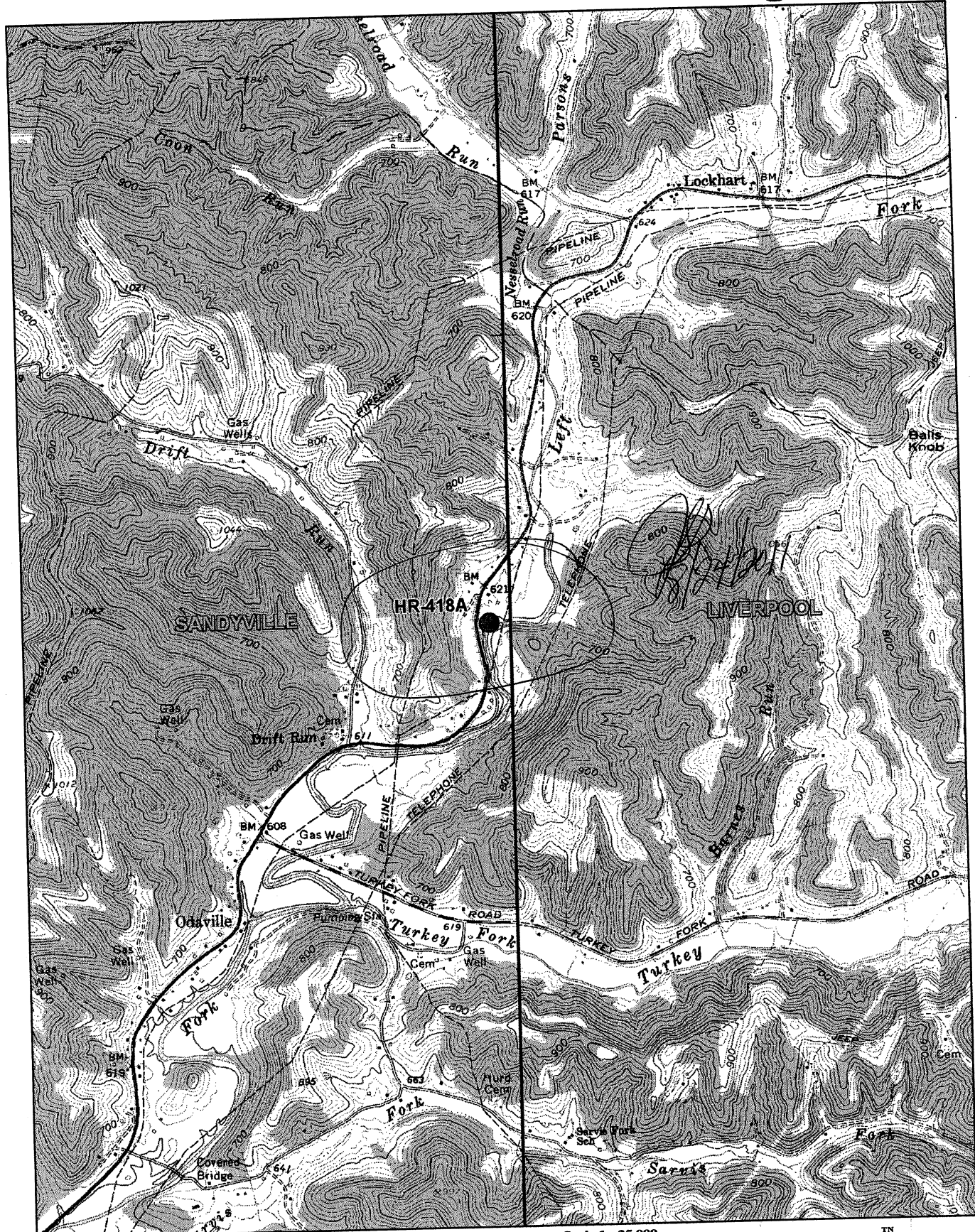

Scale 1 : 25,000  
 1" = 2,083 ft

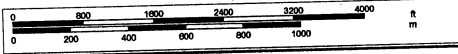

**DE LORME**

© 2001 DeLorme. XMap®. Data copyright of content owner.  
 Zoom Level: 13-0 Datum: NAD27