



---

**west virginia** department of environmental protection

---

Office of Oil and Gas  
601 57th Street SE  
Charleston, WV 25304  
(304) 926-0450  
(304) 926-0452 fax

Earl Ray Tomblin, Governor  
Randy C. Huffman, Cabinet Secretary  
www.dep.wv.gov

June 11, 2013

**WELL WORK PERMIT**

**Vertical Well**

This permit, API Well Number: 47-3503015, issued to HILDRETH, ROY G., JR. & SON, is evidence of permission granted to perform the specified well work at the location described on the attached pages and located on the attached plat, subject to the provisions of Chapter 22 of the West Virginia Code of 1931, as amended, and all rules and regulations promulgated thereunder, and to all conditions and provisions outlined in the pages attached hereto. Notification shall be given by the operator to the Oil and Gas Inspector at least 24 hours prior to the construction of roads, locations, and/or pits for any permitted work. In addition, the well operator shall notify the same inspector 24 hours before any actual well work is commenced and prior to running and cementing casing. Spills or emergency discharges must be promptly reported by the operator to 1-800-642-3074 and to the Oil and Gas inspector.

Please be advised that form WR-35, Well Operators Report of Well Work is to be submitted to this office within 90 days completion of permitted well work, as should form WR-34 Discharge Monitoring Report within 30 days of discharge of pits, if applicable. Failure to abide by all statutory and regulatory provisions governing all duties and operations hereunder may result in suspension or revocation of this permit and, in addition, may result in civil and/or criminal penalties being imposed upon the operators.

In addition to the applicable requirements of this permit, and the statutes and rules governing oil and gas activity in WV, this permit may contain specific conditions which must be followed. Permit conditions are attached to this cover letter.

Per 35CSR-4-5.2.g this permit will expire in two (2) years from the issue date unless permitted well work is commenced. If there are any questions, please feel free to contact me at (304) 926-0499 ext. 1654.



James Martin  
Chief

Operator's Well No: C.S. MCCARTY #22  
Farm Name: VALENTINE, BURL H. & KATHLI  
**API Well Number: 47-3503015**  
**Permit Type: Vertical Well**  
Date Issued: 06/11/2013

Promoting a healthy environment.

06/14/2013

STATE OF WEST VIRGINIA  
DEPARTMENT OF ENVIRONMENTAL PROTECTION, OFFICE OF OIL AND GAS  
WELL WORK PERMIT APPLICATION

1) Well Operator: ROY G. HILDRETH AND SON, INC. 307492 JACKSON RAVENSWOOD LIVERPOOL  
Operator ID County District Quadrangle

2) Operator's Well Number: C. S. MCCARTY #22 3) Elevation: 1000'

4) Well Type: (a) Oil  or Gas \_\_\_\_\_  
 (b) If Gas: Production  / Underground Storage \_\_\_\_\_  
 Deep \_\_\_\_\_ / Shallow

5) Proposed Target Formation(s): BEREA Proposed Target Depth: 2665'  
 6) Proposed Total Depth: 2850' Feet Formation at Proposed Total Depth: BEREA  
 7) Approximate fresh water strata depths: 100', PITTSBURG 740 - 880'  
 8) Approximate salt water depths: SALT SAND 2080 - 2180'

9) Approximate coal seam depths: NONE REPORTED

10) Approximate void depths,(coal, Karst, other): NONE KNOWN

11) Does land contain coal seams tributary to active mine? NO

12) Describe proposed well work and fracturing methods in detail (attach additional sheets if needed)  
DRILL NEW BEREA WELL AND STIMULATE WITH X-LINK/SAND OR FOAM/SAND

*Sample 5/11/2013*

13) **CASING AND TUBING PROGRAM**

TYPE	SPECIFICATIONS			FOOTAGE	INTERVALS	CEMENT
	Size	Grade	Weight per ft			
Conductor	11 3/4	LS	42#	30'	PULLED	
Fresh Water	8 5/8	LS	28#	985'	985'	CTS + 30% EXCESS
Coal						
Intermediate						
Production	4 1/2		11.6 LBS	2800'	2800'	201 CU FT (ABOVE SALT SAND)
Tubing						
Liners						

*OK*

Received  
Office of Oil & Gas

MAY 13 2013

Packers: Kind: \_\_\_\_\_  
 Sizes: \_\_\_\_\_  
 Depths Set \_\_\_\_\_

3503015

WW-2A  
(Rev. 6-07)

1.) Date: APRIL 24, 2013  
2.) Operator's Well Number C. S. MCCARTY #22  
State County Permit  
3.) API Well No.: 47- 035 -

STATE OF WEST VIRGINIA  
DEPARTMENT OF ENVIRONMENTAL PROTECTION, OFFICE OF OIL AND GAS  
NOTICE AND APPLICATION FOR A WELL WORK PERMIT

Check # 31592  
\$1,950.00

4) Surface Owner(s) to be served:  
(a) Name Valentine Family Trust  
Address Kathryn Sue Moore Trustee  
2139 Dutch Ridge Road  
Address Parkersburg, WV 26104  
(b) Name \_\_\_\_\_  
Address \_\_\_\_\_  
(c) Name \_\_\_\_\_  
Address \_\_\_\_\_  
5) (a) Coal Operator  
Name \_\_\_\_\_  
Address \_\_\_\_\_  
(b) Coal Owner(s) with Declaration  
Name \_\_\_\_\_  
Address \_\_\_\_\_  
(c) Coal Lessee with Declaration  
Name \_\_\_\_\_  
Address \_\_\_\_\_  
6) Inspector JAMIE STEVENS  
Address HC 62 - BOX 1C  
KENNA, WV 25248  
Telephone 304-206-7775

**TO THE PERSONS NAMED ABOVE TAKE NOTICE THAT:**

Included is the lease or leases or other continuing contract or contracts by which I hold the right to extract oil and gas  
**OR**

Included is the information required by Chapter 22, Article 6, Section 8(d) of the Code of West Virginia (see page 2)

I certify that as required under Chapter 22-6 of the West Virginia Code I have served copies of this notice and application, a location plat, and accompanying documents pages 1 through \_\_\_ on the above named parties by:

- Personal Service (Affidavit attached)
- Certified Mail (Postmarked postal receipt attached)
- Publication (Notice of Publication attached)

I have read and understand Chapter 22-6 and 35 CSR 4, and I agree to the terms and conditions of any permit issued under this application.

I certify under penalty of law that I have personally examined and am familiar with the information submitted on this application form and all attachments, and that based on my inquiry of those individuals immediately responsible for obtaining the information, I believe that the information is true, accurate and complete.

I am aware that there are significant penalties for submitting false information, including the possibility of fine and

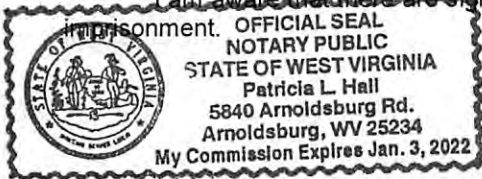

Well Operator ROY G. HILDRETH AND SON, INC.  
By: [Signature]  
Its: JOHN R. HILDRETH, SECRETARY  
Address P. O. BOX 1007  
SPENCER, WV 25276  
Telephone 304-927-2130

Received  
Office of Oil & Gas

Subscribed and sworn before me this 24TH day of APRIL, 2013

Patricia L. Hall Notary Public

My Commission Expires January 3, 2022

Oil and Gas Privacy Notice

The Office of Oil and Gas processes your personal information, such as name, address and phone number, as a part of our regulatory duties. Your personal information may be disclosed to other State agencies or third parties in the normal course of business or as needed to comply with statutory or regulatory requirements, including Freedom of Information Act requests. Our office will appropriately secure your personal information. If you have any questions about our use of your personal information, please contact DEP's Chief Privacy Officer at [depprivacyofficer@wv.gov](mailto:depprivacyofficer@wv.gov)

06/14/2013

3503015

WW-2A1  
(Rev. 1/11)

Operator's Well Number C. S. MCCARTY #22

**INFORMATION SUPPLIED UNDER WEST VIRGINIA CODE  
Chapter 22, Article 6, Section 8(d)  
IN LIEU OF FILING LEASE(S) AND OTHER CONTINUING CONTRACT(S)**

Under the oath required to make the verification on page 1 of this Notice and Application, I depose and say that I am the person who signed the Notice and Application for the Applicant, and that –

- (1) the tract of land is the same tract described in this Application, partly or wholly depicted in the accompanying plat, and described in the Construction and Reclamation Plan;
- (2) the parties and recordation data (if recorded) for lease(s) or other continuing contract(s) by which the Applicant claims the right to extract, produce or market the oil or gas are as follows:

Grantor, Lessor, etc.	Grantee, Lessee, etc.	Royalty	Book/Page
East West Resources Inc. Daniel and Richard Moore, d/b/a Summit Energy	Krakrow, Inc.	WI	247/903
		RI 1/8	<del>B</del> 18/99
Krakrow, Inc.	Roy G. Hildreth and Son, Inc.	Agreement Attached	

**Acknowledgement of Possible Permitting/Approval  
In Addition to the Office of Oil and Gas**

The permit applicant for the proposed well work addressed in this application hereby acknowledges the possibility of the need for permits and/or approvals from local, state, or federal entities in addition to the DEP, Office of Oil and Gas, including but not limited to the following:

Received  
Office of Oil & Gas

- WV Division of Water and Waste Management
- WV Division of Natural Resources
- WV Division of Highways
- U.S. Army Corps of Engineers
- U.S. Fish and Wildlife Service
- County Floodplain Coordinator

The applicant further acknowledges that any Office of Oil and Gas permit in no way overrides, replaces, or nullifies the need for other permits/approvals that may be necessary and further affirms that all needed permits/approvals should be acquired from the appropriate authority before the affected activity is initiated.

Well Operator: \_\_\_\_\_  
 By: Its: Jon R. Wilkotte  
 \_\_\_\_\_  
 JON R. HILDRETH, SECRETARY

06/14/2013

AGREEMENT

THIS AGREEMENT made this 1st day of June, 2007, by and between Krakrow, Inc., a West Virginia Corporation, as Lessor and Roy G. Hildreth & Son, Inc., a West Virginia Corporation, as Lessee, in which the Krakrow, Inc. hereby states that they are giving Roy G. Hildreth & Son, Inc. right to drill and operate on their said C. S. McCarty Lease, 235 Acres, on the waters of Buck Run, Ravenswood District, Jackson County, West Virginia.

WITNESS the following signatures and seals:

Krakrow, Inc.

By: [Signature]  
Jon R. Hildreth, President

Roy G. Hildreth and Son, Inc.

By: [Signature]  
Roy G. Hildreth, President

STATE OF WEST VIRGINIA,  
COUNTY OF ROANE, to-wit:

I, TERRI A. McMILLAN, a notary public within and for said county and state aforesaid, do hereby certify that Jon R. Hildreth, whose name is signed to the foregoing writing, bearing the 1st day of June, 2007, on behalf of Krakrow, Inc, as its President has this day, in my said county, before me, acknowledged said writing.

Given under my hand this 1st day of June, 2007.

My commission expires: August 11, 2013

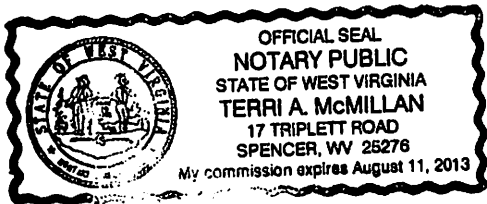

[Signature]  
NOTARY PUBLIC

STATE OF WEST VIRGINIA,  
COUNTY OF ROANE, to-wit:

I, TERRI A. McMILLAN, a notary public within and for said county and state aforesaid, do hereby certify that Roy G. Hildreth, whose name is signed to the foregoing writing, bearing the 1st day of June, 2007, on behalf of Roy G. Hildreth and Son, Inc., as its President has this day, in my said county, before me, acknowledged said writing to be the act and deed of said corporation.

Given under my hand this 1st day of June, 2007.

My commission expires: August 11, 2013

Received  
Office of Oil & Gas

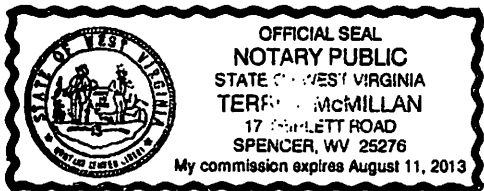

[Signature]  
NOTARY PUBLIC

06/14/2013

3903015

WW-2B1  
(5-12)

Well No. C. S. MCCARTY #22

West Virginia Department of Environmental Protection  
Office of Oil and Gas

NOTICE TO SURFACE OWNERS

The well operator named below is preparing to file for a permit from the state to drill a new well. Before a well work permit can be filed with the Chief of the Office of Oil and Gas, the well operator is required to have given notice of the right to request water well or spring analytical testing. This notice shall be given to the owners or occupants of land which have a water well or spring being utilized for human consumption, domestic animals, or other general use and which is located within 1000 feet of the proposed well site.

With this form, the operator is giving you notice of your right to request analytical testing. The operator is required to sample and analyze the water wells or springs of all owners or occupants who request it. Therefore, if you wish to have your water well or spring tested, contact the operator named below.

All sampling shall be completed prior to drilling. Within thirty (30) days of the receipt of such sample analyses the operator shall submit the results to the Chief of the Office of Oil and Gas and to the owners or occupants who may have requested them.

Be advised, you have the right to sample and analyze any water supply at your own expense.

Listed below is the laboratory chosen by operator to perform analysis, and contactor chosen to collect sample.

Certified Laboratory Name REIC LABORATORY P. O. BOX 286, BEAVER, WV 25813  
Sampling Contractor ROY G. HILDRETH AND SON, INC.

Well Operator ROY G. HILDRETH AND SON, INC.  
Address P. O. BOX 1007  
SPENCER, WV 25276  
Telephone 304-927-2130

FOR OPERATOR'S USE ONLY: Below, or on an attached page, list those persons which were given this notice. Place an asterisk beside the one(s) that contacted you and requested sampling and analyses. If there were no requests made, indicate by underling which one you have selected to sample and analyze. If there are no water wells or springs within 1000 feet of the proposed site, the Chief may require the operator to test wells up to 2000 feet from the proposed site.

SEE ATTACHED

Closest  
Water Well  
1500' Testers  
zero' JHS

Received  
Office of Oil & Gas

06/14/2013

3503015

**ATTACHMENT TO FORM WW-2B1**

W-12 ABANDONED HOUSE - VALENTINE

DUG WELL

W-13 ABANDONED HOUSE - VALENTINE

CAN NOT LOCATE A WELL, UNSURE  
IF ONE EXISTS

W-14 GEORGE CHANDLER HOUSE

APPEARS TO BE A DRILLED WELL

W-15 FRANCIS BROTHERS - HUNTING CAMP

DRILLED WELL

W-16 HOUSE ACROSS FROM FRANCIS BROTHERS - MARTIN

UNSURE OF WELL TYPE

W-17 GEORGE CHANDLER-OLD HOUSE SITE

DRILLED WELL

W-18 GEORGE CHANDLER-OLD HOUSE SITE

DUG WELL

W-19 WADE FARM

DUG WELL

VALENTINE - SURFACE OWNER ON LEASE  
GEORGE A. CHANDLER 273 CLARY ROAD, SPENCER, WV 25276  
FRANCIS BROTHERS RT. BOX 5A, LEROY, WV 25252  
CARL MARTIN 4701 HARTLEY RUN RD, LEROY, WV 25252  
DARRELL WADE 68 HECK STREET, LEROY, WV 25252

Received  
Office of Oil & Gas

06/14/2013

3503015

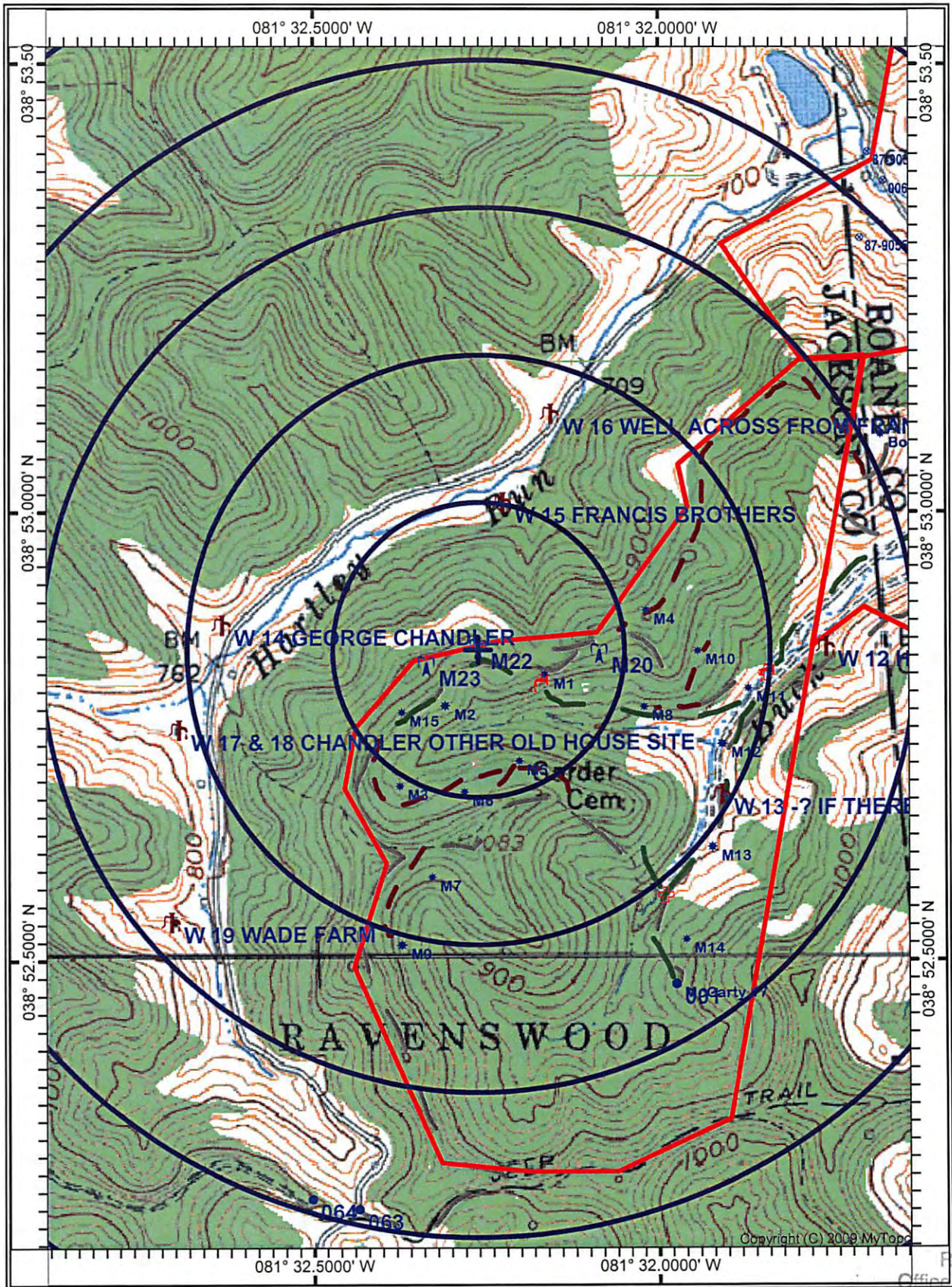

Copyright (C) 2009 MyTopo

Received Office of Oil & Gas

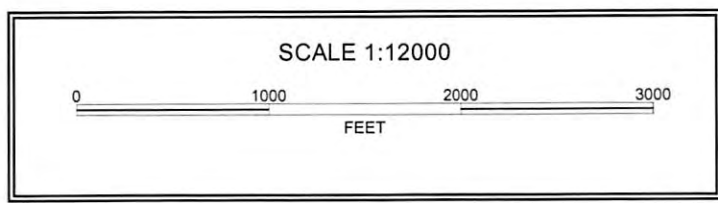









MAY 16 2013

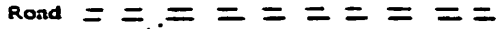
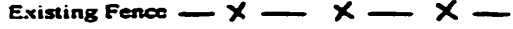



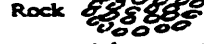

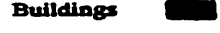

06/14/2013



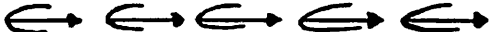

LEGEND

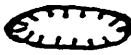
- Property Boundary 
- Road 
- Existing Fence 
- Planned Fence 
- Stream 
- Open Ditch 
- Rock 
- North 
- Buildings 
- Water wells 
- Drill site 

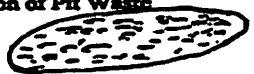
- Diversion 
- Spring 
- Wet Spot 
- Drain Pipe with size in inches 
- Waterway 
- Cross Drain 
- Artificial Filter Strip 
- Pit: cut walls 
- Pit: compacted fill walls 
- Area for Land Application of Pit Waste 

Proposed Revegetation Treatment: Acres Disturbed 3 Prevegetation pH 5.5  
 Lime 3 Tons/acre or to correct to pH 6.5  
 Fertilizer (10-20-20 or equivalent) 0.25 lbs/acre (500 lbs minimum)  
 Mulch HAY 2 Tons/acre

Seed Mixtures

Area I		Area II	
Seed Type	lbs/acre	Seed Type	lbs/acre
ORCHARD GRASS	25	LADINO CLOVER	5
RED TOP CLOVER	15	KY 31	40
ANNUAL RHY	15	ANNUAL RHY	15

Attach: Drawing(s) of road, location, pit and proposed area for land application.

Photocopied section of involved 7.5' topographic sheet.

Received Office of Oil & Gas

Plan Approved by: *Jimmie Stevens*  
 Comments: \_\_\_\_\_

Title: \_\_\_\_\_ Date: 5/1/2013  
 Field Reviewed?  Yes  No

NOTE;

Any Trees 6" or larger in Diameter will be cut and piled. Brush will be used as Sediment Barriers. Temporary seed and mulch all slopes upon construction. Stone over all Culverts.

McCARTY #22

PIT SIZE: 25'X80' +/-  
LOCATION SIZE: 100'X200' +/-

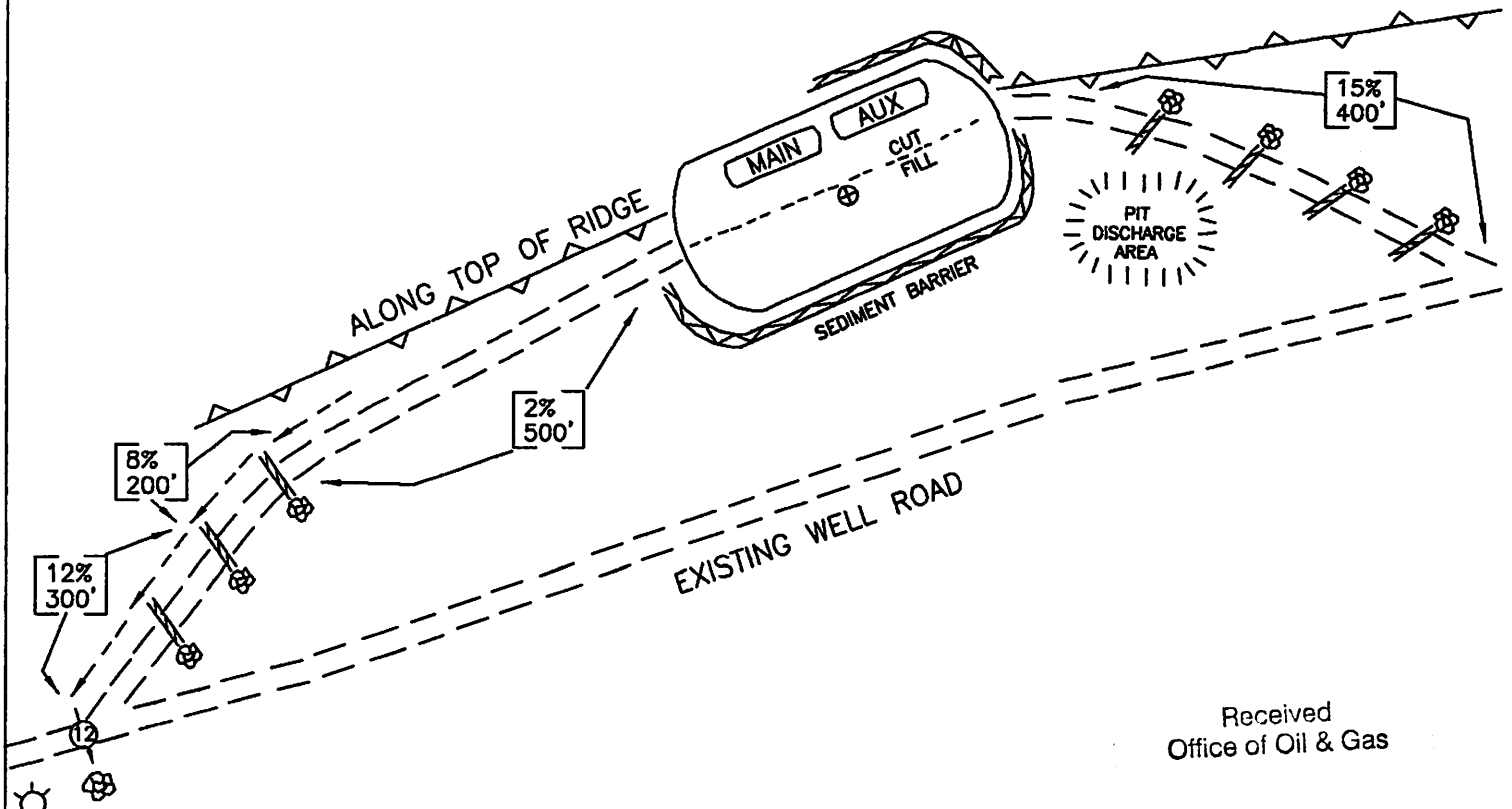

Received  
Office of Oil & Gas

May 14 2013

McCARTY #15

*Jamie Stevens*  
5/1/2013

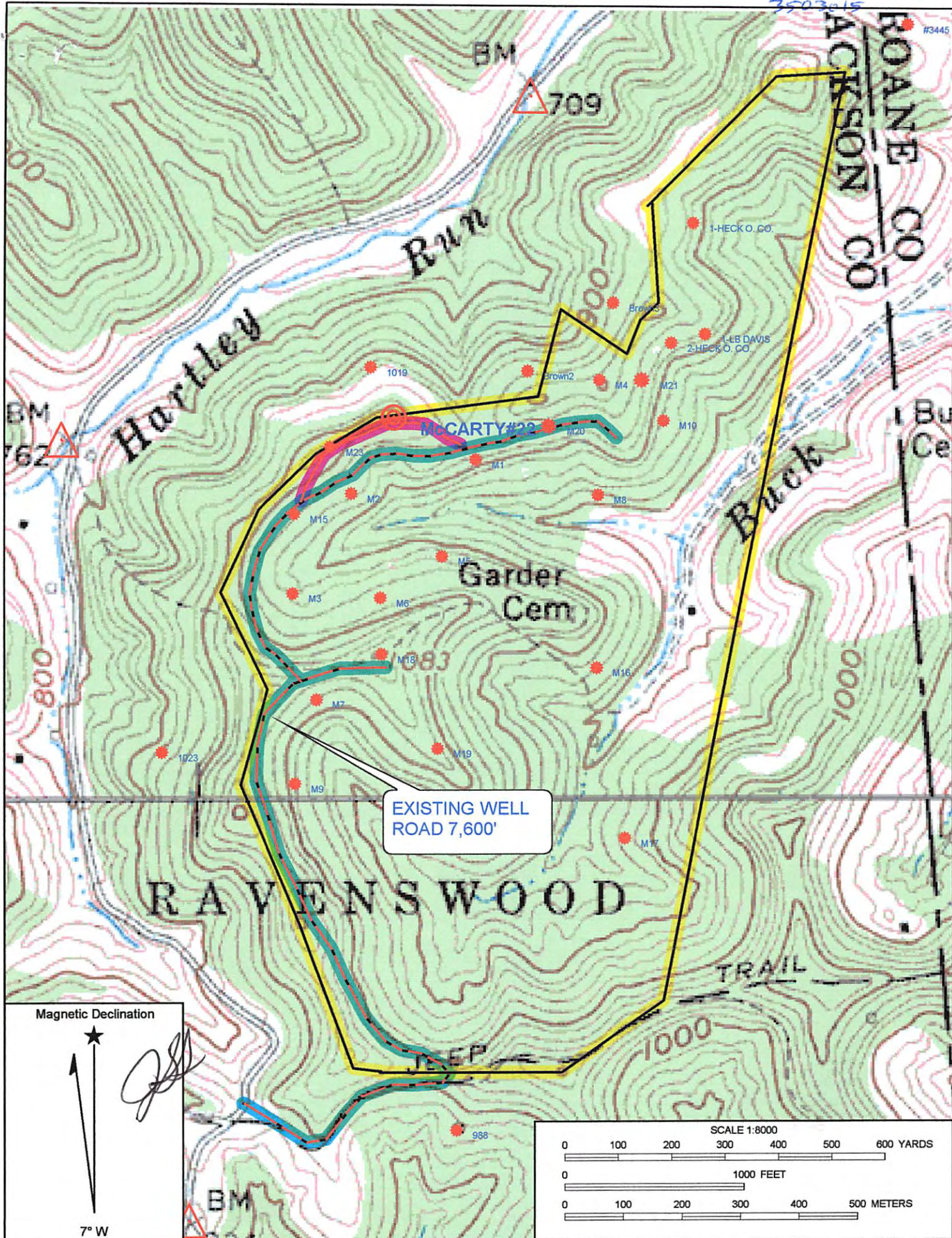

EXISTING WELL  
ROAD 7,600'

Magnetic Declination

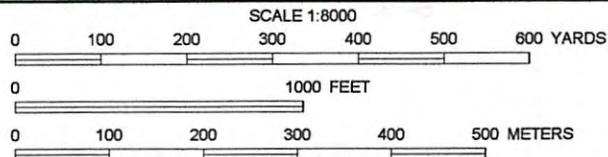

LINE	BEARING	DISTANCE
L1	S 88°00'00" W	464.76'
L2	N 83°45'00" W	348.56'
L3	N 84°00'00" W	369.19'
L4	N 18°00'00" E	570.90'
L5	N 26°00'00" W	534.60'
L6	N 21°00'00" E	511.50'
L7	N 48°00'00" E	346.50'
L8	N 61°00'00" E	399.30'
L9	N 81°00'00" E	999.90'
L10	N 13°00'00" E	495.00'
L11	S 53°00'00" E	464.08'
L12	N 26°30'00" E	174.90'
L13	N 47°00'00" E	143.05'
L14	NORTH	582.95'
L15	N 38°30'00" E	181.5'
L16	N 53°00'00" E	313.50'
L17	N 47°00'00" E	594.00'
L18	N 82°30'00" E	343.20'

LATITUDE 38°55'00"  
 UTM COORD.  
 NAD 83  
 ZONE 17  
 0453372E  
 4303896N

NORTH

LONGITUDE 81°30'00"

12,925'

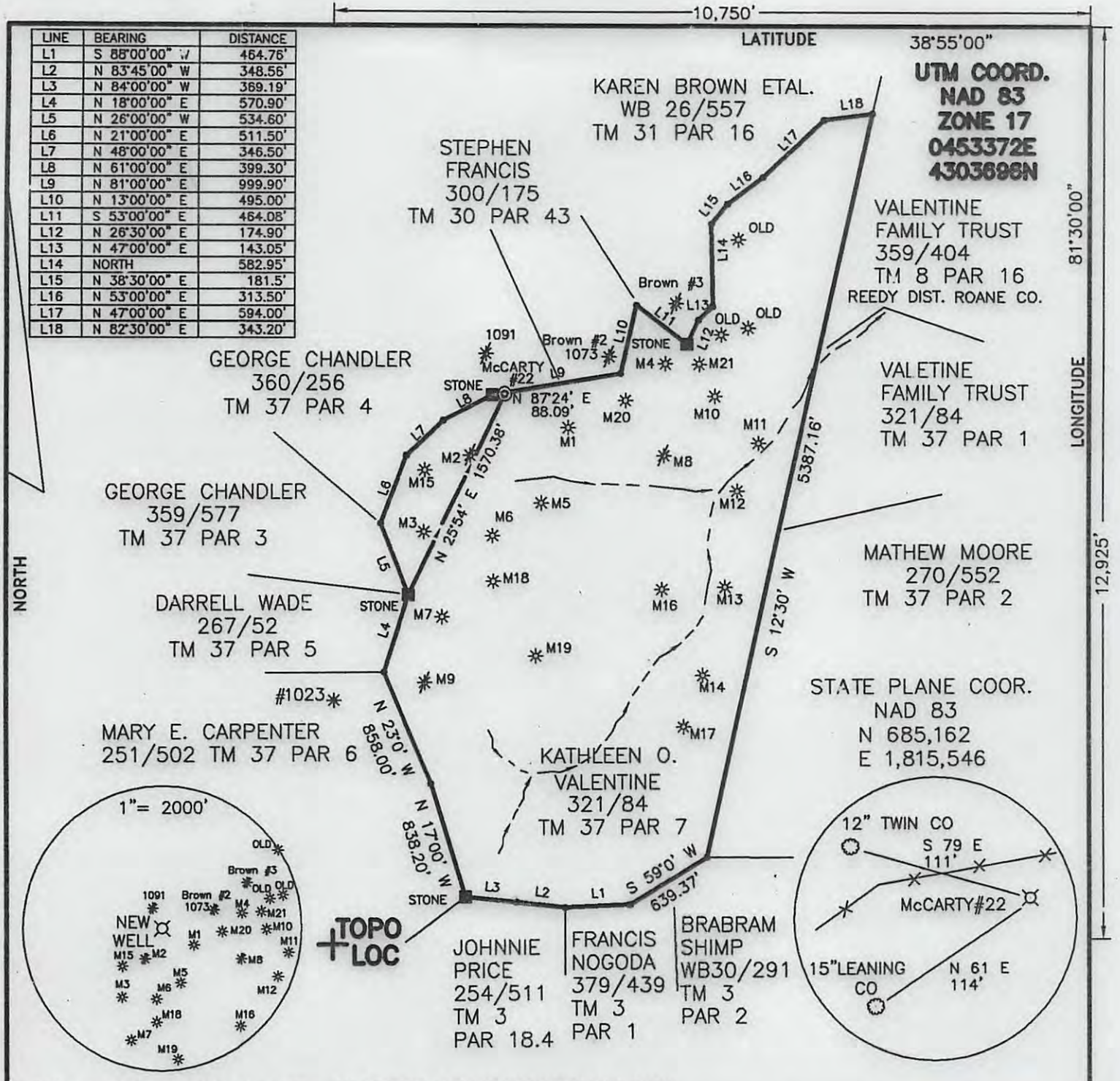

(+) DENOTES LOCATION OF WELL ON UNITED STATES TOPOGRAPHIC MAPS

FILE NO. \_\_\_\_\_  
 DRAWING NO. 13-12  
 SCALE 1"=1000'  
 MINIMUM DEGREE OF ACCURACY 1 IN 200  
 PROVEN SOURCE OF ELEVATION GPS

I THE UNDERSIGNED, HEREBY CERTIFY THAT THIS PLAT IS CORRECT TO THE BEST OF MY KNOWLEDGE AND BELIEF AND SHOWS ALL THE INFORMATION REQUIRED BY LAW AND THE REGULATIONS ISSUED AND PRESCRIBED BY THE DEPARTMENT OF ENERGY.  
 (SIGNED) \_\_\_\_\_  
 R.P.E. \_\_\_\_\_ L.L.S. 851



STATE OF WEST VIRGINIA  
 Division of Environmental Protection  
 OFFICE OF OIL AND GAS

DATE 4/18, 2013  
 OPERATOR'S WELL NO. McCARTY#22  
 API WELL NO. 47-035-03015  
 STATE COUNTY PERMIT

WELL TYPE: OIL  GAS  LIQUID INJECTION \_\_\_\_\_ WASTE DISPOSAL \_\_\_\_\_  
 (IF "GAS") PRODUCTION  STORAGE \_\_\_\_\_ DEEP \_\_\_\_\_ SHALLOW

LOCATION: ELEVATION 1000 WATER SHED BUCK RUN OF RIGHT FORK OF SANDY CREEK  
 DISTRICT RAVENSWOOD COUNTY JACKSON  
 QUADRANGLE LIVERPOOL

SURFACE OWNER BURL H. & KATHLEEN O. VALENTINE ACREAGE 235  
 OIL & GAS ROYALTY OWNER KATHLEEN O. VALENTINE LEASE ACREAGE 235  
 LEASE NO. \_\_\_\_\_

PROPOSED WORK: DRILL  CONVERT \_\_\_\_\_ DRILL DEEPER \_\_\_\_\_ REDRILL \_\_\_\_\_ FRACTURE OR  
 STIMULATE  PLUG OFF OLD FORMATION \_\_\_\_\_ PERFORATE NEW  
 FORMATION \_\_\_\_\_ OTHER PHYSICAL CHANGE IN WELL (SPECIFY): \_\_\_\_\_

PLUG AND ABANDON \_\_\_\_\_ CLEAN OUT AND REPLUG \_\_\_\_\_  
 TARGET FORMATION BEREA ESTIMATED DEPTH 2850  
 WELL OPERATOR ROY G. HILDRETH & SON DESIGNATED AGENT ROY G. HILDRETH JR.  
 ADDRESS PO BOX 1007 ADDRESS PO BOX 1007  
 SPENCER, WV 25276 SPENCER, WV 25276

06/14/2013

3503015

LINE	BEARING	DISTANCE
L1	S 88°00'00" W	464.76'
L2	N 83°45'00" W	348.56'
L3	N 84°00'00" W	369.19'
L4	N 18°00'00" E	570.90'
L5	N 26°00'00" W	534.60'
L6	N 21°00'00" E	511.50'
L7	N 48°00'00" E	346.50'
L8	N 61°00'00" E	399.30'
L9	N 81°00'00" E	999.90'
L10	N 13°00'00" E	495.00'
L11	S 53°00'00" E	464.08'
L12	N 26°30'00" E	174.90'
L13	N 47°00'00" E	143.05'
L14	NORTH	582.95'
L15	N 38°30'00" E	181.5'
L16	N 53°00'00" E	313.50'
L17	N 47°00'00" E	594.00'
L18	N 82°30'00" E	343.20'

NORTH

10,750'

LATITUDE

38°55'00"

**UTM COORD.**  
**NAD 83**  
**ZONE 17**  
**0453372E**  
**4303696N**

81°30'00"

LONGITUDE

12,925'

KAREN BROWN ETAL.  
 WB 26/557  
 TM 31 PAR 16

STEPHEN FRANCIS  
 300/175  
 TM 30 PAR 43

VALENTINE FAMILY TRUST  
 359/404  
 TM 8 PAR 16  
 REEDY DIST. ROANE CO.

VALENTINE FAMILY TRUST  
 321/84  
 TM 37 PAR 1

MATHEW MOORE  
 270/552  
 TM 37 PAR 2

STATE PLANE COOR.  
 NAD 83  
 N 685,162  
 E 1,815,546

KATHLEEN O. VALENTINE  
 321/84  
 TM 37 PAR 7

JOHNNIE PRICE  
 254/511  
 TM 3 PAR 18.4

FRANCIS NOGODA  
 379/439  
 TM 3 PAR 1

BRABRAM SHIMP  
 WB30/291  
 TM 3 PAR 2

GEORGE CHANDLER  
 360/256  
 TM 37 PAR 4

GEORGE CHANDLER  
 359/577  
 TM 37 PAR 3

DARRELL WADE  
 267/52  
 TM 37 PAR 5

MARY E. CARPENTER  
 251/502 TM 37 PAR 6

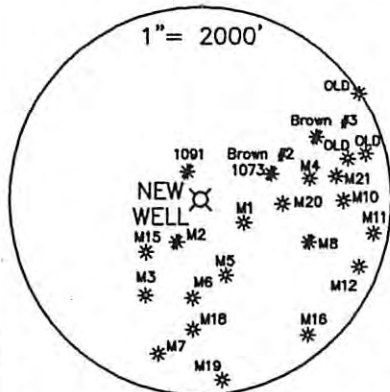

TOPO LOC

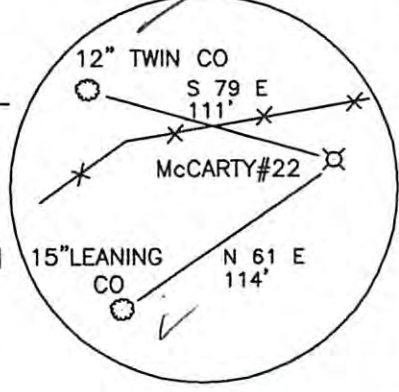

(+) DENOTES LOCATION OF WELL ON UNITED STATES TOPOGRAPHIC MAPS

FILE NO. \_\_\_\_\_  
 DRAWING NO. 13-12  
 SCALE 1"=1000'  
 MINIMUM DEGREE OF ACCURACY 1 IN 200  
 PROVEN SOURCE OF ELEVATION GPS

I THE UNDERSIGNED, HEREBY CERTIFY THAT THIS PLAT IS CORRECT TO THE BEST OF MY KNOWLEDGE AND BELIEF AND SHOWS ALL THE INFORMATION REQUIRED BY LAW AND THE REGULATIONS ISSUED AND PRESCRIBED BY THE DEPARTMENT OF ENERGY.  
 (SIGNED) \_\_\_\_\_  
 R.P.E. \_\_\_\_\_ L.L.S. 851



STATE OF WEST VIRGINIA  
 Division of Environmental Protection  
 OFFICE OF OIL AND GAS

DATE 4/18, 2013  
 OPERATOR'S WELL NO. McCARTY#22  
 API WELL NO. 47 - 035 - 03015  
 STATE WV COUNTY JACKSON PERMIT 03015

WELL TYPE: OIL  GAS  LIQUID INJECTION \_\_\_\_\_ WASTE DISPOSAL \_\_\_\_\_  
 (IF "GAS") PRODUCTION  STORAGE \_\_\_\_\_ DEEP \_\_\_\_\_ SHALLOW

LOCATION: ELEVATION 1000 WATER SHED BUCK RUN OF RIGHT FORK OF SANDY CREEK  
 DISTRICT RAVENSWOOD COUNTY JACKSON  
 QUADRANGLE LIVERPOOL

SURFACE OWNER BURL H. & KATHLEEN O. VALENTINE ACREAGE 235  
 OIL & GAS ROYALTY OWNER KATHLEEN O. VALENTINE LEASE ACREAGE 235  
 LEASE NO. \_\_\_\_\_

PROPOSED WORK: DRILL  CONVERT \_\_\_\_\_ DRILL DEEPER \_\_\_\_\_ REDRILL \_\_\_\_\_ FRACTURE OR STIMULATE  PLUG OFF OLD FORMATION \_\_\_\_\_ PERFORATE NEW FORMATION \_\_\_\_\_ OTHER PHYSICAL CHANGE IN WELL (SPECIFY): \_\_\_\_\_

PLUG AND ABANDON \_\_\_\_\_ CLEAN OUT AND REPLUG \_\_\_\_\_

TARGET FORMATION BEREA ESTIMATED DEPTH 2850

WELL OPERATOR ROY G. HILDRETH & SON DESIGNATED AGENT ROY G. HILDRETH JR.  
 ADDRESS PO BOX 1007 ADDRESS PO BOX 1007  
SPENCER, WV 25276 SPENCER, WV 25276

**06/14/2013**