

LATITUDE 38°50'

81°30'

LONGITUDE

No Elev. Available (Approximately 800' Topo, Elev.)

CASING:

13" @ 16'

10" @ 630'

8" @ 1010'

6" @ 2005'

NO COAL

GAS 2378-94

SALT WATER @ 1589

T.D. 2404'



2.71 S 38°50'

1.77 W 81°30'

Abd. Permit Issued 3-10-32

7'5 OGIS topo location

SEE PLAT 121-A (ATTACHED)

7.5' LOC _____

15' LOC _____
(calc.) _____

Company JEFF Miller, et al.

Farm A.V. PARSONS #2

Quad Gay 7.5'; Ripley 15' SE

County JACKSON

District WASHINGTON

WELL LOCATION MAP

File No. JAC-19-A

Gay (163)

38° 50'

81° 30'

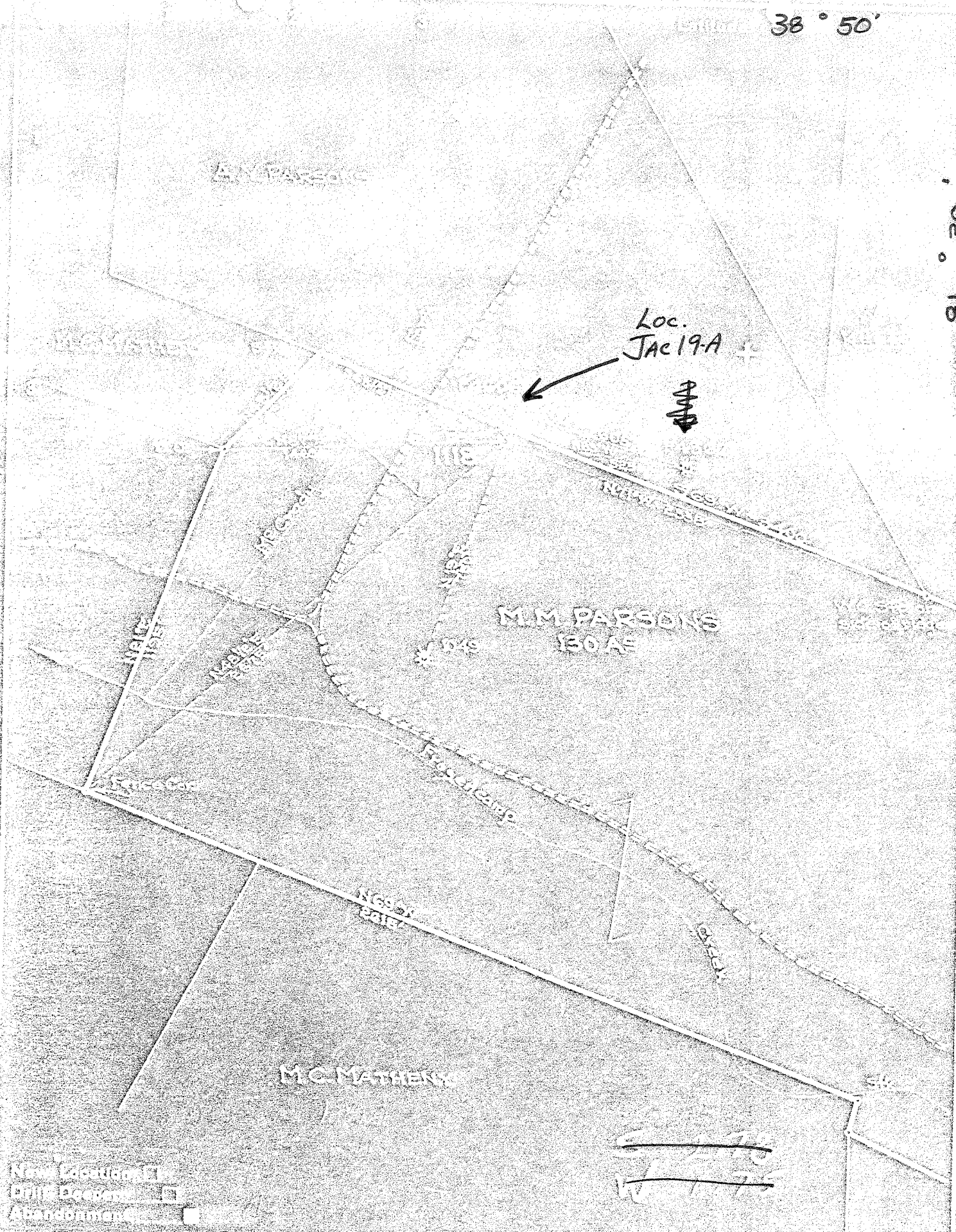

~~130 AC~~
~~130 AC~~

New Location
 Old Location
 Abandonment

JEFF MILLER

Company: ~~AMERICAN GAS CO.~~
 Address: ~~CHARLES TOWN, W. VA.~~
 Loc: **A.V.** ~~PARSONS~~
 Well No: ~~100~~ **2** ~~Spring~~
 Section: ~~100~~ **800 Top** ~~100~~
 Township: ~~100~~ **100** ~~100~~
 Range: ~~100~~ **100** ~~100~~
 County: ~~100~~ **100** ~~100~~
 State: ~~100~~ **100** ~~100~~
 Date: ~~100~~ **100** ~~100~~

STATE OF WEST VIRGINIA
 DEPARTMENT OF MINES
 OIL AND GAS DIVISION
 CHARLESTON, W. VA.

WELL LOCATION MAP

FILE NO. ~~100~~
JAC-19-A

Denotes location of well. Unless otherwise indicated, the location of the well is shown by a dashed line. The location of the well is shown by a dashed line.

Denotes location of well. Unless otherwise indicated, the location of the well is shown by a dashed line. The location of the well is shown by a dashed line.