

Latitude 38° 30'

Longitude 81° 40'

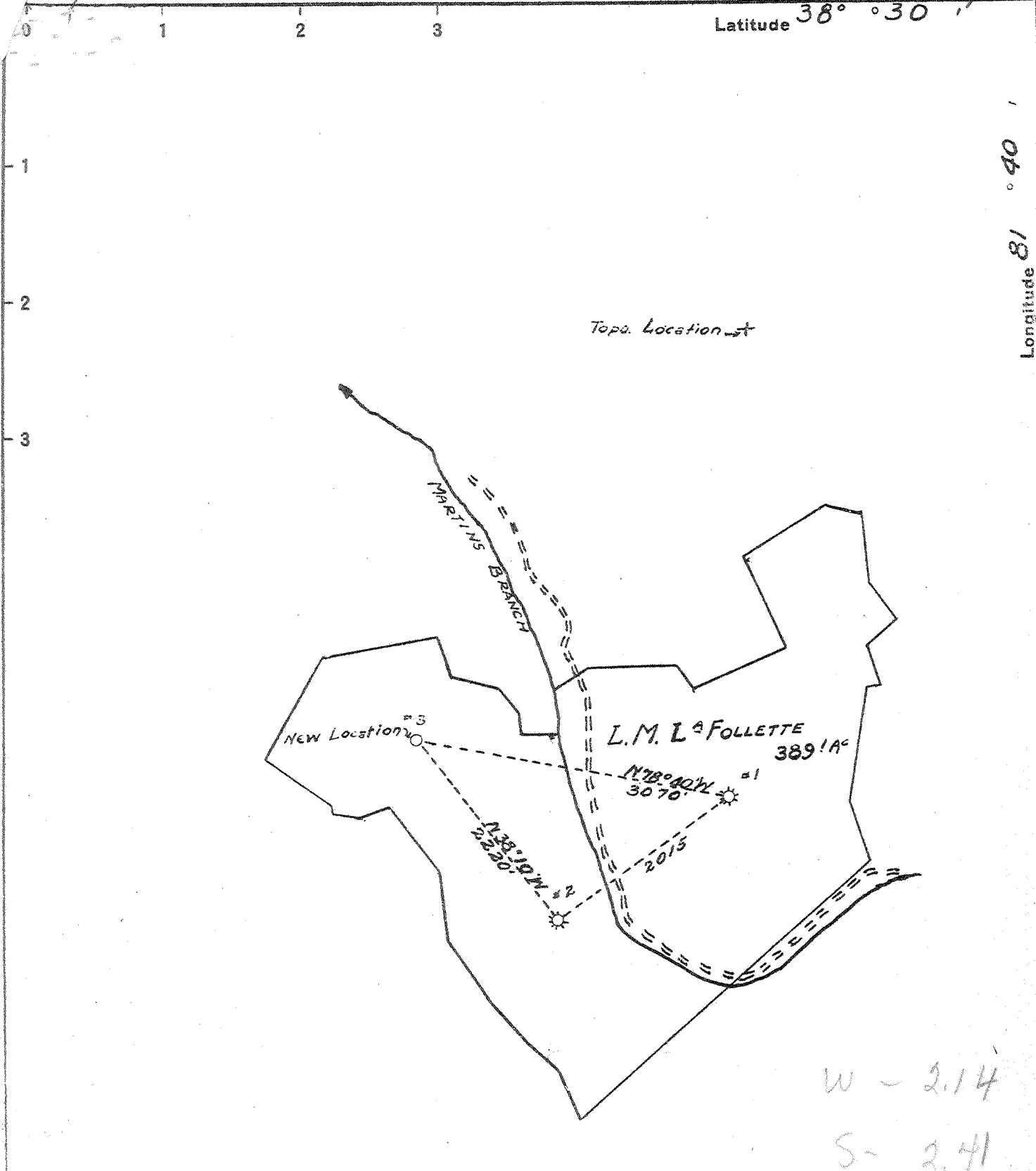

NOTE - For additional information see plats Kan. 667 and Kan. 708

Handwritten notes:
A-50
10/40
[Signature]

Handwritten notes:
W - 2.14
S - 2.41

Handwritten note: 3 C (J-5)

New Location See Vol XVI
Drill Deeper
Abandonment P. 500

Company	<u>GODFREY L CABOT INC.</u>
Address	<u>600 UNION BLDG. CHARLESTON WVA</u>
Farm	<u>L.M.L. FOLLETTE</u>
Tract	Acres <u>389.1</u> Lease No. <u>3-366</u>
Well (Farm) No.	<u>3</u> Serial No. <u>96.5</u>
Elevation (Spirit Level)	<u>745.33</u> Ground
Quadrangle	<u>CHARLESTON-NW</u>
County	<u>KANAWHA</u> District <u>UNION</u>
Engineer	<u>Charles H. Sturm</u>
Engineer's Registration No.	<u>775</u>
File No.	Drawing No.
Date	<u>Aug 28, 1940</u> Scale <u>1" = 1320'</u>

STATE OF WEST VIRGINIA
DEPARTMENT OF MINES
OIL AND GAS DIVISION
CHARLESTON

WELL LOCATION MAP
FILE NO. KAN-746

+ Denotes location of well on United States Topographic Maps, scale 1 to 62,500, latitude and longitude lines being represented by border lines as shown.
- Denotes one inch spaces on border line of original tracing.

Handwritten note: 6-6-1940

Handwritten note: Deep Well

WEST VIRGINIA DEPARTMENT OF MINES
OIL & GAS DIVISION
W E L L R E C O R D

Permit No. Kan-746
Charleston Quad.

Show
Gas Well

Company Godfrey L. Cabot, Inc.,
Address Charleston, W. Va.
Farm L. M. Lafollette ACRES -
Well No. 3 - Serial 965 ELEV. 745.33 Gr.
District Union - Kanawha County
Surface & Mineral -
Commenced Sept. 18, 1940
Completed Jan. 12, 1941
Shot 1/14/41 - depth 4792-4797 - 10 qts.
4826-4834 - 20 qts.
Volume 60,000 - 45 min. after shot
Rock Pressure 1700 lbs. 50 hrs. - Oriskany
Water -

CASING & TUBING
10-3/4 477 477
8-5/8 1570 1570
7 1816 1816
5 4713 4713
7" B.H.Packer
5" B. H. Packer

Clay	yl	s	0	21	Brown Shale	s	2188	2198	
Red Rock	rd	s	21	35	Berea Sand	gr h	2198	2208	
Slate	bl	s	35	50	Lime	bk h	2208	2431	
Red Rock	rd	s	50	70	Slate&Lime	gr m	2431	3422	
Slate	bk	s	70	85	Brown Shale	s	3422	3440	
Red Rock	rd	s	85	110	W 90 FW 2 BPH	Slate & Shells	gr m	3440	3710
Lime	gr	h	110	125	Brown Shale	s	3710	3725	
Red Rock	rd	s	125	140	Slate&Shells	gr m	3725	3830	
Sand	gr	m	140	160	Brown Shale	s	3830	3860	
Slate	bk	s	160	204	Lime	gr m	3860	3912	
Coal	bk	s	204	208	Brown Shale	s	3912	3980	
Slate	bl	s	208	225	Slate	wh s	3980	4410	
Sand	gr	m	225	243	Shale&Shell	bn	4410	4655	
Slate	bl	s	243	285	Black Shale	s	4655	4688	
Sand	gr	m	285	395	Corniferous	h	4688	4787	SL 4787
Slate	bk	s	395	405	Oriskany Sand	h	4787	4815	Gas 4794
Lime	bk	h	405	425					Shot - not
Coal	bk	s	425	428					enough
Slate	gr	s	428	457	Oriskany Lime	h	4815	4817	to gauge
Sand	gr	m	457	645	Oriskany Sand	h	4817	4835	Gas 4830-
Slate	bk	s	645	654					31 - 2/10
Sand	gr	m	654	710					W in 1"
Slate	gr	s	710	730					14.90M
Lime	bk	h	730	789	Oriskany Lime	h	4835	4837	Gas 4831-
Slate	gr	s	789	850					32 - 3/10
Lime	gr	h	850	902					W in 1"
Slate	bk	s	902	920					18.26M
Lime	gr	h	920	972	Oriskany Sand	h	4837	4840	
Sand	gr	m	972	1040	Helderberg Lime	h	4840	4854	SL 4854
Slate	gr	s	1040	1065	Total Depth			4854	
Salt Sand	h		1065	1360	W 1151-75				
					W level				
					200' down				
Lime	bk	h	1360	1370					
Sand	gr	h	1370	1393					
Lime	bk	h	1393	1406					
Slate	bk	s	1406	1416					
Sand	gr	h	1416	1456					
Lime	bk	h	1456	1485					
Sand	gr	h	1485	1553					
Slate	bk	s	1553	1554					
Big Lime	gr	h	1554	1718	SL 1570				
					Gas 1607-8				
					133 M drowned				
					cut by Aquagel				
					10/10 W in 2"				
Injun Sand	gr	s	1718	1770	W 1740, Water				
					level 540'				
Lime	gr	h	1770	1914	SL 1816				
Slate & Shells	gr	m	1914	2188					

GAUGES IN ORISKANY SAND - BEFORE SHOT
1/14/41 not enough to gauge

GAUGES IN ORISKANY SAND - AFTER SHOT
1/14/41 5 min. after shot 146 M
10 " " " 103 M
15 " " " 94 M
20 " " " 84 M
45 " " " 60 M