

38° 37' 30"

Latitude 38° 40'

Longitude 81° 40'

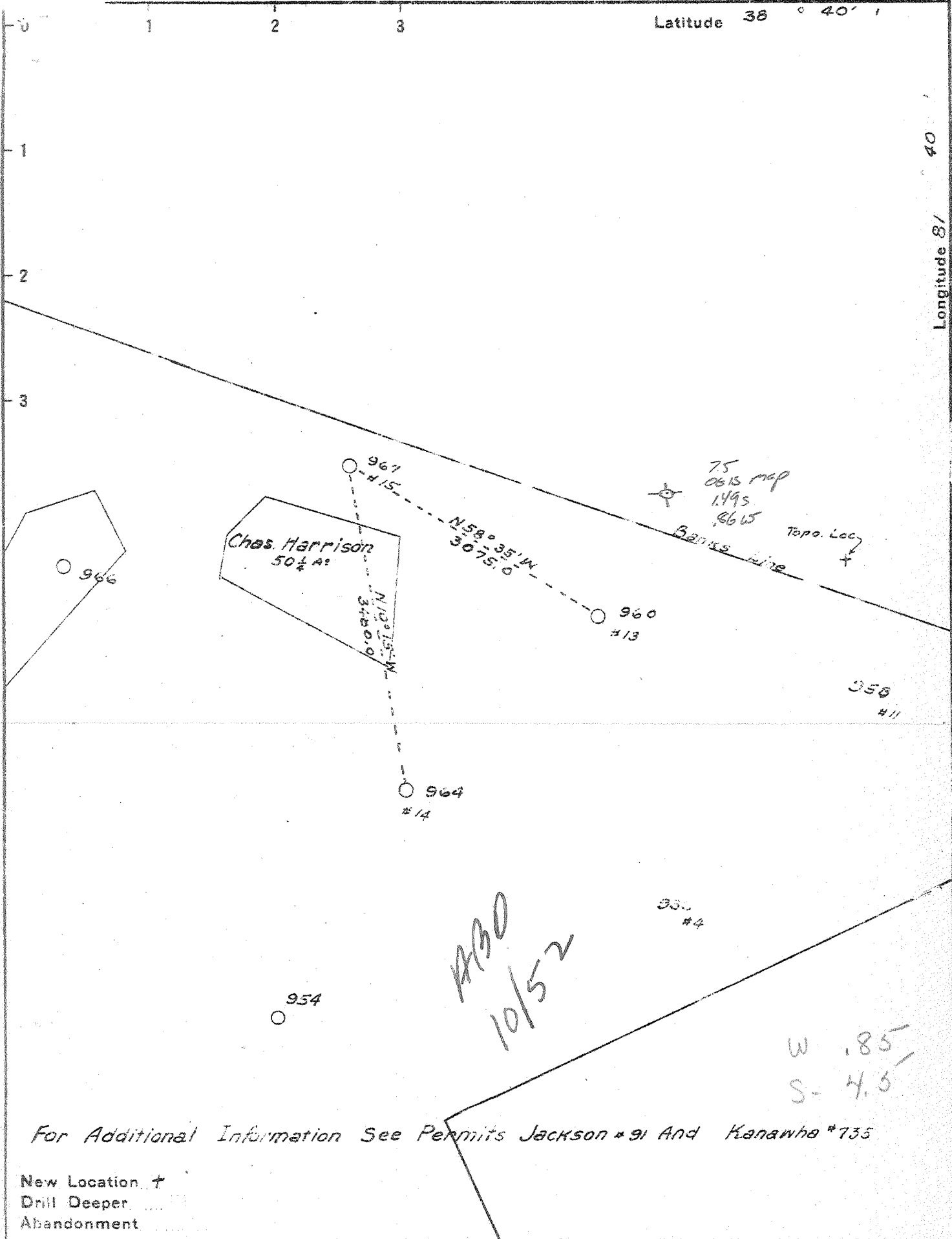

For Additional Information See Permits Jackson #91 And Kanawha #735

New Location  †  
 Drill Deeper   
 Abandonment

Company GODFREY L CABOT INC.  
 Address 600 UNION BLDG. CHARLESTON W.VA.  
 Farm THE PUTNAM COMPANY  
Part of 22,000 Acs  
 Tract \_\_\_\_\_ Acres \_\_\_\_\_ Lease No. 3-464  
 Well (Farm) No. 15 Serial No. 967  
 Elevation (Spirit Level) \_\_\_\_\_  
 Quadrangle KENNA W.  
 County KANAWHA District POCA  
 Engineer Charles K. [Signature]  
 Engineer's Registration No. 971  
 File \_\_\_\_\_ Drawing No. \_\_\_\_\_  
 Date Oct 15 1940 Scale 1" = 1320'

STATE OF WEST VIRGINIA  
 DEPARTMENT OF MINES  
 OIL AND GAS DIVISION  
 CHARLESTON

WELL LOCATION MAP  
 FILE NO. KAN-756

† Denotes location of well on United States Topographic Maps, scale 1 to 62,500, latitude and longitude lines being represented by border lines as shown.

— Denotes one inch spaces on border line of original tracing.

WEST VIRGINIA DEPARTMENT OF MINES  
OIL & GAS DIVISION  
W E L L R E C O R D

Permit No. Kan-756  
Kenna Quad.

Gas Well

Company Godfrey L. Cabot, Inc.,  
Address Charleston, W. Va.  
Farm Putnam Company ACRES --  
Well No. 15 - Serial 967 ELEV. - 914  
District Poca - Kanawha County  
Surface & Mineral --  
Commenced Nov. 2, 1940  
Completed Feb. 12, 1941  
Shot 2/12/41 - depth 5120-5132 - 30 qts.  
Open Flow 6,009,000 c.f. 17/10ths Merc. A.S.  
Rock Pressure 1480 lbs. 26 hrs. - Oriskany  
Water --

CASING & TUBING  
10-3/4 945 945  
8-5/8 2140  
7 5043 5043  
2-3/8 5192

7" B.H.Packer Lead

Soil	0	13	Slate&Shells wh	2535	3737
Red Rock	13	35	Dark Shale	3737	3776
Dark Lime	35	51	Slate&Shells - wh	3776	4119
Slate - blue	51	104	Brown Shale	4119	4320
Red Rock - red	104	170	Slate	4320	4782
Slate	170	180	Brown Shale	4782	5023
Slate Shells	180	206	-Corniferous	5023	5120 SL 5043
Red Rock	206	386	-Oriskany	5120	5171
Slate Shells	386	446	Oriskany Lime	5171	5180
Red Rock	446	470	-Oriskany Sand	5180	5194
Slate Shells	470	545			
Red Rock	545	572			
Sand - white	572	630			
Red Rock	630	710			
Sand - white	710	760			
Slate Shells	760	780			
Sand - white	780	828			
Slate	828	839			
Red Rock	839	856			
Lime - dark	856	879			
Slate - white	879	888			
Slate - black	888	916			
Lime - dark	916	935	Oil 930 show		
Slate	935	940			
Big Dunkard Sand	940	990	S.L. 945		
Slate - white	990	1175			
Sand	1175	1230			
Slate	1230	1250			
Sand	1250	1292			
Slate & Shells - dk	1292	1350			
Sand - white	1350	1380			
Slate	1380	1530			
Salt Sand	1530	1967			
			SW 1650		
			SW level		
			within 200'		
			of top		
Big Lime	1967	2048			
Slate - dark	2048	2053			
Big Injun - grey	2053	2081			
Slate & Shells	2081	2108			
Black Lime - black	2108	2150	SL 2140		
Slate & Shells - wh	2150	2176			
Lime Shells - white	2176	2329			
Slate & Shells	2329	2508			
Brown Shale	2508	2523			
Berea Grit - grey	2523	2535	Gas 2530,		
			showing		
			not enough		
			to gauge		

GAUGES IN ORISKANY SAND - BEFORE SHOT

2/ 7/41	5122	133 M
"	5123	1,724 M
"	5124	2,727 M
"	5125	2,870 M
"	5128	2,855 M
"	5133	1,843 M
2/ 8/41	5138	1,090 M
"	5147	1,157 M
2/ 9/41	5155	1,157 M
"	5171	1,090 M
"	5178	1,090 M
2/10/41	5189	1,021 M
2/11/41	5191	771 M
"	5194	668 M
2/12/41	before shot	545 M

GAUGES IN ORISKANY SAND - AFTER SHOT

	5 min. after shot	7,238 M
10 "	"	6,284 M
15 "	"	6,284 M
20 "	"	6,009 M