

Latitude 38° 40'

Longitude 81° 30'

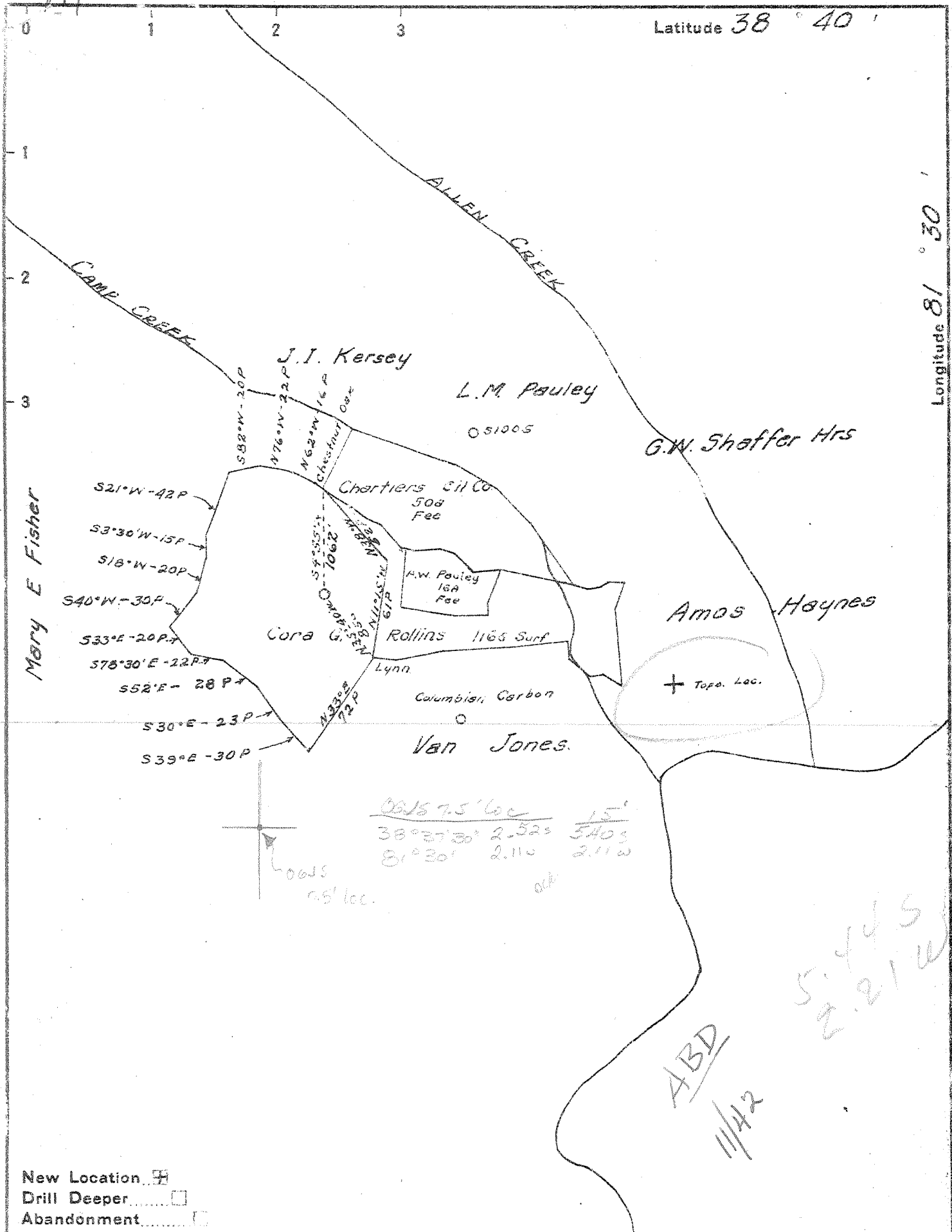

New Location    
 Drill Deeper    
 Abandonment

Godfrey L Cabot Inc. for   
 Company THE CHARTIERS OIL Co.   
 Address 900 UNION BLDG CHARLESTON WVA   
 Farm THE CHARTIERS OIL Co.   
 Tract \_\_\_\_\_ Acres 116 Lease No. 3-812   
 Well (Farm) No. 1 Serial No. 1016   
 Elevation (Spirit Level) 891.56   
 Quadrangle Kenna   
 County Kanawha District Poca   
 Engineer Charles Sturm   
 Engineer's Registration No. 975   
 File No. \_\_\_\_\_ Drawing No. \_\_\_\_\_   
 Date 10-10-41 Scale 1" = 1320'

STATE OF WEST VIRGINIA   
 DEPARTMENT OF MINES   
 OIL AND GAS DIVISION   
 CHARLESTON

WELL LOCATION MAP   
 FILE NO. KAN-878

+ Denotes location of well on United States Topographic Maps, scale 1 to 62,500, latitude and longitude lines being represented by border lines as shown.   
 - Denotes one inch spaces on border line of original tracing.

"IMPERIAL" TRACING CLOTH   
 K & E CO., N. Y.

Deep well

WEST VIRGINIA DEPARTMENT OF MINES  
OIL & GAS DIVISION  
W E L L R E C O R D

Permit No. Kan 878	Company Godfrey LeCabot, Inc.	Gas Well CASING & TUBING
Address Farm	Charleston, W. Va. Chartiers Oil Co. (M.F. Pauley)	10 1/2 686 686
Location	---	8 5/8 1894
Well No.	1 Sor. 1016 Elev. 892	7" 5069 5069
District	Poca Kanawha County	2 3/8 5256 5256
Surface	---	8 5/8 x 10 1/2 x 16" D.H.
Mineral	---	Packer, 28 sacks aquagel
Commenced	Dec. 2, 1941	1 7" O.D. Sp. Orisk.
Completed	March 18, 1942	Packer; 40 sacks aquagel
Shot	4-6-42 Depth 5186-5196 40 qts.	and 4 sacks fibertex.
Volume	1500 A.S. Est. 20 Mins A.S.; D.S.	bottom joint welded (23/8)
	Est. 300 MCF	Line pipe used as tubing
Rock Pressure	1425 lbs. 64 hrs.	Perf. top bot
Salt Water	1350' H.F. hole filled up 400'	5190 5196
		5255 5261
		Tubed & shut in 5-5-42

Surface	0	14		Best gauge Oriskany 5188-5192
Sand	14	20		init. prod. 696 MCF
Shale	20	60		
Lime	60	75		GAUGES IN ORISKANY SAND BEFORE SHOT
Red Rock	75	110		5188-92 696 M
Sand	110	140		5201 492 M
Slate & Shells	140	312		5212 467 M
Sand	312	335		5221 440 M
Red Rock & Shells	335	608		5231 490 M
Little Dunkard	608	630		5255 440 M
Red Rock	630	649		5260 440 M
Slate	649	654	686 SLM	5263 440 M
Lime	654	665		GAUGES IN ORISKANY AFTER SHOT
Big Dunkard	665	875		Gauge before shot 300 M (Est.)
Black Shale	875	883		30 Mins A.S. 1500 M (Est)
Sand	883	925		NOTE: There was no gauge at well at
Slate & Shells	925	960		time of shot. The open flow on 4-23-42,
Sand	960	1000		while cleaning out, was 246 M. The
Lime	1000	1026		well was turned into line while not
Sand	1026	1145		being cleaned out. Finished cleaning
Slate & Shells	1145	1235		out, tubed and turned into the line
Lime	1235	1295		5-5-42.
Shale	1295	1303		
Lime	1303	1345		
Salt Sand	1345	1637	1667	
Little Lime	1667	1702		
Pencil Cave	1702	1706		
Big Lime	1708	1851		
Big Injun	1851	1882		
Slate	1882	1891		
Lime Shell	1891	1896	1894 SLM	
Squaw Shells	1909	2130		
Slate & Shells	2130	2340		
Brown Shale	2340	2362		
Berea Shells	2362	2465	- ?	
Slate & Shells	2465	2680		
Sand	2680	2700		
Lime	2700	2730		
Slate & Shells	2730	3410		
Brown Shale	3410	3451		
Slate & Shells	3451	3545		
Brown Shale	3545	3630		
Slate & Shells	3630	3970		
Brown Shale	2970	4140		
Slate & Shells	4140	4480		
White Sl&Shells	4490	4630		
Brown Shale	4630	4915		
White Slate	4915	4950		
Black Shale	4950	5049		
Corniferous	5049	5175	5069 SLM	
Oriskany	5175	5218		
Lime	5218	5227	Gas 5188-92	
Sand	5227	5249		
Holderberg Lime	5249	5263	5263 SLM	
TOTAL DEPTH		5263	SLM	

5049	5175	5249
892	892	892
4157	4283	4357