

FILE NO. \_\_\_\_\_  
 DRAWING NO. 7103  
 SCALE 1" = 400  
 MINIMUM DEGREE OF ACCURACY 1/200  
 PROVEN SOURCE OF ELEVATION G.P.S.

I THE UNDERSIGNED, HEREBY CERTIFY THAT THIS PLAT IS CORRECT TO THE BEST OF MY KNOWLEDGE AND BELIEF AND SHOWS ALL THE INFORMATION REQUIRED BY LAW AND THE REGULATIONS ISSUED AND PRESCRIBED BY THE DEPARTMENT OF ENERGY.  
 (SIGNED) \_\_\_\_\_  
 R.P.E. 12794 L.L.S. 1605

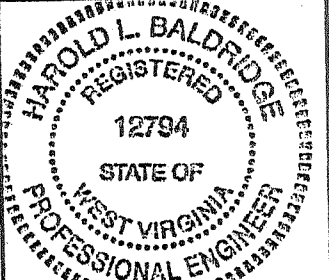

STATE OF WEST VIRGINIA  
 DIVISION OF ENVIRONMENTAL PROTECTION  
 SECTION OF OIL & GAS

DATE: APRIL 24 20 01

OPERATOR'S WELL NO. 7103  
 API WELL NO. \_\_\_\_\_

WELL TYPE: OIL \_\_\_ GAS \_\_\_ LIQUID INJECTION \_\_\_ WASTE DISPOSAL \_\_\_ STATE COUNTY PERMIT  
 (IF "GAS,") PRODUCTION \_\_\_ STORAGE \_\_\_ DEEP \_\_\_ SHALLOW \_\_\_

LOCATION: ELEVATION 1302.51 WATER SHED \_\_\_\_\_ DISTRICT ELK COUNTY KANAWHA

QUADRANGLE BLUE CREEK, W. VA. COORDINATES LAT: 38° 25' 02.5" LONG: 81° 23' 55.4"

SURFACE OWNER ED W. GOSHORN ESTATE ACREAGE 455.4  
 ORIGINAL OIL & GAS ROYALTY OWNER J. N. CARNES, ET. AL. LEASE ACREAGE 455.4  
 COAL OWNER ED W. GOSHORN ESTATE LEASE NO. 14334

PROPOSED WORK: DRILL \_\_\_ CONVERT \_\_\_ DRILL DEEPER \_\_\_ REDRILL \_\_\_ FRACTURE OR STIMULATE \_\_\_ X PLUG OFF OLD FORMATION \_\_\_ PERFORATE NEW FORMATION \_\_\_ OTHER PHYSICAL CHANGE IN WELL (SPECIFY) STORAGE RECONDITION

PLUG AND ABANDON \_\_\_ CLEAN OUT AND REPLUG \_\_\_ ESTIMATED DEPTH 5644'

TARGET FORMATION Oniskany

WELL OPERATOR COLUMBIA GAS TRANSMISSION CORP DESIGNATED AGENT PAUL AMICK

ADDRESS PO BOX 1273, CHARLESTON, WV ADDRESS PO BOX 1273, CHARLESTON, WV 25325-1273

COUNTY NAME KANAWHA  
 PERMIT 01540 F

Blue Ck (Falling Rk) 90 (2M) SEP 30 2005

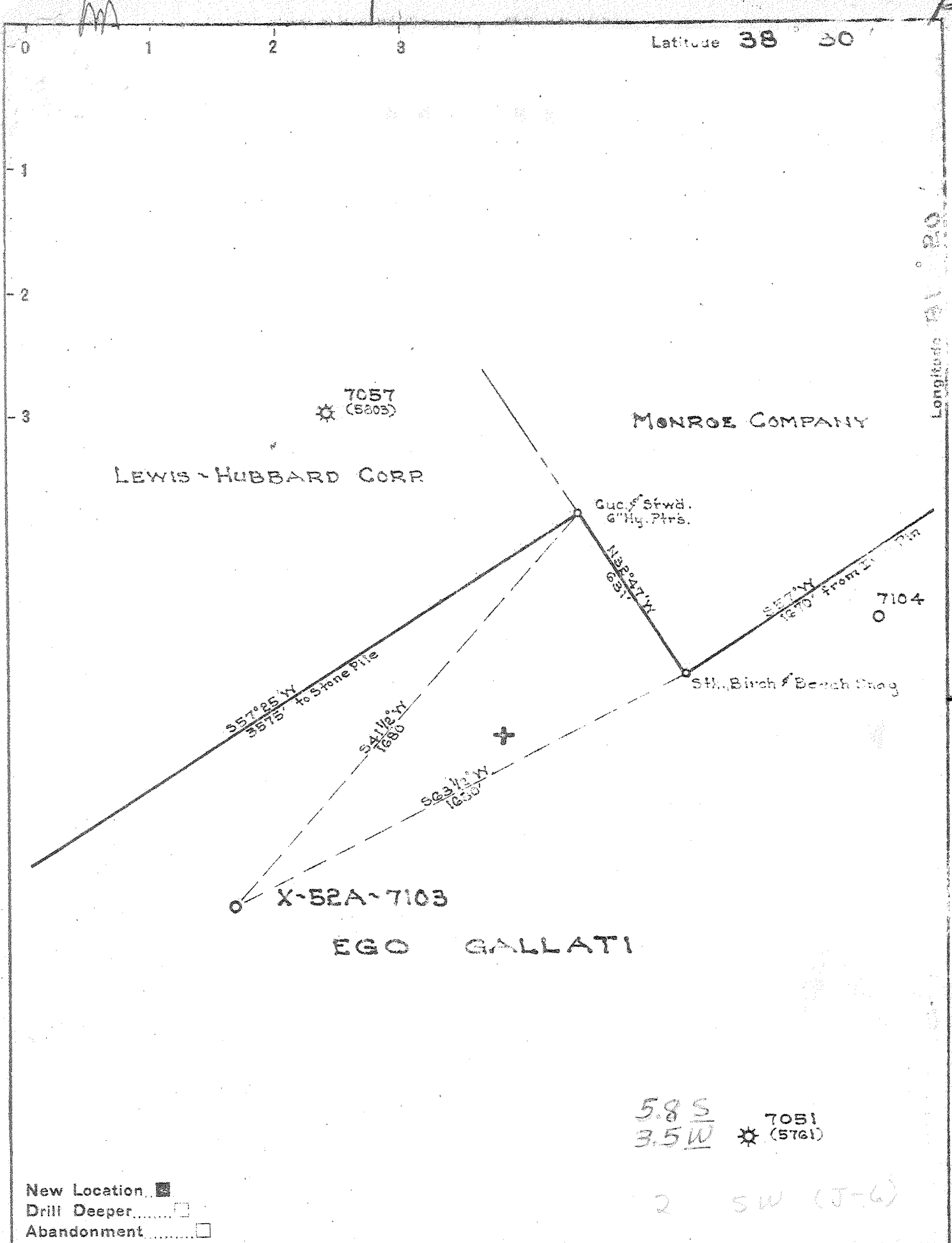

5.8 S  
3.5 W

7051 (5761)

2 SW (J-6)

New Location   
 Drill Deeper   
 Abandonment

Company UNITED FUEL GAS CO.  
 Address CHARLESTON, W. VA.  
 Farm EGO GALLATI  
 Tract Acres 455.4 <sup>Deed</sup> ~~Lease~~ No. 14334  
 Well (Farm) No. 6 Serial No. X-52A-7103  
 Elevation (Spirit Level) 1298.68  
 Quadrangle CLENDENIN - NC  
 County KANAWHA District ELK  
 Engineer \_\_\_\_\_  
 Engineer's Registration No. 662  
 File No. 74-63 Drawing No. \_\_\_\_\_  
 Date 8-17-50 Scale 1" = 400'

STATE OF WEST VIRGINIA  
 DEPARTMENT OF MINES  
 OIL AND GAS DIVISION  
 CHARLESTON

WELL LOCATION MAP  
 FILE NO. KAN-1540

+ Denotes location of well on United States Topographic Maps, scale to 62,500, latitude and longitude lines being represented by border lines as shown.

- Denotes one inch spaces on border line of original tracing.

storage 20 2, Orisk Deep Well

WEST VIRGINIA DEPARTMENT OF MINES  
OIL & GAS DIVISION  
W E L L R E C O R D

Permit No. Kan 1540

Gas Well  
CASING & TUBING

Clendenin Quad.

Company

United Fuel Gas Company

Address

P.O. Box 1273, Charleston, 25, W.Va. 14 56 Pld. 36'

Farm

Ego Gallati Acres 455.4 10 1/2 1677 Pld.

Location

Three Mile Fk. of Blue Cr. 8 5/8 1866 1866

Well No.

X-52 A-7103 Elev. 1298.68 5 1/2 5538 5538

District

Elk Kanawha County 2 5644

Surface

Mineral

U.F.G. Co. P.O. Box 1273,

Charleston, W.Va. 25

Commenced

11-13-50

Completed

5-29-51

Date shot

5-31-51 Depth 5630 to 5644

Open flow

with 20 qts. glycerine

Volume

28/10ths W in 7"

Rock Pressure

2,282 M Oriskany

Salt Water

575 lbs. 48 hrs.

1280'

Clay

0 4

Big Lime gas show 1993-1995'

Sand

4 75

Gas 2095-2100 8 1/10 W 2" 386 M

Slate

75 85

Show gas 5627'

Red Rock

85 90

Gas 5627-5640 8/10 W 7" 22# 1,220 M

Blue Slate

90 125

Gas 5640-5644 8/10 W 7" 22# 1,220 M

Red Rock

125 155

Test before shot 8/10 W 7" 22# 1,220 M

Gray Slate

155 170

shot 5-31-51 with 20 qts. glycerine

Slate

170 200

from 5630-5644

Blue Slate

200 225

test after shot 28/10 W 7" 22# 2,282 M

Sand

225 240

Blue Slate

240 300

Final open flow 2,282 M Oriskany

Sand

300 510

48 hr. R.P. 575#

Slate

510 540

Shut in 5-29-51 in 2" tubing

Sand

540 720

Slate

720 800

Sand

800 900

Lime

900 925

Slate

925 1000

Sand

1000 1073

Slate

1073 1130

-Salt Sand

1130 1679

Sand

1679 1708

Slate

1708 1797

Pencil Cove

1797 1802

? -Little Lime

1802 1838

-Big Lime

1838 2034

-Injun Sand

2034 2050

-Sand

2050 2053

Lime

2053 2083

-Sand

2083 2273

Slate & Shells

2273 3615

Brown Shale

3615 3790

Slate

3790 4190

Brown Shale

4190 4460

White Slate

4460 5050

Brown Shale

5050 5335

White Slate

5335 5375

Brown Shale

5375 5450

-Black Shale

5450 5498

-Corniferous Lime

5498 5619

-Oriskany Sand

5619 5644

T.D.

5644' SLM

WR-35  
Rev (5-01)

DATE: 3/17/08  
API #: 47-039-01540

State of West Virginia  
Department of Environmental Protection  
Office of Oil and Gas

Well Operator's Report of Well Work

Farm name: Goshorn, H.D. EST Operator Well No.: 7103

LOCATION: Elevation: 1302.5 ft Quadrangle: Blue Creek

District: Elk County: Kanawha  
Latitude: 14,920 Feet South of 38 Deg. 27 Min. 30 Sec.  
Longitude 6,800 Feet West of 81 Deg. 22 Min. 30 Sec.

Company: Columbia Gas Transmission Corp

	Casing & Tubing	Used in drilling	Left in well	Cement fill up Cu. Ft.
Address: 1700 MacCorkle Ave SE Charleston, WV 25325-1273				
Agent: Paul Amick	This is an existing storage well - no casing was pulled or ran during rework			
Inspector:				
Date Permit Issued: 9/27/05				
Date Well Work Commenced: 9/17/05				
Date Well Work Completed: 10/12/05				
Verbal Plugging:				
Date Permission granted on:				
Rotary X Cable Rig				
Total Depth (feet): 5644				
Fresh Water Depth (ft.): not applicable - rework				
Salt Water Depth (ft.): not applicable - rework				
Is coal being mined in area (N/Y)? no				
Coal Depths (ft.): _____ ft				

OPEN FLOW DATA

Producing formation Oriskany Sand Pay zone depth (ft) 5627 - 5644  
Gas: Initial open flow 23,700 MCF/d Oil: Initial open flow 0 Bbl/d  
Final open flow 29,500 MCF/d Final open flow 0 Bbl/d  
Time of open flow between initial and final tests not applicable Hours  
Static rock Pressure 1800 psig (surface pressure) after 72+ Hours

NOTE: ON BACK OF THIS FORM PUT THE FOLLOWING: 1). DETAILS OF PERFORATED INTERVALS, FRACTURING OR STIMULATING, PHYSICAL CHANGE, ETC. 2). THE WELL LOG WHICH IS A SYSTEMATIC DETAILED GEOLOGICAL RECORD OF ALL FORMATIONS, INCLUDING COAL ENCOUNTERED BY THE WELLBORE.

Signed: James E. Amos  
By: James E. Amos - Senior Storage Engineer - Columbia Gas Transmission Corp  
Date: 3/17/08

RECEIVED  
Office of Oil & Gas  
MAR 19 2008  
MAY 02 2008  
WV Department of Environmental Protection  
KAN 1540

Coco A Storage well 7103

This is an existing storage well. Below is a summary of work performed.

- 1) Installed new wellhead.
- 2) Fracture stimulated.

Frac Data: 1000 gals HCl acid  
345 bbls gel  
108 MSCF nitrogen  
25,600 lbs sand  
Break @ 2900 psig  
ATR = 14 BPM  
ATP = 3300 psig

\* Note that no earthen pit was utilized. Flowback treatment fluids recovered via steel tanks and transported to LAD in Wheeling, WV for disposal/processing.