

(+) DENOTES LOCATION OF WELL ON UNITED STATES TOPOGRAPHIC MAPS

FILE No 2001-3079-001-012
 DRAWING No. 2001-3079-001-012
 SCALE 1"=500'
 MINIMUM DEGREE OF ACCURACY 1:200
 PROVEN SOURCE OF ELEVATION TRIMBLE R10 GPS UNIT

I THE UNDERSIGNED, HEREBY CERTIFY THAT THIS PLAT IS CORRECT TO THE BEST OF MY KNOWLEDGE AND BELIEF AND SHOWS ALL THE INFORMATION REQUIRED BY LAW AND THE REGULATIONS ISSUED AND PRESCRIBED BY THE DIVISION OF ENVIRONMENTAL PROTECTION.

(SIGNED) 
 ROBERT F. THAW PS #965

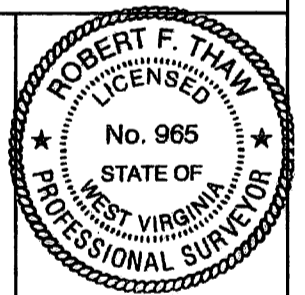

FORM IV-6 (8-78)

STATE OF WEST VIRGINIA DIVISION OF ENVIRONMENTAL PROTECTION OFFICE OF OIL AND GAS NITRO, WV			DATE <u>NOVEMBER 11</u> 20 <u>20</u> OPERATOR'S WELL No. <u>7326</u> API WELL No. <u>47 039 - 01603P</u>
WELL TYPE: OIL <input type="checkbox"/> GAS <input checked="" type="checkbox"/> LIQUID INJECTION <input type="checkbox"/> WASTE DISPOSAL <input type="checkbox"/> (IF "GAS") PRODUCTION <input type="checkbox"/> STORAGE <input type="checkbox"/> DEEP <input checked="" type="checkbox"/> SHALLOW <input type="checkbox"/>		STATE COUNTY PERMIT	
LOCATION: ELEVATION <u>1052.47'</u> WATER SHED <u>RICH FORK OF THE ELK RIVER</u> DISTRICT <u>BIG SANDY</u> COUNTY <u>KANAWHA</u> QUADRANGLE <u>BLUE CREEK, WV</u>			
SURFACE OWNER <u>GLEN D. AND NANCY C. CHESTNUT</u> ACREAGE <u>9.5</u>		OIL & GAS ROYALTY OWNER <u>THREE MILE FORK LAND COMPANY</u> LEASE ACREAGE <u>64.63</u> LEASE No. <u>1032593-000</u>	
PROPOSED WORK: DRILL <input type="checkbox"/> CONVERT <input type="checkbox"/> DRILL DEEPER <input type="checkbox"/> REDRILL <input type="checkbox"/> FRACTURE <input type="checkbox"/> STIMULATE <input type="checkbox"/> PLUG OFF OLD FORMATION <input type="checkbox"/> PERFORATE NEW FORMATION <input type="checkbox"/> OTHER PHYSICAL CHANGE IN WELL (SPECIFY) <u>04/02/2021</u>			
PLUG AND ABANDON <input checked="" type="checkbox"/> CLEAN OUT AND REPLUG <input type="checkbox"/>			
TARGET FORMATION <u>ORISKANY</u> ESTIMATED DEPTH <u>5513</u>		DESIGNATED AGENT <u>JIM AMOS</u>	
WELL OPERATOR <u>COLUMBIA GAS TRANSMISSION, LLC</u> ADDRESS <u>PO BOX 1273, CHARLESTON, WV 25325-1273</u>		ADDRESS <u>48 COLUMBIA GAS ROAD SANDYVILLE, WV 25275</u>	

(ROMANCE)



BLUE CREEK QUADRANGLE
WEST VIRGINIA
TOPOGRAPHIC SERIES

4703901603 (CLIQ)



RECEIVED
Office of Oil and Gas
JAN 13 2021
WV Department of
Environmental Protection

Produced by Trimble Terrain Navigator Pro
Topography based on USGS 1:24,000 Maps
North American 1983 Datum (NAD83)
To place on the predicted North American 1927 move the
projection lines 11M N and 14M E



(QUICK)
SCALE 1:24000

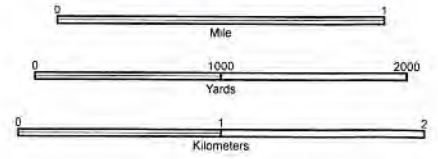

CONTOUR INTERVAL 20 FT

38081-D3-TM-024
BLUE CREEK, WV
JAN 1, 1977

04/02/2021