

NOTE: ALL WELLS IDENTIFIED WITHIN 2400' ARE SHOWN

LATITUDE 38°17'30"

7,128'

LONGITUDE 81°27'30"

13,328'

NORTH

NOTE: NO BUILDING STRUCTURES IDENTIFIED WITHIN 200'

WELL SITE
STATE PLANE WV SOUTH ZONE NAD 1927 N - 457,315.190 : E - 1,861,276.518
LATITUDE: (N) 38.2549293° LONGITUDE: (W) 81.4831078°
UTM NAD83 17 - 84W TO 78W, METERS N - 4,234,222.156 : E - 457,745.623

(+) DENOTES LOCATION OF WELL ON UNITED STATES TOPOGRAPHIC MAPS

FILE NO. 820524P&A.DGN
DRAWING NO. 820524 P&A
SCALE 1" = 1000'
MINIMUM DEGREE OF ACCURACY 1 : 200
PROVEN SOURCE OF ELEVATION MAPPING GRADE GPS

I THE UNDERSIGNED, HEREBY CERTIFY THAT THIS PLAT IS CORRECT TO THE BEST OF MY KNOWLEDGE AND BELIEF AND SHOWS ALL THE INFORMATION REQUIRED BY LAW AND THE REGULATIONS ISSUED AND PRESCRIBED BY THE DEPARTMENT OF ENVIRONMENTAL PROTECTION.

(SIGNED) *Paul E. Miller*
R.P.E. _____ L.L.S. 647

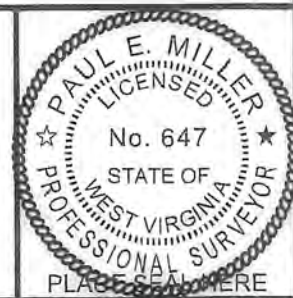

STATE OF WEST VIRGINIA
DIVISION OF ENVIRONMENTAL PROTECTION
OIL AND GAS DIVISION



DATE APRIL 15, 20 16
OPERATOR'S WELL NO. 820524
API WELL NO.

47 039 03908 P
STATE COUNTY PERMIT

WELL TYPE: OIL ___ GAS ___ LIQUID INJECTION ___ WASTE DISPOSAL ___
(IF "GAS,") PRODUCTION ___ STORAGE ___ DEEP ___ SHALLOW ___
LOCATION: ELEVATION 738' WATER SHED LEFT FORK OF WITCHER CREEK

DISTRICT CABIN CREEK COUNTY KANAWHA
QUADRANGLE QUICK, WV 7.5'

SURFACE OWNER BLACKHAWK LAND & RESOURCES ACREAGE 545.3
OIL & GAS ROYALTY OWNER CABOT OIL & GAS CORPORATION LEASE ACREAGE 545.3
LEASE NO. 1-190651-002

PROPOSED WORK: DRILL ___ CONVERT ___ DRILL DEEPER ___ REDRILL ___ FRACTURE OR STIMULATE ___ PLUG OFF OLD FORMATION ___ PERFORATE NEW FORMATION ___ OTHER PHYSICAL CHANGE IN WELL (SPECIFY) _____

PLUG AND ABANDON X CLEAN OUT AND REPLUG ___

TARGET FORMATION _____ ESTIMATED DEPTH _____

WELL OPERATOR CHESAPEAKE APPALACHIA, L.L.C. DESIGNATED AGENT JESSICA GREATHOUSE

ADDRESS P.O. BOX 18496, OKLAHOMA CITY, OK 73154-0496 ADDRESS CHESAPEAKE APPALACHIA, L.L.C. PO BOX 6070, CHARLESTON, WV 25362

FORM WW-6

COUNTY NAME

PERMIT

05/27/2016

RECEIVED
Office of Oil and Gas
APR 29 2016
WV Department of
Environmental Protection

CHESAPEAKE APPALACHIA, L.L.C.

RECLAMATION DIAGRAM WELL LOCATION 820524

API 47-039-03908

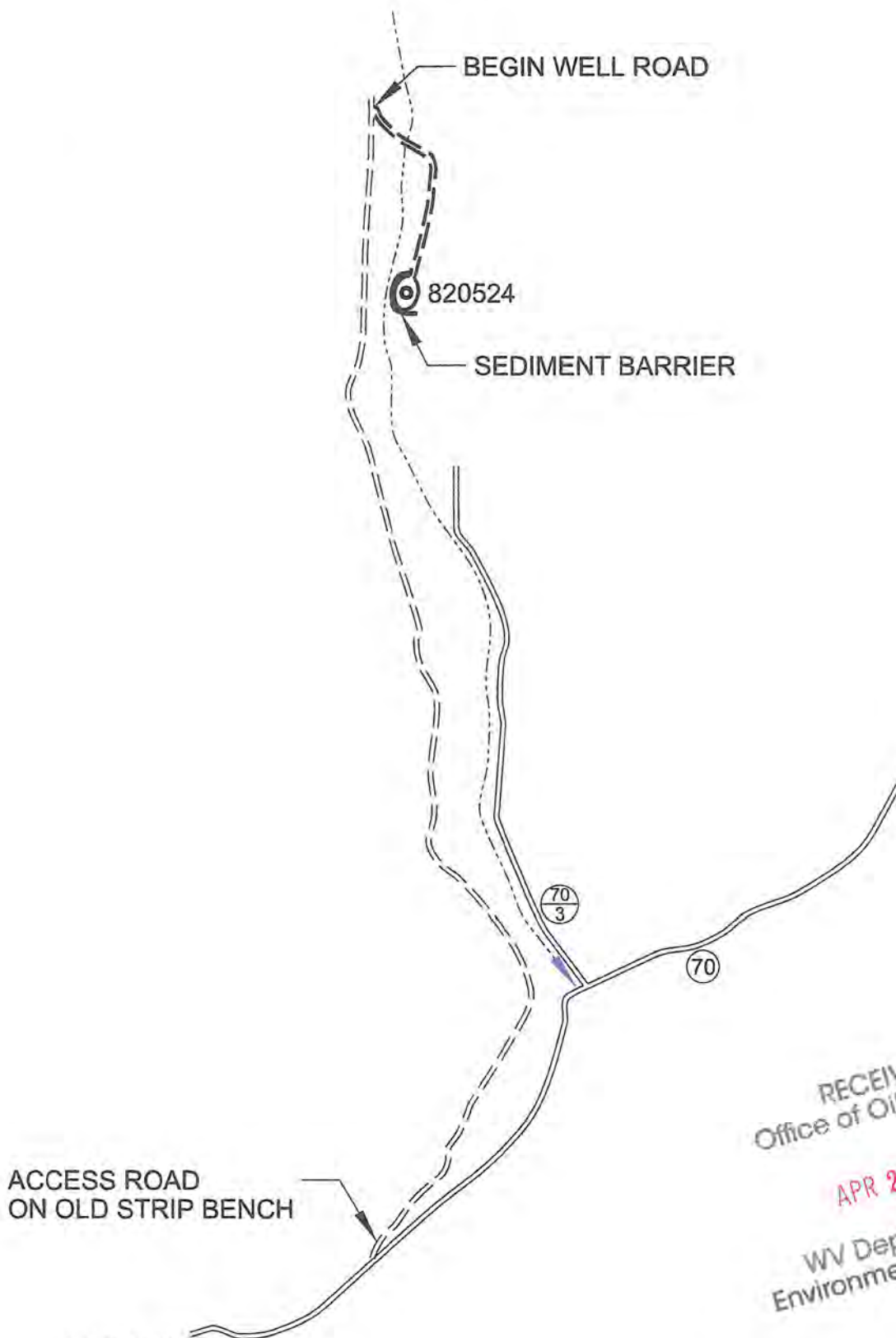

RECEIVED
Office of Oil and Gas
APR 29 2016
WV Department of
Environmental Protection

GENERAL NOTES

This drawing is a schematic representation of the well site and access road. Proposed structures such as well site, drilling pit, roadways, culverts, sediment barriers, etc. are shown in approximate pre-planning configurations.

All culvert pipes will be a minimum of 15 inches in diameter. All culvert pipes installed will be accompanied by an entrance sump with dimensions no less than 3 feet (width) x 3 feet (length) x 4 feet (deep). Culverts will be installed at an angle to ensure proper flow. The outfall of culverts will be protected from erosion and sedimentation using large rocks or other sediment controls deemed necessary in the prevention of erosion and sedimentation. Storm water from the ditches to the culverts will be directed to stable natural vegetative areas. Where culverts are not practical, operator will have other sediment control in place to minimize erosion sedimentation.

Cross drains, broad based dips, water bars, and diversion ditches, will be employed during the construction phase. These erosion and sediment control structures will be used to control erosion and sedimentation during the construction phase, where applicable, and in areas that will allow. These structures will be considered permanent and used as such.

Permanent seeding: See Attachment #1.

05/27/2016