

Susan S. Brawley, Mrs

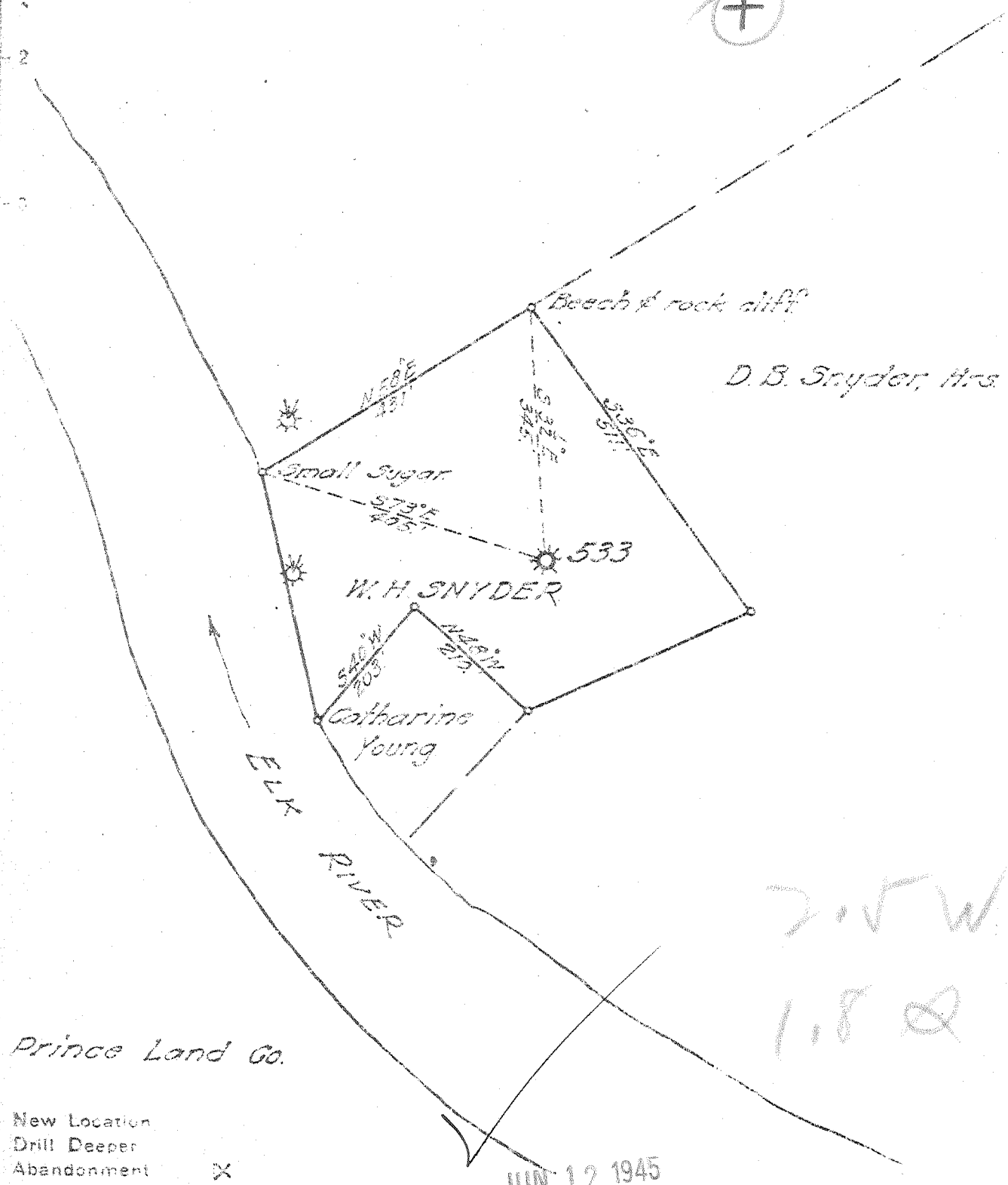

Longitude 81 15



D. B. Snyder, Mrs

2.5 W  
1.8 Q

Prince Land Co.

New Location  
Drill Deeper  
Abandonment X

JUN 12 1945

Company UNITED FUEL GAS CO  
 Address CHARLESTON W. VA.  
 Farm W.H. SNYDER  
 Tract \_\_\_\_\_ Acres 3 Lease No 554  
 Well Farm No. \_\_\_\_\_ Serial No. 533  
 Elevation Spirit Level 640 BAR  
 Quadrangle GLENDENIN  
 County KANAWHA District BIG SANDY  
 Engineer A. Cunningham  
 Engineer's Registration No. 659  
 File No. 80-67 Drawing No. \_\_\_\_\_  
 Date MAY 21, 1945 Scale 1" = 200'

STATE OF WEST VIRGINIA  
DEPARTMENT OF MINES  
OIL AND GAS DIVISION  
CHARLESTON

WELL LOCATION MAP  
FILE NO. KAN-429-A

+ Denotes location of well on United States Topographic Maps, scale 1 to 62,500, latitude and longitude lines being represented by border lines as shown.

- Denotes one inch spaces on border line of original tracing.

6-0-292



STATE OF WEST VIRGINIA  
DEPARTMENT OF MINES  
OIL AND GAS DIVISION

1080

Permit No. 429-A

WELL RECORD

Oil or Gas Well GAS  
(KIND)

Company United Fuel Gas Company  
Address Box 1273, Charleston 25, W. Va.  
Farm W. H. Snyder Acres 3  
Location (waters) Elk River  
Well No. 533 Elev. 640  
District Big Sandy County Kanawha  
The surface of tract is owned in fee by W. H. Snyder  
Address Queen Shoals, W. Va.  
Mineral rights are owned by Same  
Address \_\_\_\_\_  
Drilling commenced June 6, 1913  
Drilling completed July 22, 1913  
Date Shot Not shot From \_\_\_\_\_ To \_\_\_\_\_  
With \_\_\_\_\_  
Open Flow \_\_\_\_\_ /10ths Water in \_\_\_\_\_ Inch  
\_\_\_\_\_ /10ths Merc. in \_\_\_\_\_ Inch  
Volume Gas well \_\_\_\_\_ Cu. Ft.  
Rock Pressure \_\_\_\_\_ lbs. \_\_\_\_\_ hrs.  
Oil \_\_\_\_\_ bbls., 1st 24 hrs.  
Fresh water \_\_\_\_\_ feet \_\_\_\_\_ feet  
Salt water 770 feet \_\_\_\_\_ feet

| Casing and Tubing | Used in Drilling | Left in Well | Packers        |
|-------------------|------------------|--------------|----------------|
| Size              |                  |              | Kind of Packer |
| 16                |                  |              |                |
| 13                |                  |              |                |
| 10                |                  |              | Size of        |
| 8 1/4             | <u>465</u>       | <u>-</u>     |                |
| 6 5/8             | <u>1341</u>      | <u>1341</u>  | Depth set      |
| 5 3/16            | <u>1562</u>      | <u>1562</u>  |                |
| 3                 |                  | <u>1552</u>  | Perf. top      |
| 2                 |                  |              | Perf. bottom   |
| Liners Used       |                  |              | Perf. top      |
|                   |                  |              | Perf. bottom   |

CASING CEMENTED \_\_\_\_\_ SIZE \_\_\_\_\_ No. Ft. \_\_\_\_\_ Date \_\_\_\_\_

COAL WAS ENCOUNTERED AT 75 FEET 60 INCHES  
\_\_\_\_\_  
FEET INCHES FEET INCHES  
\_\_\_\_\_  
FEET INCHES FEET INCHES

| Formation      | Color | Hard or Soft | Top  | Bottom | Oil, Gas or Water | Depth Found | Remarks |
|----------------|-------|--------------|------|--------|-------------------|-------------|---------|
| Co             |       |              |      |        |                   |             |         |
| Conductor      |       |              | 16   |        |                   |             |         |
| Slate          |       |              | 16   | 75     |                   |             |         |
| Coal           |       |              | 75   | 80     |                   |             |         |
| Slate          |       |              | 80   | 300    |                   |             |         |
| Sand           |       |              | 300  | 465    |                   |             |         |
| Slate & Shells |       |              | 465  | 640    |                   |             |         |
| Salt Sand      |       |              | 640  | 1240   | Water             | 770         |         |
| Maxon          |       |              | 1240 | 1300   |                   |             |         |
| Little Lime    |       |              | 1300 | 1330   |                   |             |         |
| Slate          |       |              | 1330 | 1333   |                   |             |         |
| Lime Shell     |       |              | 1333 | 1335   |                   |             |         |
| Pencil Cave    |       |              | 1335 | 1338   |                   |             |         |
| Big Lime       |       |              | 1338 | 1465   | Gas               | 1433        |         |
| Injun Sand     |       |              | 1465 | 1493   | Gas               | 1468 - 1493 |         |
| Red Rock       |       |              | 1493 | 1547   |                   |             |         |
| Total Depth    |       |              | 1547 |        |                   |             |         |



(Over)

JUN 27 1945

