

Latitude $38^{\circ} 10'$

Longitude $81^{\circ} 25'$

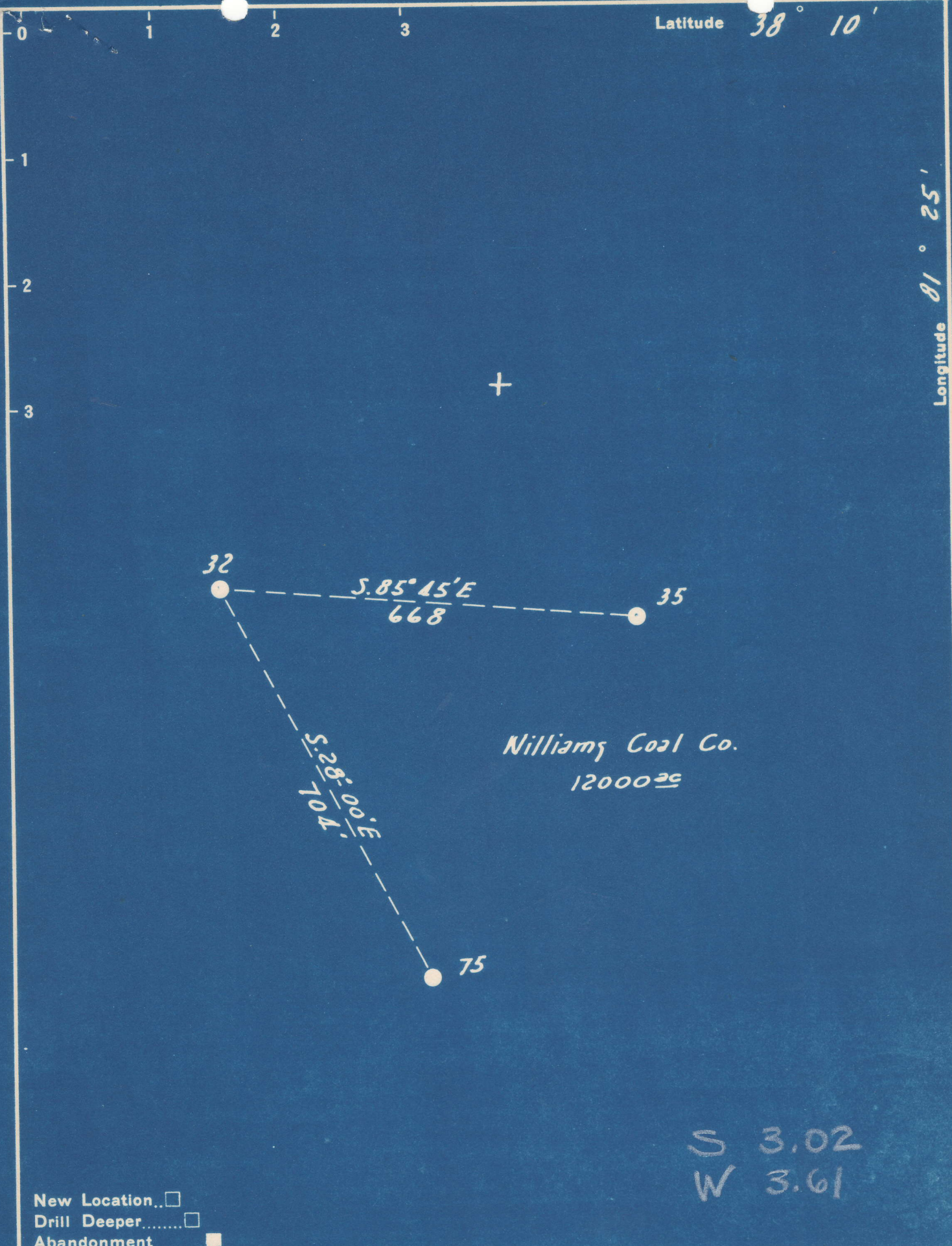

New Location
 Drill Deeper
 Abandonment

S 3.02
 W 3.61

Company The Pure Oil Co.
 Address Newark, Ohio
 Farm Williams Coal Co.
 Tract _____ Acres 12000 Lease No. 5012
 Well (Farm) No. 32 Serial No. 306
 Elevation (Spirit Level) 1591.5
 Quadrangle Montgomery WC
 County Kanawha District Cabin Creek
 Engineer J. B. Hunt
 Engineer's Registration No. Ohio-2912
 File No. _____ Drawing No. _____
 Date 11-22-19 Scale 1" = 200'

STATE OF WEST VIRGINIA
 DEPARTMENT OF MINES
 OIL AND GAS DIVISION
 CHARLESTON

WELL LOCATION MAP
 FILE NO. KAN-663-R

+ Denotes location of well on United States Topographic Maps, scale 1 to 62,500, latitude and longitude lines being represented by border lines as shown.
 - Denotes one inch spaces on border line of original tracing.

6-6-24

WILLIAMS COAL CO. NO. 32 WELL.

663A

Cabin Creek District, Kanawha County, W. Va.

By The Pure Oil Co., Box 551, Newark, Ohio.

Abandoned under permit Kan-.....-AT

On 12,000 acres, on Cabin Creek.

Elevation, 1591.5' L.

Surface and minerals owned by Shonk Land Co., 802 Kanawha Banking & Trust Bldg., Charleston, W. Va.

Drilling commenced May 25, 1916; completed June 7, 1917.

Shot June 12, 1918, at 3258-3263' and Aug. 24, 1925, at 3246-3263'; 1st shot, 5 qts.; 2nd shot, 50 qts.

Oil, 29 bbls.; 1st 24 hrs.

Salt water, 1765'.

10" casing, 1067'; 8 1/2", 1987'; 6 3/8", 2595'; 3" tubing, 3234'; all left in.

Coal was encountered at 915-920 and 1040-1043'.

Oil well. Now water injection well. Record to Dept. of Mines dated Dec. 15, 1949.

Record to RCT from Mrs. Griffith Sept. 9, 1950. Old File No. 1469.

	Top.	Bottom.
Conductor	0	10
Sand	10	100
Slate	100	150
Sand	150	165
Slate	165	270
Sand	270	310
Slate	310	330
Sand	330	380
Slate	380	405
Sand	405	495
Slate	495	515
Sand	515	525
Slate	525	550
Sand	550	575
Slate	575	585
Sand	585	605
Slate	605	625
Sand	625	655
Slate	655	685
Sand	685	735
Slate	735	745
Sand	745	785
Slate	785	805
Sand	805	815
Slate	815	820
Sand	820	845
Slate	845	850
Sand	850	875
Slate	875	915
Coal	915	920
Slate	920	930
Sand	930	960
Slate	960	975
Sand	975	1000
Slate	1000	1010
Sand	1010	1030
Slate	1030	1040

(OVER)

WILLIAMS COAL CO. NO. 32 WELL (Continued).

	Top.	Bottom.
Coal	1040	- 1043
Sand	1043	- 1100
Slate	1100	- 1105
Sand	1105	- 1125
Slate and lime	1125	- 1200
Sand	1200	- 1280
Slate	1280	- 1285
Sand	1285	- 1460
Slate	1460	- 1470
Grampus Sand	1470	- 1560
Lime	1560	- 1575
Slate	1575	- 1625
Salt Sand (hole full water, 1765')	1625	- 1970
Slate and lime	1970	- 1980
Sand	1980	- 2000
Lime shells	2000	- 2060
Slate and shells	2060	- 2100
Slate	2100	- 2130
Sand	2130	- 2190
Red rock	2190	- 2250
Slate	2250	- 2310
Red rock	2310	- 2320
Slate	2320	- 2330
Red rock	2330	- 2370
Slate	2370	- 2420
Red rock	2420	- 2455
Maxton Sand	2455	- 2465
Slate	2465	- 2485
Little Lime	2485	- 2535
Break in lime	2535	- 2540
Lime	2540	- 2550
Pencil Cave	2550	- 2555
Big Lime, black	2555	- 2580
Big Lime, white	2580	- 2795
Keener Sand	2795	- 2810
Big Injun Sand	2810	- 2840
Slate and shells	2840	- 3215
Black slate over sand	3215	- 3230
Berea Sand	3230	- 3263
Pay sand	3246	- 3263
Total depth		3265



STATE OF WEST VIRGINIA
DEPARTMENT OF MINES
OIL AND GAS DIVISION

1469

WELL RECORD

Permit No. KAN-1463-A

Oil or Gas Well Water Inj.
(KIND)

Company The Pure Oil Company
Address Box 551-Newark, Ohio
Farm Williams Coal Company Acres 12,000
Location (waters) Cabin Creek
Well No. 32 Elev. 1591.5
District Cabin Creek County Kanawha
The surface of tract is owned in fee by Shonk Land Co.
802 Kanawha Banking & Trust Co. Bldg.
Address Charleston, W. Va.
Mineral rights are owned by Shonk Land Co.
802 Kanawha Banking & Trust Co. Bldg. Charleston
Address W. Va.
Drilling commenced 5/25/16
Drilling completed 6/7/17 3258' 3263'
Date Shot 8/21/25 From 3246' To 3263'
With 1st. shot - 5 qts, 2nd. shot 50 qts.

Casing and Tubing	Used in Drilling	Left in Well	Packers
Size			
16			Kind of Packer
13			
10	1067'	1067'	Size of
8 1/4	1987'	None	
6 5/8	2595'	2595'	Depth set
5 3/16			
3	3234'	3234'	Perf. top
2			Perf. bottom
Liners Used			Perf. top
			Perf. bottom

Open Flow /10ths Water in _____ Inch
/10ths Merc. in _____ Inch
Volume _____ Cu. Ft.
Rock Pressure _____ lbs. _____ hrs.
Oil 29 bbls., 1st 24 hrs.
Fresh water _____ feet _____ feet
Salt water 1765' feet _____ feet

CASING CEMENTED _____ SIZE _____ No. Ft. _____ Date _____
COAL WAS ENCOUNTERED AT 915 FEET 60 INCHES
1010 FEET 36 INCHES FEET INCHES
FEET INCHES FEET INCHES

Formation	Color	Hard or Soft	Top	Bottom	Oil, Gas or Water	Depth Found	Remarks
Conductor			0	10			
Sand			10	100			
Slate			100	150			
Sand			150	165			
Slate			165	270			
Sand			270	310			
Slate			310	330			
Sand			330	380			
Slate			380	405			
Sand			405	495			
Slate			495	535			
Sand			515	525			
Slate			525	550			
Sand			550	575			
Slate			575	585			
Sand			585	605			
Slate			605	625			
Sand			625	655			
Slate			655	685			
Sand			685	735			
Slate			735	745			
Sand			745	785			
Slate			785	805			
Sand			805	815			
Slate			815	820			
Sand			820	845			
Slate			845	850			
Sand			850	875			
Slate			875	915			
Coal			915	920			
Slate			920	930			
Sand			930	960			
Slate			960	975			
Sand			975	1000			
Slate			1000	1010			
Sand			1010	1030			
Slate			1030	1040			

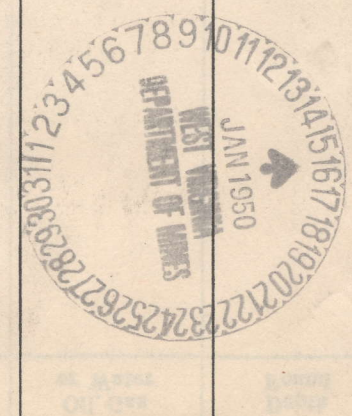

Formation	Color	Hard or Soft	Top	Bottom	Oil, Gas or Water	Depth Found	Remarks
Coal			1040	1043			
Sand			1043	1100			
Slate			1100	1105			
Sand			1105	1125			
Slate & lime			1125	1200			
Sand			1200	1280			
Slate			1280	1285			
Sand			1285	1460			
Slate			1460	1470			
Grampus			1470	1560			
Lime			1560	1575			
Slate			1575	1625			
SALT SAND			1625	1970	Water	1765'	Hole Full
Slate & Lime			1970	1980			
Sand			1980	2000			
Lime shells			2000	2060			
Slate & shells			2060	2100			
Slate			2100	2130			
Sand			2130	2190			
Red Rock			2190	2250			
Slate			2250	2310			
Red Rock			2310	2320			
Slate			2320	2330			
Red Rock			2330	2370			
Slate			2370	2420			
Red Rock			2420	2455			
MAXON SAND			2455	2465			
Slate			2465	2485			
Little Lime			2485	2535			
Break in Lime			2535	2540			
Lime			2540	2550			
Pencil Cave			2550	2555			
BIG LIME	black		2555	2580			
BIG LIME	white		2580	2795			
Keener sand			2795	2810			
INJUN SAND			2810	2810			
Slate & Shells			2810	3215			
Black Slate	Over sand		3215	3230			
BEREA SAND			3230	3263			
Pay Sand			3246	3263			
			TOTAL DEPTH	3265			

Date December 15, 1919

THE PURE OIL COMPANY
Box 551-Newark, Ohio

APPROVED _____, Owner

By Hard Willy
Senior Superintendent