

Latitude $38^{\circ} 10'$

Longitude $81^{\circ} 25'$

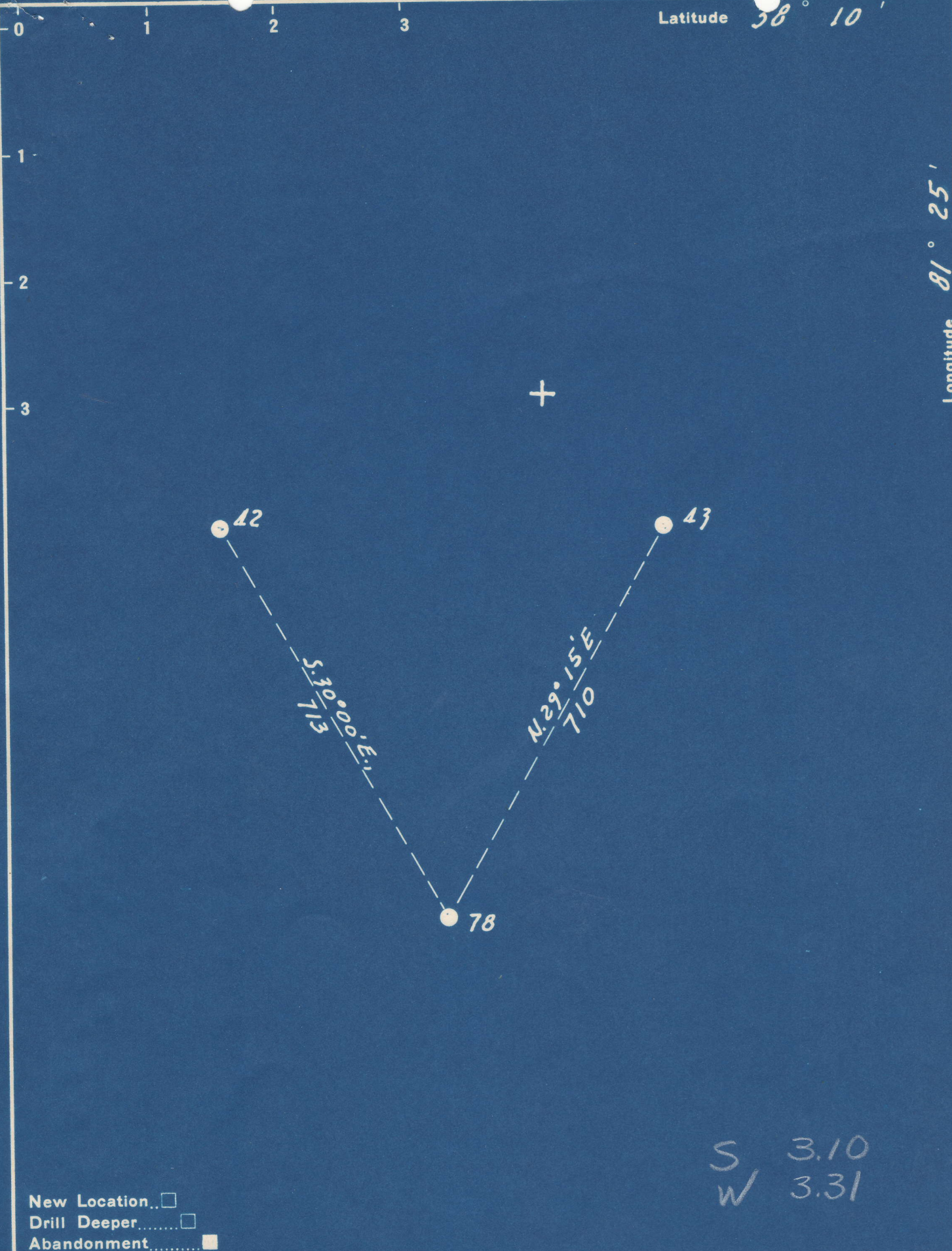

S 3.10
W 3.31

New Location...
 Drill Deeper.....
 Abandonment.....

Company The Pure Oil Co.
 Address Newark, Ohio
 Farm Williams Coal Co.
 Tract _____ Acres 12000 Lease No. 5012
 Well (Farm) No. 78 Serial No. 314
 Elevation (Spirit Level) 1396
 Quadrangle Montgomery WC
 County Kanawha District Cabin Cr.
 Engineer J. M. Hunter
 Engineer's Registration No. Ohio-2912
 File No. _____ Drawing No. _____
 Date 11-22-49 Scale 1" = 200'

STATE OF WEST VIRGINIA
 DEPARTMENT OF MINES
 OIL AND GAS DIVISION
 CHARLESTON

WELL LOCATION MAP
 FILE NO. KAN-672-A

+ Denotes location of well on United States Topographic Maps, scale 1 to 62,500, latitude and longitude lines being represented by border lines as shown.
 - Denotes one inch spaces on border line of original tracing.

650 240

WILLIAMS COAL CO. NO. 78 WELL.

672A

Cabin Creek District, Kanawha County, W. Va.

By The Pure Oil Co., Box 551, Newark, Ohio.

Abandoned under permit Kan-.....-A?

On 12,000 acres, on Cabin Creek.

Elevation, 1396' L.

Surface and minerals owned by Shonk Land Co., 802 Kanawha Banking & Trust Bldg., Charleston, W. Va.

Drilling commenced Feb. 26, 1917; completed July 20, 1918.

Shot July 30, 1918, at 3085-3100', with 60 qts.

10" casing, 923'; 8½", 1800' (pulled); 6½", 2431'; 2" tubing, 3131';
5½" liner, 457' 1".

Oil well. Record to Dept. of Mines dated Dec. 20, 1949.

Record to RCT from Mrs. Griffith Sept. 9, 1950. Old File No. 1473.

	Top.	Bottom.
Salt Sand	1450	- 1775
Little Lime	2350	- 2375
Big Lime	2406	- 2635
Big Injun Sand	2635	- 2665
Berea Grit (gas, 3083'; gas, 3085'; oil, 3085')	3069	- 3100
Total depth		3102



STATE OF WEST VIRGINIA
DEPARTMENT OF MINES
OIL AND GAS DIVISION

1473

WELL RECORD

Permit No. KAN-672-A

Oil or Gas Well Oil
(KIND)

Company The Pure Oil Company
Address Box 551 - Newark, Ohio
Farm Williams Coal Company Acres 12,000
Location (waters) Cabin Creek
Well No. 78 Elev. 1396
District Cabin Creek County Kanawha - W. Va.
The surface of tract is owned in fee by Shonk Land Co.
802 Kanawha Banking & Trust Co. Bldg. Address Charleston, W. Va.
Mineral rights are owned by Shonk Land Co.
802 Kanawha Banking & Trust Co. Bldg. Address Charleston, W. Va.
Drilling commenced 2/26/17
Drilling completed 7/20/18
Date Shot 7/30/18 From 3085 To 3100
With 60 qts.
Open Flow /10ths Water in Inch
/10ths Merc. in Inch
Volume Cu. Ft.
Rock Pressure lbs. hrs.
Oil bbls., 1st 24 hrs.
Fresh water feet feet
Salt water feet feet

Casing and Tubing	Used in Drilling	Left in Well	Packers
Size			
16			Kind of Packer
13			
10	923'	923'	Size of
8 3/4	1800'	Pulled	
6 5/8	2431'	2431'	Depth set
5 3/16			
3			Perf. top
2	3131'	3131'	Perf. bottom
Liners Used	5-3/16"	457'1"	Perf. top
			Perf. bottom

CASING CEMENTED SIZE No. Ft. Date
COAL WAS ENCOUNTERED AT FEET INCHES
 FEET INCHES FEET INCHES
 FEET INCHES FEET INCHES

Formation	Color	Hard or Soft	Top	Bottom	Oil, Gas or Water	Depth Found	Remarks
SALT SAND			1450	1775			
Little Lime			2350	2375			
BIG LIME			2406	2635			
BIG INJUN			2635	2665			
BEREA GRIT			3069	3100	Gas	3082'	
				3102	Gas	3085'	
					Oil	3085'	

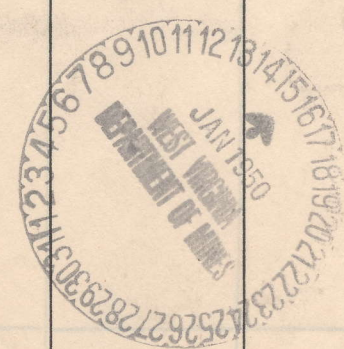

SEP - 9 1950

