

Latitude 38° 35'

Longitude 81° 25'

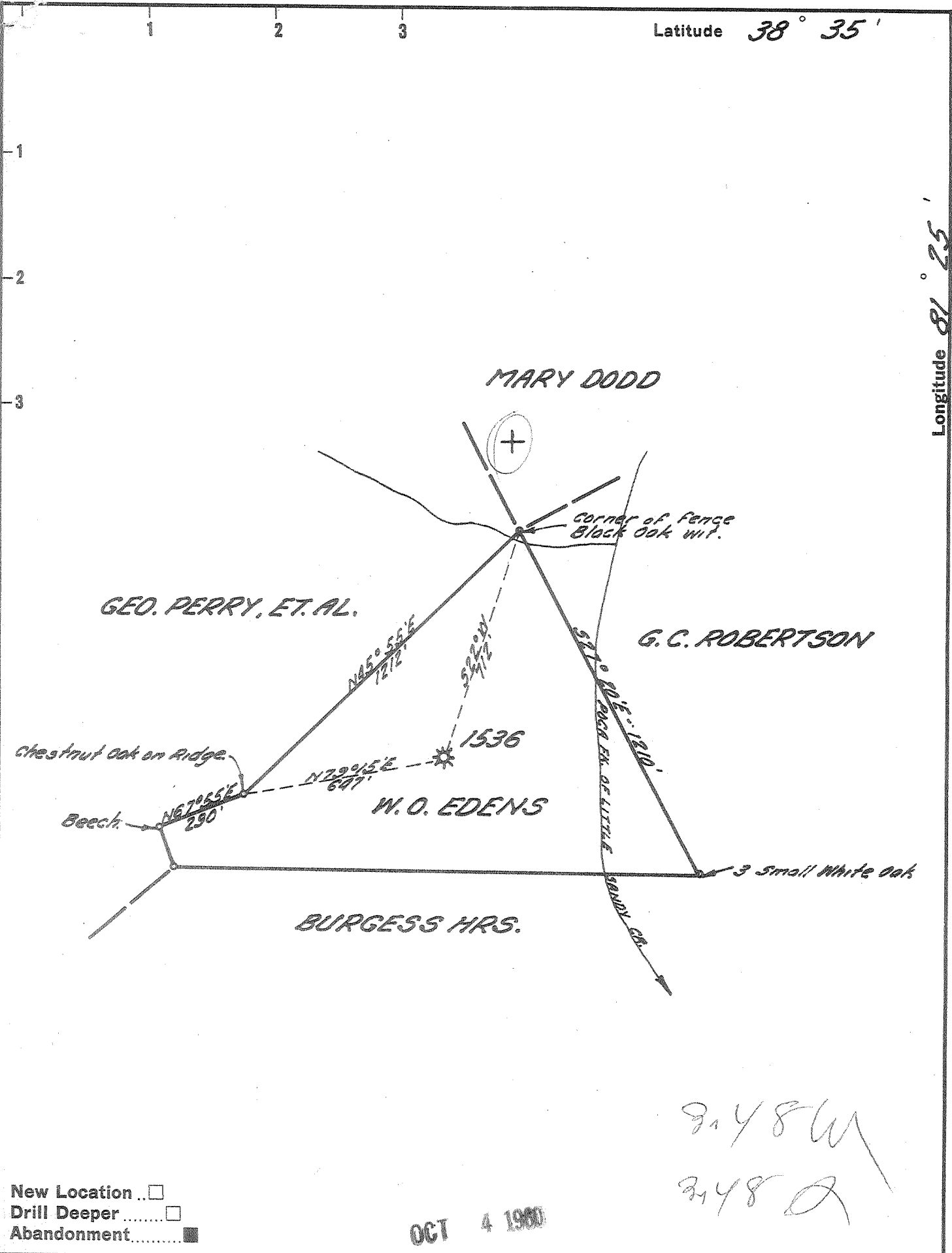

3148W
3148A

New Location
 Drill Deeper
 Abandonment

OCT 4 1960

Company UNITED FUEL GAS CO.
 Address CHARLESTON, W. VA.
 Farm W.O. EDENS
 Tract _____ Acres 20 Lease No. 140-38
 Well (Farm) No. _____ Serial No. 1536
 Elevation (Spirit Level) 1000.68'
 Quadrangle WALTON
 County KANAWHA District ELK
 Engineer Seybert Rhurell
 Engineer's Registration No. 2529
 File No. 70-71 Drawing No. _____
 Date 9-16-60 Scale 1" = 400'

STATE OF WEST VIRGINIA
 DEPARTMENT OF MINES
 OIL AND GAS DIVISION
 CHARLESTON

WELL LOCATION MAP
 FILE NO. KAN-1313-A

+ Denotes location of well on United States Topographic Maps, scale 1 to 62,500, latitude and longitude lines being represented by border lines as shown.

- Denotes one inch spaces on border line of original tracing.

G-6 192

W. O. EDENS No. 1536 - U. F. G. Co. - KAN-1313A



2072

STATE OF WEST VIRGINIA
DEPARTMENT OF MINES
OIL AND GAS DIVISION

Quadrangle Walton

Permit No. Kan-1313-A

WELL RECORD

Oil or Gas Well Gas
(KIND)

Company United Fuel Gas
Address P.O. Box 1273 - Charleston 25, W. Va.
Farm W. O. Edens Acres 20

Location (waters) Pocatalico Fork
Well No. 1536 Elev. 1000.68'
District Elk County Kanawha

The surface of tract is owned in fee by _____
Address _____

Mineral rights are owned by Marie Smith
100 Cora Street - Charleston, West Virginia
Address _____

Drilling commenced 11-14-25

Drilling completed 12-21-25

Date Shot _____ From _____ To _____

With _____

Open Flow _____ /10ths Water in _____ Inch

_____ /10ths Merc. in _____ Inch

Volume 650,000 Cu. Ft.

Rock Pressure 230 lbs. _____ hrs.

Oil _____ bbls., 1st 24 hrs.

WELL ACIDIZED _____

WELL FRACTURED _____

Casing and Tubing	Used in Drilling	Left in Well	Packers
Size			Kind of Packer
16			<u>Anchor set at</u>
13			<u>1902</u>
10			Size of
8 1/4	<u>606'</u>		
6 5/8	<u>1819'</u>	<u>1819'</u>	Depth set <u>1902</u>
5 3/16			
3	<u>2003'</u>	<u>2003'</u>	Perf. top <u>1979</u>
2			Perf. bottom _____
Liners Used			Perf. top <u>1938</u>
			Perf. bottom _____

CASING CEMENTED _____ SIZE _____ No. Ft. _____ Date _____

COAL WAS ENCOUNTERED AT _____ FEET _____ INCHES

_____ FEET _____ INCHES _____ FEET _____ INCHES

_____ FEET _____ INCHES _____ FEET _____ INCHES

RESULT AFTER TREATMENT _____

ROCK PRESSURE AFTER TREATMENT _____

Fresh Water _____ Feet _____ Salt Water _____ Feet _____

Formation	Color	Hard or Soft	Top	Bottom	Oil, Gas or Water	Depth	Remarks
Soil			0	10			
Red Rock			10	20			
Sand			20	100			
Blue Rock			100	180			
Red Rock			180	240			
Blue Rock			240	480			
Red Rock			480	525			
Slate			525	580			
Sand			580	740			
Slate and Shells			740	1140			
Sand			1140	1240			
Slate and Shells			1240	1280			
Salt Sand			1280	1500			
Slate			1500	1502			
Sand			1502	1550			
Lime			1550	1608			
Maxon Sand			1608	1750			
Little Lime			1750	1778			
Pencil Cave			1778	1786			
Big Lime			1786	1921			
Big Injun			1921	1955			
Slate			1955	1989			
Total Depth				1989'			

Hole reduced 1883
Show of gas in Big Lime 1894
Injun Gas 1929-1938 40/10 W 3"

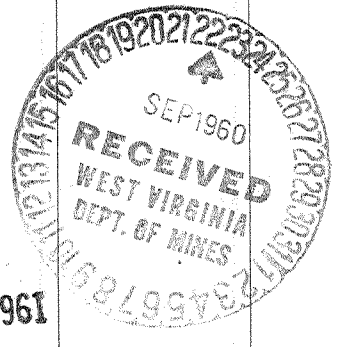

AUG 2 1961

(over)

W. O. EDENS No 1526

UFG Co

KAN-1313-A

