

NELLIE B. TOMPKINS ESTATE

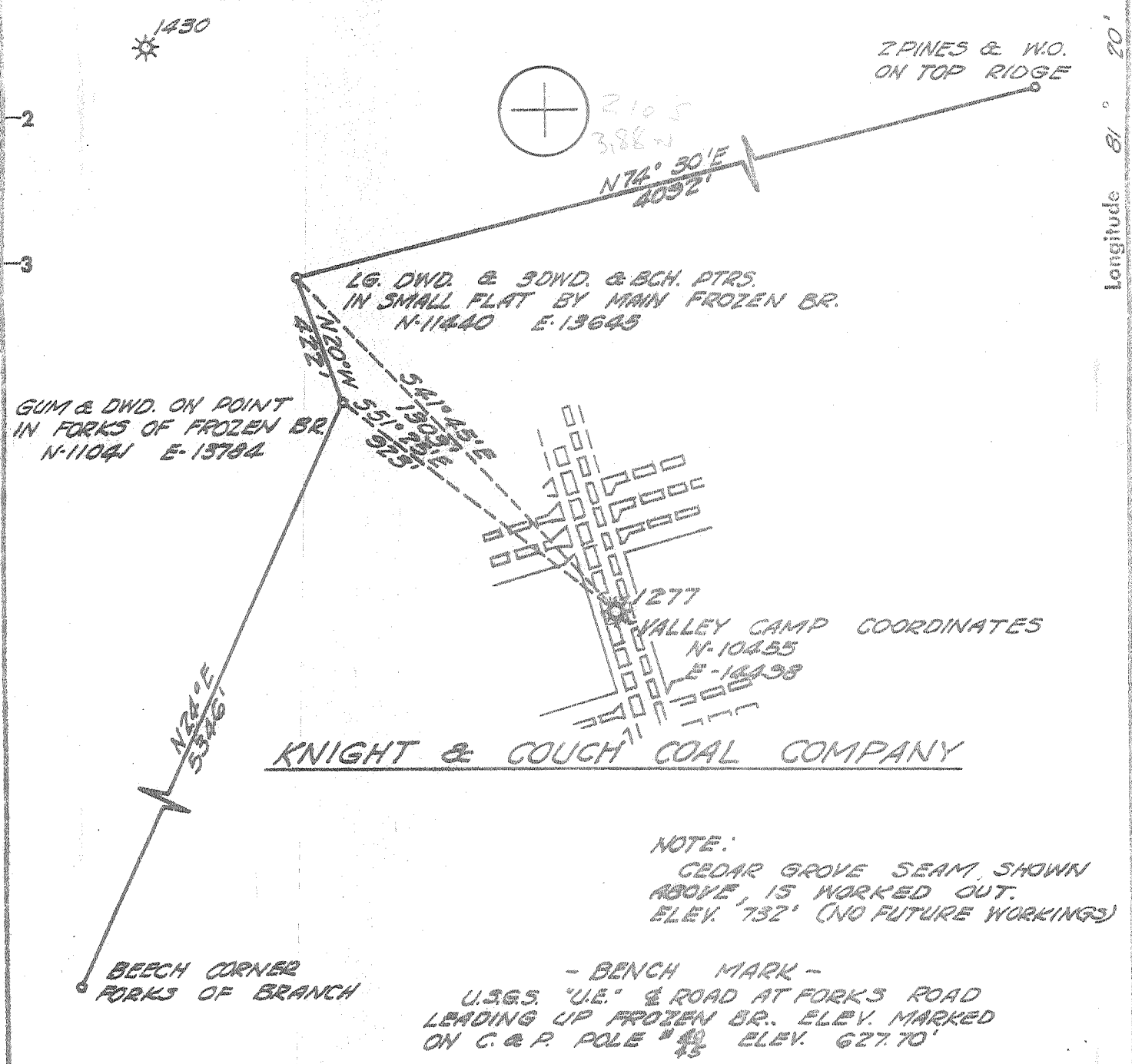

NOTE:
CEDAR GROVE SEAM, SHOWN ABOVE, IS WORKED OUT.
ELEV. 732' (NO FUTURE WORKINGS)

- BENCH MARK -
U.S.G.S. "U.E." & ROAD AT FORKS ROAD
LEADING UP FROZEN BR. ELEV. MARKED
ON C & P POLE #45 ELEV. 627.70'

Fracture	<u>Cane - 10-1-73</u>
Before 6/5/29	<input checked="" type="checkbox"/>
New Location	<input type="checkbox"/>
Drill Deeper	<input type="checkbox"/>
Redrill	<input type="checkbox"/>
Abandonment	<input checked="" type="checkbox"/>

I, the undersigned, hereby certify that this map is correct to the best of my knowledge and belief and shows all the information required by Paragraph 5 of the Rules and Regulations of the Oil and Gas Section of the Mining Laws of West Virginia.
The accuracy of this survey is within the limits and as prescribed in Paragraph 5 by the Oil and Gas Division of the Department of Mines Regulation.

Company COLUMBIA GAS TRANSMISSION CORP
 Address CHARLESTON, W. VA.
 Farm KNIGHT & COUCH COAL CO.
 Tract _____ Acres 692 Lease No. 17937
 Well (Farm) No. _____ Serial No. 1277
 Elevation (Spirit Level) 570.20
 Quadrangle MONTE MERY NC
 County KANAWHA District CABIN CREEK
 Engineer William E. Chapman
 Engineer's Registration No. 2330
 File No. 74-49 Drawing No. _____
 Date 4-19-73 Scale 1" = 400'

STATE OF WEST VIRGINIA
DEPARTMENT OF MINES
OIL AND GAS DIVISION
CHARLESTON

WELL LOCATION MAP

FILE NO. Ken-8-Tree-Cane
Revised As Ken-1432-A
 + Denotes location of well on United States Topographic Maps, scale 1 to 62,500 latitude and longitude lines being represented by border lines as shown.
 - Denotes one inch spaces on border line of original tracing. 47-039