

<b>WELL AW-317</b>	
NAD 83	LAT. 39°06'04.9765" LONG. 80°39'13.2495"
UTM NAD 83 (METERS)	N4328084.27 E529945.62

**MSES consultants, inc.**  
 FILE NO. 12-502-WellAW317-WellPlat  
 DRAWN BY HDW / MVS  
 SCALE 1" = 500'  
 MIN. DEGREE OF ACCURACY 1 IN 2500  
 PROVEN SOURCE OF ELEVATION:  
DGPS (SUBMETER MAPPING GRADE)

I, THE UNDERSIGNED, HEREBY CERTIFY THAT THIS PLAT IS CORRECT TO THE BEST OF MY KNOWLEDGE AND BELIEF, AND THAT IT SHOWS ALL INFORMATION REQUIRED BY LAW AND REGULATIONS ISSUED AND PRESCRIBED BY THE DEPARTMENT OF MINES.  
 (SIGNED) Hershel D. Ward  
 R.P.E. \_\_\_\_\_ P.S. 995



**STATE OF WEST VIRGINIA**  
 DEPARTMENT OF MINES  
**OIL AND GAS DIVISION**



DATE JULY 24 20 13  
 OPERATOR'S WELL NO. AW-317  
 API WELL NO.  
**47 041 02757R**  
 STATE COUNTY PERMIT NO.

WELL TYPE: OIL  GAS  LIQUID INJECTION  WASTE DISPOSAL   
 IF "GAS", PRODUCTION  STORAGE  DEEP  SHALLOW

LOCATION: ELEVATION 1129.32' WATERSHED UNNAMED TRIBUTARY OF FINK CREEK  
 DISTRICT FREEMANS CREEK COUNTY LEWIS  
 QUADRANGLE VADIS, WV 7.5' NEAREST TOWN FINK  
 SURFACE OWNER BERNARD McCUTCHEON ACREAGE 120.5  
 OIL & GAS ROYALTY OWNER LEEMAN MAXWELL LEASE ACREAGE 123.30  
 LEASE NO. FK002930

PROPOSED WORK: DRILL  CONVERT  DRILL DEEPER  REDRILL  FRACTURE OR STIMULATE   
 PLUG OFF OLD FORMATION  PERFORATE NEW FORMATION   
 OTHER PHYSICAL CHANGE IN WELL (SPECIFY) REWORK  
 PLUG AND ABANDON  CLEAN OUT AND REPLUG

TARGET FORMATION GANTZ ESTIMATED DEPTH 2450'  
 WELL OPERATOR DOMINION TRANSMISSION, INC. DESIGNATED AGENT MR. JAMES D. BLASINGAME  
 ADDRESS 445 WEST MAIN STREET ADDRESS 445 WEST MAIN STREET  
CLARKSBURG, WV 26301 CLARKSBURG, WV 26301

FORM IV-9

11/08/2013

COUNTY **041**  
 PERMIT NO. **02757**

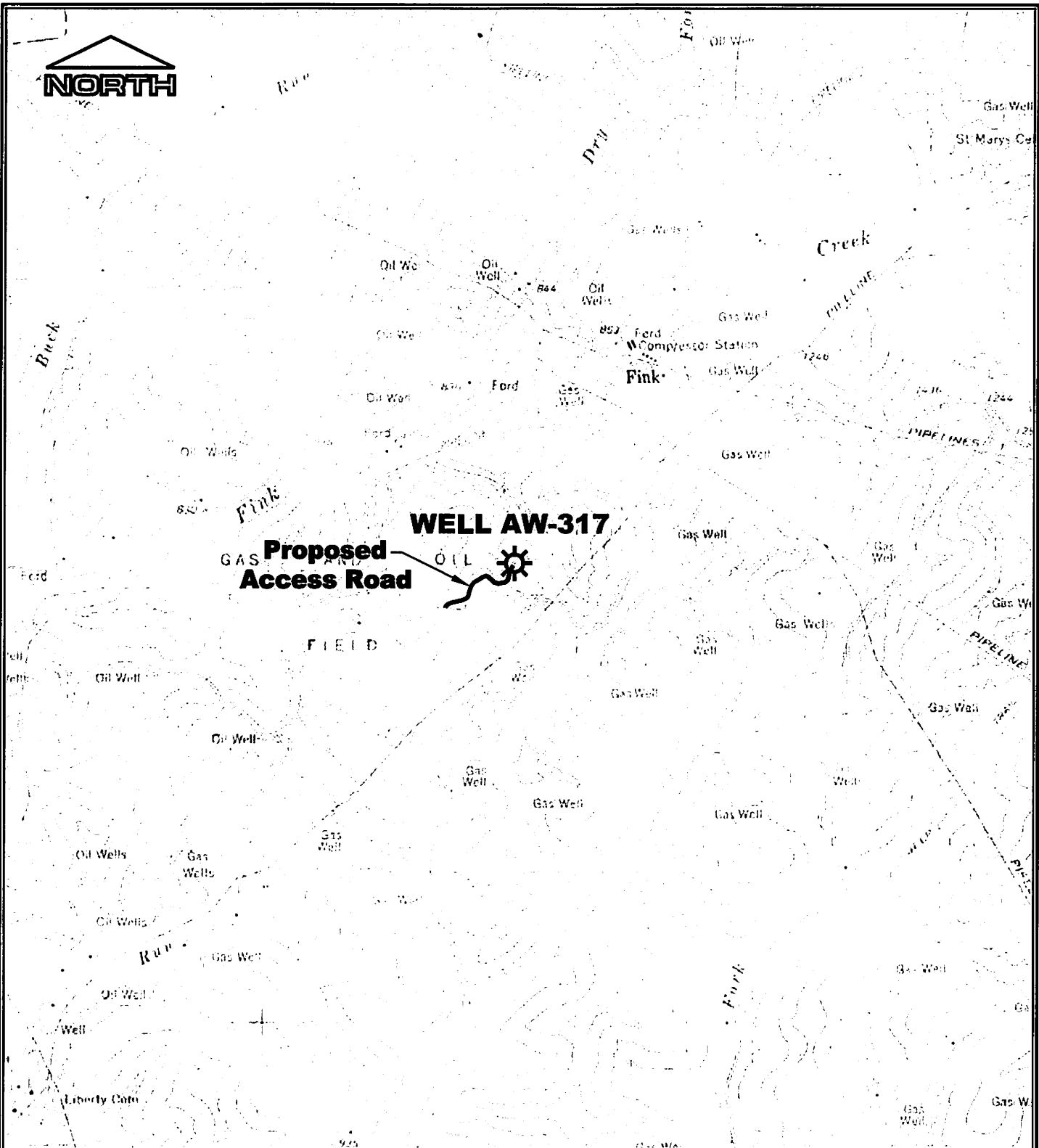

**WELL AW-317**  
**Proposed Access Road**

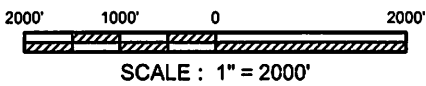

**REFERENCE**  
 U.S.G.S TOPOGRAPHIC MAP 7.5'  
 VADIS, W.V. 1964 PHOTOREVISED 1976

**DOMINION TRANSMISSION, INC.**

**WELL AW-317  
 LOCATION MAP**

Drawn by	KLA	7/13
Engineer	HDW	7/13
Checked by	RVS	7/13
		Date

Scale: AS SHOWN

1 of 1

Prepared by **MSES consultants, inc.**