

9,099' to Bottom Hole

4,308' to Top Hole

TOP LATITUDE 39 - 07 - 30
BTM LATITUDE 39 - 10 - 00

LONGITUDE 80 - 30 - 00
3,444' to Top Hole

2,135' to Bottom Hole

Tag	Bearing	Dist.	Description
L1	N 88°37' W	1,089.6'	#47-041-02619
L2	S 67°22' E	1,349.5'	#47-041-01847
L3	S 26°33' E	489.9'	Gate Post
L4	S 10°59' E	2,462.2'	5/8" Rebar w/cap
L5	N 44°25' E	978.1'	Landing point



I, the undersigned, hereby certify that this plat is correct to the best of my knowledge and belief and shows all the information required by law and the rules issued and prescribed by the Department of Environmental Protection.

Kevin S. James
Kevin S. James, P.S. 2305

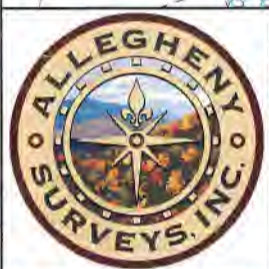

RECEIVED
Office of Oil and Gas
FEB 03 2021

WV Department of Environmental Protection

Notes:
Well No. Evans 1213 N-1H
UTM NAD 1983 (USSF)
Top Hole Coordinates
N: 14,205,092.28'
E: 1,777,976.99'
Landing Point Coordinates
N: 14,205,790.80'
E: 1,778,661.61'
Bottom Hole Coordinates
N: 14,221,545.52'
E: 1,773,094.48'

Notes: Well No. Evans 1213 N-1H
West Virginia Coordinate System of 1927, North Zone based upon Differential GPS Measurements.
Top Hole coordinates Latitude: 39°06'55.95" Longitude: 80°30'54.67" UTM Zone 17, NAD 1983
Bottom Hole coordinates Latitude: 39°09'38.89" Longitude: 80°31'55.56" UTM Zone 17, NAD 1983
Top Hole Coordinates N: 4,329,720.786m E: 541,928.470m
Bottom Hole Coordinates N: 4,334,735.744m E: 540,440.280m
Plat orientation and corner and well references are based upon the grid north meridian. Well location references are based upon the magnetic meridian.

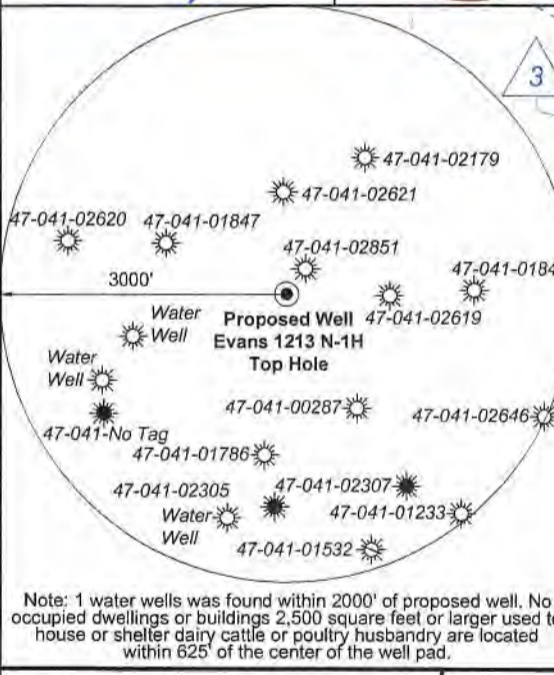

FILE NO: 235-36-12-19
DRAWING NO: Evans 1213 N-1H Well Plat
SCALE: 1" = 2000'
MINIMUM DEGREE OF ACCURACY: Submeter
PROVEN SOURCE OF ELEVATION: CORS, Bridgeport, WV

STATE OF WEST VIRGINIA
DEPARTMENT OF ENVIRONMENTAL PROTECTION
OIL AND GAS DIVISION

DATE: December 11 2020
OPERATOR'S WELL NO. Evans 1213 N-1H
API WELL NO MOD
47 - 041 - 05708
STATE COUNTY PERMIT

WELL TYPE: OIL GAS LIQUID INJECTION WASTE DISPOSAL
(IF GAS) PRODUCTION: STORAGE DEEP SHALLOW

LOCATION: ELEVATION: 1,227.6' WATERSHED: Middle West Fork Creek
DISTRICT: Freemans Creek
SURFACE OWNER: James M. & Suzanne L. Evans
ROYALTY OWNER: Mary C. Burnside, et al, et al LEASE NO: ACREAGE: 294.00

PROPOSED WORK: DRILL CONVERT DRILL DEEPER FRACTURE OR STIMULATE PLUG OFF OLD FORMATION
 PERFORATE NEW FORMATION OTHER PHYSICAL CHANGE IN WELL (SPECIFY) LP & BH MOD 6,760' TVD
 PLUG AND ABANDON CLEAN OUT AND REPLUG TARGET FORMATION: Marcellus Shale ESTIMATED DEPTH: 24,050' MD

WELL OPERATOR: HG Energy II Appalachia, LLC ADDRESS: 5260 Dupont Road Parkersburg, WV 26101
DESIGNATED AGENT: Diane C. White ADDRESS: 5260 Dupont Road Parkersburg, WV 26101



**Well Location References
Not to Scale**

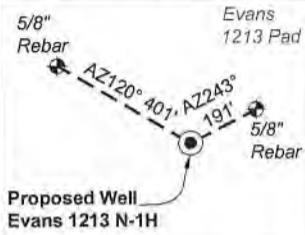

ID	Lease
3	C.M. Garrett, et al
4	Ira L. Queen, et al
5	Will E. Morris, et al
6	Clara Queen, et vir, et al
13	Robert T. Paugh, et al
14	Oma G. Hall, et al
16	Flodia B. Smith, et al
18	Lizzie B. Conley
19	Robert J. Paugh, et al
20	W.T. Highland, et al
26	J.S. Norris
27	Stephen Queen, et al
28	Silas E. Gochenour, et ux, et al
29	Lowman E. Garrett, et al
30	J.S. Hall, et ux
31	Mary C. Burnside, et al

Wellhead Layout (NTS)

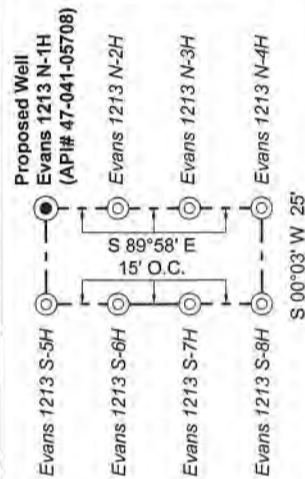

Legend

- Proposed gas well
- Well Reference, as noted
- Monument, as noted
- Existing Well, as noted
- Existing Plugged Well, as noted
- Digitized Well, as noted
- Creek or Drain
- Existing Road
- Surface boundary (approx.)
- Adjoiner surface tracts (approx.)

RECEIVED
Office of Oil and Gas
FEB 03 2021
WV Department of
Environmental Protection

Lewis Co. - Freeman Creek Dist.				
No.	TM / Par	Owner	Bk / Pg	Ac.
1	6C / 4	Suzanne L. & James M. Evans, III	657 / 228	294.00
2	6C / 21	Clarence C. Thacker, et al	445 / 493	166.25
3	6C / 3.2	John K. Burnside & Bertha F. Benedum	666 / 44	115.00
4	6C / 3	Phillip E. Burnside, et al	666 / 38	87.20
5	6C / 1	Brenda A. Stout, et al	W33 / 607	25.50
6	6C / 2	Phillip E. Burnside, et al	666 / 38	17.00
7	6B / 10	Michael Terrel Moss, et al	340 / 693	112.00
8	6B / 8	James C. Garrett, et al	621 / 578	47.00
9	6B / 7	Michael Terrel Moss, et al	340 / 693	10.00
10	6B / 6	James C. Garrett, et al	621 / 578	30.00
11	5B / 39	Edward E. Garrett, et al	429 / 245	55.00
12	6B / 5	Edward E. Garrett, et al	429 / 245	136.00
13	5B / 41	Michael J. Kirwan, III	720 / 812	51.00
14	5B / 36	James C. Garrett, et al	621 / 578	64.00
15	6B / 4	James C. Garrett, et al	621 / 578	92.50
16	5B / 35	Ruth U. Theofield Living Trust	740 / 840	96.69
17	6B / 2	Edward & Theresa M. Paugh (L/E)	746 / 831	78.25
18	5C / 47	James C. Garrett, et al	621 / 578	1.50
Harrison Co. - Union-Outside Dist.				
No.	TM / Par	Owner	Bk / Pg	Ac.
19	442 / 8.3	William Coffindaffer, et ux (LE)	1585 / 819	114.79
20	442 / 8	Mark J. Coffindaffer, et al	W160 / 415	119.78
21	442 / 8.1	Barbara Dawson & Misha McDonnie	W175 / 240	1.11
22	442 / 9.2	John R. & Jennifer L. Paugh	1365 / 585	5.59
23	442 / 7	Michael A. & Sarah G. Weaver	1592 / 1189	61.10
24	422 / 33	Mark J. Coffindaffer, et al	W160 / 415	125.70
25	422 / 32	Mike Ross, Inc.	1483 / 698	101.00
26	422 / 15.3	Carol Ann Nay, et al	1560 / 362	83.83
27	442 / 8.2	Pleasant Hill M.E. Church Trustees	188 / 197	0.40

FILE NO: 235-36-12-19
DRAWING NO: Evans 1213 N-1H Well Plat
SCALE: 1" = 2000'
MINIMUM DEGREE OF ACCURACY:
Submeter
PROVEN SOURCE OF ELEVATION:
CORS, Bridgeport, WV

STATE OF WEST VIRGINIA
DEPARTMENT OF ENVIRONMENTAL PROTECTION
OIL AND GAS DIVISION

DATE: December 11, 2020
OPERATOR'S WELL NO. Evans 1213 N-1H
API WELL NO 47-041-05708
STATE COUNTY PERMIT

WELL TYPE: OIL GAS LIQUID INJECTION WASTE DISPOSAL
(IF GAS) PRODUCTION: STORAGE DEEP SHALLOW

LOCATION: ELEVATION: 1,227.6' WATERSHED: Middle West Fork Creek
DISTRICT: Freemans Creek

Btm: Big Isaac
Top: Camden
QUADRANGLE: Lewis
COUNTY: Lewis
ACREAGE: 294.00

SURFACE OWNER: James M. & Suzanne L. Evans

ROYALTY OWNER: Mary C. Burnside, et al, et al

LEASE NO: _____ ACREAGE: 294.00

PROPOSED WORK: DRILL CONVERT DRILL DEEPER FRACTURE OR STIMULATE PLUG OFF OLD FORMATION
 PERFORATE NEW FORMATION OTHER PHYSICAL CHANGE IN WELL (SPECIFY) LP & BH MOD

PLUG AND ABANDON CLEAN OUT AND REPLUG TARGET FORMATION: Marcellus Shale ESTIMATED DEPTH: 6,760' TVD
24,050' MD

WELL OPERATOR: HG Energy II Appalachia, LLC
ADDRESS: 5260 Dupont Road
Parkersburg, WV 26101

DESIGNATED AGENT: Diane C. White
ADDRESS: 5260 Dupont Road
Parkersburg, WV 26101