

4704105765

SUBJECT WELL  
Van Wie 1221 N-6H

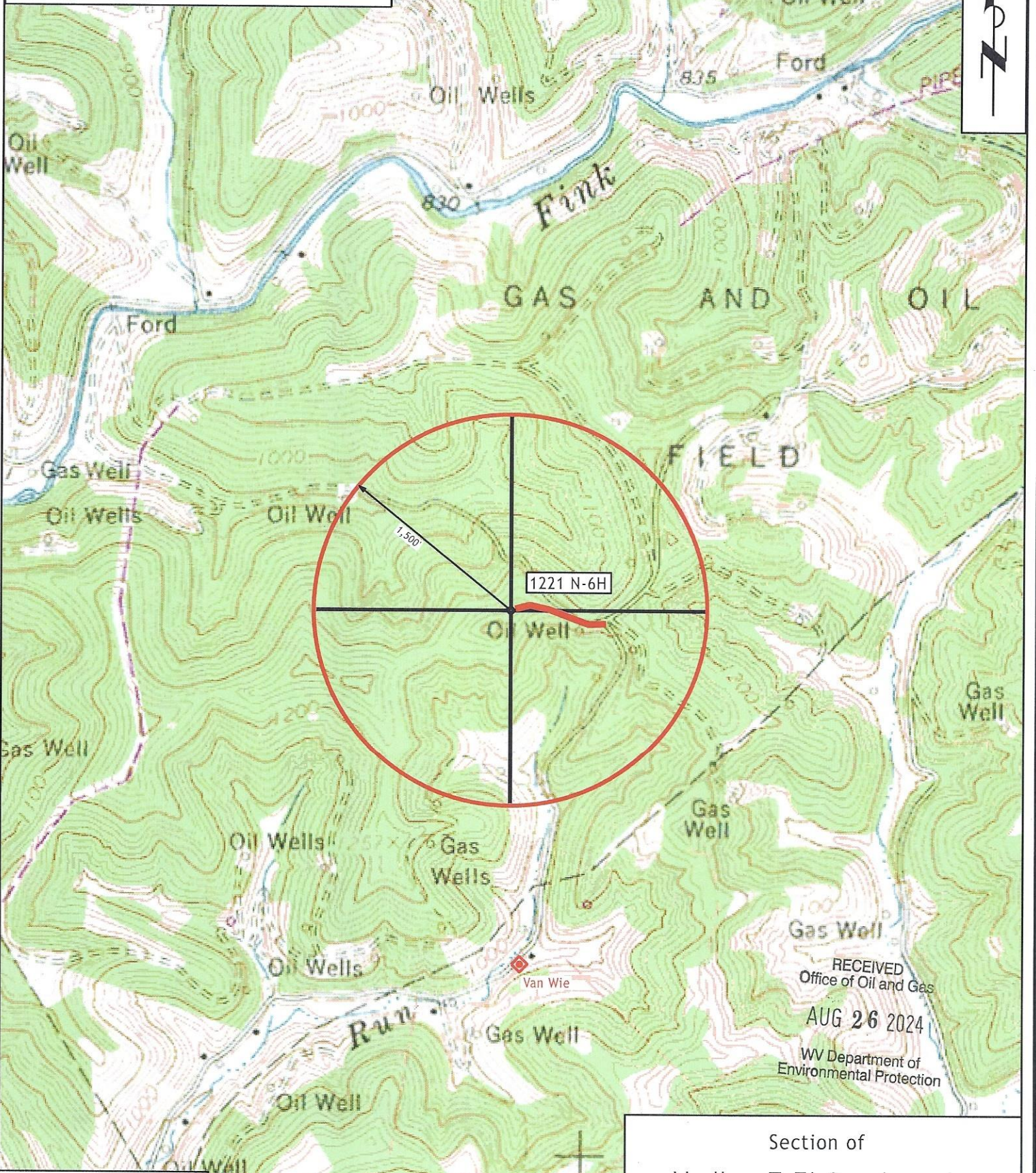

Denotes Possible Water Supply Source to be Tested

Section of  
Vadis 7.5' Quadrangle  
SCALE 1"=1000'

RECEIVED  
Office of Oil and Gas  
AUG 26 2024  
WV Department of  
Environmental Protection

10/04/2024



2,212' to Bottom Hole

508' to Top Hole

TOP LATITUDE 39 - 07 - 30  
BTM LATITUDE 39 - 10 - 00

TOP HOLE LONGITUDE 80 - 40 - 00  
BTM HOLE LONGITUDE 80 - 40 - 00

10,963' to Top Hole

10,077' to Bottom Hole

HG Energy II Appalachia, LLC  
Well No. Van Wie 1221 N-6H

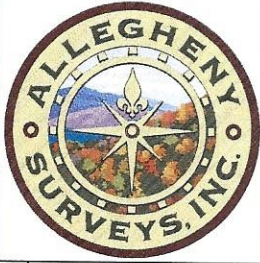

Page 1 of 2

Page 2 Match Line

Stone w/3  
notches on  
top of knob

5/8" Rebar w/cap

2" Iron Pipe

500' Buffer

47-041-01328

47-041-02747

47-041-05676

5/8" Rebar w/cap

Doddridge County  
Lewis County

2" Iron Pipe

Large Rock

Leading  
Creek

47-041-02657

47-041-01155

47-041-02660

47-041-02809

47-041-01176

47-041-01176

47-041-01176

47-041-01176

47-041-01176

47-041-01176

47-041-01176

47-041-01176

47-041-01176

47-041-01176

47-041-01176

47-041-01176

47-041-01176

47-041-01176

47-041-01176

47-041-01176

47-041-01176

47-041-01176

47-041-01176

47-041-01176

47-041-01176

47-041-01176

47-041-01176

47-041-01176

47-041-01176

47-041-01176

47-041-01176

47-041-01176

47-041-01176

47-041-01176

47-041-01176

47-041-01176

47-041-01176

47-041-01176

47-041-01176

47-041-01176

47-041-01176

47-041-01176

47-041-01176

47-041-01176

47-041-01176

47-041-01176

47-041-01176

47-041-01176

I, the undersigned, hereby  
certify that this plat is correct to  
the best of my knowledge and  
belief and shows all the  
information required by law and  
the rules issued and prescribed  
by the Department of  
Environmental Protection.

*Dwayne D. Matheny*

Dwayne D. Matheny, P.S. 2070

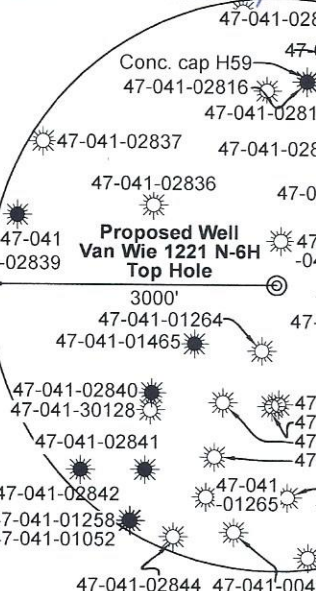

Note: 0 water wells, 0 cistern, and 0 pond were found within 1500' of proposed well. No occupied dwellings or buildings 2,500 square feet or larger used to house or shelter dairy cattle or poultry husbandry are located within 625' of the center of the well pad.

Tag	Bearing	Dist.	Description
L1	N 73°05' E	2,961.3'	5/8" Iron rebar
L2	S 75°33' E	2,821.5'	47-041-02839
L3	S 62°25' E	2,494.6'	5/8" Iron rebar
L4	S 29°35' W	1,617.6'	47-041-02809
L5	N 66°09' E	3,686.9'	Landing Point

FILE NO: 170-12-30-FC-22  
DRAWING NO: Van Wie 1221 N-6H Well Plat  
SCALE: 1" = 2000'  
MINIMUM DEGREE OF ACCURACY:  
Submeter  
PROVEN SOURCE OF ELEVATION:  
CORS, Bridgeport, WV

STATE OF WEST VIRGINIA  
DEPARTMENT OF ENVIRONMENTAL PROTECTION  
OIL AND GAS DIVISION

DATE: July 8 20 24  
OPERATOR'S WELL NO. Van Wie 1221 N-6H  
API WELL NO  
47 - 041 - 05765  
STATE COUNTY PERMIT

WELL TYPE:  OIL  GAS  LIQUID INJECTION  WASTE DISPOSAL  
(IF GAS) PRODUCTION:  STORAGE  DEEP  SHALLOW

LOCATION: ELEVATION: 1,251.77' WATERSHED: Fink Creek QUADRANGLE: Vadis  
DISTRICT: Freemans Creek COUNTY: Lewis

SURFACE OWNER: HG Energy II Appalachia, LLC, et al ACREAGE: 131.85  
ROYALTY OWNER: Joseph Krenn, et al LEASE NO: ACREAGE: 245

PROPOSED WORK:  DRILL  CONVERT  DRILL DEEPER  FRACTURE OR STIMULATE  PLUG OFF OLD FORMATION  
 PERFORATE NEW FORMATION  OTHER PHYSICAL CHANGE IN WELL (SPECIFY)

PLUG AND ABANDON  CLEAN OUT AND REPLUG TARGET FORMATION: Marcellus Shale ESTIMATED DEPTH: 7,035' TVD  
24,475' MD

WELL OPERATOR: HG Energy II Appalachia, LLC DESIGNATED AGENT: Diane C. White  
ADDRESS: 5260 Dupont Road ADDRESS: 5260 Dupont Road  
Parkersburg, WV 26101 Parkersburg, WV 26101

10/04/2024



HG Energy II Appalachia, LLC  
Well No. Van Wie 1221 N-6H

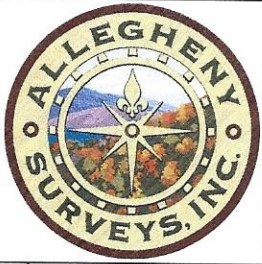

Page 2 of 2

Legend

- Proposed gas well
- Well Reference, as noted
- Monument, as noted
- Existing Well, as noted
- Existing Plugged Well, as noted
- Digitized Well, as noted
- Creek or Drain
- Existing Road
- Surface boundary (approx.)

Wellhead  
Layout (NTS)

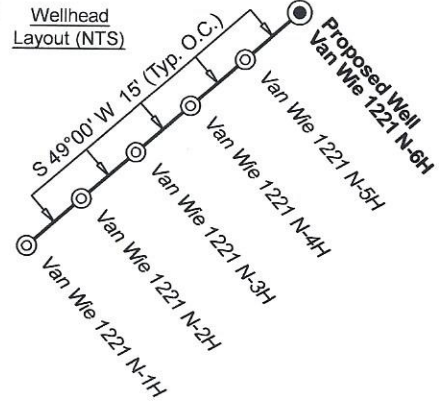

Well Location References  
Not to Scale



West Virginia Coordinate System of 1927, North Zone based upon Differential GPS Measurements.

Notes: Well No. Van Wie 1221 N-6H  
WVCS 1927, North Zone  
Top Hole Coordinates  
Lat: 39°05'41.60"  
Lon: 80°40'06.45"  
Landing Point Coordinates  
Lat: 39°05'56.22"  
Lon: 80°39'23.59"  
Bottom Hole Coordinates  
Lat: 39°08'20.36"  
Lon: 80°40'28.08"

UTM Zone 17, NAD 1983  
Plat orientation and corner and well references are based upon the grid north meridian. Well location references are based upon the magnetic meridian.

Notes: Well No. Van Wie 1221 N-6H UTM NAD 1983 (USSF) Top Hole Coordinates N: 14,197,376.01' E: 1,734,530.17' Landing Point Coordinates N: 14,198,866.97' E: 1,737,902.18' Bottom Hole Coordinates N: 14,213,425.94' E: 1,732,767.69'	Notes: Well No. Van Wie 1221 N-6H UTM NAD 1983 (Meters) Top Hole Coordinates N: 4,327,368.863m E: 528,685.853m Landing Point Coordinates N: 4,327,823.308m E: 529,713.644m Bottom Hole Coordinates N: 4,332,260.891m E: 528,148.648m
---	--

ID	Lease
1	J.C. Starcher & A.C. Starcher
2	HG Energy II Appalachia, LLC
3	Joseph Krenn, et ux
16	William Walsh
17	Frank J. Maxwell, et ux, et al
18	Lorena M. Fahey, et vir, et al
19	C.E. Lawhead, et ux, et al
20	Leeman Maxwell, et al
21	Dennis Conry & Maggie Conry
22	Virginia Trimble, et al
25	Emma Droppleman, et al
28	R.A. Droppleman, et ux, et al

Lewis Co. (Freemans Creek Dist.)				
No.	TM / Par	Owner	Bk / Pg	Ac.
1	2D / 3	HG Energy II Appalachia, LLC	800 / 637	131.85
2	2D / 29	Anthony S. & Dawn H. VanWie	732 / 622	26.63
3	2D / 30	Anthony S. & Dawn H. VanWie	732 / 622	19.00
4	2D / 37	Jacob R. Straley Heirs	728 / 53	97.00
5	2D / 45	Matthew D. & Linda S. Richards	553 / 117	54.00
6	2D / 3.1	HG Energy II Appalachia, LLC	800 / 637	20.00
7	2D / 38	William J. & Ann McCutchan	793 / 173	26.96
8	2D / 40	Judith A. Rioch	403 / 270	63.89
9	2D / 42	Frances McCutchan, et al	726 / 561	124.30
10	2C / 7	James R. & Sheila A. Gum, II	721 / 350	350.78
11	2C / 9	William & Anne McCutchan	683 / 426	46.04
12	2C / 10	William & Anne McCutchan	683 / 426	1.04
13	2C / 8	Frances McCutchan	726 / 561	9.00
14	2C / 12	Frances McCutchan, et al	726 / 561	159.75
15	2C / 11	Robert E. & Joyce E. McCutchan	775 / 930	91.14
16	2C / 13	Jenny E. Dropplemann, et al	740 / 25	97.00
17	2C / 14	Jenny E. Dropplemann, et al	740 / 25	16.00
18	2C / 15	Jenny E. Dropplemann, et al	740 / 25	107.25
19	2C / 27	Dorothy K. Downey & Frank A. Altomare, Jr	418 / 615	90.90
Doddridge Co. (Cove Dist.)				
No.	TM / Par	Owner	Bk / Pg	Ac.
20	10 / 15	Scott Flanagan, et al	W44 / 594	98.44
21	10 / 15.1	Scott Flanagan, et al	239 / 591	101.56
22	6 / 11.1	Florence A. Adams	W103 / 448	102.00
23	7 / 2	Florence A. Adams	W103 / 448	292.87

FILE NO: 170-12-30-FC-22  
DRAWING NO: Van Wie 1221 N-6H Well Plat  
SCALE: 1" = 2000'  
MINIMUM DEGREE OF ACCURACY: Submeter  
PROVEN SOURCE OF ELEVATION: CORS, Bridgeport, WV

STATE OF WEST VIRGINIA  
DEPARTMENT OF ENVIRONMENTAL PROTECTION  
OIL AND GAS DIVISION

DATE: July 8 20 24  
OPERATOR'S WELL NO. Van Wie 1221 N-6H  
API WELL NO  
47 - 041 - 05765  
STATE COUNTY PERMIT

WELL TYPE:  OIL  GAS  LIQUID INJECTION  WASTE DISPOSAL  
(IF GAS) PRODUCTION:  STORAGE  DEEP  SHALLOW

LOCATION: ELEVATION: 1,251.77' WATERSHED: Fink Creek QUADRANGLE: Vadis  
DISTRICT: Freemans Creek COUNTY: ~~Wayne~~ **10/04/2024**  
SURFACE OWNER: HG Energy II Appalachia, LLC, et al ACREAGE: 131.85  
ROYALTY OWNER: Joseph Krenn, et al LEASE NO: ACREAGE: 245  
PROPOSED WORK:  DRILL  CONVERT  DRILL DEEPER  FRACTURE OR STIMULATE  PLUG OFF OLD FORMATION  
 PERFORATE NEW FORMATION  OTHER PHYSICAL CHANGE IN WELL (SPECIFY)  
 PLUG AND ABANDON  CLEAN OUT AND REPLUG TARGET FORMATION: Marcellus Shale ESTIMATED DEPTH: 7,035' TVD 24,475' MD

WELL OPERATOR: HG Energy II Appalachia, LLC DESIGNATED AGENT: Diane C. White  
ADDRESS: 5260 Dupont Road ADDRESS: 5260 Dupont Road  
Parkersburg, WV 26101 Parkersburg, WV 26101