

HG Energy II Appalachia, LLC  
Well No. Van Wie 1221 S-7H

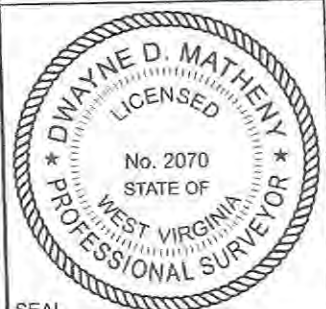

Page 1 of 2



I, the undersigned, hereby certify that this plat is correct to the best of my knowledge and belief and shows all the information required by law and the rules issued and prescribed by the Department of Environmental Protection.

*Dwayne D. Matheny*  
Dwayne D. Matheny, P.S. 2070

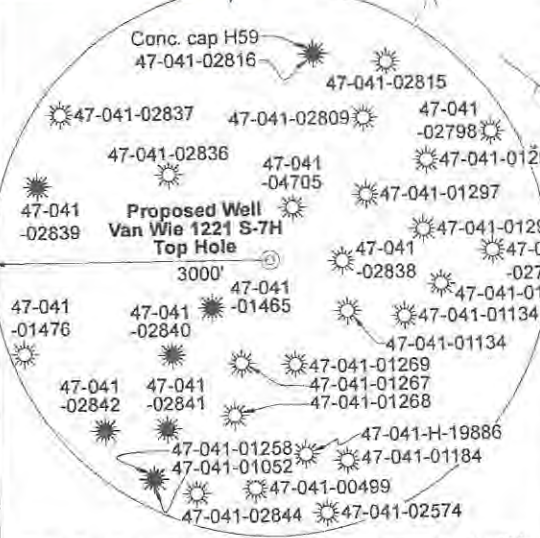

Note: 0 water wells, 0 cistern, and 0 pond were found within 1500' of proposed well. No occupied dwellings or buildings 2,500 square feet or larger used to house or shelter dairy cattle or poultry husbandry are located within 625' of the center of the well pad.

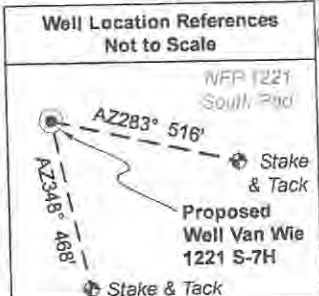

Tag	Bearing	Dist.	Description
L1	N 74°29' E	2,657.1'	5/8" Iron rebar
L2	S 70°50' E	2,603.7'	47-041-02839
L3	S 59°42' E	3,499.0'	5/8" Iron rebar
L4	S 34°31' W	1,890.5'	47-041-02809
L5	S 47°03' W	1,108.8'	Landing Point

FILE NO: 170-12-30-FC-22  
DRAWING NO: Van Wie 1221 S-7H Well Plat-S  
SCALE: 1" = 2000'  
MINIMUM DEGREE OF ACCURACY: Submeter  
PROVEN SOURCE OF ELEVATION: CORS, Bridgeport, WV

**STATE OF WEST VIRGINIA**  
DEPARTMENT OF ENVIRONMENTAL PROTECTION  
**OIL AND GAS DIVISION**

DATE: September 13, 2024  
OPERATOR'S WELL NO. Van Wie 1221 S-7H  
API WELL NO. 47-041-05166  
STATE COUNTY PERMIT

WELL TYPE:  OIL  GAS  LIQUID INJECTION  WASTE DISPOSAL  
(IF GAS) PRODUCTION:  STORAGE  DEEP  SHALLOW

LOCATION: ELEVATION: 1,251.77' WATERSHED: Fink Creek  
DISTRICT: Freemans Creek  
SURFACE OWNER: HG Energy II Appalachia, LLC, et al  
ROYALTY OWNER: Joseph Krenn, et al LEASE NO: ACREAGE: 11/08/2024

PROPOSED WORK:  DRILL  CONVERT  DRILL DEEPER  FRACTURE OR STIMULATE  PLUG OFF OLD FORMATION  
 PERFORATE NEW FORMATION  OTHER PHYSICAL CHANGE IN WELL (SPECIFY) 7,035' TVD  
 PLUG AND ABANDON  CLEAN OUT AND REPLUG TARGET FORMATION: Marcellus Shale ESTIMATED DEPTH: 18,748' MD

WELL OPERATOR: HG Energy II Appalachia, LLC  
ADDRESS: 5260 Dupont Road, Parkersburg, WV 26101

DESIGNATED AGENT: Diane C. White  
ADDRESS: 5260 Dupont Road, Parkersburg, WV 26101

HG Energy II Appalachia, LLC  
Well No. Van Wie 1221 S-7H



Page 2 of 2

West Virginia Coordinate System of 1927, North Zone based upon Differential GPS Measurements.

UTM Zone 17, NAD 1983  
Plat orientation and corner and well references are based upon the grid north meridian. Well location references are based upon the magnetic meridian.

Notes: Well No. Van Wie 1221 S-7H  
WVCS 1927, North Zone  
Top Hole Coordinates  
Lat: 39°05'40.12"  
Lon: 80°40'09.92"  
Landing Point Coordinates  
Lat: 39°05'32.68"  
Lon: 80°40'20.25"  
Bottom Hole Coordinates  
Lat: 39°03'50.29"  
Lon: 80°39'34.47"

Notes: Well No. Van Wie 1221 S-7H  
UTM NAD 1983 (USSF)  
Top Hole Coordinates  
N: 14,197,225.17'  
E: 1,734,257.28'  
Landing Point Coordinates  
N: 14,196,469.59'  
E: 1,733,445.83'  
Bottom Hole Coordinates  
N: 14,186,128.18'  
E: 1,737,092.93'

Notes: Well No. Van Wie 1221 S-7H  
UTM NAD 1983 (Meters)  
Top Hole Coordinates  
N: 4,327,322.886m  
E: 528,602.676m  
Landing Point Coordinates  
N: 4,327,092.585m  
E: 528,355.346m  
Bottom Hole Coordinates  
N: 4,323,940.57m  
E: 529,466.984m

ID	Lease
6	Joseph Krenn, et ux
7	HG Energy II Appalachia, LLC
10	M.C. Marsh, et al
11	L.B. Gaston, et ux, et al
12	HG Energy II Appalachia, LLC
13	H.P. Queen, et ux, et al
45	HG Energy II Appalachia, LLC
51	Riverside Farm Livestock and Woodland, LLC
52	S.R. Harrison, Jr., et ux, et al

RECEIVED  
Office of Oil and Gas  
OCT 03 2024  
The Department of Environmental Protection



Lewis Co. (Freemans Creek Dist.)				
No.	TM / Par	Owner	Bk / Pg	Ac.
1	2D / 3	HG Energy II Appalachia, LLC	800 / 637	131.85
2	2D / 28	Donna Davidovich & Cheryl Casey	349 / 280	9.75
3	2D / 29	Anthony S. & Dawn H. VanWie	732 / 622	26.63
4	2D / 31	Anthony S. & Dawn H. VanWie	732 / 622	73.10
5	2D / 26	M.P. & D.M. Davidovich	539 / 131	22.50
6	2D / 25	M.P. & D.M. Davidovich	539 / 131	16.00
7	2D / 19	M.P. & D.M. Davidovich	539 / 131	4.50
8	2D / 18.1	Anthony S. & Dawn H. VanWie	732 / 622	6.10
9	2D / 32	Arthur A. Ruble	544 / 536	58.00
10	2D / 33	Anthony S. & Dawn H. VanWie	732 / 622	19.00
11	2E / 41	Charles M. & Katie D. Groah	575 / 205	15.50
12	2E / 41.1	David B. Lang	717 / 614	72.75
13	2E / 39	Carl G. White, III, et al	544 / 734	126.50
14	2E / 40	Kevin Finneyfrock	620 / 774	40.00
15	2E / 42	Elana D. Burnett, et al	W21 / 187	50.00
16	2E / 36	Kevin Finneyfrock	620 / 774	25.00
17	2E / 35	Kevin Finneyfrock	620 / 774	40.00
18	2E / 35.1	Kevin Finneyfrock	620 / 774	4.14
19	2E / 45	Paul J. Groah & James C. Empoules	723 / 719	173.00
20	2E / 31.1	Craig T. Pospech, et al	FID / 652	10.00
21	2E / 31.19	Jeri L. Pospech	670 / 613	3.90
22	2E / 31.24	Jeri L. Pospech	670 / 613	4.74
23	2E / 31	Michael R. Bryant	537 / 178	2.10
24	2E / 31.25	Michael R. Bryant	537 / 178	4.98
25	2E / 31.23	Jeri L. Pospech	670 / 613	4.74
26	2E / 46	Emily M. & Carlton E. Jones, II	734 / 928	130.00
27	2E / 54	Emily M. & Carlton E. Jones, II	734 / 928	47.44
28	2E / 47	Edward Labbe	336 / 239	30.00

FILE NO: 170-12-30-FC-22  
DRAWING NO: Van Wie 1221 S-7H Well Plat-S  
SCALE: 1" = 2000'  
MINIMUM DEGREE OF ACCURACY:  
Submeter  
PROVEN SOURCE OF ELEVATION:  
CORS, Bridgeport, WV

STATE OF WEST VIRGINIA  
DEPARTMENT OF ENVIRONMENTAL PROTECTION  
OIL AND GAS DIVISION

DATE: September 13 20 24  
OPERATOR'S WELL NO. Van Wie 1221 S-7H  
API WELL NO  
47 - 041 - 05166  
STATE COUNTY PERMIT

WELL TYPE:  OIL  GAS  LIQUID INJECTION  WASTE DISPOSAL  
(IF GAS) PRODUCTION:  STORAGE  DEEP  SHALLOW

LOCATION: ELEVATION: 1,251.77' WATERSHED: Fink Creek  
DISTRICT: Freemans Creek

QUADRANGLE: Vadis  
COUNTY: Lewis

SURFACE OWNER: HG Energy II Appalachia, LLC, et al  
ROYALTY OWNER: Joseph Krenn, et al

ACREAGE: 131.85  
11/08/2024  
ACREAGE: 245

PROPOSED WORK:  DRILL  CONVERT  DRILL DEEPER  FRACTURE OR STIMULATE  PLUG OFF OLD FORMATION  
 PERFORATE NEW FORMATION  OTHER PHYSICAL CHANGE IN WELL (SPECIFY)

PLUG AND ABANDON  CLEAN OUT AND REPLUG TARGET FORMATION: Marcellus Shale ESTIMATED DEPTH: 7,035' TVD 18,748' MD

WELL OPERATOR: HG Energy II Appalachia, LLC  
ADDRESS: 5260 Dupont Road  
Parkersburg, WV 26101

DESIGNATED AGENT: Diane C. White  
ADDRESS: 5260 Dupont Road  
Parkersburg, WV 26101