

LATITUDE 39° 00' 00"

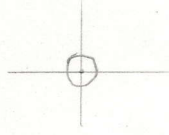

00° 58' 00" LONGITUDE

7'5 OGIS topo location

7.5' loc	<u>0.413</u>	15' loc	_____
	<u>1.69w</u>	(calc.)	_____

Company _____

Farm _____

Quad PETERSON 7 1/2'

County LEWIS

District COURT HOUSE

WELL LOCATION MAP

File No. 041-57A

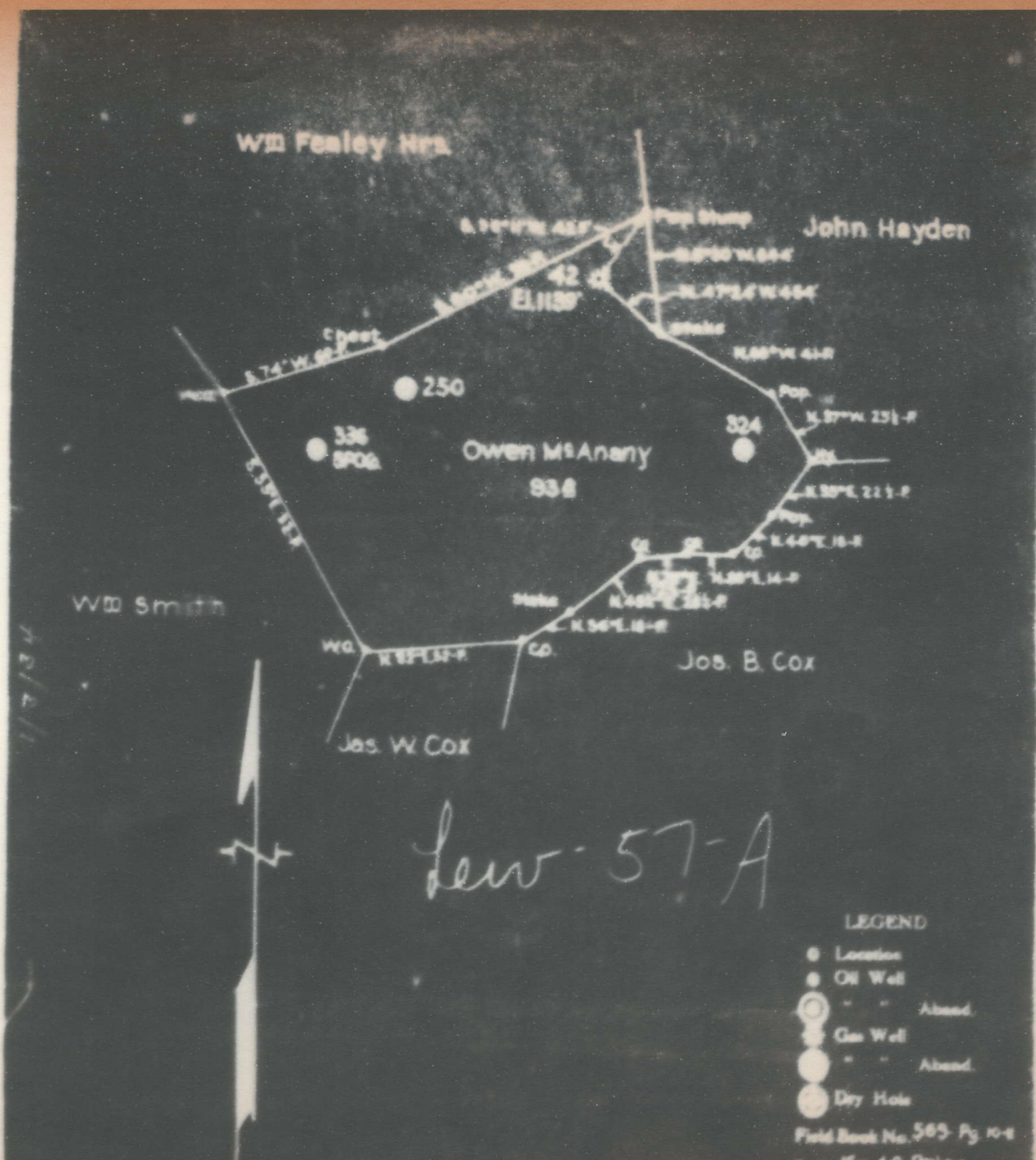

LEGEND
 ● Location
 ● Oil Well
 ○ " " Aband.
 ● Gas Well
 ○ " " Aband.
 ● Dry Hole
 Field Book No. 565 Pg. 10-8
 Scale: 1" = 40 Poles
 12-28-1933

ENGINEERS CERTIFICATE

I, the undersigned, hereby certify that this map is correct and shows all the information to the best of my knowledge and belief, required by the oil and gas section of the mining laws of West Virginia.

[Redacted Signature]

Acknowledged before me a Notary Public in and for the County of Harrison and State of West Virginia

57A

Court House District, Lewis County, W. Va.
 Hope Natural Gas Co., 445 W. Main St., Clarksburg, W. Va.
 On 93 acres, surface owned by Owen McAnainey, Weston, W. Va.
 Elevation, 1139' L.
 6-5/8" casing, 2189'.
 Coal was encountered at 420-424 (est. thickness).
 Abandonment reported to Dept. of Mines Dec. 29, 1933.
 Well was shot at 2952-2957'.
 No record of water.
 Gas well; now declined to the extent that it is no longer
 commercially productive.

	Top.	Bottom.
Pittsburgh Coal	420	- (424?)
Dunkard Sand	1065	- 1120
Salt Sand	1300	- 1360
Big Lime	2085	- 2130
Big Injun Sand	2130	- 2305
Gordon Stray Sand	2755	- 2764
Gordon Sand (show gas, 2780')	2778	- 2790
Fifth Sand (gas, 2955')	2952	- 2957
Total depth		2980