

LATITUDE 39° 10' 00"

LONGITUDE 80° 32' 30"

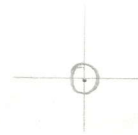

C, P, O

T'5 OGIS topo location

7.5' loc	<u>2.585</u>	15' loc	<u>2.585</u>
	0.82 W	(calc.)	<u>3.05 W</u>

Company _____

Farm _____

Nadis EC

Quad BIG ISAAC 7 1/2'

County LEWIS

District FREEMANS CREEK

WELL LOCATION MAP

File No. 041-67A

(wa213)

LOCATION OF WELL N^o 1965

PITTSBURGH & W.VA. GAS COMPANY OF PITTSBURGH, PA.

LEASE NO. 5277 LESSOR DRUELLA THOMS ACRES 33.53

DISTRICT FREEMANS CREEK COUNTY LEWIS STATE W.VA.

QTR. QUADRANGLE VADIS N.E. 43 DATE JUNE 14, 1934 NO. ON LEASE

LEASE EXPIRES F. RESERVATION ELEVATION 1184.6

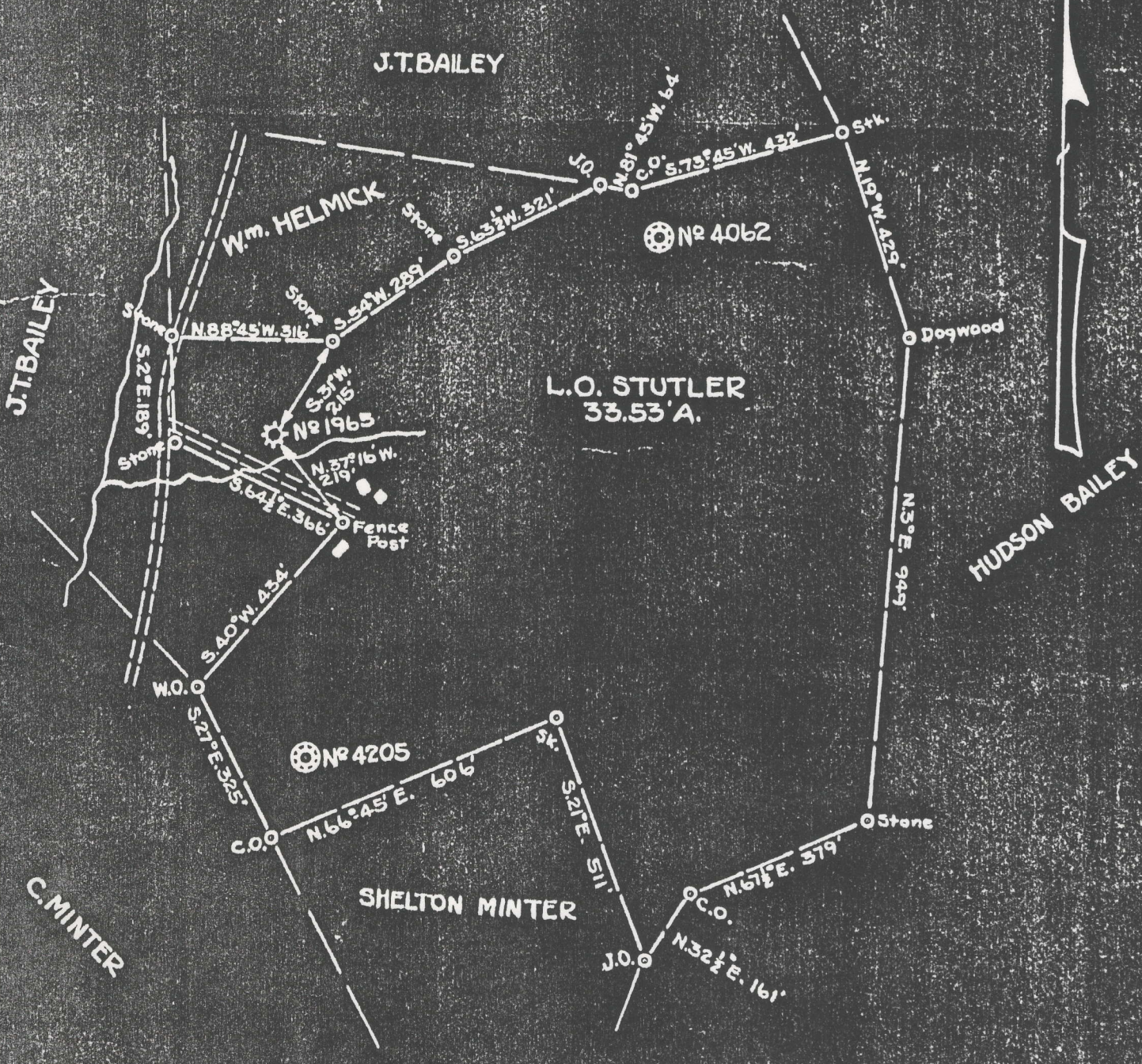

SCALE: 1" = 300'

ENGINEER'S CERTIFICATE

I, THE UNDERSIGNED, HEREBY CERTIFY THAT THIS MAP IS CORRECT AND SHOWS ALL THE INFORMATION TO THE BEST OF MY KNOWLEDGE AND BELIEF, REQUIRED BY THE OIL AND GAS SECTION OF THE MINING LAWS OF WEST VIRGINIA.

James P. Jeffries
ENGINEER.

ACKNOWLEDGED BEFORE ME, A NOTARY PUBLIC, THIS 14th DAY OF June 19 34
My Commission expires March 23rd, 1943.

W.C. McMaster
NOTARY PUBLIC.

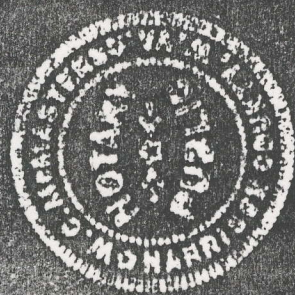

1967A

Freemans Creek District, Lewis County, W. Va.
 Pittsburgh & W. Va. Gas Co., Clarksburg, W. Va.
 On 36 acres, surface owned by L. O. Stutler, Kincheloe, W. Va., and
 mineral rights by Garner and Olive Thoms, Weston, W. Va.
 Well completed June 7, 1907.
 Elevation, 1184' L.
 13" conductor, 16'; 10" casing, 280'; 8½", 1125'; 6-5/8", 2115'.
 Coal was encountered at 263-268'.
 Abandonment reported to Dept. of Mines July 18, 1934.
 Began drilling April 29, 1907; completed, June 7, 1907.
 Well was not shot.

	Top.	Bottom.
Pittsburgh Coal	263	- 268
Gas Sand	900	- 960
1st Salt Sand	970	- 1040
2nd Salt Sand	1060	- 1130
White sand (oil, 1475') <i>maxton</i>	1475	- 1515
Big Lime	1735	- 1800
Big Injun Sand	1800	- 1920
Gantz? (Berea) Sand	2090	- 2110
50-Ft. Sand	2115	- 2135
30-Ft. Sand	2250	- 2285
Gordon Stray Sand	2345	+
No break between Gordon Stray and Gordon.		
Gordon Sand (gas, 2370 and 2392')	- 2411
Total depth		2411

Lew-13

PITTSBURGH & WEST VA GAS CO. Company
CLARKSBURG, WEST VA. Address

COMPLETION DATA SHEET
No. 2
FORMATION RECORD

Well No. 1965, Ducella Thoms, et vir farm.
Freemans Creek Dist., Lewis Co., W.Va.

Name	Color	Character	Oil, Gas or Water	Top	Bottom	Thickness	Total Depth	Remarks
n-recorded				0	263	263	263	
gh. Coal				263	268	5	268	
n-recorded				268	900	632	900	
as Sand				900	960	60	960	
n-recorded				960	970	10	970	
st. Salt Sand				970	1040	70	1040	
n-recorded				1040	1060	20	1060	
nd. Salt Sand				1060	1130	70	1130	
n-recorded				1130	1475	345	1475	
White Sand			0-1475'	1475	1515	40	1515	
n-recorded				1515	1735	220	1735	
Big Lime				1735	1800	65	1800	
Big Injun				1800	1920	120	1920	
n-recorded				1920	2090	170	2090	
lantz Sand				2090	2110	20	2110	
n-recorded				2110	2115	5	2115	
50 Ft. Sand				2115	2135	20	2135	
n-recorded				2135	2250	115	2250	
30 Ft. Sand				2250	2285	35	2285	
n-recorded				2285	2345	60	2345	"No break between Gordon Stray and Gordon."
Gordon Stray			G-2370'	2345	2411	66	2411	
Gordon Sand			G-2392'					
Total Depth							2411'	

Well was not shot at Not Shot. feet; well was shot at _____ feet.

Fresh water at _____ feet; fresh water at _____ feet.

Well was 6-5/8 producing hole.

PITTSBURGH & WEST VA GAS COMPANY.

6-15-34
Date

Approved _____ By, F. E. Bridgen
Owner

NOTE: All bottom formations must be noted as indicated above and all key-rocks and oil and gas sands must be recorded under their proper geological names in the district as well as any local names commonly used in the district for such strata.

JUN 18 1934

"APPLICATION TO DRILL DEEPER"

Not Drilled Deeper

WEST VIRGINIA DEPARTMENT OF MINES

Oil and Gas Section

PRELIMINARY DATA SHEET NO. 1

File No. Lew 13 → 30067 Well No. 1965

PITTSBURGH & WEST VA GAS Company, of CLARKSBURG,

West Va. on the Drucella Thoms, et vir. Farm

containing 36 acres. Location Map Ref. Vadis N.E. 4-3

Freemans Creek District, in Lewis County, West Virginia.

The surface of the above tract is owned in fee by L. O. Stutler

of Kincheloe, West Va. address, and the mineral rights are owned by

Garner and Olive Thoms of Weston, West Va.

The oil and gas privileges are held under lease by the above named company, and this well is drilled under permit No. _____ issued by the West Virginia Department of Mines, Oil and Gas Section,

(Well Completed 6-7-1907) 19____

Elevation of surface at top of well, 1184' Spirit _____

The number of feet of the different sized casings used in the well.

16 feet 13" size. Wood conductor.

280 feet 10" size, 1125 feet 8-1/4" sized csg.

2115 feet 6-5/8" size, csg. _____ feet _____ sized csg.

_____ feet _____ size, csg. _____ feet _____ sized csg.

_____ packer of _____ size, set at _____

_____ packer of _____ size, set at _____

_____ in casing perforated at _____ feet to _____ feet.

_____ in casing perforated at _____ feet to _____ feet.

Coal was encountered at 263-268 feet; thickness 60 inches, and at _____

feet; thickness _____ inches; and at _____ feet; thickness _____ inches.

Liners were used as follows: (Give details) _____

June 15th, 1934. Date.

Began Drg. April 29th, 1907. Completed Drg. June 7th, 1907. Approved Pittsburgh & West Va Gas Co. Owner.

By F. E. Brigden (Title)

JUN 18 1934