

LATITUDE 39° 10' 00"

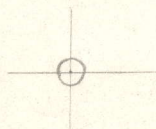

LONGITUDE 80° 32' 30"

7'5 OGIS topo location

7.5' loc 1.06 S 15' loc _____
 1.25 W (calc.) _____

Company _____

Farm _____

Quad BIG ISAAC 7 1/2'

County LEWIS

District FREEMANS CREEK

WELL LOCATION MAP

File No. 041-103A

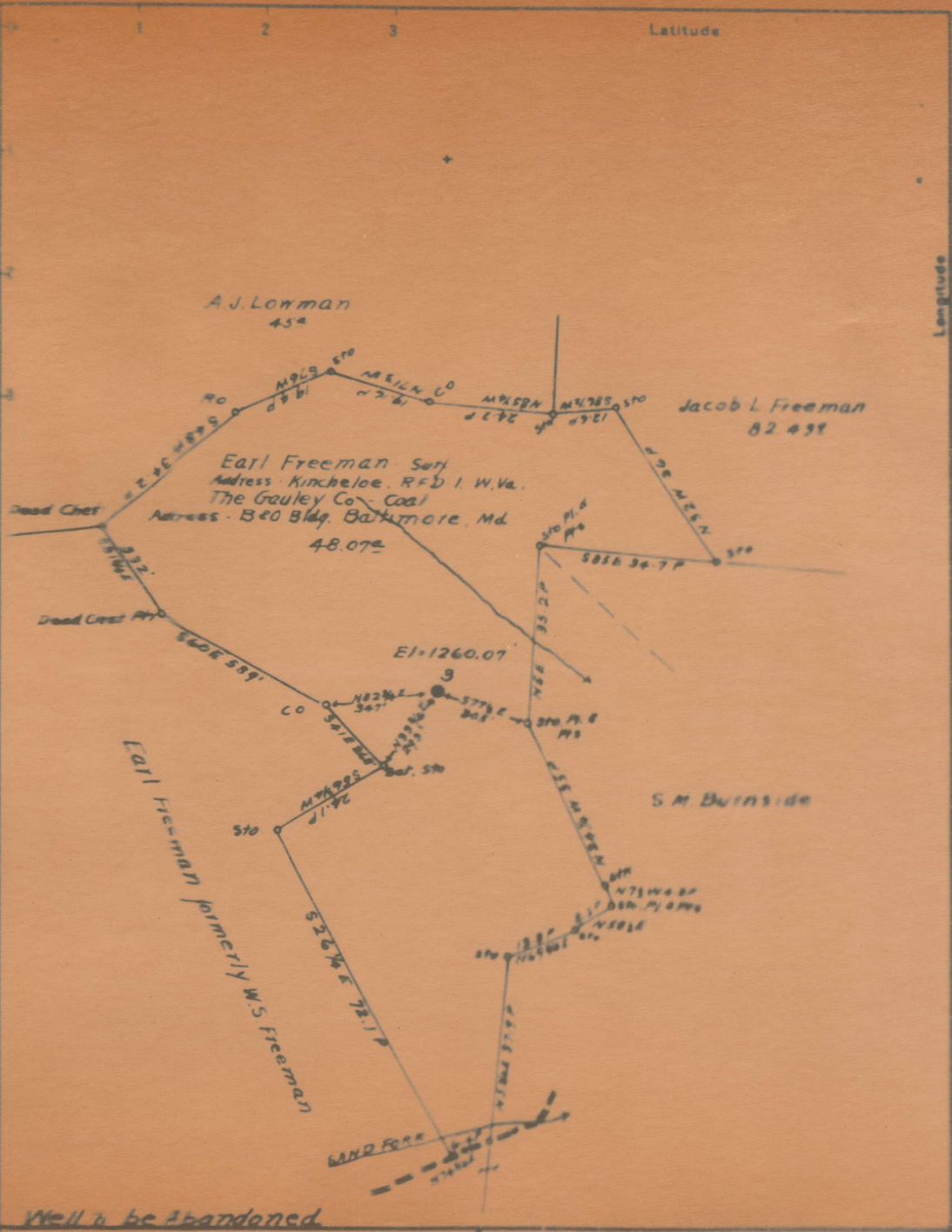

Well to be Abandoned

Company	South Penn Oil Co
Address	41-7th Ave - Pittsburgh, Pa
Farm	Wills Freeman
Tract	Acres 58 Lease No 69720

STATE OF WEST VIRGINIA
 DEPARTMENT OF MINES
 OIL AND GAS DIVISION
 CHARLESTON

Big Brook
 539 4333

(VBA)

Freemans Creek District, Lewis County, W. Va.
 By South Penn Oil Co., Chamber of Commerce Bldg., Pittsburgh, Pa.
 On 58 acres, surface owned by Earl Freeman, R. F. D. No. 1,
 Kincheloe, W. Va., and mineral rights by C. C. Freeman et al.,
 Route 1, Miletus, W. Va.

Elevation, 1260.07' L.

16' conductor; 10" casing, 270' (pulled); 8 $\frac{1}{2}$ " 1486'; 6-5/8", 2066'.

Coal was encountered at 30-33 and 615-620'.

Abandonment reported to Dept. of Mines June 29, 1936.

Well was shot 3-8-20, with 40 qts.; and in Gordon Stray, 30 qts.

Salt water at 1430-1435'.

Oil well.

	Top.	Bottom.
Native coal	30	- 33
Bluff Sand	180	- 270
Pittsburgh Coal	615	- 620
Little Dunkard Sand	1070	- 1112
Big Dunkard Sand	Lime	
Gas Sand	Lime	
1st Salt Sand (water, 1430-1435')	1415	- 1470
2nd Salt Sand	1490	- 1525
3rd Salt Sand	1670	- 1771
Sand	1776	- 1798
Little Lime	2014	- 2026
Big Lime	2050	- 2110
Big Injun Sand (light show oil, 2165')	2110	- 2230
Squaw Sand	2232	- 2300
Gantz Sand	2420	- 2435
Fifty-foot Sand	2500	- 2520
Thirty-foot Sand	2615	- 2630
Gordon Stray Sand (oil, 2684-2686')	2675	- 2703
Gordon Sand	2718	- 2740
Total depth		2782

*Lew
103A*

**AFFIDAVIT IN TRIPLICATE TO TIME AND MANNER OF
PLUGGING AND FILLING WELL**

(REQUIRED BY SECTION 8, ARTICLE 4, CHAPTER 22 OF THE CODE)

**WEST VIRGINIA DEPARTMENT OF MINES
OIL AND GAS DIVISION**

The Gauley Company,

COAL OPERATOR OR OWNER
P. & O. Building,
Paltimore, Md.

ADDRESS

COAL OPERATOR OR OWNER

ADDRESS

Earl Freeman

LEASE OR PROPERTY OWNER

RFD No. 1, Kincheloe, W. Va.

ADDRESS

SOUTH PENN OIL COMPANY

Chamber of Commerce Bldg.
Pittsburgh, Pa.

COMPLETE ADDRESS

September 25, 1936

WELL AND LOCATION

Freemans Creek District

Lewis County

Well No. 3

Stella Freeman Farm

AFFIDAVIT TO BE MADE IN TRIPLICATE. ONE COPY TO BE MAILED BY REGISTERED MAIL TO THE DEPARTMENT. ONE COPY TO BE RETAINED BY THE WELL OPERATOR AND THE THIRD COPY (AND EXTRA COPIES IF REQUIRED) TO BE MAILED TO EACH COAL OPERATOR ABOVE NAMED AT THEIR RESPECTIVE ADDRESSES.

AFFIDAVIT

STATE OF WEST VIRGINIA,

COUNTY OF Harrison

ss:

J. F. Black

being first duly sworn according to law depose and say that they are experienced in the work of plugging

and filling oil and gas wells and were employed by South Penn Oil Company, well operator, and participated in the work of plugging and filling the above well, that said work was commenced on the

3rd day of August

19 36

and that the well was plugged and filled in the following manner:

Manner in which sand was plugged:

Total depth 2782'. Filled with non-porous material to 2655', -20' above Gordon Stray Sand. Set wood plug 2655'-2652'. Set cement plug 2652'-2642', -sealing Gordon Stray and Gordon Sands. Set bridge at 2540'. Filled with non-porous material to 2480', -20' above Rifty Foot Sand. Set wood plug 2480'-2477'. Set cement plug 2477'-2467', -sealing Fifty Foot Sand. Set bridge at 2255'. Filled with non-porous material to 2090', -20' above Big Injun Sand. Set wood plug 2090'-2087'. Set cement plug 2087'-2077', -sealing Big Injun Sand. Cut and pulled 1915'-6-5/8" casing. Set bridge at 1801', -30' below 3rd Salt Sand. Filled with non-porous material to 1468'. Cut and pulled 8 1/2" casing. Filled with non-porous material to 1395', -20' above 1st Salt Sand. Set wood plug 1395'-1392'. Set cement plug 1392'-1382', -sealing Salt Sand. Set bridge at 1130'. Filled with non-porous material to 1050', -20' above Little Dunkard Sand. Set wood plug at 1050'-1047'. Set cement plug 1047'-1037', -sealing Little Dunkard Sand. Set bridge at 660', -40' below Pittsburgh Coal. Set 2" vent pipe 660' to surface, perforated 660'-650'. Set Morning Glory Packer 650', -30' below Pittsburgh Coal. Cemented vent pipe 650'-595', -20' above Pittsburgh Coal. Filled with non-porous material to surface.

Description of monument. 2" pipe 8' above ground, 2" tee, 2-2" Ells pointing downward. 2' cement cone around vent pipe 2' above ground.

(THE ABOVE DESCRIPTIONS MUST BE IN DETAIL AND IN ACCORDANCE WITH THE PROVISIONS OF SECTION 10, ARTICLE 4, CHAPTER 22 OF THE CODE)

and that the work of plugging and filling said well was completed on the 2nd day of September