

Latitude 39 10

4,90 S
.44 W

Longitude 80° 35'

Jeff Cheuvront

N 57 1/2° E 57.48 P
M. M. Romine
5 1/2

Ira P. Simmons

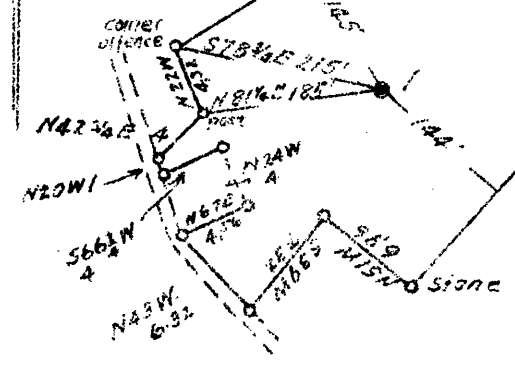

Fee owners are
Shil G. Romine Camden W. Va. R.D. 2
Ida Gum Valley Chapel W. Va.

New Location
Drill Deeper
Abandonment

Map 18 S 45 S 25 E 1

Company South Penn Natural Gas Co
 Address Parkersburg W. Va.
 Farm M. M. Romine
 Tract _____ Acres 7 Lease No. 74616
 Well (Farm) No. 1 Serial No. _____
 Elevation (Spirit Level) 1041 D.F. - 1035.4 G
 Quadrangle Vadis
 County Lewis District Freemans Crk.
 Engineer Emmon Haines
 Engineer's Registration No. _____
 File No. _____ Drawing No. _____
 Date 3-26-43 Scale 1" = 200'

STATE OF WEST VIRGINIA
DEPARTMENT OF MINES
OIL AND GAS DIVISION
CHARLESTON

WELL LOCATION MAP
FILE NO. LEW-260A
30260

+ Denotes location of well on United States Topographic Maps, scale 1 to 62,500, latitude and longitude lines being represented by border lines as shown.

- Denotes one inch spaces on border line of original tracing.



STATE OF WEST VIRGINIA
DEPARTMENT OF MINES
OIL AND GAS DIVISION

240

WELL RECORD

Permit No. 260A

Oil or Gas Well OIL-GAS
(KIND)

Company South Penn Natural Gas Company
Address Union Trust Bldg. Parkersburg, W. Va.
Farm M. M. Romine Acres 7
Location (waters) Fink Creek
Well No. 1 Elev. 1035.4
District Freemans Creek County Lewis
The surface of tract is owned in fee by Shirl G. Romine et al
R. D. No. 2 Address Camden, W. Va.
Mineral rights are owned by Shirl G. Romine et al
R. D. No. 2, Address Camden, W. Va.
Drilling commenced April 17, 1922
Drilling completed August 18, 1922
Date Shot 8-22-22 From 2528 To 2532
1-19-27 From 2526 To 2534
With 1st shot 10 qt. 2nd- 20 qts.
Open Flow 12 /10ths Water in 2" 146 net Inch
/10ths Merc. in ----- Inch
Volume ----- Cu. Ft.
Rock Pressure --- lbs. --- hrs.
Oil 10 bbls., 1st 24 hrs.
Fresh water 440 feet -- feet
Salt water 955 feet 1025 feet

Casing and Tubing	Used in Drilling	Left in Well	Packers
Size			
16.			Kind of Packer <u>Anchor</u>
13.			Size of <u>5-3/16X 6-5/8"</u>
<u>10"</u>	<u>236 (Pulled)</u>		Depth set <u>2348'</u>
8 3/4	<u>658' 10"</u>		Perf. top <u>--</u>
6 3/4	<u>1688'</u>		Perf. bottom <u>--</u>
5 3/16	<u>2369' (Pulled)</u>		Perf. top <u>--</u>
3.			Perf. bottom <u>--</u>
2.			
Liners Used			
Cond.	<u>16"</u>		

CASING CEMENTED -- SIZE -- No. Ft. -- Date --
Native
COAL WAS ENCOUNTERED AT 95 FEET 24 INCHES
172 FEET 36 INCHES -- FEET -- INCHES
-- FEET -- INCHES -- FEET -- INCHES

Formation	Color	Hard or Soft	Top	Bottom	Oil, Gas or Water	Depth Found	Remarks
Native Coal			95	97			
Pittsburgh Coal			172	175			
Little Dunkard			605	685	Water	440	10 Blr.pr.hr
Big Dunkard			700	750			
1st Gas Sand			775	830			
2nd Gas Sand			840	940			
1st Salt Sand			945	975			
2nd Salt Sand			1005	1100	Water	955	4 blr.pr.hr.
3rd Salt Sand			1130	1225	Water	1025	Hole full
4th Salt Sand			1340	1420			
Little Lime			1625	1640			
Pencil Cave			1640	1650			
Big Lime			1650	1705			
Big Injun			1705	1825			
Squaw Sand			1835	1865			
Gantz Sand			2020	2040			
Fifth Sand (50')			2155	2165			
Thirty Foot			2210	2235			
Gordon Stray			2303	2318			
Gordon Sand			2335	2355	Gas	2310	4/10W.2"
Fifth Sand			2525	2534	Gas	2341	8/10 W. 2"
Slate			2534	2548	Oil & Gas	2528	119 net
Total Depth				2548			

APR 17 1944

