

Latitude

Longitude

2.72s
1.43w

Topo Location

7.5' Loc. _____ 15' Loc. _____
(calc.) _____

Company _____

Farm _____

15' Quad _____
(sec.)

7.5' Quad Camden

District Freemans Creek

WELL LOCATION PLAT

County 041 Permit 30370

7.05 S
7.50 W

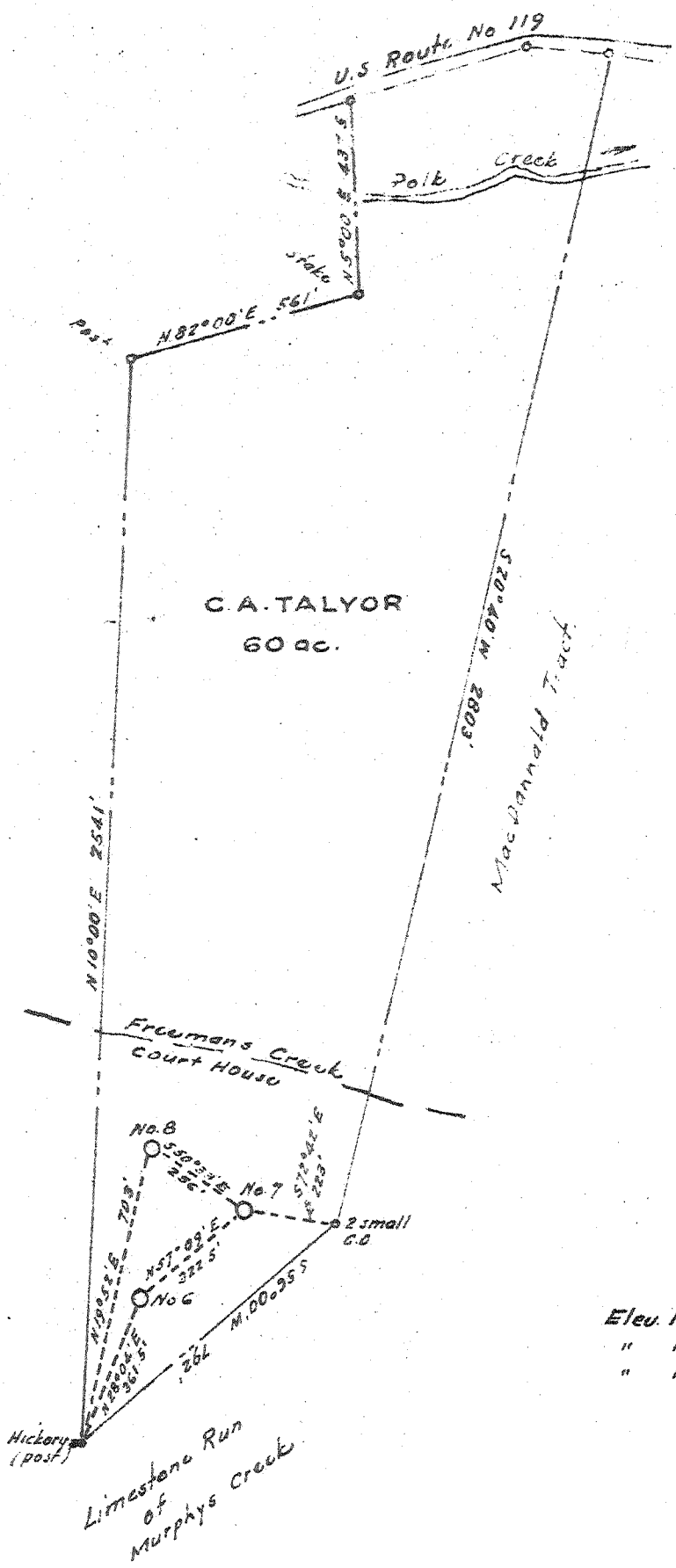

Elev. No 6 = 1162.0'
 " No 7 = 1241.0'
 " No 8 = 1270.0'

New Location
 Drill Deeper
 Abandonment

Company **HARTMAN & BOWSER**
 Address **Parkersburg, West Va.**
 Farm **C.A. Taylor**
 Tract **Acres 60** Lease No. _____
 Well (Farm) No. _____ Serial No. _____
 Elevation (Spirit Level) **As noted**
 Quadrangle **Yadis**
 County **Lewis** District **Court House**
 Engineer **M. H. Hart**
 Engineer's Registration No. **1227**
 File No. _____ Drawing No. _____
 Date **June 1947** Scale **1" = 400'**

STATE OF WEST VIRGINIA
 DEPARTMENT OF MINES
 OIL AND GAS DIVISION
 CHARLESTON

WELL LOCATION MAP
 FILE NO. **LEW-370-A-#8**

+ Denotes location of well on United States Topographic Maps, scale 1 to 62,500, latitude and longitude lines being represented by border lines as shown.
 - Denotes one inch spaces on border line of original tracing.



453

STATE OF WEST VIRGINIA
DEPARTMENT OF MINES
OIL AND GAS DIVISION

WELL RECORD

Permit No. Ab 370-A

Oil or Gas Well oil
(KIND)

Company Hartman and Bowser
Address Union Trust Bldg. Parkersburg, W. Va.
Farm C. A. Taylor Acres 5.2
Location (waters) Polk Creek
Well No. 1270-0 Elev 1270.0
District County County Lewis
The surface of tract is owned in fee by C. A. Taylor, et ux
Weston, W. Va. Address _____
Mineral rights are owned by same
Address _____

Drilling commenced 1 Nov. 1915
Drilling completed 22 Dec. 1915
Date Shot 20 Dec. 1915 From 1325 To 1335
With 10 cts. nitro glycerine
Open Flow /10ths Water in _____ Inch
/10ths Merc. in _____ Inch
Volume _____ Cu. Ft.
Rock Pressure _____ lbs. _____ hrs.
Oil _____ bbls., 1st 24 hrs.
Fresh water _____ feet _____ feet
Salt water _____ feet _____ feet

Casing and Tubing	Used in Drilling	Left in Well	Packers
Size			
16			Kind of Packer
13			
10			Size of
8 1/4	185	185	
6 3/4	973	973	Depth set
5 3/16			
3			Perf. top
2			Perf. bottom
Liners Used			Perf. top
			Perf. bottom

CASING CEMENTED _____ SIZE _____ No. Ft. _____ Date _____

COAL WAS ENCOUNTERED AT none FEET _____ INCHES
_____ FEET _____ INCHES _____ FEET _____ INCHES
_____ FEET _____ INCHES _____ FEET _____ INCHES

Formation	Color	Hard or Soft	Top	Bottom	Oil, Gas or Water	Depth Found	Remarks
Gas sand			675	750			
1st salt sand			750	925			
Oil sand			1318	1335	oil 1325 to 1335		
Total depth			1338				

