

Latitude 38 20'  
Longitude 82 00'

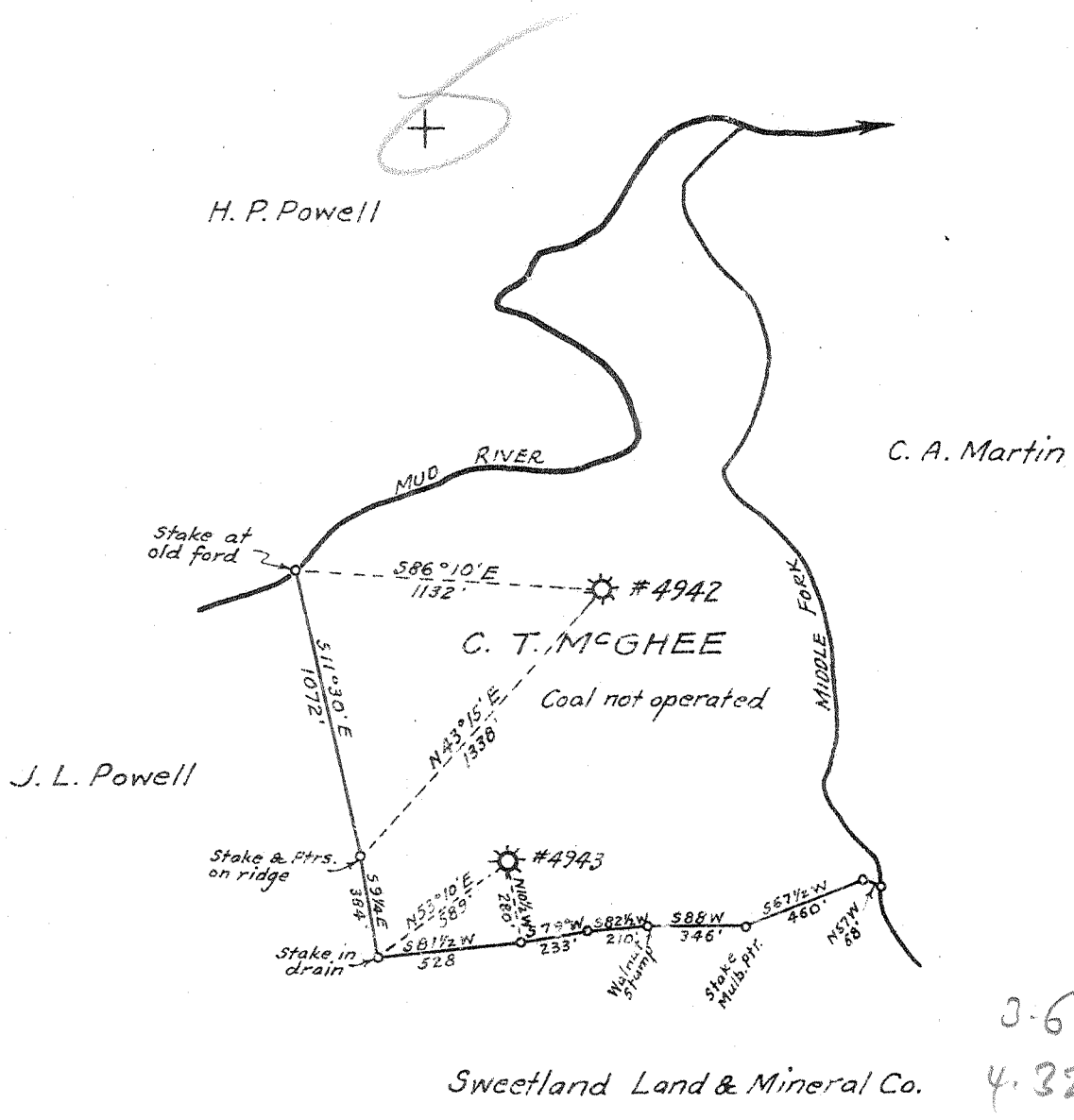

New Location...   
 Drill Deeper...   
 Abandonment...

Company UNITED FUEL GAS CO.  
 Address CHARLESTON, W.VA.  
 Farm C.T. MCGHEE  
 Tract Acres 79 Lease No. 43384  
 Well (Farm) No.            Serial No. 4942  
 Elevation (Spirit Level) 633.3  
 Quadrangle MILTON  
 County LINCOLN District CARROLL  
 Engineer                             
 Engineer's Registration No. 659 (W.VA.)  
 File No. 36-53 Drawing No.             
 Date JAN. 13, 1943 Scale 1" = 660'

STATE OF WEST VIRGINIA  
 DEPARTMENT OF MINES  
 OIL AND GAS DIVISION  
 CHARLESTON

**WELL LOCATION MAP**  
 FILE NO. LIN-361-A

+ Denotes location of well on United States Topographic Maps, scale 1 to 62,500, latitude and longitude lines being represented by border lines as shown.  
 - Denotes one inch spaces on border line of original tracing.