

Latitude 38° 15'

Longitude 82° 05'

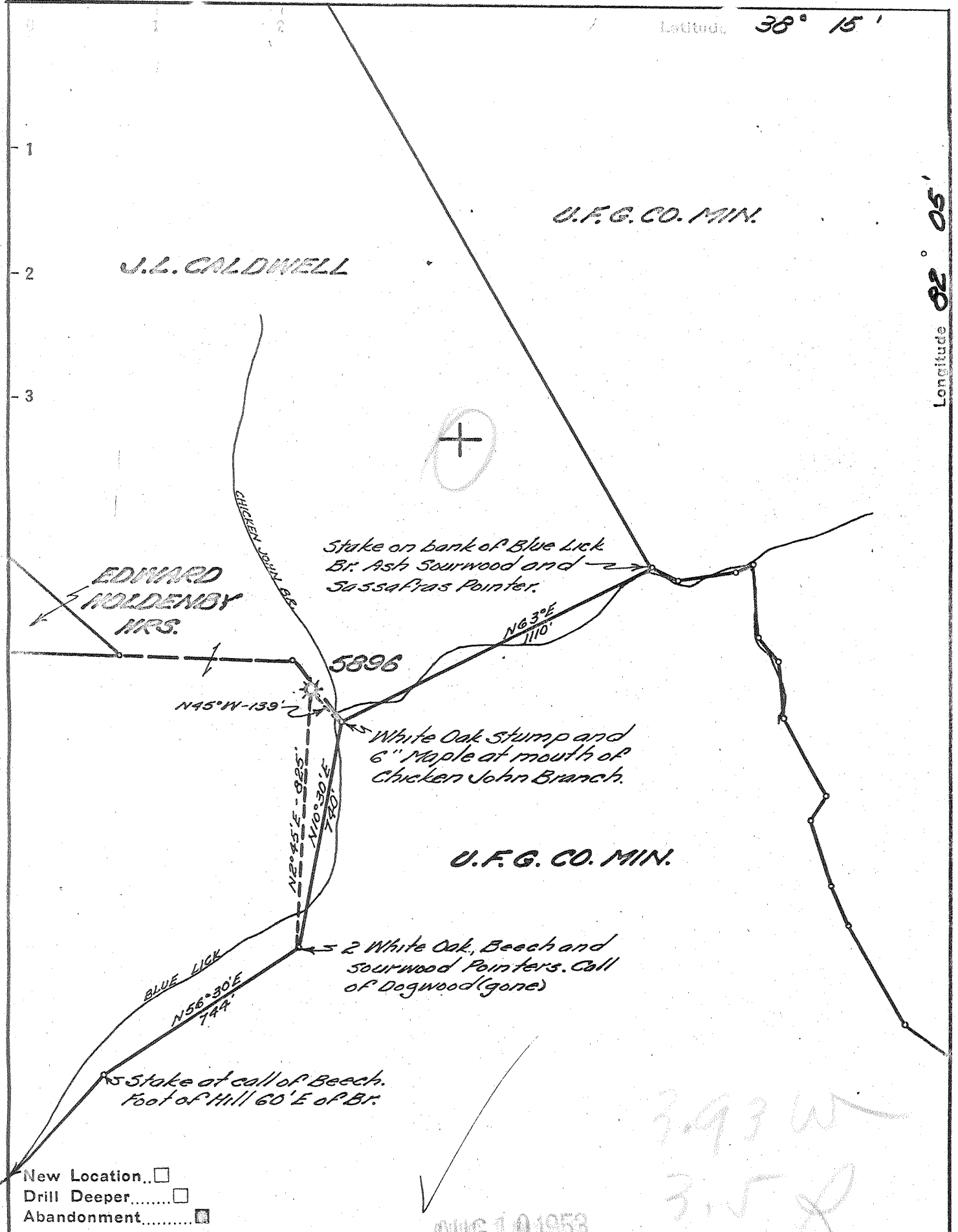

Company	UNITED FUEL GAS CO.
Address	CHARLESTON, W. VA.
Farm	J. L. CALDWELL
Tract	Acres 9/3 Lease No. 45190
Well (Farm) No.	Serial No. 5896
Elevation (Spirit Level)	688.0'
Quadrangle	MIDKIFF
County	LINCOLN District LAUREL HILL
Engineer	Seybert R. Frenell
Engineer's Registration No.	2529
File No.	32-49 Drawing No.
Date	7-21-53 Scale 1"=400'

STATE OF WEST VIRGINIA
 DEPARTMENT OF MINES
 OIL AND GAS DIVISION
 CHARLESTON

WELL LOCATION MAP
 FILE NO. LIN-1093-A

+ Denotes location of well on United States Topographic Maps, scale 1 to 62,500, latitude and longitude lines being represented by border lines as shown.

- Denotes one inch spaces on border line of original tracing.

J.L. CALDWELL No. 5896 - U.F.G. Co. - LIN-1093-A