

WJ 9-7-65

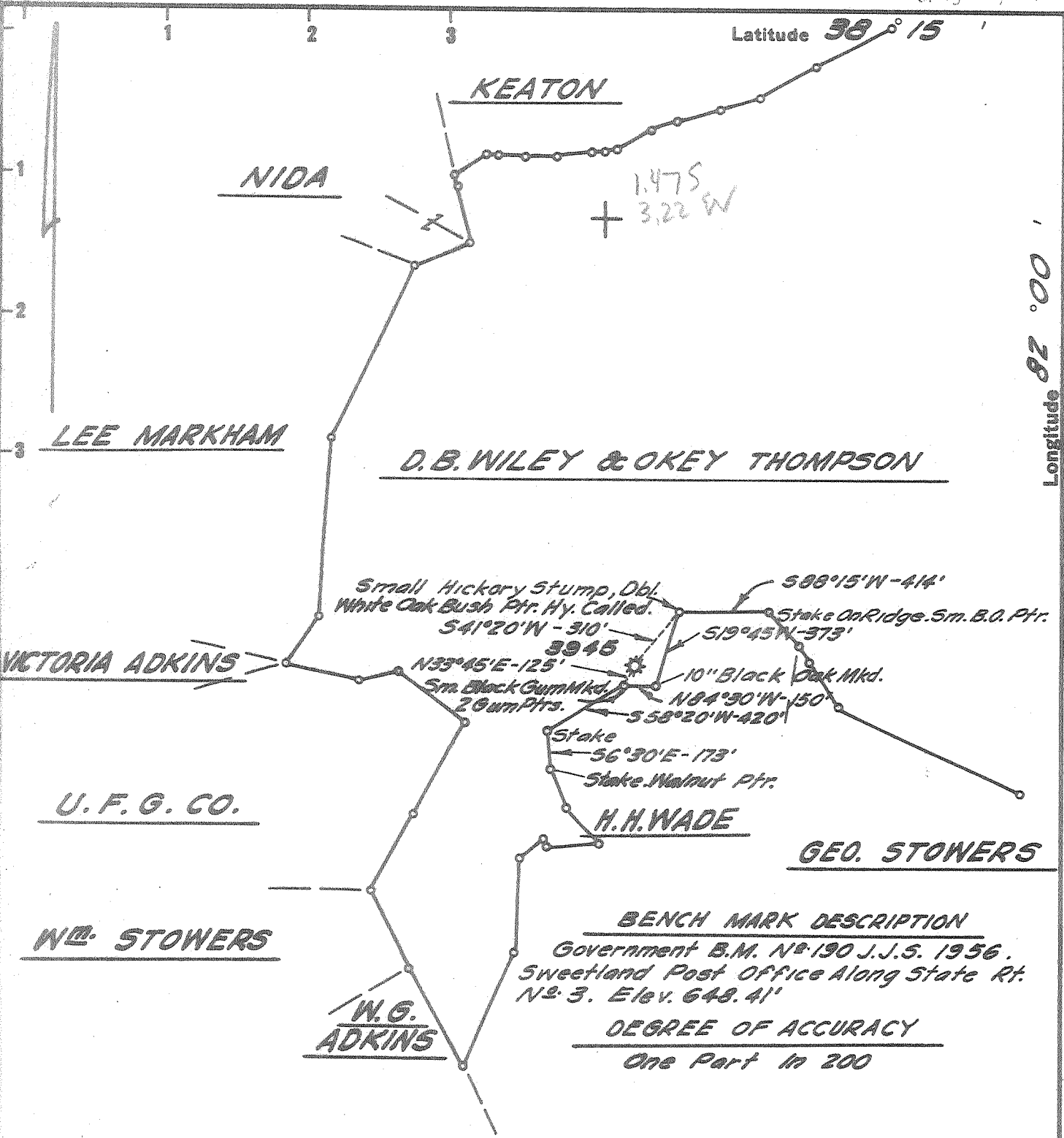

I, the undersigned, hereby certify that this map is correct to the best of my knowledge and belief and shows all the information required by Paragraph 6 of the rules and regulations of the oil and gas section of the mining laws of West Virginia.

New Location
 Drill Deeper
 Abandonment

Sybert Russell

Company UNITED FUEL GAS CO.
 Address CHARLESTON W. VA.
 Farm D.B. WILEY & O. THOMPSON
 Tract _____ Acres 255 Lease No. 24604-24583-
 Well (Farm) No. 2 Serial No. 3945
 Elevation (Spirit Level) 1058.03'
 Quadrangle MIDKIFF - NE
 County LINCOLN District CARROLL
 Engineer Sybert Russell
 Engineer's Registration No. 2529
 File No. 38-51 Drawing No. _____
 Date AUG. 30, '65 Scale 1" = 1320'

STATE OF WEST VIRGINIA
 DEPARTMENT OF MINES
 OIL AND GAS DIVISION
 CHARLESTON

WELL LOCATION MAP
 FILE NO. LIV-1314-A

+ Denotes location of well on United States Topographic Maps, scale 1 to 62,500, latitude and longitude lines being represented by border lines as shown.

-- Denotes one inch spaces on border line of original tracing.