

Latitude 38° 10'

Longitude 82° 10'

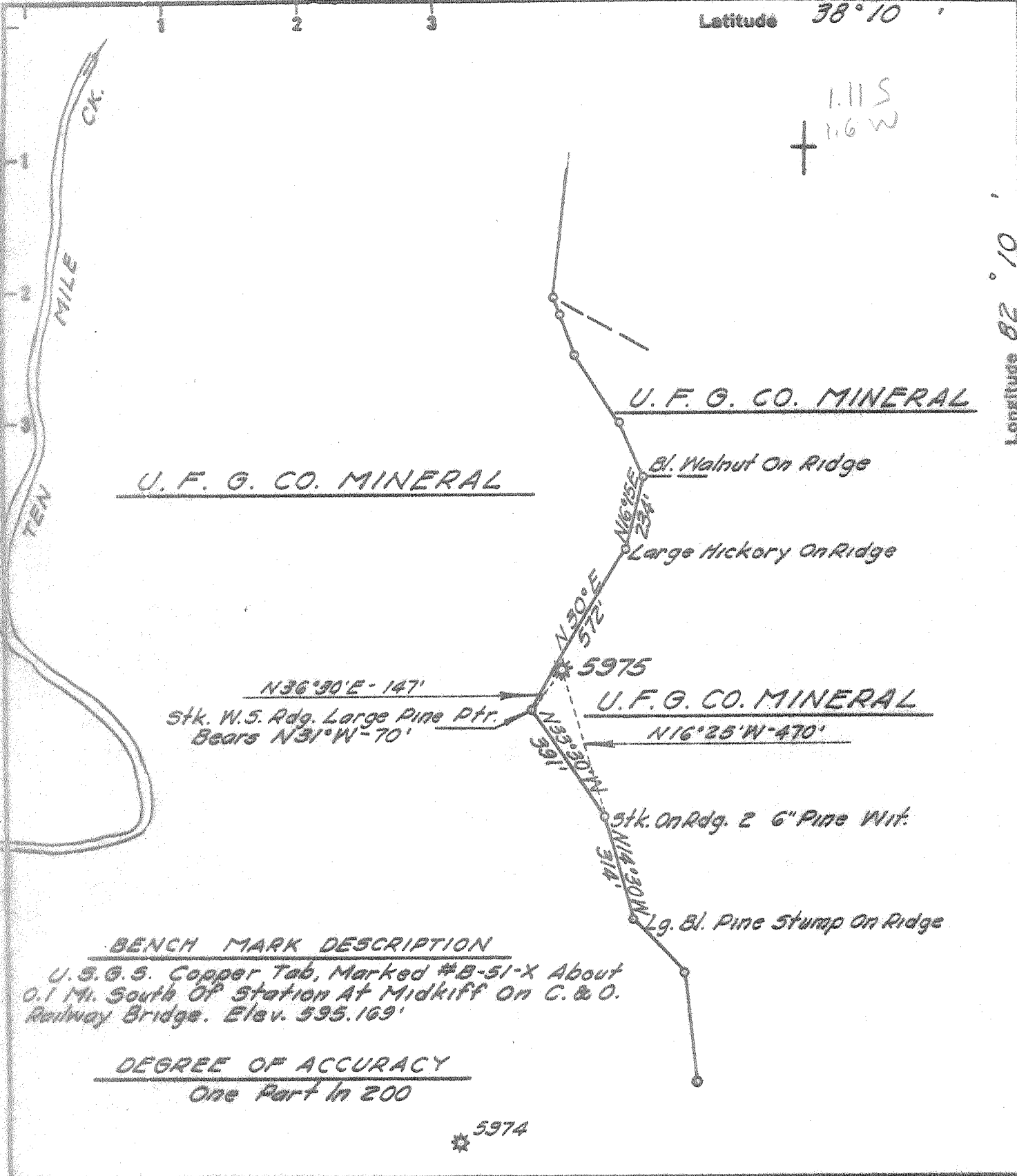

BENCH MARK DESCRIPTION

U.S.G.S. Copper Tab, Marked #B-51-X About 0.1 Mi. South Of Station At Midkiff On C. & O. Railway Bridge. Elev. 595.169'

DEGREE OF ACCURACY

One Part In 200

★ 5974

- Fracture Before 6/5/29
- New Location
- Drift Deeper
- Redrill
- Abandonment

8-1-68

I, the undersigned, hereby certify that this map is correct to the best of my knowledge and belief and shows all the information required by Paragraph 5 of the Rules and Regulations of the Oil and Gas Section of the Mining Laws of West Virginia.

The accuracy of this survey is within the limits and as prescribed in paragraph 5 by the Oil and Gas Division of the Department of Mines Regulations.

PROVEN ELEVATION 595.169'

Company UNITED FUEL GAS CO.  
 Address CHARLESTON, W. VA.  
 Farm U.F.G. CO. MIN. TR. # 1  
 Tract \_\_\_\_\_ Acres 24,682.04 Lease No. NO REF.  
 Well (Farm) No. 69 Serial No. 5975  
 Elevation (Spirit Level) 1038.07'  
 Quadrangle MIDKIFF W.C.  
 County LINCOLN District LAUREL HILL  
 Engineer O.S. Smith  
 Engineer's Registration No. 2712  
 File No. 30-45 Drawing No. \_\_\_\_\_  
 Date DEC. 29, '59 Scale 1" = 400'

STATE OF WEST VIRGINIA  
 DEPARTMENT OF MINES  
 OIL AND GAS DIVISION  
 CHARLESTON

WELL LOCATION MAP  
 FILE NO. LZN-1848-A

★ Denotes location of well on United States Topographic Maps, scale 1 to 62,500 latitude and longitude lines being represented by border lines as shown.

— Denotes one inch spaces on border line of original tracing.