

Latitude 38°15'00"

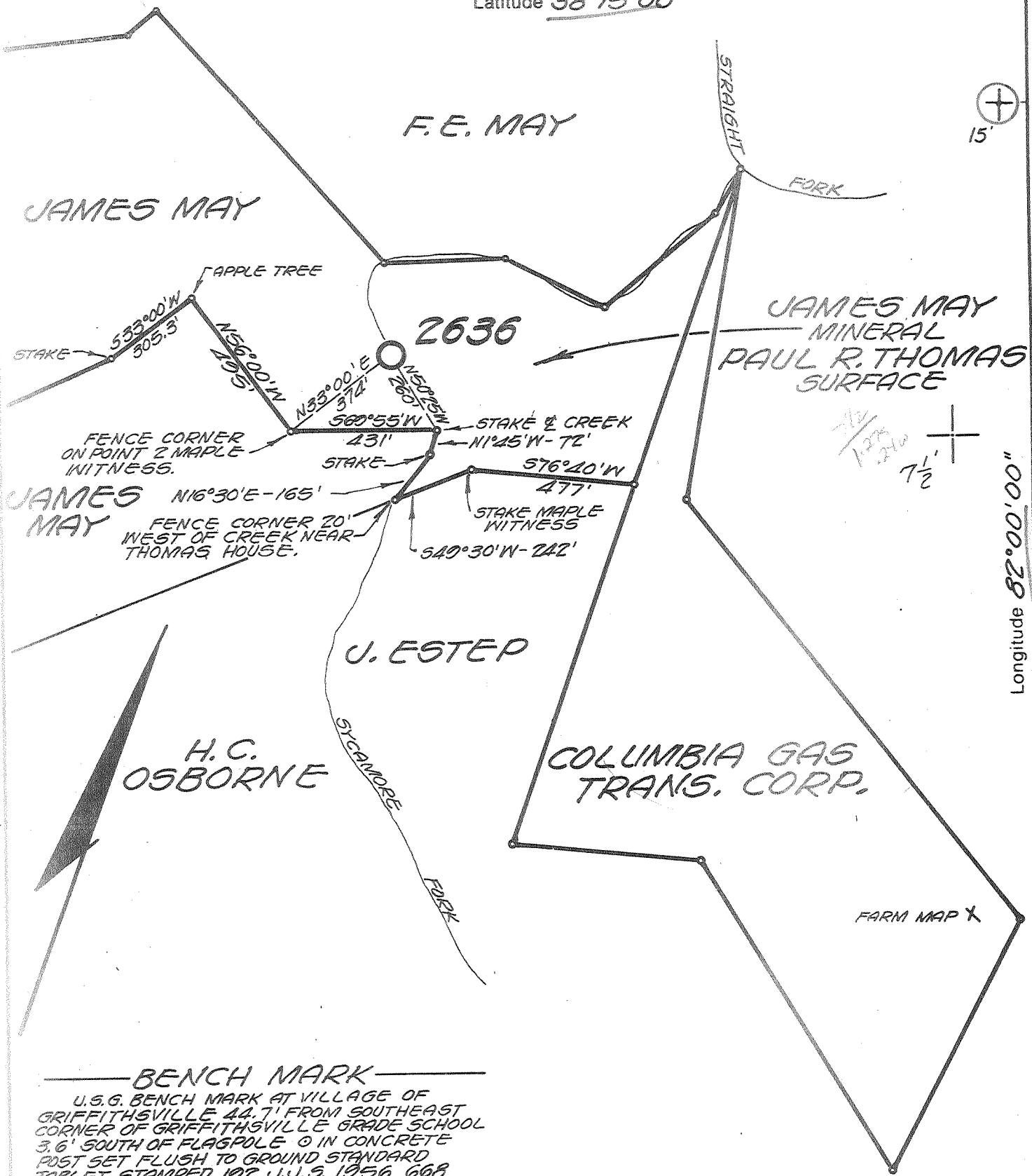

BENCH MARK
 U.S.G. BENCH MARK AT VILLAGE OF GRIFFITHSVILLE 44.7' FROM SOUTHEAST CORNER OF GRIFFITHSVILLE GRADE SCHOOL 3.6' SOUTH OF FLAGPOLE ① IN CONCRETE POST SET FLUSH TO GROUND STANDARD TABLET STAMPED 192 U.J.S. 1956 668

"I, the undersigned, hereby certify that this map is correct to the best of my knowledge and belief and shows all the information required by the rules and regulations of the oil and gas section of the mining laws of WEST VIRGINIA. Minimum degree of accuracy is one part in 200

Signed Adrian E. [Signature]
 ENGR. REG. NO. 2330
 BOX 1273 CHARLESTON, W. VA.

- New Location
- Storage
- Drill Deeper
- Abandonment
- Re-Drill/Fracture

Company COLUMBIA GAS TRANS CORP.
 Address BOX 1273 CHARLESTON W.VA.
 Farm JAMES MAY
 Lease 24666 Acres 35⁹
 Well Farm No. 1 Ser. No. 2636
 Elevation - Spirit Level 662.10' NE
 Quadrangle HAGER, W.VA., MIDKIFF 15'
 Township or District DUVAL
 County LINCOLN
 Sec., Lot, Qr. _____ T _____ R _____
 Coordinates LAT. 38°13'53" LONG. 82°00'15"
 File No. 40-51 Dwg. No. _____
 Date 2-16-77 Scale 1" = 400'

WELL LOCATION MAP
 STATE OF WEST VIRGINIA
 (+) Denotes Values Of Well On United States Topographic Maps
 LIN - 1383-A
 Scale 15' 7 1/2'
 47-043