

Amie
3/1/91

LATITUDE 37° 55' 00"

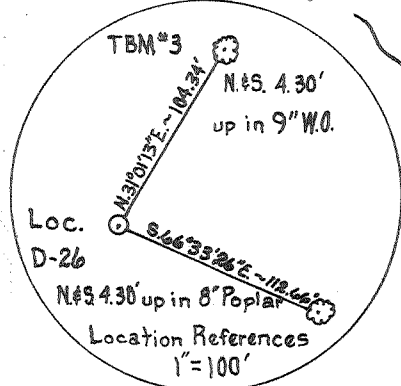

Huntington Development & Gas Co.
(Adverse)

I. C. 5
Altizer & Lawson
1080.62 Ac. F.

Chapmanville
Holden

Quadrangle
Quadrangle

NORTH

I. C. 6
Tom Avis
13.20 Ac. M.
Claimed By H. D. & G. Co.

Island Creek Coal Co.
W.V. - 486 35,053.47 Ac.

I. C. 7
L.H. Thompson
97.33 Ac. M.

Island Creek Coal Co.
Coordinates for Loc. No. D-26
N. 14,700.9198 ~ W. 19,917.4406

N. 10,000

W. 23,000

2.75 S
0.58 W

(+) DENOTES LOCATION OF WELL ON UNITED STATES TOPOGRAPHIC MAPS

FILE NO. _____
DRAWING NO. _____
SCALE 1" = 1000'
MINIMUM DEGREE OF ACCURACY 1:24,065
PROVEN SOURCE OF ELEVATION U.S.C. & G.S. Bench Mark "R-155"; Elev. = 914.778

I THE UNDERSIGNED, HEREBY CERTIFY THAT THIS PLAT IS CORRECT TO THE BEST OF MY KNOWLEDGE AND BELIEF AND SHOWS ALL THE INFORMATION REQUIRED BY LAW AND THE REGULATIONS ISSUED AND PRESCRIBED BY THE DEPARTMENT OF ENERGY.
(SIGNED) Ronald L. Smith
R.P.E. _____ L.L.S. 150



STATE OF WEST VIRGINIA
DEPARTMENT OF ENERGY
OIL AND GAS DIVISION



DATE Dec. 26, 1990
OPERATOR'S WELL NO. Island Creek D-26
API WELL NO. S.N. 133751
47 - 045 - 1158
STATE COUNTY PERMIT

WELL TYPE: OIL ___ GAS X LIQUID INJECTION ___ WASTE DISPOSAL ___
(IF "GAS,") PRODUCTION X STORAGE ___ DEEP ___ SHALLOW X
LOCATION: ELEVATION 1,031.5 WATERSHED Brush Camp Fork of Mud Fork of Island Creek
DISTRICT Island Creek, LOGAN COUNTY Logan
QUADRANGLE Chapmanville Holden C
SURFACE OWNER Georgia Pacific Corporation ACREAGE 1,080.62
OIL & GAS ROYALTY OWNER Island Creek Coal Co. LEASE ACREAGE 35,053.47
LEASE NO. WV-486
PROPOSED WORK: DRILL X CONVERT ___ DRILL DEEPER ___ REDRILL ___ FRACTURE OR STIMULATE ___ PLUG OFF OLD FORMATION ___ PERFORATE NEW FORMATION ___ OTHER PHYSICAL CHANGE IN WELL (SPECIFY) _____

PLUG AND ABANDON ___ CLEAN OUT AND REPLUG ___
TARGET FORMATION Devonian Shale ESTIMATED DEPTH 4,127' KB
WELL OPERATOR Ashland Exploration, Inc. DESIGNATED AGENT Forrest Burkett
ADDRESS P.O. Box 391 ADDRESS P.O. Box 379
Ashland, Ky. 41114 Brenton, W.V. 24818

DEEP WELL 66 Logan-Holden-Adress (204)

LONGITUDE 82° 05' 00"

14,230'

COUNTY NAME

PERMIT

MAR 08 1991

State of West Virginia
DEPARTMENT OF ENERGY
Division of Oil and Gas

Reviewed TMG
Recorded _____

Well Operator's Report of Well Work

Farm name: GEORGIA PACIFIC CORP Operator Well No.: D 26 S 133751

LOCATION: Elevation: 1031.50 Quadrangle: CHAPMANVILLE

District: ISLAND CREEK County: LOGAN
Latitude: 14230 Feet South of 37 Deg. 55Min. 0 Sec.
Longitude 3080 Feet West of 82 Deg. 5 Min. 0 Sec.

RECEIVED
OCT 01 1991
Division of Energy
Oil and Gas Section

Company: ASHLAND EXPLORATION, INC.
P.O. BOX 391, A1-6
ASHLAND, KY 41114-0391

Agent: FORREST BURKETT

Inspector: TIM BENNETT
Permit Issued: 03/07/91
Well work Commenced: 6/4/91
Well work Completed: 8/15/91
Verbal Plugging _____
Permission granted on: _____
Rotary X Cable _____ Rig _____
Total Depth (feet) 4137
Fresh water depths (ft) Approximate
176'
Salt water depths (ft) 406', 759' &
830'
Is coal being mined in area (Y/N)? N
Coal Depths (ft): Not noted while drlg.

Casing & Tubing Size	Used in Drilling	Left in Well	Cement Fill Up Cu. Ft.
16"	30'	30'	17.7
8 5/8"	1552	1552	662
5 1/2"	4127	4127	736
1.9 @	3975' KB w/	ADL-1 pkr	@ 1831' KI
1.9 @	1824' KB		

OPEN FLOW DATA

Producing formation Big Lime Pay zone depth (ft) 1742-1802
Gas: Initial open flow 84 MCF/d Oil: Initial open flow 0 Bbl/d
Final open flow 1082/1634 MCF/d Final open flow 0 Bbl/d
Time of open flow between initial and final tests 3 Hours
Static rock Pressure 530# psig (surface pressure) after 72 Hours

Second producing formation Devonian Shale Pay zone depth (ft) 2522-4043
Gas: Initial open flow 0 MCF/d Oil: Initial open flow 0 Bbl/d
Final open flow 552 MCF/d Final open flow 0 Bbl/d
Time of open flow between initial and final tests 3 Hours
Static rock Pressure 300# psig (surface pressure) after 72 Hours

NOTE: ON BACK OF THIS FORM PUT THE FOLLOWING: 1). DETAILS OF PERFORATED INTERVALS, FRACTURING OR STIMULATING, PHYSICAL CHANGE, ETC. 2). THE WELL LOG WHICH IS A SYSTEMATIC DETAILED GEOLOGICAL RECORD OF ALL FORMATIONS, INCLUDING COAL ENCOUNTERED BY THE WELLBORE.

For: ASHLAND EXPLORATION, INC.

By: James L. Stephens James L. Stephens Eng.-Tech.
Date: September 8, 1991

OCT 3 1991

<u>Formation or Rock Type</u>	<u>TOP</u>	<u>BASE</u>
Sand & Shale (Base Lee formation)	0	1146
Pennington formation	1146	1533
U. Maxton Sand 1394-1420		
L. Maxton Sand 1488-1521		
Little Lime	1533	1573
Big Lime	1573	1807
Borden Formation	1807	2317
Sunbury Shale	2317	2348
Berea	2348	2368
Devonian Shale	2368	4121
Onondaga LS.	4121	TD
DTD 4137		
LTD 4136		

Well Treatment

Perf Rhinestreet 20H/ 3820-4043
N₂ frac. using 500 gal. 7 1/2% Fe inh. acid
807,000 SCF N₂ @ 107,092 SCF/MIN.
BD @ 2252#, ATP 3089#, MTP 3152#, ISIP 1877#, 15 min. 1188#

Perf Huron 20H/ 3191-3618
N₂ frac using 500 gal. 7 1/2% Fe acid
781,000 SCF N₂ @ 96,000 SCF/MIN
BD @ 2110#, ATP 2713#, MTP 2713#, ISIP 1639#, 15 min. 940#

Perf Chagrin 20H/ 2522-2767
N₂ frac. using 500 gal. 8% inh. Fe acid
809,000 SCF N₂ @ 100,969 SCF/MIN
BD @ 1446#, ATP 2628#, MTP 2797#, ISIP 800#, 15 min. 608#

Perf Big Lime 15H/ 1742-1802
Foam acidize the Big Lime using 2500 gal. 28% inh. Fe acid
46,000 SCF N₂ & 13 Hi-dense perf balls.
BD @ 1200#, ATP 1000# @ 4BPM, MTP 1200#, ISIP 1000#, 15 min. 992#, TF 60bb

RECEIVED

FEB 19 1991

045-1158

Issued 3/7/91
Page 1 of 1

FORM WW-2B

DEPT. OF ENERGY

STATE OF WEST VIRGINIA
DEPARTMENT OF ENERGY, DIVISION OF OIL AND GAS
WELL WORK PERMIT APPLICATION

Expires 3/7/93

- 1) Well Operator: Ashland Exploration, Inc. 2750 (5) 288
Island Creek Coal Corp.
- 2) Operator's Well Number: D-26, Serial #133751 3) Elevation: 1031.5
- 4) Well type: (a) Oil or Gas
(b) If Gas: Production / Underground Storage
Deep / Shallow
- 5) Proposed Target Formation(s): Devonian Shale
- 6) Proposed Total Depth: 4127'KB feet
- 7) Approximate fresh water strata depths: 176'KB (Map WV-12)
- 8) Approximate salt water depths: 406'KB (Map WV-12) 454'
- 9) Approximate coal seam depths: Not Operated - Solid Coal 34'-36'
- 10) Does land contain coal seams tributary to active mine? Yes / No
- 11) Proposed Well Work: Drill & Stimulate New Well.
- 12)

CASING AND TUBING PROGRAM

TYPE	SPECIFICATIONS			FOOTAGE INTERVALS		CEMENT
	Size	Grade	Weight per ft.	For drilling	Left in well	
Conductor	16	LS	42.0	30	30	CTS
Fresh Water						30CSR18 11.3 30CSR18 11.2.2
Coal						
Intermediate	8 5/8	J55	24.0	1172	1172	CTS w/Cl "A" (2% Gel, 3% CaCl) Tail 100s:: (3% CaCl)
Production	5 1/2	J55	15.5	4127	4127	As Needed.
Tubing	1.9	J55	2.76	-	4077	30CSR18 11.3 Siphon
Liners						

RECEIVED
Division of Energy

PACKERS : Kind _____
Sizes _____
Depths set _____

FEB 19 91

Permitting
Oil and Gas Section

For Division of Oil and Gas Use Only

Fee(s) paid: Well Work Permit Reclamation Fund WPCP

Plat. WW-9 WW-2B Bond Seneca Bank Agent

(Type)

cc 106
7

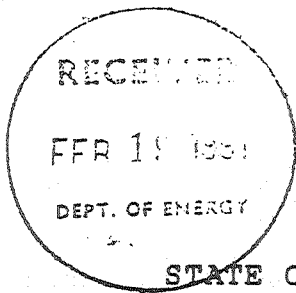

- 1) Date: January 23, 1991
- 2) Operator's well number Island Creek Coal Co. #D-26, Serial #133751
- 3) API Well No: 47 - 045 - 1158
State - County - Permit

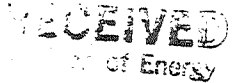

FEB 19 91

STATE OF WEST VIRGINIA
DEPARTMENT OF ENERGY, DIVISION OF OIL AND GAS

NOTICE AND APPLICATION FOR A WELL WORK PERMIT

- 4) Surface Owner(s) to be served:
 - (a) Name Georgia-Pacific Corp.
Address Jerry Crouse
Wyoming, WV 24898
 - (b) Name _____
Address _____
 - (c) Name _____
Address _____
- 6) Inspector Tim Bennett
Address Rt. 2 Box 61-B
Chapmanville, WV 25508
Telephone (304)- 855-7705

- 5) (a) Coal Operator:
 - Name None
 - Address _____
 - (b) Coal Owner(s) with Declaration
Name Island Creek Corp.
Address P.O. Box 840
Holden, WV 25625
 - Name _____
Address _____
 - (c) Coal Lessee with Declaration
Name _____
Address _____

TO THE PERSON(S) NAMED ABOVE TAKE NOTICE THAT:

 Included is the lease or leases or other continuing contract or contracts by which I hold the right to extract oil and gas OR
 X Included is the information required by Chapter 22B, Article 1, Section 8(d) of the Code of West Virginia (see page 2)

I certify that as required under Chapter 22B of the West Virginia Code I have served copies of this notice and application, a location plat, and accompanying documents pages 1 through 2 on the above named parties, by:

- Personal Service (Affidavit attached)
- X Certified Mail (Postmarked postal receipt attached)
- Publication (Notice of Publication attached)

I have read and understand Chapter 22B and 38 CSR 11-18, and I agree to the terms and conditions of any permit issued under this application.

I certify under penalty of law that I have personally examined and am familiar with the information submitted on this application form and all attachments, and that based on my inquiry of those individuals immediately responsible for obtaining the information, I believe that the information is true, accurate, and complete.

I am aware that there are significant penalties for submitting false information, including the possibility of fine and imprisonment.

Well Operator Ashland Exploration, Inc.
 By: J. T. Mellinger
 Its: Vice President
 Address P.O. Box 391
Ashland, KY 41114
 Telephone 606-329-5450

Subscribed and sworn before me this 23rd day of January, 1991

 Nick W. South Notary Public
 My commission expires November 23, 1994