

4704501928P

WW-7
8-30-06



West Virginia Department of Environmental Protection
Office of Oil and Gas

WELL LOCATION FORM: GPS

API: 47-045-01928 WELL NO.: 143

FARM NAME: Yawkey Freeman

RESPONSIBLE PARTY NAME: Greylock Conventional LLC

COUNTY: Logan DISTRICT: Guyan

QUADRANGLE: Henlawson

SURFACE OWNER: Homes for Appalachia

ROYALTY OWNER: Homes for Applachaia

UTM GPS NORTHING: 4193415.86

UTM GPS EASTING: 416430.676 GPS ELEVATION: 1123ft

The Responsible Party named above has chosen to submit GPS coordinates in lieu of preparing a new well location plat for a plugging permit or assigned API number on the above well. The Office of Oil and Gas will not accept GPS coordinates that do not meet the following requirements:

1. Datum: NAD 1983, Zone: 17 North, Coordinate Units: meters, Altitude: height above mean sea level (MSL) – meters.
2. Accuracy to Datum – 3.05 meters
3. Data Collection Method:

Survey grade GPS : Post Processed Differential

Real-Time Differential

Mapping Grade GPS : Post Processed Differential

Real-Time Differential

4. **Letter size copy of the topography map showing the well location.**

I the undersigned, hereby certify this data is correct to the best of my knowledge and belief and shows all the information required by law and the regulations issued and prescribed by the Office of Oil and Gas.

G.M. [Signature]
Signature

Asset Development Manager
Title

03/23/2023
Date

RECEIVED
Office of Oil and Gas

MAR 29 2023

WV Department of
Environmental Protection

04/28/2023

47-045-01928
ECA YAWKEY 143

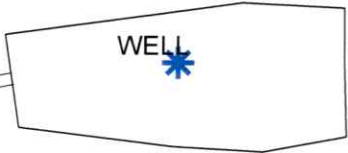

WELL *

NO PITS OR LAND APPLICATION WILL BE USED

NOT TO SCALE



RECEIVED
Office of Oil and Gas
MAR 29 2023
WV Department of
Environmental Protection

GREYLOCK
ENERGY

Greylock Conventional, LLC

500 Corporate Landing Charleston, WV 25311
304-925-6100 - www.greylockenergy.com

Date: 06/29/21

TOPO SECTION OF USGS
HENLAWSON 7.5' QUADRANGLE

ALL ROADS SHOWN HEREON ARE EXISTING UNLESS OTHERWISE NOTED AND SHALL BE MAINTAINED IN ACCORDANCE WITH WV D.E.P. OIL AND GAS BMP MANUAL ENTRANCES AT COUNTY/STATE ROADS SHALL BE MAINTAINED WITH WV D.O.T. REGULATION. SEPARATE PERMITS MAY BE REQUIRED BY D.O.T.

EARTHWORK CONTRACTORS ARE RESPONSIBLE FOR NOTIFICATION TO THE OPERATOR AND PRIOR TO ANY DEVIATION FROM THIS PLAN.

04/28/2023

4704501928P

Well Location Map for
47-045-01928
ECA Yawkey #143

Northing: 4193415.860
Easting: 416430.676
Elevation: 1122.6 ft

UTM NAD83 Zone 17N Meters

Greylock Conventional, LLC
500 Corporate Landing
Charleston, WV 25311

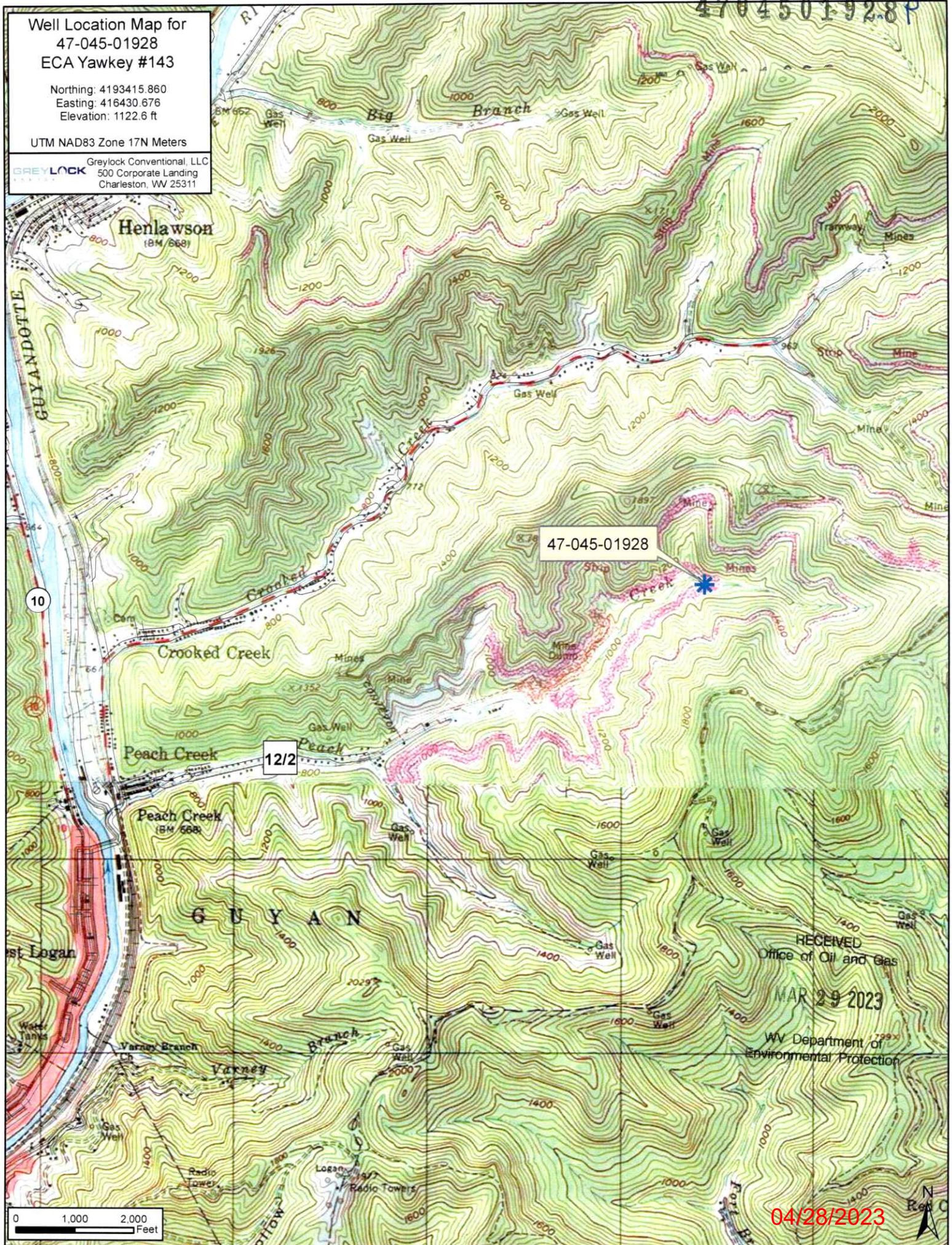

47-045-01928

1212

RECEIVED
Office of Oil and Gas
MAR 29 2023
WV Department of
Environmental Protection

04/28/2023

