

Jackson Resources Co. Gas Well 231

LATITUDE: 37°47'30"

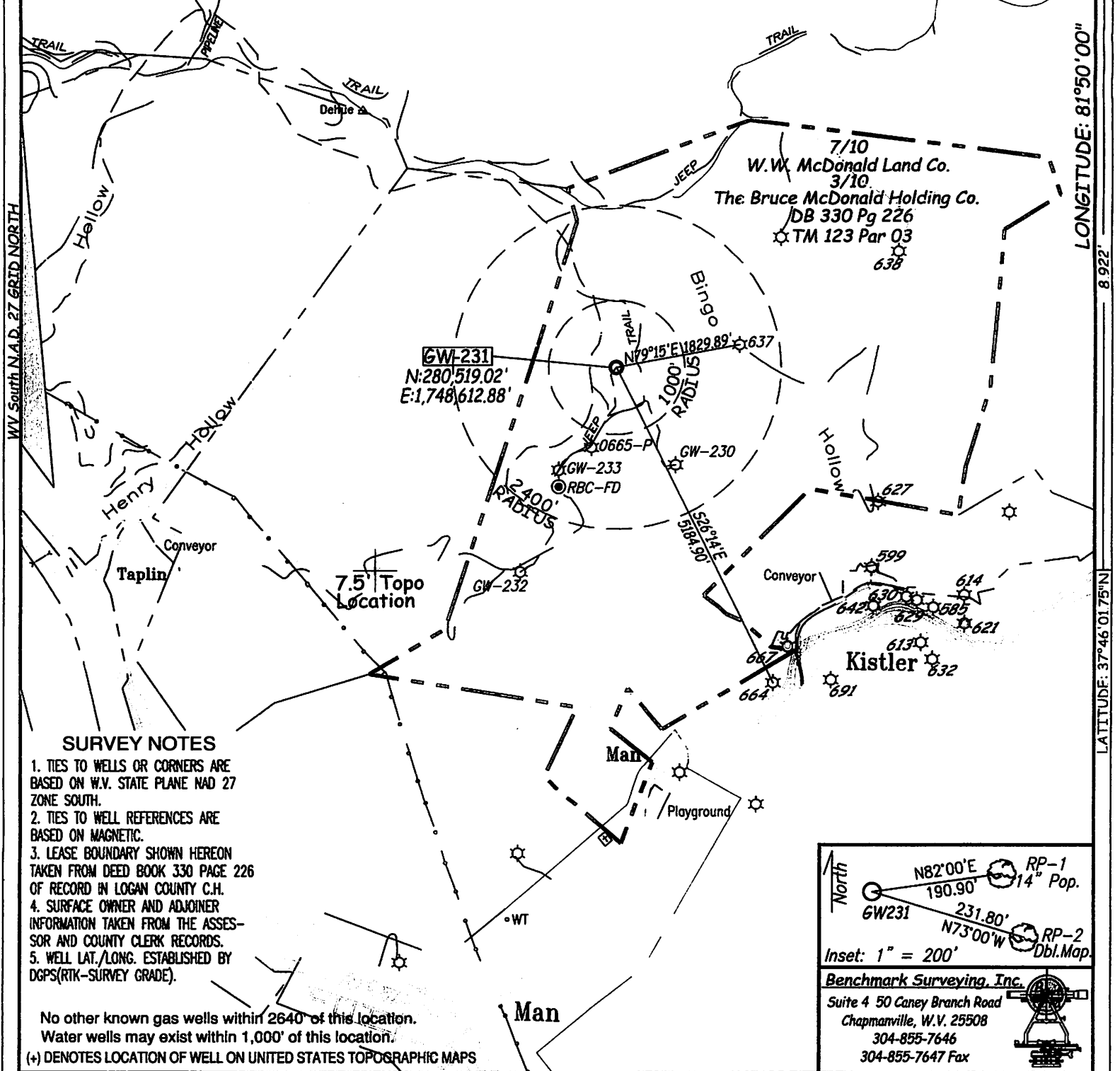

SURVEY NOTES

1. TIES TO WELLS OR CORNERS ARE BASED ON W.V. STATE PLANE NAD 27 ZONE SOUTH.
2. TIES TO WELL REFERENCES ARE BASED ON MAGNETIC.
3. LEASE BOUNDARY SHOWN HEREON TAKEN FROM DEED BOOK 330 PAGE 226 OF RECORD IN LOGAN COUNTY C.H.
4. SURFACE OWNER AND ADJOINER INFORMATION TAKEN FROM THE ASSESSOR AND COUNTY CLERK RECORDS.
5. WELL LAT./LONG. ESTABLISHED BY DGPS(RTK-SURVEY GRADE).

No other known gas wells within 2640' of this location.
 Water wells may exist within 1,000' of this location.
 (+) DENOTES LOCATION OF WELL ON UNITED STATES TOPOGRAPHIC MAPS

North

RP-1
 14" Pop.
 N82°00'E
 190.90'

GW231
 231.80'

RP-2
 Dbl. Map.
 N73°00'W

Inset: 1" = 200'

Benchmark Surveying, Inc.
 Suite 4 50 Caney Branch Road
 Chapmanville, W.V. 25508
 304-855-7646
 304-855-7647 Fax

FILE NO. 2008-130
 DRAWING NO. 231
 SCALE 1" = 2,000'
 MINIMUM DEGREE OF ACCURACY 1:2,500'
 PROVEN SOURCE OF ELEVATION NGVD 29 VERTICAL DATUM VIA OPUS OBSERVATION

I THE UNDERSIGNED, HEREBY CERTIFY THAT THIS PLAT IS CORRECT TO THE BEST OF MY KNOWLEDGE AND BELIEF AND SHOWS ALL THE INFORMATION REQUIRED BY LAW AND THE REGULATIONS ISSUED AND PRESCRIBED BY THE DEPARTMENT OF ENVIRONMENTAL PROTECTION.
 (SIGNED) [Signature]
 P.S. 837-SU

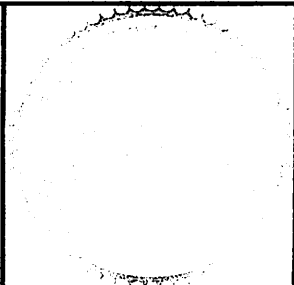

STATE OF WEST VIRGINIA
 DEPARTMENT OF ENVIRONMENTAL PROTECTION
 OIL AND GAS DIVISION



DATE: March 13th 2009
 OPERATOR'S WELL NO. 231
 API WELL NO. 47-045-02338

WELL TYPE: OIL GAS LIQUID INJECTION WASTE DISPOSAL STATE COUNTY PERMIT
 (IF "GAS,") PRODUCTION STORAGE DEEP SHALLOW C.B.M. CANCELLED
 LOCATION: ELEVATION 2162.98' WATER SHED Henry Hollow of the Guyandotte River
 DISTRICT Triadelphia COUNTY Logan
 QUADRANGLE Amherstdale, W.V. 7.5'
 SURFACE OWNER W.W. McDonald Land Co. & The Bruce McDonald Holding Co. ACREAGE 1,156.8 Acres
 OIL & GAS ROYALTY OWNER McDonald Land/Feamster et. al. LEASE ACREAGE 1,182.05 Acres

LEASE NO. _____
 PROPOSED WORK: DRILL CONVERT DRILL DEEPER REDRILL FRACTURE OR STIMULATE PLUG OFF OLD FORMATION PERFORATE NEW FORMATION OTHER PHYSICAL CHANGE IN WELL (SPECIFY) _____

PLUG AND ABANDON CLEAN OUT AND REPLUG
 TARGET FORMATION Devonian ESTIMATED DEPTH _____
 WELL OPERATOR Jackson Resources Company DESIGNATED AGENT Dale Coleman
 ADDRESS 24 Second Street, Hamlin, West Virginia 25523 ADDRESS 24 Second Street, Hamlin, West Virginia 25523

WV South N.A.D. 27 GRID NORTH

LONGITUDE: 81°50'00"

LATITUDE: 37°46'01.75"N

FORM WV-6

LOGAN COUNTY NAME PERMIT