

J.G. MYERS - 113 Ac.

1245
2.160

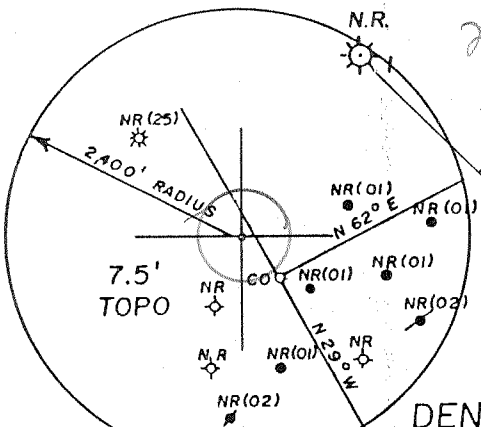

SARAH R. & L.W.
KINTYHTT
100.67 Ac.

DENZIL L. PARKER
22 AC.

CASSA EDDY
RUN 61.75 Ac.

LOCATION REFERENCES

S 55° 56' W 154' (+28%) 36" Pop
S 88° 13' E 56' (-10%) Corner Post

A. - N 55° 56' E 148.7'
B - N 88° 13' W 55.8'
C - S 65° 30' W 196.6'

NIMROD MORGAN HRS.
115 Ac.

FILE NO. 100-35
 DRAWING NO. -
 SCALE 1" = 400'
 MINIMUM DEGREE OF ACCURACY 1 in 200
 PROVEN SOURCE OF ELEVATION N. Morgan No. 3
(1243' NE of Location) = 1065.0'

I THE UNDERSIGNED, HEREBY CERTIFY THAT THIS PLAT IS CORRECT TO THE BEST OF MY KNOWLEDGE AND BELIEF AND SHOWS ALL THE INFORMATION REQUIRED BY LAW AND THE REGULATIONS ISSUED AND PRESCRIBED BY THE DEPARTMENT OF MINES.

(SIGNED) *Leighton P. Rowland*
 R.P.E. _____ L.L.S. 793

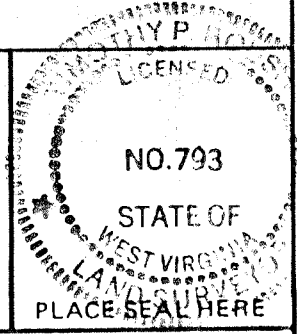

STATE OF WEST VIRGINIA
 DEPARTMENT OF MINES
 OIL AND GAS DIVISION



DATE November 16, _____, 19 87
 OPERATOR'S WELL NO. D. Parker No. 1
 API WELL NO. _____
47 - 049 - 0868
 STATE COUNTY PERMIT

(*) DENOTES LOCATION OF WELL ON UNITED STATES TOPOGRAPHIC MAPS
 WELL TYPE: OIL GAS LIQUID INJECTION _____ WASTE DISPOSAL _____
 (IF "GAS,") PRODUCTION STORAGE _____ DEEP _____ SHALLOW
 LOCATION: ELEVATION 1234' WATER SHED Plum Run
 DISTRICT Lincoln 3 COUNTY Marion
 QUADRANGLE Mannington 7.5' 457 072g +15' SE
 SURFACE OWNER Denzil L. Parker ACREAGE 22 Ac.
 OIL & GAS ROYALTY OWNER Denzil L. Parker LEASE ACREAGE 22 Ac.
 LEASE NO. _____
 PROPOSED WORK: DRILL CONVERT _____ DRILL DEEPER _____ REDRILL _____ FRACTURE OR STIMULATE _____ PLUG OFF OLD FORMATION _____ PERFORATE NEW FORMATION _____ OTHER PHYSICAL CHANGE IN WELL (SPECIFY) _____

PLUG AND ABANDON _____ CLEAN OUT AND REPLUG _____
 TARGET FORMATION Bayard ESTIMATED DEPTH 3,100'
 WELL OPERATOR G.B. Hefner & Assoc. DESIGNATED AGENT George B. Hefner
 ADDRESS 401 W. Main St. 1024 ADDRESS 401 W. Main St.
Bridgeport, W. Va. 26330 Bridgeport, W. Va. 26330

6-6 Mannington (63)

RECEIVED
FEB 17 1988



DIVISION OF OIL & GAS
DEPARTMENT OF ENERGY

State of West Virginia
DEPARTMENT OF ENERGY
Oil and Gas Division

Date February 16, 1988
Operator's
Well No. PARKER # 1
Farm DENZIL L. PARKER
API No. 47 -049 -0868

WELL OPERATOR'S REPORT
OF
DRILLING, FRACTURING AND/OR STIMULATING, OR PHYSICAL CHANGE

WELL TYPE: Oil XX / Gas XX / Liquid Injection / Waste Disposal /
(If "Gas," Production XX / Underground Storage / Deep / Shallow /)

LOCATION: Elevation: 1239' Watershed Plum Run
District: Lincoln County Marion Quadrangle Mannington 7.5'

COMPANY G. B. Hefnr & Associates, Inc.
ADDRESS 401 W. Main St.-Bridgeport, WV
DESIGNATED AGENT G. B. Hefner
ADDRESS Same as above
SURFACE OWNER Denzil L. Parker
ADDRESS Rte. 3, Box 188, Mannington, WV
MINERAL RIGHTS OWNER Same as Surface
ADDRESS Same as Above
OIL AND GAS INSPECTOR FOR THIS WORK Don Ellis
ADDRESS Fairmont, WV 26554

Casing & Tubing	Used in Drilling	Left in Well	Cement fill up Cu. ft.
Size 20-16 Cond.			
13-10"	34	34	
9 5/8	755	755	245Sk
8 5/8			
7			
5 1/2			
4 1/2	3339	3339	140Sk
3			
XX 1 1/2	3170	3170	
Liners used			

PERMIT ISSUED December 31, 1987
DRILLING COMMENCED January 8, 1988
DRILLING COMPLETED January 12, 1988
IF APPLICABLE: PLUGGING OF DRY HOLE OR CONTINUOUS PROGRESSION FROM DRILLING OR REWORKING. VERBAL PERMISSION OBTAINED ON

GEOLOGICAL TARGET FORMATION Bayard Depth 3550 feet
Depth of completed well 3373 feet Rotary XX / Cable Tools
Water strata depth: Fresh 130 feet; Salt feet
Coal seam depths: 625-627 and 730-735 Is coal being mined in the area? No

OPEN FLOW DATA

Producing formation Fifth and Gordon Pay zone depth 2950-3020 feet
Gas: Initial open flow Mcf/d Oil: Initial open flow Bbl/d
Final open flow 112 Mcf/d Final open flow 1 Bbl/d
Time of open flow between initial and final tests hours
Static rock pressure 640 psig (surface measurement) after 48 hours shut in
(If applicable due to multiple completion--)

Second producing formation Fifty foot & Gantz Pay zone depth 2600-2650 feet
Gas: Initial open flow Mcf/d Oil: Initial open flow Bbl/d
Final open flow * Mcf/d Oil: Final open flow * Bbl/d
Time of open flow between initial and final tests hours
Static rock pressure psig (surface measurement) after hours shut in

* Co-mingled with 1st stage

(Continue on reverse side)

FEB 22 1988

DETAILS OF PERFORATED INTERVALS, FRACTURING OR STIMULATING, PHYSICAL CHANGE, ETC.

1st. stage--Fifth Sand--10,000#-80/100 Sand & 20,000# 20/40 sand in gel frac with nitrogen assist.

2nd. stage--Gordon --water frac 2700# 20/40 sand

3rd. Stage--Fifty foot and Gantz--water frac 1300# 80/100 sand

RECEIVED
FEB 17 1988

DIVISION OF OIL & GAS
DEPARTMENT OF ENERGY

WELL LOG

FORMATION	COLOR	HARD OR SOFT	TOP FEET	BOTTOM FEET	REMARKS Including indication of all free and salt water, coal, oil and gas
Sand			0	10	
Red Rock			10	25	
Shale			25	100	
Sand & Shale			100	120	
sand			120	150	
sand & shale			150	210	
sand (white)			210	260	
sand & shale			260	280	
sand			280	365	
sand & shale			365	370	
sand & shale			370	625	
coal			625	627	
sand & shale			627	730	
coal			730	735	
sand & shale			735	850	
Shale & red rock			850	1190	
Sand & shale			1190	1970	
Red rock			1970	2100	
Injun			2100	2255	oil show
sand & shale			2255	2600	
Gantz			2600	2640	
sand & shale			2640	2650	
Fifty Foot			2650	2655	gas show
sand & shale			2655	2950	
Gordon			2950	3010	gas show
sand & shale			3010	3130	
Fifth & Bayard			3130	3162	gas show
sand & shale			3162	3373	T. D.

(Attach separate sheets as necessary)

G. B. HEFNER & ASSOCIATES, INC.

Well Operator

By: 

Date: February 16, 1988

Note: Regulation 2.02(i) provides as follows: "The term 'log' or 'well log' shall mean a systematic detailed geological record of all formations, including coal, encountered in the drilling of a well."

RECEIVED
DEC 24 1987



1) Date: November 23, 19 87
 2) Operator's Well No. D. Parker #1
 3) API Well No. 47 049 0868
 State County Permit

STATE OF WEST VIRGINIA
 DIVISION OF OIL & GAS DEPARTMENT OF ENERGY, OIL AND GAS DIVISION
 DEPARTMENT OF ENERGY **APPLICATION FOR A WELL WORK PERMIT**

- 4) WELL TYPE: A Oil X / Gas X /
 B (If "Gas", Production X / Underground storage _____ / Deep _____ / Shallow X /)
- 5) LOCATION: Elevation: 1239' Watershed: Plum Run
 District: Lincoln 3 County: Marion 049 Quadrangle: Mannington 7.5 457
- 6) WELL OPERATOR G. B. Hefner & Ass DE: 21815 7) DESIGNATED AGENT G. B. Hefner
 Address 401 W. Main St. 1020 Address 401 W. Main St.
Bridgeport, WV 26330 Bridgeport, WV 26330
- 8) OIL & GAS INSPECTOR TO BE NOTIFIED 9) DRILLING CONTRACTOR:
 Name Donald Ellis Name Eastern Overthrust Drilling, Inc.
 Address 2604 Crab Apple Lane Address P. O. Box 600
Fairmont, WV 26554 Anmoore, WV 26323
- 10) PROPOSED WELL WORK: Drill X / Drill deeper _____ / Redrill _____ / Stimulate X /
 Plug off old formation _____ / Perforate new formation _____ /
 Other physical change in well (specify) _____
- 11) GEOLOGICAL TARGET FORMATION, Bayard 423
- 12) Estimated depth of completed well, 3350 feet
- 13) Approximate trata depths: Fresh, _____ feet; salt, _____ feet.
- 14) Approximate coal seam depths: ~675 (Pittsburgh) Is coal being mined in the area? Yes _____ / No _____
- 15) CASING AND TUBING PROGRAM from 049-0069

CASING OR TUBING TYPE	SPECIFICATIONS					FOOTAGE INTERVALS		CEMENT FILL-UP OR SACKS (Cubic feet)	PACKERS
	Size	Grade	Weight per ft.	New	Used	For drilling	Left in well		
Conductor	13-5/8				X	30'	Pulled		Kinds
Fresh water	9-5/8				X	740'	740'	To Surface	3BCSR 18-11.
Coal	7"				X	1880'	1880'	500' fill	
Intermediate									
Production	4 1/2	10.5		X		3320'	3320'	1700' fill	Depths set
Tubing									
Liners									Perforations:
									Top Bottom

OFFICE USE ONLY
 DRILLING PERMIT

Permit number 47-049-0868 December 31 19 87
 Date

This permit covering the well operator and well location shown below is evidence of permission granted to drill in accordance with the pertinent legal requirements subject to the conditions contained herein and on the reverse hereof. Notification must be given to the District Oil and Gas Inspector. (Refer to No. 8) Prior to the construction of roads, locations and pits for any permitted work. In addition, the well operator or his contractor shall notify the proper district oil and gas inspector 24 hours before actual permitted work has commenced.)

The permitted work is as described in the Notice and Application, plat, and reclamation plan, subject to any modifications and conditions specified on the reverse hereof.

Permit expires December 31, 1989 unless well work is commenced prior to that date and prosecuted with due diligence.

Bondy	Agent:	Plat:	Casing	Fee	WHOP	ESSE	Other
<i>[Signature]</i>	<i>[Signature]</i>	<i>MW</i>	<i>MW</i>	<i>240</i> <i>145</i>	<i>[Signature]</i>	<i>[Signature]</i>	<i>[Signature]</i>

NOTE: Keep one copy of this permit posted at the drilling location.

[Signature] Director, Division of Oil and Gas

File