

# SNIDER 15H

LATITUDE: 39°32'30"  
SCALE 1" = 2000'

SCALE: 1" = 2400'

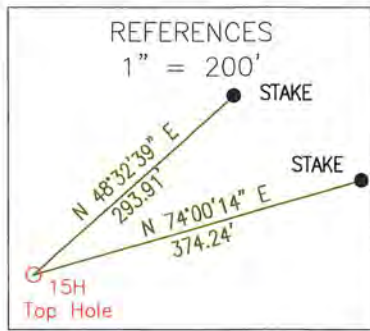
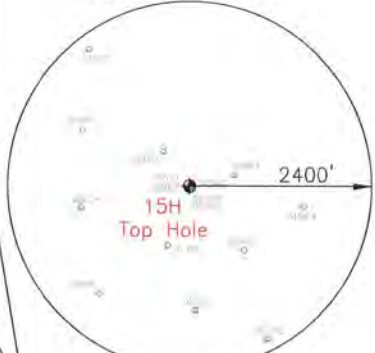

LINE LEGEND

LEASE BOUNDARY	— — — — —
SURFACE BOUNDARY	- - - - -
CREEK / STREAM	~ ~ ~ ~ ~
ROADS	— — — — —
PROPOSED LATERAL	— — — — —
APPROXIMATE CURVE	- - - - -
AS-DRILLED LATERAL	- - - - -
500' LATERAL OFFSET	- - - - -
EXISTING GAS WELL	☉

NOTES ON SURVEY

1. NO DWELLINGS WITHIN 625' WERE FOUND.
2. NO WATER WELLS OR DEVELOPED SPRINGS WITHIN 250' WERE FOUND.
3. TIES TO WELLS AND CORNERS ARE BASED ON STATE PLANE GRID NORTH WV NORTH ZONE NAD 83.
4. WELL ELEVATION ESTABLISHED BY RTK GPS NAVD 88.
5. SURFACE OWNER AND ADJOINER INFORMATION TAKEN FROM THE ASSESSOR AND COUNTY CLERK RECORDS OF MARION COUNTY IN MAY 2016 AND FILES PROVIDED BY XTO ENERGY, INC.
6. WELLS SHOWN ARE TAKEN FROM RECORDS OF WVDEP.

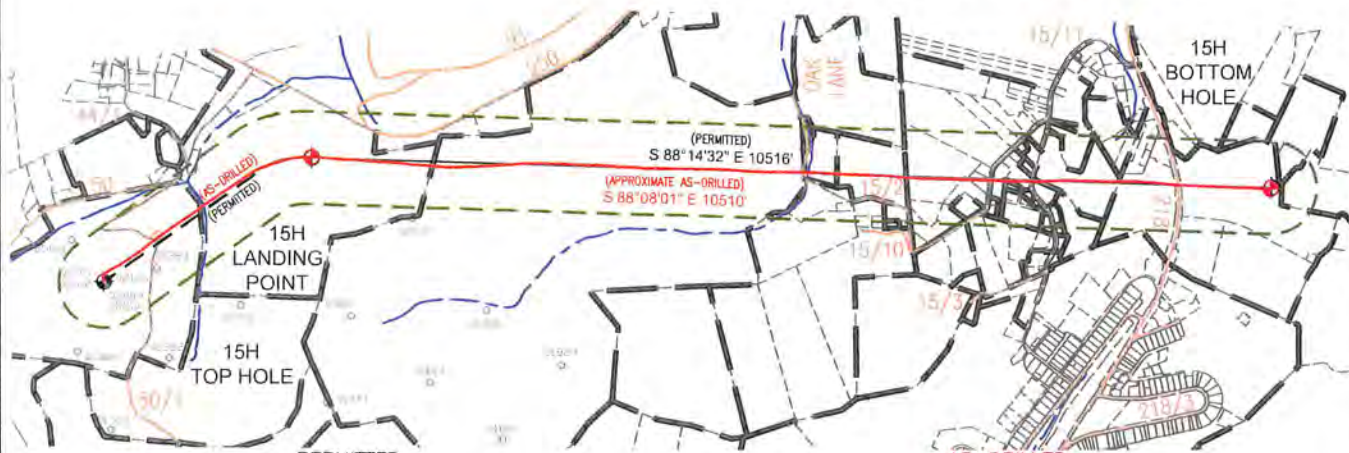

PERMITTED			AS-DRILLED		
Top Hole Location	Landing Point Location	Bottom Hole Location	Top Hole Location	Landing Point Location	Bottom Hole Location
NAD 27 Feet	NAD 27 Feet	NAD 27 Feet	NAD 27 Feet	NAD 27 Feet	NAD 27 Feet
N: 365346.581	N: 366692.503	N: 366369.986	N: 365346.581	N: 366698.323	N: 366356.065
E: 1775468.693	E: 1777747.131	E: 1788258.513	E: 1775468.693	E: 1777741.611	E: 1788246.423
UTM Zone 17 (SPCS83) Meters	UTM Zone 17 (SPCS83) Meters	UTM Zone 17 (SPCS83) Meters	UTM Zone 17 (SPCS83) Meters	UTM Zone 17 (SPCS83) Meters	UTM Zone 17 (SPCS83) Meters
N: 4372550.767	N: 4372972.400	N: 4372927.537	N: 4372550.767	N: 4372974.145	N: 4372973.234
E: 560571.762	E: 561259.108	E: 564463.249	E: 560571.762	E: 561257.397	E: 564459.636
NAD 27	NAD 27	NAD 27	NAD 27	NAD 27	NAD 27
N 39.5003610	N 39.5041113	N 39.5034729	N 39.5003610	N 39.5041272	N 39.5034344
W 080.2956973	W 080.2876652	W 080.2504050	W 080.2956973	W 080.2876849	W 080.2504474



2402 PENNSYLVANIA 66 DELMONT, PA 15626  
(724) 757 - 2417 www.jonesconsultant.com

SHEET 1 OF 2

FILE #: JC2016-41  
DRAWING #: SNIDER 15H WELL  
SCALE: 1" = 2000'  
MINIMUM DEGREE OF ACCURACY: 1:2500  
PROVEN SOURCE OF ELEVATION: RTK GPS

I, THE UNDERSIGNED, HEREBY CERTIFY THAT THIS PLAT IS CORRECT TO THE BEST OF MY KNOWLEDGE AND BELIEF AND SHOWS ALL THE INFORMATION REQUIRED BY LAW AND THE RULES ISSUED AND PRESCRIBED BY THE DEPARTMENT OF ENVIRONMENTAL PROTECTION.

Signed: *Ryan Jones*  
R.P.E.: \_\_\_\_\_ P.S.: 2165



(+) DENOTES LOCATION OF WELL ON UNITED STATES TOPOGRAPHIC MAPS WVDEP  
OFFICE OF OIL & GAS  
601 57TH STREET  
CHARLESTON, WV 25304



DATE: 08/07/2018  
OPERATOR'S WELL #: SNIDER 15H  
API WELL #: 47 049 02432  
STATE COUNTY PERMIT



Well Type:  Oil  Waste Disposal  Production  Deep  
 Gas  Liquid Injection  Storage  Shallow

WATERSHED: BUFFALO CREEK 0502000301  
COUNTY/DISTRICT: MARION / LINCOLN  
SURFACE OWNER: RICHARD & JOCELYN BOWER  
OIL & GAS ROYALTY OWNER: JOHN E. BRENNAN, ET AL

ELEVATION: 1,252' FINISHED GRADE  
QUADRANGLE: MANNINGTON 7.5'  
ACREAGE: 94.5±  
ACREAGE: 727±

DRILL  CONVERT  DRILL DEEPER  REDRILL  FRACTURE OR STIMULATE   
PLUG OFF OLD FORMATION  PERFORATE NEW FORMATION  PLUG & ABANDON   
CLEAN OUT & REPLUG  OTHER CHANGE  (SPECIFY): \_\_\_\_\_

TARGET FORMATION: MARCELLUS ESTIMATED DEPTH: 7,702' (TVD) 19,308' (TMD)  
WELL OPERATOR: XTO ENERGY INC.  
Address: 190 THORN HILL ROAD  
City: WARRENDALE State: PA Zip Code: 15086  
DESIGNATED AGENT: GARY BEALL  
Address: P.O. BOX 1008  
City: JANE LEW State: WV Zip Code: 26378



# SNIDER 15H

## AS-DRILLED

State Plane Coordinate  
West Virginia North

Top Hole Location	Landing Point Location	Bottom Hole Location
NAD 27 Feet	NAD 27 Feet	NAD 27 Feet
N: 365346.581	N: 366898.323	N: 366356.069
E: 1775468.693	E: 1777741.611	E: 1788246.423
UTM Zone 17 (SPCS83) Meters	UTM Zone 17 (SPCS83) Meters	UTM Zone 17 (SPCS83) Meters
N: 4372550.767	N: 4372974.145	N: 4372923.236
E: 580571.762	E: 561257.397	E: 564459.636
NAD 27	NAD 27	NAD 27
N 39.5003610	N 39.5041272	N 39.5034344
W 080.2956973	W 080.2876849	W 080.2504474

02/15/2019

## PERMITTED

State Plane Coordinate  
West Virginia North

Top Hole Location	Landing Point Location	Bottom Hole Location
NAD 27 Feet	NAD 27 Feet	NAD 27 Feet
N: 365346.581	N: 366692.503	N: 366369.986
E: 1775468.693	E: 1777747.131	E: 1788258.513
UTM Zone 17 (SPCS83) Meters	UTM Zone 17 (SPCS83) Meters	UTM Zone 17 (SPCS83) Meters
N: 4372550.767	N: 4372972.400	N: 4372927.537
E: 560571.762	E: 561259.108	E: 564463.249
NAD 27	NAD 27	NAD 27
N 39.5003610	N 39.5041113	N 39.5034729
W 080.2956973	W 080.2876652	W 080.2504050

### NOTES ON SURVEY

1. NO DWELLINGS WITHIN 625' WERE FOUND.
2. NO WATER WELLS OR DEVELOPED SPRINGS WITHIN 250' WERE FOUND.
3. TIES TO WELLS AND CORNERS ARE BASED ON STATE PLANE GRID NORTH WV NORTH ZONE NAD 83.
4. WELL ELEVATION ESTABLISHED BY RTK GPS NAVD 88.
5. SURFACE OWNER AND ADJOINER INFORMATION TAKEN FROM THE ASSESSOR AND COUNTY CLERK RECORDS OF MARION COUNTY IN MAY 2016 AND FILES PROVIDED BY XTO ENERGY, INC.
6. WELLS SHOWN ARE TAKEN FROM RECORDS OF WVDEP.

SNIDER 15H		
LEASE	LESSOR	MINERAL ACREAGE
1)	JOHN E. BRENNAN	94.5000
2)	E.T. WOOD, ET AL	110
3)	ROBERT F. HORNER, ET AL	361.59
4)	JULIA CINALLI, ET AL	4.51
5)	ROBERT F. HORNER, ET AL	361.59
6)	PAULA A. WILLIAMS, ET AL	39.82
7)	PAUL KORSH, ET AL	3.26
8)	RONALD J. MERRILL, ET UX	1.0875
9)	KAREN JOHNSON, ET AL	36.125
10)	YVONNE GIBBONS, ET AL	75.75

LETTER	SURFACE OWNER	TAX PARCEL
A	GARY L. KING, ET AL	11-31-16
B	NORMA L. DAVIS	11-31-17
C	NORMA L. DAVIS	11-31-23
D	THOMAS R. BURGESS, ET UX	11-31-22
E	GEORGE W. TENNANT, SR., ET UX	11-31-22.1
F	PAUL KORSH, ET UX	11-30-41
G	PAUL KORSH, ET UX	11-30-41.1
H	RICHARD A. WADDELL, ET AL	11-30-37
I	PETER J. ALASKY, III., ET UX	11-44-42.2
J	ANTHONY P. BURNSIDE, ET AL	11-44-42.4
K	THREE A'S INC	11-44-25
L	JOHN JONES	11-44-48
M	DONALD G. MORGAN, ET UX	11-44-46
N	PRIMEACRE LAND CORPORATION	11-44-21
O	RONALD J. MERRILL, ET UX	11-44-43

### LINE LEGEND

LEASE BOUNDARY	— — — — —
SURFACE BOUNDARY	- - - - -
CREEK / STREAM	~ ~ ~ ~ ~
ROADS	— — — — —
PROPOSED LATERAL	— — — — —
APPROXIMATE CURVE	- - - - -
AS-DRILLED LATERAL	- - - - -
500' LATERAL OFFSET	- - - - -
EXISTING GAS WELL	⊙

## JONES CONSULTANTS, LLC

SURVEYING • MAPPING • LAND • GAS WELL • PIPELINE  
2402 PENNSYLVANIA 66 DELMONT, PA 15626  
(724) 757 - 2417 www.jonesconsultant.com

RECEIVED  
Office of Oil and Gas  
DEC 20 2018  
WV Department of Environmental Protection

### SUPPLEMENTAL SURFACE AND LESSOR EXHIBIT

#### SNIDER 15H

Drawn By:	Date:	LINCOLN DISTRICT
JRV	08/07/18	MARION COUNTY, WEST VIRGINIA
Scale: SCALE 1" = 1500'	Sheet:	File No.:
AFE # 808945	SHEET 2 OF 2	JC2016-41



**XTO ENERGY**  
190 THORN HILL ROAD  
WARRENDALE, PA 15086

0' 1500'

