

- Proposed Gas Well
- Located Corner, as noted
- Surface Tract Lines
- - - Reference Line
- Lease Boundary
- Creek or Drain
- ⊙ WV County Route
- ⊙ WV State Route

(⊙) Denotes Location of Well on United States Topographic Maps



I, the undersigned, hereby certify that this plat is correct to the best of my knowledge and belief and shows all the information required by law and the regulations issued and prescribed by the Department of Environmental Protection.

Ben R. Singleton
P.S. 2092



SEAL

FILE NO: 113-21
DRAWING NO: Radcliff 18H
SCALE: 1" = 2000'
MINIMUM DEGREE OF ACCURACY: 1:2500
PROVEN SOURCE OF ELEVATION: NGS CORS Station

STATE OF WEST VIRGINIA
DEPARTMENT OF ENVIRONMENTAL PROTECTION
OIL AND GAS DIVISION

DATE: July 17 20 23
OPERATOR'S WELL NO.: Radcliff 18H
API WELL NO
47 - 049 - 02515
STATE COUNTY PERMIT

WELL TYPE: OIL GAS LIQUID INJECTION WASTE DISPOSAL
(IF GAS) PRODUCTION: STORAGE DEEP SHALLOW

LOCATION: ELEVATION: 1493' WATERSHED Bartholomew Fork QUADRANGLE: Glover Gap
DISTRICT: Mannington COUNTY: Marion

SURFACE OWNER: Jackie D. & Sheila L. Radcliff ACREAGE: 1090
ROYALTY OWNER: Rebecca R. Shuttlesworth, et al. LEASE NO: 109790001 ACREAGE: 1090

PROPOSED WORK: DRILL CONVERT DRILL DEEPER FRACTURE OR STIMULATE PLUG OFF OLD FORMATION
 PERFORATE NEW FORMATION OTHER PHYSICAL CHANGE IN WELL (SPECIFY)
 PLUG AND ABANDON CLEAN OUT AND REPLUG TARGET FORMATION: Marcellus ESTIMATED DEPTH: 7916'

WELL OPERATOR: EQT Production Company DESIGNATED AGENT: Joseph C. Mallow
ADDRESS: 400 Woodcliff Drive ADDRESS: 427 Midstate Drive
Canonsburg, PA 15317 Clarksburg, WV 26301

09/15/2023

**Radcliff 18H
Radcliff
EQT Production Company**

| Tract L.D. | Tax Map No. | Parcel No. | County | District | Surface Tract Owner | Acres |
|------------|-------------|------------|--------|------------|------------------------------------|---------|
| 1 | 40 | 10.1 | Marion | Mannington | Jackie D. & Sheila L. Radcliff | 46.06 |
| 2 | 40 | 10 | Marion | Mannington | Shelly L. Nelson | 43.03 |
| 3 | 40 | 3 | Marion | Mannington | Jason G. & Heather R. Stout | 99.75 |
| 4 | 40 | 7 | Marion | Mannington | Lula B. Knight | 56.32 |
| 5 | 40 | 11 | Marion | Mannington | Clarence W. Sweeney | 63 |
| 6 | 40 | 12 | Marion | Mannington | Jackie D. & Sheila L. Radcliff | 27.35 |
| 7 | 40 | 13 | Marion | Mannington | Shelly L. Nelson | 19.75 |
| 79 | 38 | 19 | Marion | Mannington | Dorothy D. Hendershot | 38.246 |
| 83 | 38 | 20 | Marion | Mannington | Dennis G. & Louise M. Hayes | 59.24 |
| 85 | 26 | 16 | Marion | Mannington | Jason G. & Heather R. Stout | 48.12 |
| 86 | 39 | 2 | Marion | Mannington | Lula B. Knight | 43.39 |
| 88 | 38 | 21.1 | Marion | Mannington | Ronald B. Jean Hayes | 21.55 |
| 94 | 40 | 9 | Marion | Mannington | Karl A. Goud | 35.32 |
| 95 | 40 | 4 | Marion | Mannington | EBX-EM LLC | 20.8 |
| 96 | NA | NA | Marion | Mannington | Tax Info Not Available | NA |
| 97 | 26 | 15 | Marion | Mannington | Jason G. & Michelle R. Stout | 91.9 |
| 98 | 39 | 15 | Marion | Mannington | Jason G. & Michelle R. Stout | 7.5 |
| 99 | 26 | 17 | Marion | Mannington | Jason G. & Michelle R. Stout | 57 |
| 100 | 39 | 16 | Marion | Mannington | Jason G. & Michelle R. Stout | 7.351 |
| 101 | 39 | 7 | Marion | Mannington | Dennis Markel & John Pheasant | 84 |
| 102 | 39 | 9 | Marion | Mannington | Dennis Markel & John Pheasant | 62.5 |
| 103 | 39 | 11.2 | Marion | Mannington | Michael F. & Kerri Berthy | 7.01 |
| 109 | 39 | 11.3 | Marion | Mannington | Kerri F. & Michael F. Berthy | 9.11 |
| 120 | 26 | 12 | Marion | Mannington | EBX-EM LLC | 152.25 |
| 121 | 26 | 17 | Marion | Mannington | Jason G. & Michelle R. Stout | 57 |
| 122 | 39 | 1 | Marion | Mannington | Albert C. Woods Melrs | 90.6 |
| 123 | 39 | 8 | Marion | Mannington | Dennis Markel & John Pheasant | 128.625 |
| 128 | 26 | 18 | Marion | Mannington | EBX-EM LLC | 41 |
| 129 | 26 | 3 | Marion | Mannington | Thomas C. Carpenter, et al. | 150.95 |
| 130 | 26 | 2.1 | Marion | Mannington | Larry Gell | 160.04 |
| 131 | 28 | 19 | Marion | Mannington | Rickey C. Bennett | 94.12 |
| 132 | 39 | 14 | Marion | Mannington | Lee R. & Sherri L. Taylor | 36.09 |
| 133 | 39 | 13.1 | Marion | Mannington | Michael F. & Kerri Berthy | 9.26 |
| 134 | 39 | 10 | Marion | Mannington | Dennis Markel & John Pheasant | 12.17 |
| 135 | 39 | 11 | Marion | Mannington | Michael F. & Kerri Berthy | 7 |
| 136 | 26 | 11 | Marion | Mannington | EBX-EM LLC | 92 |
| 137 | 26 | 5 | Marion | Mannington | EBX-EM LLC | 60 |
| 138 | 28 | 20 | Marion | Mannington | Sportsmans Square Circle Club Inc. | 102.85 |
| 139 | 39 | 13 | Marion | Mannington | Lee R. & Sherri L. Taylor | 96.49 |
| 140 | 36 | 1 | Marion | Mannington | Lee R. & Sherri L. Taylor | 67.35 |
| 141 | 39 | 12 | Marion | Mannington | Lynn E. Sturm | 40.19 |
| 144 | 38 | 20.1 | Marion | Mannington | Donald Malone | 6.5 |

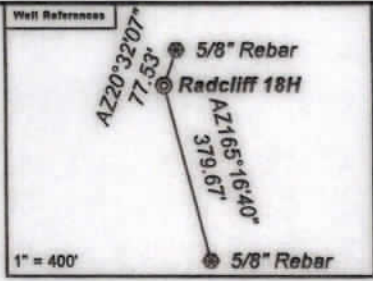

Notes:
 Radcliff 18H coordinates are
 NAD 83 N: 397,653.47 E: 1,704,133.22
 NAD 83 Lat: 39.587990 Long: -80.438077
 NAD 83 UTM N: 4,382,179.40 E: 548,252.78
 Radcliff 18H Landing Point coordinates are
 NAD 83 N: 397,965.61 E: 1,707,741.71
 NAD 83 Lat: 39.588939 Long: -80.425285
 NAD 83 UTM N: 4,382,292.85 E: 549,350.56
 Radcliff 18H Bottom Hole coordinates are
 NAD 83 N: 390,390.30 E: 1,711,660.74
 NAD 83 Lat: 39.588939 Long: -80.425285
 NAD 83 UTM N: 4,380,001.81 E: 550,583.12
 West Virginia Coordinate system of 1927 (North Zone)
 based upon Differential GPS Measurements.
 Plat orientation, corner and well ties are based upon
 the grid north meridian.
 Well location references are based upon the grid north
 meridian.
 UTM coordinates are NAD83, Zone 17, Meters.

- Radcliff**
- Radcliff 18H ☉
 - Radcliff 16H ☉
 - Radcliff 14H ☉
 - Radcliff 12H ☉
 - Radcliff 10H ☉
 - Radcliff 8H ☉
 - Radcliff 6H ☉
 - Radcliff 4H ☉

| Lease No. | Owner | Acres |
|-----------|-------------------------------------|--------|
| 109790001 | Rebecca R. Shufflesworth, et al. | 1090 |
| 174985003 | Country Roads Minerals, LLC, et al. | 59 |
| 130336000 | Beverly N. Nicklaus, et al. | 152.25 |
| 127156000 | EQT Production Company, et al. | 40.75 |
| 127156000 | EQT Production Company, et al. | 97.25 |
| 138806000 | Nancy Ellen Dennison, et al. | 129 |
| 228726001 | Bounty Minerals, LLC | 62.5 |
| 228882000 | Bounty Minerals, LLC | 36.09 |
| 127156000 | EQT Production Company, et al. | 95.75 |

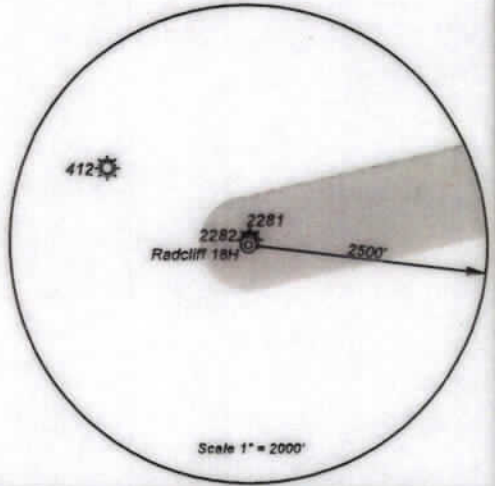

I, the undersigned, hereby certify that this plat is correct to the best of my knowledge and belief and shows all the information required by law and the regulations issued and prescribed by the Department of Environmental Protection.

Ben R. Singleton
 P.S. 2092



FILE NO: 113-21
 DRAWING NO: Radcliff 18H
 SCALE: 1" = 2000'
 MINIMUM DEGREE OF ACCURACY: 1:2500
 PROVEN SOURCE OF ELEVATION: NGS CORS Station



DATE: July 17 20 23
 OPERATOR'S WELL NO.: Radcliff 18H
 API WELL NO
 47 - 049 - 02515
 STATE COUNTY PERMIT

WELL TYPE: OIL GAS LIQUID INJECTION WASTE DISPOSAL
 (IF GAS) PRODUCTION: STORAGE DEEP SHALLOW
 LOCATION: ELEVATION: 1493' WATERSHED: Bartholomew Fork QUADRANGLE: Glover Gap
 DISTRICT: Mannington COUNTY: Marion
 SURFACE OWNER: Jackie D. & Sheila L. Radcliff ACREAGE: 46.06
 ROYALTY OWNER: Rebecca R. Shufflesworth, et al. LEASE NO: 109790001 ACREAGE: 1090
 PROPOSED WORK: DRILL CONVERT DRILL DEEPER FRACTURE OR STIMULATE PLUG OFF OLD FORMATION
 PERFORATE NEW FORMATION OTHER PHYSICAL CHANGE IN WELL (SPECIFY)
 PLUG AND ABANDON CLEAN OUT AND REPLUG TARGET FORMATION: Marcellus ESTIMATED DEPTH: 7916'
 WELL OPERATOR: EQT Production Company DESIGNATED AGENT: Joseph C. Mallow
 ADDRESS: 400 Woodcliff Drive ADDRESS: 427 Midstate Drive
 Canonsburg, PA 15317 Clarksburg, WV 26301

09/15/2023