

LATITUDE 39 30

375  
28W

LONGITUDE 80 25

7'5 OGIS topo location

7.5' loc \_\_\_\_\_ 15' loc \_\_\_\_\_  
(calc.) \_\_\_\_\_

Company \_\_\_\_\_

Farm HARRY HUEY 1

Quad WALLACE

County MARION

District MANNINGTON

WELL LOCATION MAP

File No. 30034



Harry Huey well No. 1 - Mannington District, Marion County, West Virginia.

ENGINEER'S CERTIFICATE

I, the undersigned, hereby certify that this map is correct and shows all the information to the best of my knowledge and belief as required by the oil and gas section of the mining laws of West Virginia.

*Frank Ferguson*  
Engineer

Acknowledged before me a Notary Public this 8th day of April, 1931.  
My commission expires March 30th, 1935.

*John F. Wiegman*  
Notary Public  
JOHN F. WIEGMAN, NOTARY PUBLIC  
MY COMMISSION EXPIRES MAR. 30, 1935

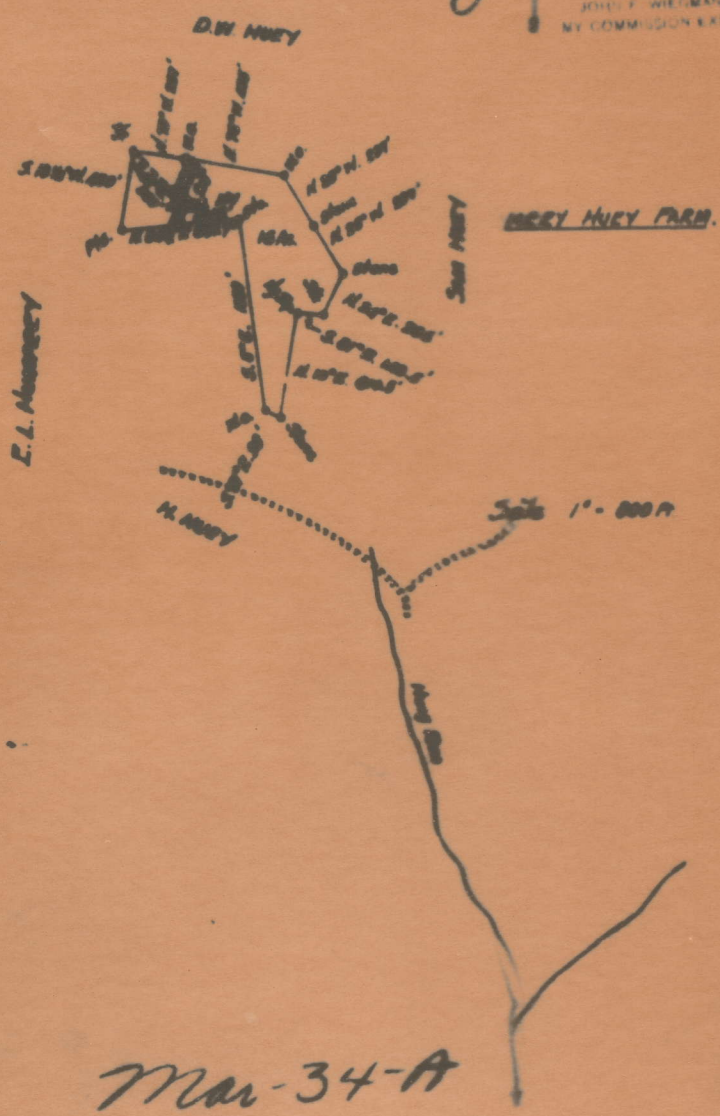

Mar-34-A



Mannington District, Marion County, W. Va.  
 By South Penn Oil Co., P. O. Drawer 1255, Pittsburgh, Pa.  
 On 16 acres, surface owned by Pinkey Athey, Route 2, Mannington,  
 W. Va., and mineral rights by Harry Huey, Mannington, W. Va.  
 Elevation, 1412' L.  
 10" casing, 365'; 8", 1538'; 6-5/8", 2300'; 6", 2961';  
 2" tubing, 3488'.  
 Coal was encountered at 910-915 and 1015-1022'.  
 Abandonment reported to Dept. of Mines April 29, 1931.  
 Well was not shot.  
 Salt water at 1825'.  
 Gas well.

MAR-34-A

	Top.	Bottom.
Mapletown (Sewickley) Coal	910	915
Pittsburgh Coal	1015	1022
Little Dunkard Sand	1455	1490
Big Dunkard Sand	1520	1545
Gas Sand	1725	1790
1st Salt Sand (water, 1825')	1820	1910
2nd Salt Sand	2000	2075
Maxton Sand (oil show, 2205')	2150	2230
Little Lime	2247	2261
Pencil Cave	2262	2265
Big Lime	2265	2315
Big Injun Sand (oil show, 2420-2425')	2315	2455
Fifty-foot Sand (gas, 2973')	2932	2979
Thirty-foot Sand (oil show, 3022')	3012	3038
Boulder Sand	3058	3080
Gordon Sand (hole reduced at 3152')	3152	3180
Fourth Sand	3190	3208
Sand	3232	3255
Total depth		3488



Mannington District, Marion County, W. Va.

South Penn Oil Co.

On 16 acres, surface owned by Pinky ~~Watts~~ Athey, Route 2,

Mannington, W. Va., and mineral rights by Harry Huey.

Mannington, W. Va.

Elevation, 1412' L.

10" casing, 365'; 8 1/2", 1538'; 6-5/8", 2300' 6"; 5-3/16", 2961';  
2", 3488'.

Abandonment reported to Dept. of Mines April 29, 1931.

Well was not shot.

	Top.	Bottom.
Mapletown Coal	910	915
Pittsburgh Coal	1015	1022
Little Dunkard Sand	1455	1490
Big Dunkard Sand	1520	1545
Gas Sand	1725	1790
1st Salt Sand (water, 1825')	1820	1910
2nd Salt Sand	2000	2075
Maxton Sand (oil show, 2205')	2150	2230
Little Lime	2247	2261
Pencil Cave	2262	2265
Big Lime	2265	2315
Big Injun Sand (oil show, 2420-2425')	2315	2455
50-Ft. Sand (gas, 2973')	2932	2979
30-Ft. Sand (oil show, 3022')	3012	3038
Boulder Sand	3058	3080
Gordon Sand (Hole reduced at 3152')	3152	3180
4th Sand	3190	3208
Sand	3232	3255
Total depth		3488