

1 2 3

Latitude 39 35

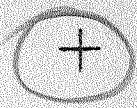

Longitude 80 25

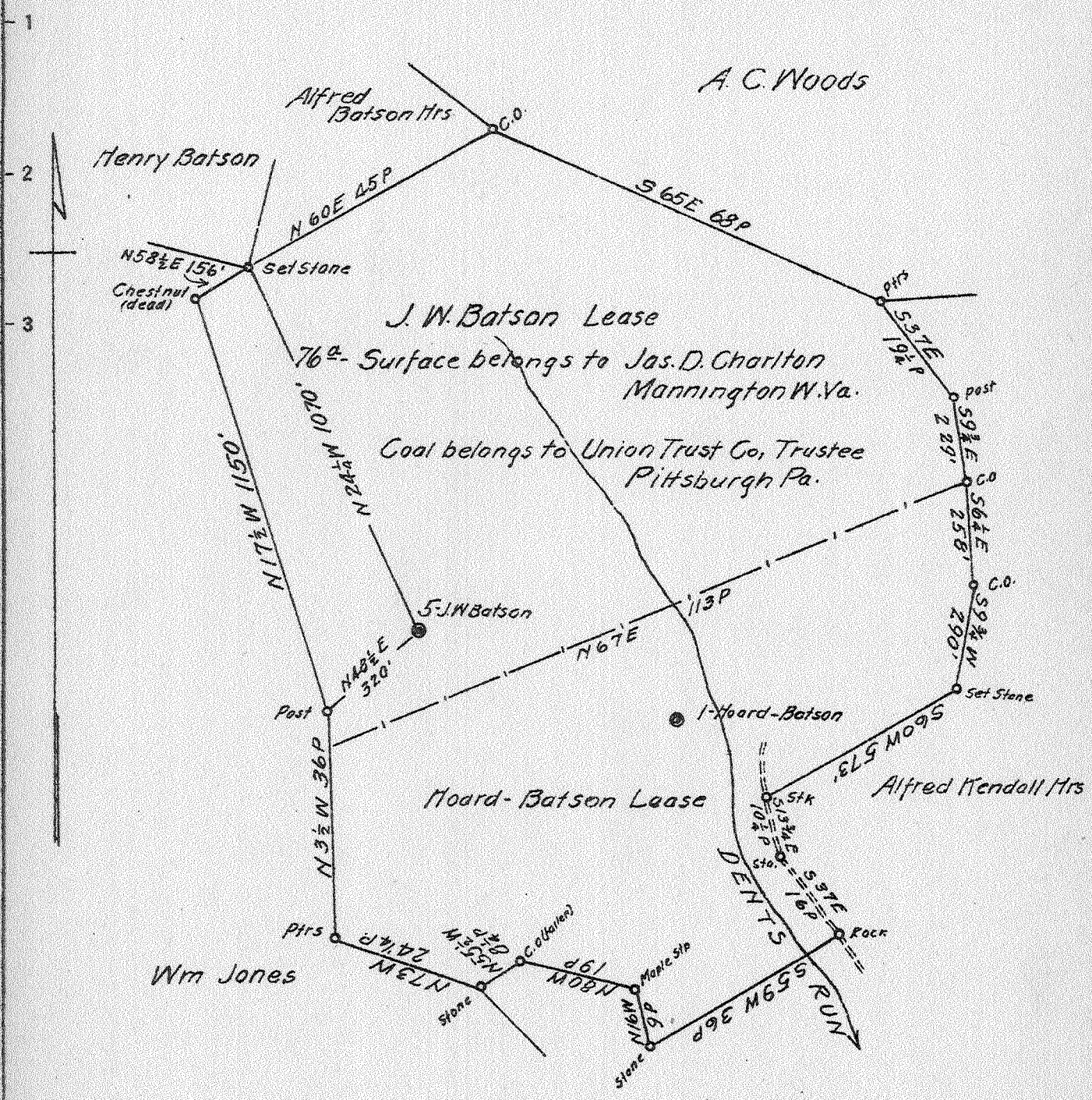

New Location
 Drill Deeper
 Abandonment

0.40W 0.41W
 0.52S 0.53 S
 JUN - 6 1943

Company South Penn Natural Gas Co
 Address Parkersburg W. Va.
 Farm J. W. Batson
 Tract _____ Acres 84 Lease No. 69215
 Well (Farm) No. 5 Serial No. _____
 Elevation (Spirit Level) 1437⁵² DF. 1435¹² G
 Quadrangle Mannington
 County Marion District Mannington
 Engineer E. C. Tabler
 Engineer's Registration No. _____
 File No. 4-26-43 Drawing No. _____
 Date ↑ Scale 1" = 400'

STATE OF WEST VIRGINIA
 DEPARTMENT OF MINES
 OIL AND GAS DIVISION
 CHARLESTON

WELL LOCATION MAP
 FILE NO. MAR-376-A

+ Denotes location of well on United States Topographic Maps, scale 1 to 62,500, latitude and longitude lines being represented by border lines as shown.
 - Denotes one inch spaces on border line of original tracing.

J. W. BATSON NO. 5 - SOUTH PENN N.G. Co. - MAR-376-A

STATE OF WEST VIRGINIA
DEPARTMENT OF MINES
OIL AND GAS DIVISION

446

WELL RECORD

Permit No. 376-A Oil or Gas Well OIL
(KIND)

Company South Penn Natural Gas Company
Address Union Trust Bldg. Parkersburg, W. Va.
Farm J. W. Batson Acres 84
Location (waters) Dents Run
Well No. 5 Elev. 1435.12
District Mannington County Marion
The surface of tract is owned in fee by Jas. D. Charlton
Address Mannington, W. Va.
Mineral rights are owned by Zebedee Batson,
R. D. No. 5, Address Mannington, W. Va.
Drilling commenced July 16, 1917
Drilling completed October 12, 1917
Date Shot See below From -- To --
With ----
Open Flow /10ths Water in -- Inch
/10ths Merc. in -- Inch
Volume -- Cu. Ft.
Rock Pressure -- lbs. -- hrs.
Oil 10 bbls., 1st 24 hrs.
Fresh water --- feet. --- feet
Salt water XXXX 2544 feet. --- feet

Casing and Tubing	Used in Drilling	Left in Well	Packers
Size			
16.			Kind of Packer <u>--</u>
13.			<u>--</u>
10.	<u>591'</u>		Size of <u>--</u>
8 1/4	<u>1678'</u>		<u>--</u>
6 3/4	<u>2474'</u>	<u>10"</u>	Depth set <u>--</u>
5 3/16	<u>2828'</u>		<u>--</u>
3.			Perf. top <u>--</u>
2.			Perf. bottom <u>--</u>
Liners Used			Perf. top <u>--</u>
Cond.	<u>16'</u>		Perf. bottom <u>--</u>

CASING CEMENTED -- SIZE -- No. Ft. -- Date --
COAL WAS ENCOUNTERED AT 1115 FEET 60 INCHES
1214 FEET 108 INCHES -- FEET -- INCHES
-- FEET -- INCHES -- FEET -- INCHES

Formation	Color	Hard or Soft	Top	Bottom	Oil, Gas or Water	Depth Found	Remarks
Mapletown	Coal		1115	1120			
Pittsburgh	Coal		1214	1223			
Little Dunkard			1595	1605			
Big Dunkard			1648	1723			
Gas Sand			1903	1960			
1st Salt Sand			1978	2010			
2nd Salt Sand			2045	2215			
Maxon Sand			2295	2320			
Little Lime			2432	2444			
Pencil Cave			2444	2452			
Big Lime			2452	2508			
Big Injun			2508	2648			
					Water	2544	
					Show of Oil	2594	
Fifty Foot Sand			3150	3185	Gas	3181	
Thirty Foot Sand			3215		Gas	3220	
					Gas & Oil	3223	
Total Depth				3232			

SHOT RECORD:
10 - 17 - 17 20 Qt.
10 - 18 - 17 20 Qt.
10 - 9 - 18 40 Qt.

