

Latitude 39° 35'

Longitude 80° 05'

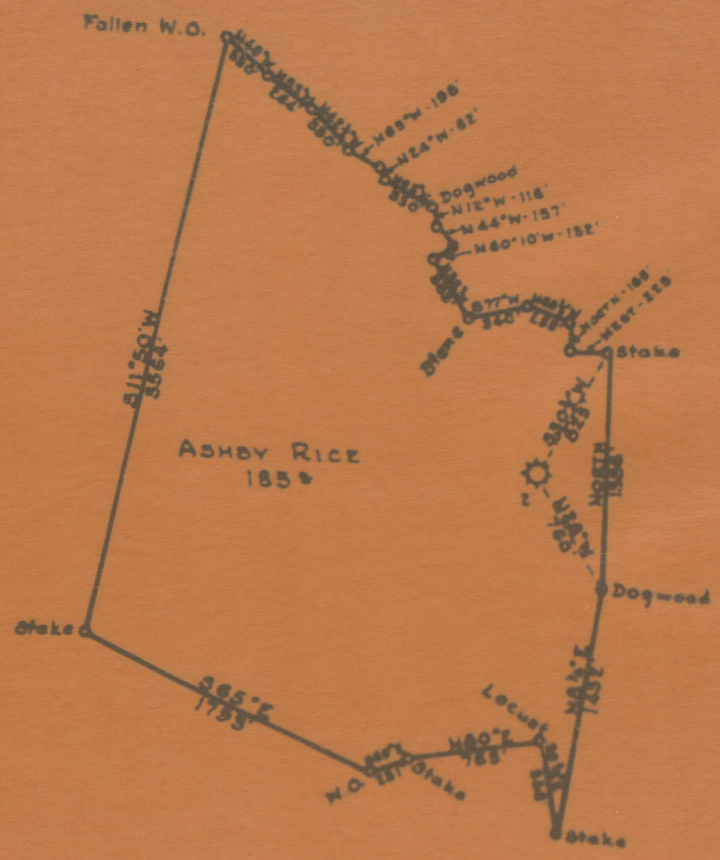

New Location   
 Drill Deeper   
 Abandonment

Company WILHELM & JACKSON  
 Address HAMLIN, W. VA.  
 Farm ASHBY RICE  
 Tract Acres 185 Lease No. \_\_\_\_\_  
 Well (Farm) No. 2 Serial No. 123

STATE OF WEST VIRGINIA  
 DEPARTMENT OF MINES  
 OIL AND GAS DIVISION  
 CHARLESTON  
 WELL LOCATION MAP



ASHBY RICE "A" NO. 2 (123) WELL.

7156

Paupaw District, Marion County, W. Va.  
 By Owens, Libbey-Owens Gas Dept., Charleston, W. Va.  
 Abandoned under permit Mar-.....-4?  
 On..... acres.  
 Elevation, .....<sup>1</sup> L.  
 Drilling commenced Aug. 11, 1928; completed Sept. 18, 1928.  
 Volume, 149,000 cu. ft.  
 Rock pressure, 102 lbs. in 24 hrs.  
 Water, 20', hole full. Water, 1363-1368', 5 mbis./hr.  
 Gas, 1838-1846', 158 M. Gas, 2263-2268', 166 M. cu. ft.  
 Gas well. Record to Dept. of Mines stamped Aug. 14, Sept. 31, 1952.  
 Record to RCT from Mrs. Griffith Dec. 2, 1952. O.F.No.853.

	Top.	Bottom.
Napletown (Sewickley) Coal	277	- 279
Pittsburgh Coal	364	- 367
Gas Sand	967	- 1009
Salt Sand	1302	- 1409
Big Lime	1658	- 1770
Big Injun Sand	1770	- 1875
Gantz Sand	2245	- 2297
Total depth		2317



STATE OF WEST VIRGINIA  
DEPARTMENT OF MINES  
OIL AND GAS DIVISION

853

Permit No. MAK-775-A

WELL RECORD

Oil or Gas Well \_\_\_\_\_  
(KIND)

Company W. H. H. & Co. Inc. - Liberty-Central Gas Dept.  
 Address Charleston, W. Va.  
 Farm Libby Mine #1 Acres \_\_\_\_\_  
 Location (waters) \_\_\_\_\_  
 Well No. 2, Serial 123 Elev. \_\_\_\_\_  
 District Law Tax County Marion  
 The surface of tract is owned in fee by \_\_\_\_\_  
 Address \_\_\_\_\_  
 Mineral rights are owned by \_\_\_\_\_  
 Address \_\_\_\_\_  
 Drilling commenced August 11, 1928  
 Drilling completed September 17, 1928  
 Date Shot \_\_\_\_\_ From \_\_\_\_\_ To \_\_\_\_\_  
 With \_\_\_\_\_  
 Open Flow \_\_\_\_\_ /10ths Water in \_\_\_\_\_ Inch  
 \_\_\_\_\_ /10ths Merc. in \_\_\_\_\_ Inch  
 Volume 119,000 Cu. Ft.  
 Rock Pressure 1022 lbs. 21 hrs.  
 Oil \_\_\_\_\_ bbls., 1st 24 hrs.  
 Fresh water \_\_\_\_\_ feet \_\_\_\_\_ feet  
 Salt water \_\_\_\_\_ feet \_\_\_\_\_ feet

Casing and Tubing	Used in Drilling	Left in Well	Packers
Size			
16		15'	Kind of Packer _____
13			Motor-Anchor
10	127'	127'	Size of _____
8 1/2	1363'		6-5/8" x 3 1/2"
6 5/8	1698'	1698'	Depth set _____
5 3/16			1731-1739'
3			Perf. top _____
2	2317'	2317'	Perf. bottom _____
Liners Used			Perf. top _____
			Perf. bottom _____

CASING CEMENTED \_\_\_\_\_ SIZE \_\_\_\_\_ No. Ft. \_\_\_\_\_ Date \_\_\_\_\_

COAL WAS ENCOUNTERED AT \_\_\_\_\_ FEET \_\_\_\_\_ INCHES  
 \_\_\_\_\_ FEET \_\_\_\_\_ INCHES FEET \_\_\_\_\_ INCHES  
 \_\_\_\_\_ FEET \_\_\_\_\_ INCHES FEET \_\_\_\_\_ INCHES

Formation	Color	Hard or Soft	Top	Bottom	Oil, Gas or Water	Depth Found	Remarks
Poplerton Coal			277	279	Water 20' - hole full		
Pittsburgh Coal			364	367			
Gas Sand			967	1009			
Salt Sand			1302	1409	Water 1363'-1368' - 5 bbls. hr.		
Big Lime			1658	1770			
Injun Sand			1770	1875	Gas 1833-1846 - 153 bbls		
Canta Sand			2245	2297	Gas 2263-2268' - 156 bbls		
Total Depth				2317'			

