

LATITUDE

39 52 30

0 → OGIS
75' loc

30 30

LONGITUDE

7'5 OGIS topo location

7.5' loc 0.50S
1.81W

15' loc 3.38S
(calc.) 1.81W

Company _____

Farm _____

Quad Cameron + 15' ec

County _____

District Cameron

WELL LOCATION MAP

File No. Marshall 1

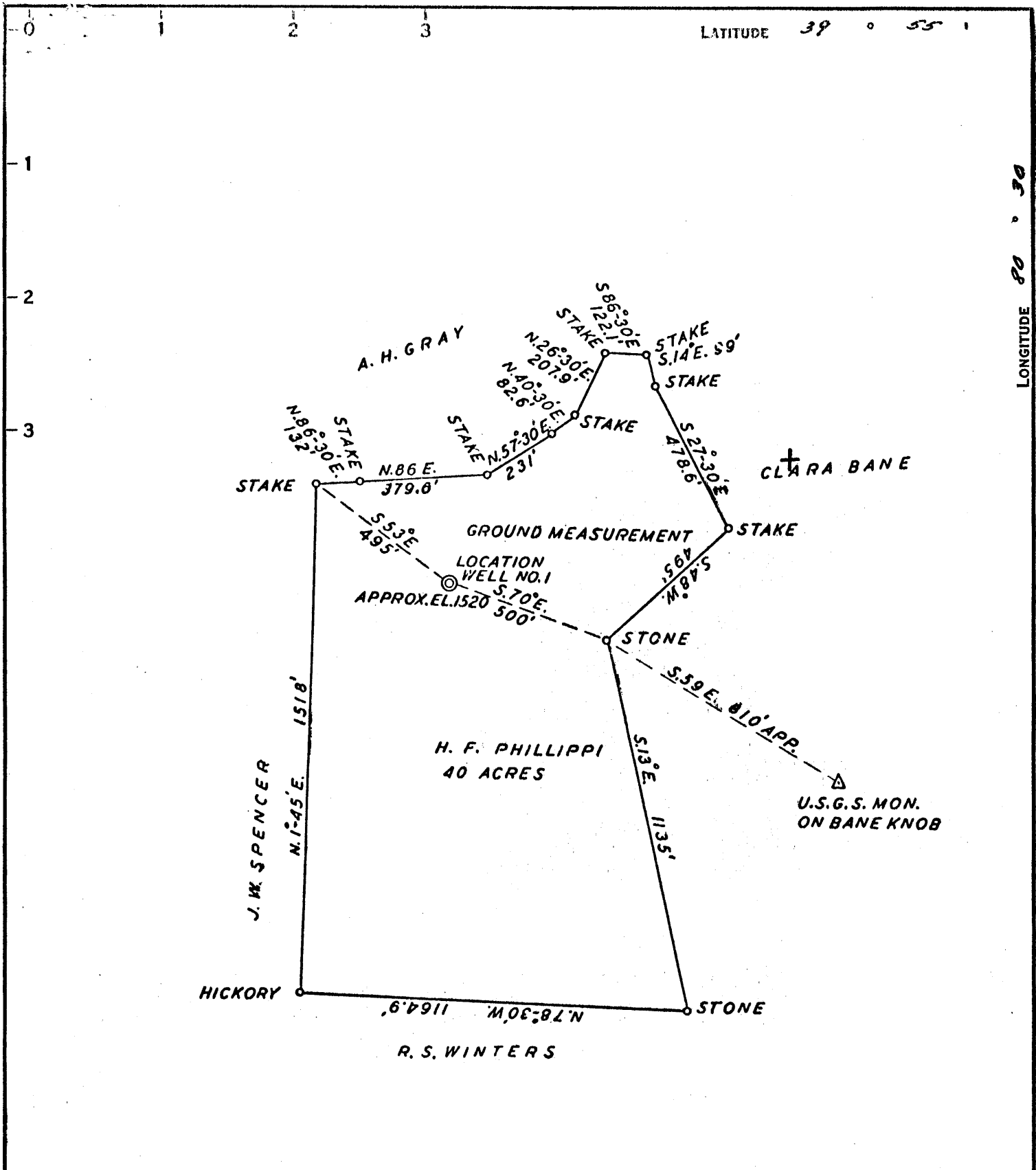

3.25S
1.82W

COAL OWNED BY _____

NEW LOCATION...

DRILL DEEPER...

ABANDONMENT...

0-25-20

COMPANY THE MANUFACTURERS LIGHT & HEAT

ADDRESS 800 UNION TRUST BLDG., PGM., PA.

FARM H. F. PHILLIPPI

TRACT _____ ACRES 40 LEASE No. 9051

WELL (FARM) No. 1 SERIAL No. 3387

ELEVATION (SPIRIT LEVEL) 1520'

QUADRANGLE CAMERON

COUNTY MARSHALL DISTRICT CAMERON

ENGINEER D. V. Brush

ENGINEER'S REGISTRATION No. 5396

FILE No. _____ DRAWING No. Y-25-544

DATE 15 MAY 62 SCALE 1" = 400'

STATE OF WEST VIRGINIA
DEPARTMENT OF MINES
OIL AND GAS DIVISION
CHARLESTON

WELL LOCATION MAP
File No. MARS-445-A
Now - MARS-01

+ DENOTES LOCATION OF WELL ON UNITED STATES TOPOGRAPHIC MAPS. SCALE 1 TO 62,500. LATITUDE AND LONGITUDE LINES BEING REPRESENTED BY BORDER LINES AS SHOWN.

— DENOTES ONE INCH SPACES ON BORDER LINE OF ORIGINAL TRACING.

Cameron District, Marshall County, W. Va.
 By Manufacturers Light & Heat Co.
 Completed Nov. 30, 1929.
 Record from Mr. Schillhelm Sept. 30, 1939.

Marshall 1

222-250 Sept 25, 1939

	Top.	Bottom.
Pittsburgh Coal	1023	- 1030
Murphy Sand	1115	- 1145
Little Dunkard Sand	1420	- 1460
Big Dunkard Sand	1508	- 1560
Export Coal	1615	- 1620
Coal	1730	- 1734
Salt Sand (water, 1800')	1790	- 1815
Big Lime	2110	- 2153
Big Injun Sand	2233	- 2395
50-Foot Sand (gas pay, 2944-2951')	2941	- 2952
Gordon Sand	3028	- 3035
4th Sand (sm. gas, 3064')	3062	- 3075
5th Sand	3098	- 3106
Total depth		3157