

COAL OWNED BY _____
 Recondition for Storage PAR. PLUG.
 NEW LOCATION
 DRILL DEEPER
 ABANDONMENT *issued 1-21-71*

0-25-29

COMPANY THE MANUFACTURERS LIGHT & HEAT CO.
 ADDRESS PITTSBURGH, PENNA.
 FARM Thomas Geho
 TRACT _____ ACRES 25 LEASE No. 28905
 WELL (FARM) No. 1 SERIAL No. L-4406
 ELEVATION (SPIRIT LEVEL) 832.2'
 QUADRANGLE Cameron SC
 COUNTY Marshall DISTRICT Liberty
 ENGINEER Robert McNeill (J.E.)
 ENGINEER'S REGISTRATION No. 361-E
 FILE No. _____ DRAWING No. Y-15-702
 DATE 1-9-58 SCALE 1" = 400'

STATE OF WEST VIRGINIA
 DEPARTMENT OF MINES
 OIL AND GAS DIVISION
 CHARLESTON

WELL LOCATION MAP

FILE No. MARS-333-REDRILL-P

+ DENOTES LOCATION OF WELL ON UNITED STATES TOPOGRAPHIC MAPS, SCALE 1 TO 62,500. LATITUDE AND LONGITUDE LINES BEING REPRESENTED BY BORDER LINES AS SHOWN.

- DENOTES ONE INCH SPACES ON BORDER LINE OF ORIGINAL TRACING.

AM

0 1 2 3 LATITUDE 39° 50'

1

2

3 LONGITUDE 80° 35'

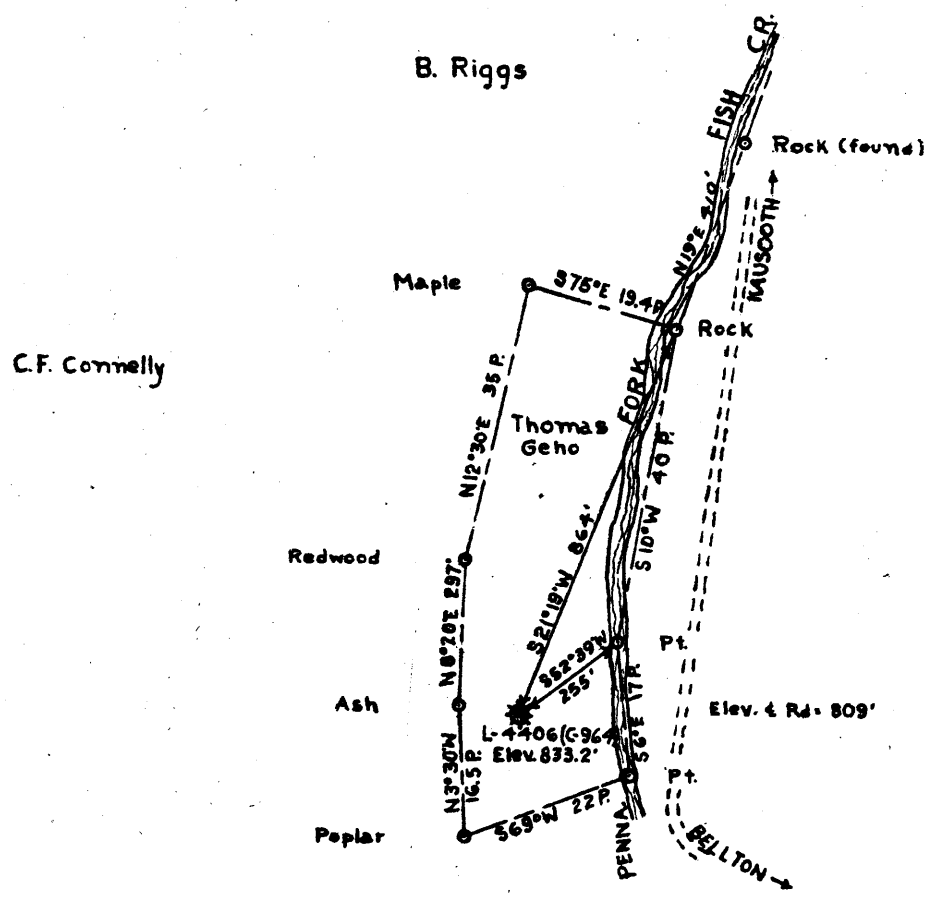

5.295
0.17W
+

0-25-29

COAL OWNED BY _____
 Recondition for Storage & PRR. PLUS.
 NEW LOCATION.....
 DRILL DEEPER.....
 ABANDONMENT.....

COMPANY THE MANUFACTURERS LIGHT & HEAT CO.
 ADDRESS PITTSBURGH, PENNA.
 FARM Thomas Geho
 TRACT _____ ACRES 25 LEASE No. 28905
 WELL (FARM) No. 1 SERIAL No. L-4406
 ELEVATION (SPIRIT LEVEL) 832.2'
 QUADRANGLE Cameron
 COUNTY Marshall DISTRICT Liberty
 ENGINEER Robert McNeill (J.E.)
 ENGINEER'S REGISTRATION No. 361-E
 FILE No. _____ DRAWING No. Y-15-702
 DATE 1-9-58 SCALE 1"=400'

STATE OF WEST VIRGINIA
 DEPARTMENT OF MINES
 OIL AND GAS DIVISION
 CHARLESTON

WELL LOCATION MAP
 FILE No. MARS-333-Redrill

+ DENOTES LOCATION OF WELL ON UNITED STATES TOPOGRAPHIC MAPS. SCALE 1 TO 62,500. LATITUDE AND LONGITUDE LINES BEING REPRESENTED BY BORDER LINES AS SHOWN.
 - DENOTES ONE INCH SPACES ON BORDER LINE OF ORIGINAL TRACING.



STATE OF WEST VIRGINIA
DEPARTMENT OF MINES
OIL AND GAS DIVISION

Quadrangle Cameron

Permit No. MARS-390 333-Redrill

WELL RECORD

Oil or Gas Well GAS
(KIND)

Company <u>The Manufacturers Light and Heat Company</u>	Casing and Tubing	Used in Drilling	Left in Well	Packers
Address <u>800 Union Trust Building, Pgh. 19, Penna.</u>				
Farm <u>Thomas Geho</u> Acres <u>25</u>	Size			
Location (waters) _____	16			Kind of Packer _____
Well No. <u>4406</u> Elev. <u>832.2'</u>	18			
District <u>Liberty</u> County <u>Marshall</u>	10"	133'	133'	Size of _____
The surface of tract is owned in fee by _____	8 1/4"	631'	980'	Depth set _____
Address _____	8 1/4" 7"	1582'	1582'	
Mineral rights are owned by _____	5 3/16"			
Address _____	3			Perf. top _____
Drilling commenced <u>June 10, 1958</u>	2			Perf. bottom _____
Drilling completed <u>September 12, 1958</u>	Liners Used _____			Perf. top _____
Date Shot _____ From _____ To _____				Perf. bottom _____
With _____				
Open Flow _____ /10ths Water in _____ Inch				
_____ /10ths Merc. in _____ Inch				
Volume _____ Cu. Ft.				
Rock Pressure _____ lbs. _____ hrs.				
Oil _____ bbls., 1st 24 hrs.				
Fresh water _____ feet _____ feet				
Salt water _____ feet _____ feet				

CASING CEMENTED _____ SIZE _____ No. Ft. _____ Date _____

COAL WAS ENCOUNTERED AT _____ FEET _____ INCHES
_____ FEET _____ INCHES
_____ FEET _____ INCHES

Formation	Color	Hardness Soft THICKNESS	Top	Bottom	Oil, Gas or Water	Depth Found	Remarks
Schlumberger Well Survey							
✓ Pittsburgh Coal		6	562	568	All Pipe Measured Over Threads. Run 133' of 10 3/4" Casing, Smls, Gr. H 32# on a Steel Shoe and Cemented with 225 Bags of Cement, 15.6# per Gallon. Good Return of Cement at Surface. Run X 6: 631' of 8 5/8" Casing Smls. Gr. J. 24# and and connected it to 349' of original 8 1/4" Casing with a Steel Die Nipple. Cemented with 175 Bags of Cement 14.9# per gallon, No Return of Cement at Surface. Run 1582' of 7" Casing, Smls. Gr. J. 20# on a Steel Shoe set at 1570' and cemented with 200 Bags of Cement. 14.6# per Gallon. Good return of cement at surface. Well cleaned out to depth of 2600', X plugged back to 2050' with Rock and Mud. Plugged back from 2050' to 2040' with Rock. Cemented from 2040' to 1650' with 80 bags of neat cement.		
✓ Maxton Sand		8	1572	1580			
✓ Lower Maxton		14	1626	1640			
✓ Top Big Line			1662				
✓ Bottom Injun				1965			
Total Depth				1650			
7" Shoe set at			1662 832 ----- 830	1570			

Prob Storage Well

