

LATITUDE 39° 47' 30"

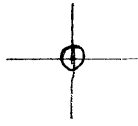

80° 30' 00" LONGITUDE

7'5 OGIS topo location

7.5' loc 0.815 ✓ 15' loc _____
 1.51W (calc.) _____

Company _____

Farm _____

Quad CAMERON 7 1/2'

County MARSHALL

District LIBERTY

WELL LOCATION MAP

File No. 051 - 583

(024)

COMPANY COLUMBIA GAS TRANSMISSION CORPORATION MAP NO. Cameron
FARM H. L. Gray Agt. WELL NO. 601275
DISTRICT Liberty COUNTY Marshall STATE WV
SCALE: 1" = 1320' LONG. 80°31'39" LAT. 39°46'45"

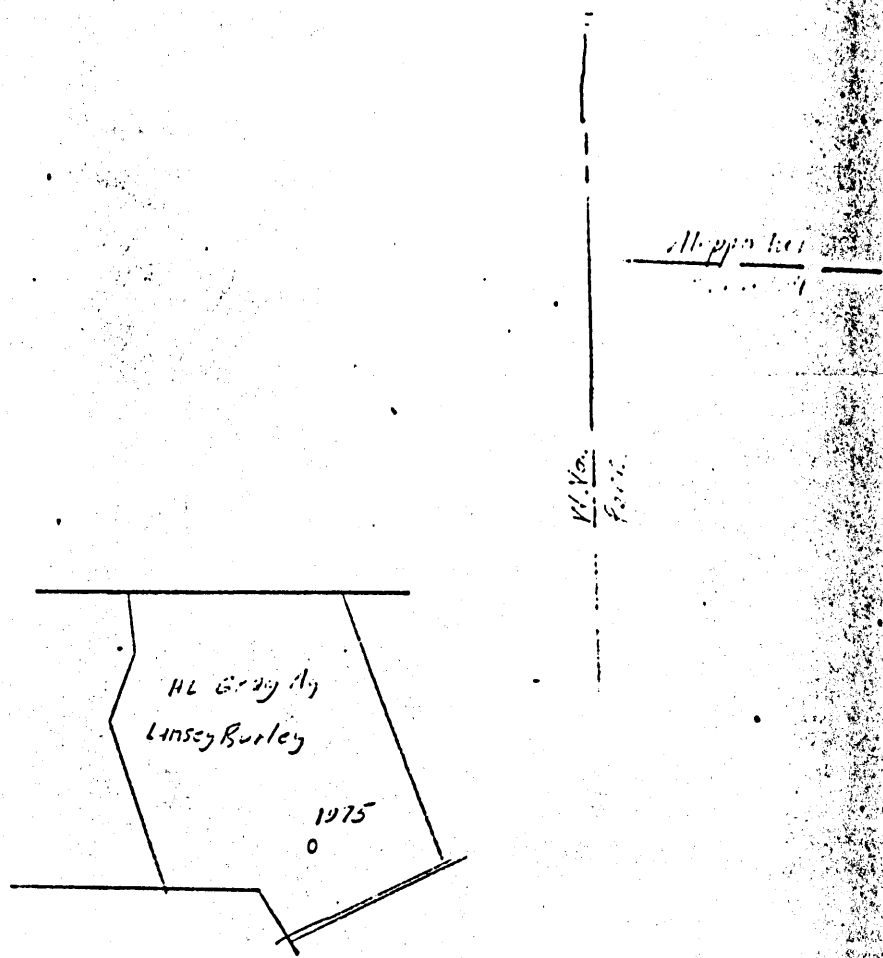

The Manufacturers Light & Heat Co. Company

248 Fourth Ave., Pittsburgh, Penna.

Division *Cumberland*
 Record of Well No. *1975* on *L. Bury* Farm Acres
Dumfries Field *Liberty* District Township *Marshall* County *W Va.* State
 Rig Commenced *July 15* 1916, Completed *July 15* 1916
 Drilling Commenced *July 25* 1916, Completed *Aug 11* 1916
 Cost per foot *1.25* Contractor *G. Campbell Pugh* Address *New Cumberland W. Va.*
 Drillers' Names *Key Virgin, Garfield Jones*

BOILER

ENGINE

RIG

H. P.	No.	Name of Maker	H. P.	No.	Name of Maker	New	Old	Height	Name of Builder
						yes		82	W. H. West

CONDUCTOR AND CASING USED IN DRILLING

Conductor	13 inch	10 inch	8 1/4 inch	6 3/4 inch	6 1/4 inch	6 inch	5 3/8 inch	6 inch	4 inch
<i>14</i>		<i>295</i>	<i>1295</i>						

CONDUCTOR AND CASING LEFT IN WELL

Conductor	13 inch	10 inch	8 1/4 inch	6 3/4 inch	6 1/4 inch	6 inch	5 3/8 inch	6 inch	4 inch	3 inch
<i>14</i>			<i>1295</i>						<i>1748.02</i>	

OIL WELL

GAS WELL

When Shot	Size of Torpedo	1st Day's Production	Tubing	Rods	Tanks	Size of Packer	Depth Set	Packed with	1st Minute's Pressure	Rock Pressure
						<i>8 1/4 x 4</i>	<i>1719.7</i>	<i>7</i>	<i>95</i>	<i>15-7 1/2</i> <i>615</i>

FORMATION

Top Bottom Thickness

REMARKS

<i>Shale & Slate</i>	0	370	370							
<i>Coal</i>	370	374	4							
<i>Coal</i>	450	453	3							
<i>Fairview coal</i>	570	514	4							
<i>Martletown Coal</i>	705	710	5							
<i>Pg^h Coal</i>	805	812	7							
<i>Red rock red soil</i>	860	878	18							
<i>Sand</i>	925	945	20							
<i>Little Dunkard</i>	1220	1230	10							
<i>Big Dunkard</i>	1330	1350	20							
<i>Gas sand</i>	1480	1495	15							
<i>1st salt sand</i>	1630	1685	55							
<i>2nd salt sand</i>	1700	—	34							

Total Depth 1734.

Show of gas in ^{3rd} coal and 2 barrels of water in tr. 2nd salt sand very hard. Aug 13-1916. well packed in second salt sand. at 1719.07" with 8 1/4 x 4" Spring anchor Packer, anchor set 1 ft above Packer 1719.07 80 psi Total 1748.02 made in 4" Tubing with spring gag. 95-170-290-295-305. 157 to 615 shut in at 5:45 PM. Aug 13-1916.

MSH-583

APPROVED
J. J. [Signature]
 Genl Supt

Division

Company

Record of Well No. **1975**

on

Farm

Acres

Field

District
Township

County

State

Rig Commenced

19

Completed

19

Drilling Commenced

19

Completed

19

Contractor

Address

Driller' Name

CASING AND TUBING RECORD

Conductor	13"	10"	8 1/2"	7"	6 1/2"	5 1/2"	4"	3"
Used in Drig.								
Left in Well								

PACKER RECORD

SHOOTING RECORD

Size	Depth Set	Type Packer	Date	Type Explosive	Amount	DEPTH		Volume Before Cu. Ft.	Volume After Cu. Ft.
						Top	Bottom		

VOLUME AND PRESSURE

Date	Reading in Inches	Liquid	Size Orifice	Volume	Sand	PRESSURE IN MIN.					24 Hr. R. P.	Max. R. P.	
						1	5	10	20	60			

TOTAL INITIAL OPEN FLOW

CUBIC FEET PER 24 HOURS

FORMATION	TOP	BOTTOM	THICKNESS	REMARKS		
Lime white hard	374	400	7 1/2	Lime gray hard	1140	1170
Lime white's hard	453	485	3 1/2	slate black soft	1170	1185
Sand " "	485	570	20'	red rock - red soft	1185	1195
Lime white hard	514	530	1 1/2	Lime white hard	1195	1210
slate & shells	530	550	20	Red Rock red soft	1210	1220
Lime white hard	550	570	20	slate dark soft	1230	1240
slate dark soft	570	575	5'	shell dark hard	1240	1270
Lime white hard	575	700	120'	slate dark soft	1270	1290
slate dark soft	700	705	5'	Lime shell white	1290	1300
Lime white hard	710	805	95'	slate gray soft	1300	1330
Lime dark hard	812	840	48'	slate gray soft	1350	1370
Lime white hard	878	895	27'	Lime white hard	1375	1410
slate dark soft	905	915	10'	slate dark soft	1410	1430
Lime white hard	915	925	10'	shell dark hard	1430	1435
Red Rock red soft	945	955	10'	slate dark soft	1435	1470
Lime white hard	955	970	15'	Lime light hard	1470	1470
Red Rock red soft	970	985	15'	slate dark soft	1470	1480
Lime white hard	985	1000	15'	slate dark soft	1495	1530
slate dark soft	1000	1020	20'	Lime shells hard	1530	1550
Lime white hard	1020	1030	10'	slate dark soft	1550	1570
slate dark soft	1030	1035	5'	Sand light hard	1570	1600
Lime white hard	1035	1050	15'	Coal black soft	1600	1605
slate light soft	1050	1058	8'	slate dark soft	1605	1630
Red Rock red soft	1058	1070	12'	slate dark soft	1630	1700
Lime white hard	1070	1095	25'			
Red Rock red soft	1095	1120	25'			
shell dark hard	1120	1130	10'			

MSH-583

The Mfrs Light & Heat Company

Division CAMERON

248 Fourth Ave., Pittsburgh, Pa.

Record of Well No. 1975 on Lindsay Burloy

Farm

Acres

Cameron Field Liberty

District Township

Marshall

County W.Va.

State

Rig Commenced Repaired 19 Completed 19

Drilling Commenced February 22nd 1923 Completed February 23rd 1923

Cost per Foot \$2.00 Contractor M.J.Cummings Address Cameron, W.Va.

Drillers' Names I.C.Young, Joe Wood, S.W.Morgan, and A.R.Lemasters

BOILER			ENGINE			RIG			
H. P.	No.	Name of Maker	H. P.	No.	Name of Maker	New	Old	Height	Name of Builder

CONDUCTOR AND CASING USED IN DRILLING

Conductor	12 inch	10 inch	8 1/2 inch	6 3/4 inch	6 inch	5 1/2 inch	5 1/8 inch	4 inch	3 inch

CONDUCTOR AND CASING LEFT IN WELL

Conductor	12 inch	10 inch	8 1/2 inch	6 3/4 inch	6 inch	5 1/2 inch	5 1/8 inch	4 inch	3 inch

OIL WELL

GAS WELL

When Shot	Size of Turbine	1st Day's Production	Tubing	Rods	Tanks	Size of Packer	Depth Set	Packed with	1st Minute Pressure	Rock Press

FORMATION	Top	Bottom	Thickness	REMARKS
-----------	-----	--------	-----------	---------

2nd Salt Sand
Total Depth

1738

When Drilling Deeper was Commenced.
1750

MCH-502

The Manufacturing Light & Heat Company

Division 2 Drilling deeper record.

Record of Well No. 1975 on Lindsay burley Farm 122 Acres
 Cameron Field Liberty District Marshall County W.Va. State
 Rig Commenced 19 Completed 19
 Drilling Commenced June 7, 1931 19 Completed Sept. 7, 1931. 19
 Cost per Foot \$2.00 Contractor F.G. Burson Address Elm Grove, W.Va.
 Drillers' Names S.T. Carpenter, Warren McVay toolies J.H. Echols and J.B. Callentine

BOILER			ENGINE			RIG			
H. P.	No.	Name of Maker	H. P.	No.	Name of Maker	New	Old	Height	Name of Builder

CONDUCTOR AND CASING USED IN DRILLING									
Conductor	12 inch	10 inch	8 1/2 inch	8 1/4 inch	8 1/8 inch	8 1/4 inch	8 1/4 inch	8 inch	6 inch

CONDUCTOR AND CASING LEFT IN WELL									
Conductor	12 inch	10 inch	8 1/2 inch	8 1/4 inch	8 1/8 inch	8 1/4 inch	8 1/4 inch	8 inch	6 inch

OIL WELL										
When Shot	Size of Torpedo	1st Day's Production	Tubing	Rods	Tanks	Size of Packer	Depth Set	Packed with	1st Minute Pressure	Rock Press

FORMATION	Top	Bottom	REMARKS
-----------	-----	--------	---------

FORMATION	Top	Bottom	REMARKS
Drill deeper from 1750 ft			Colar
Second Salt Sand	1750	1770	White & Hard
Lime Shells	1770	1920	do
Marion Sand	1920	1940	Dark & Soft
Pencil cave	1940	1950	Gray & Hard
Big Lime	1950	2007	White & Hard
Big Injun Sand	2007	2260	do little show of gas atv 2009 ft
Slate	2260	2280	Dark & Soft
Lime Shells	2290	2310	White & Hard
Slate	2310	2360	Dark & Soft
Lime Shells	2360	2410	White & Hard
Lime	2410	2455	do
Slate	2455	2510	Dark & Soft
Shells	2510	2548	Gray & Hard
Slate	2548	2610	Dark & Soft
Thirty Ft. Shells	2610	2665	White & Hard
Slate	2665	2731	Dark & Soft
Pink Rock	2731	2773	Pink & Soft
Fifty Ft. Sand	2773	2775	White & Hard Little gas at 2774 ft.
Slate	2775	2805	Dark & Soft
Gordon Stray Sand	2805	2823	White & Hard
Lime	2823	2873	do
Gordon Sand	2873	2919	do
Slate	2919	2929	Dark & Soft
Fourth Sand	2929	2931	White & Hard Very little show of oil at 2930
Slate	2931	2960	White & Soft
Fifth Sand	2960	2964	White & Hard, Test 60/10 water in 2" at 2961 ft. S
Slate	2964	3012	Dark & Soft. 369,000 cu. ft.
Total Depth	3012.		

Oct 24, 1931, well tubed with 4" Tubing, packed with 1-6 5/8x4" Spang anchor packer.
 Set at 2883'06" in Gordon Sand.
 Anchor-----126'02"-----6-joints of 8thd tubing
 Above packer-----2899'11"-----134- " " 10thd " 3012
 Total-- 3026'01" 140 1750
 First cage on first joint, second gagavon 6 th Joint. 1264
 Shut in test first minute 0-2nd2#-3rd5#-4th7#-5th 9#.
 Rock pressure for 28 hrs. 198 #.
 Rock pressure of casing head gas 120 lbs.

MSH-583

Examined above information and measurements and found to be correct by F.G. Burson Contractor
 Examined and approved by Superintendent of Co.
 NOTE—The above blank must be filled out carefully by the contractor, with a description of the Well, and accompany, when presented for payment of the bill for drilling.
 All formations and known sands must be given by their proper name, with steel line measurements, and under the head of "Remarks" must be recorded in what sand and at what depth Oil, Gas or Water was found, the quantity of same, the quality of the sand, and thickness of pay.
 Make no memoranda of boiler and engine if owned by contractor.

The Lfrs Light & Heat Company

Division CAMERON 248 Fourth Ave., Pittsburgh, Pa.

Record of Well No. 1975 on Lindsay Burley Farm 122 Area
 Cameron Field Liberty District Marshall County W.Va. State
 Rig Commenced October 28th, 1922. Completed November 2nd, 1922.
 Drilling Commenced November 30th, 1922. Completed December 1st, 1922.
 Cost per Foot \$2.00 Contractor M. J. Cummings Address Cameron, W.Va.
 Drillers' Names Joe Wood, Earl Taylor, Porter Richard & T.D. Newland.

BOILER			ENGINE			RIG			
H. P.	No.	Name of Maker	H. P.	No.	Name of Maker	New	Old	Height	Name of Buikler
							X	82'	& Kuhn Richardson

CONDUCTOR AND CASING USED IN DRILLING										
Conductor	12 inch	10 inch	8 1/2 inch	6 3/4 inch	6 inch	5 1/2 inch	5 1/8 inch	5 inch	4 inch	
				1753'						

CONDUCTOR AND CASING LEFT IN WELL										
Conductor	12 inch	10 inch	8 1/2 inch	6 3/4 inch	6 inch	5 1/2 inch	5 1/8 inch	5 inch	4 inch	3 inch
				1753'						

OIL WELL					GAS WELL					
When Shot	Size of Torpedo	1st Day's Production	Tubing	Rode	Tanks	Size of Packer	Depth Set	Packed with	1st Minute Pressure	Rock Pressure

FORMATION	Top	Bottom	Thickness	REMARKS
Salt Sand	1734			Depth when drilling was commenced
Total Depth		1738		

MSH-583