

Well is located on topo map 15,149 feet south of Latitude: 40° 00' 00"

Well is located on topo map 600

feet west of Longitude: 80° 35' 00"

**SURFACE HOLE LOCATION (SHL)**  
 PAD CENTER EL = 1153.60  
 UTM 17 - NAD83  
 N: 4423223.477  
 E: 535405.300  
 NAD27, WV NORTH  
 N: 533004.770  
 E: 1695661.093  
 LAT/LON DATUM-NAD83  
 LAT: 39.958411  
 LON: -80.585474

**APPROX. LANDING POINT**  
 UTM 17 - NAD83  
 N: 4423363.822  
 E: 535893.038  
 NAD27, WV NORTH  
 N: 533438.515  
 E: 1697269.253  
 LAT/LON DATUM-NAD83  
 LAT: 39.959655  
 LON: -80.579756

**BOTTOM HOLE LOCATION**  
 UTM 17 - NAD83  
 N: 4425137.106  
 E: 535141.839  
 NAD27, WV NORTH  
 N: 539299.1  
 E: 1694902.0  
 LAT/LON DATUM-NAD83  
 LAT: 39.975663  
 LON: -80.588456

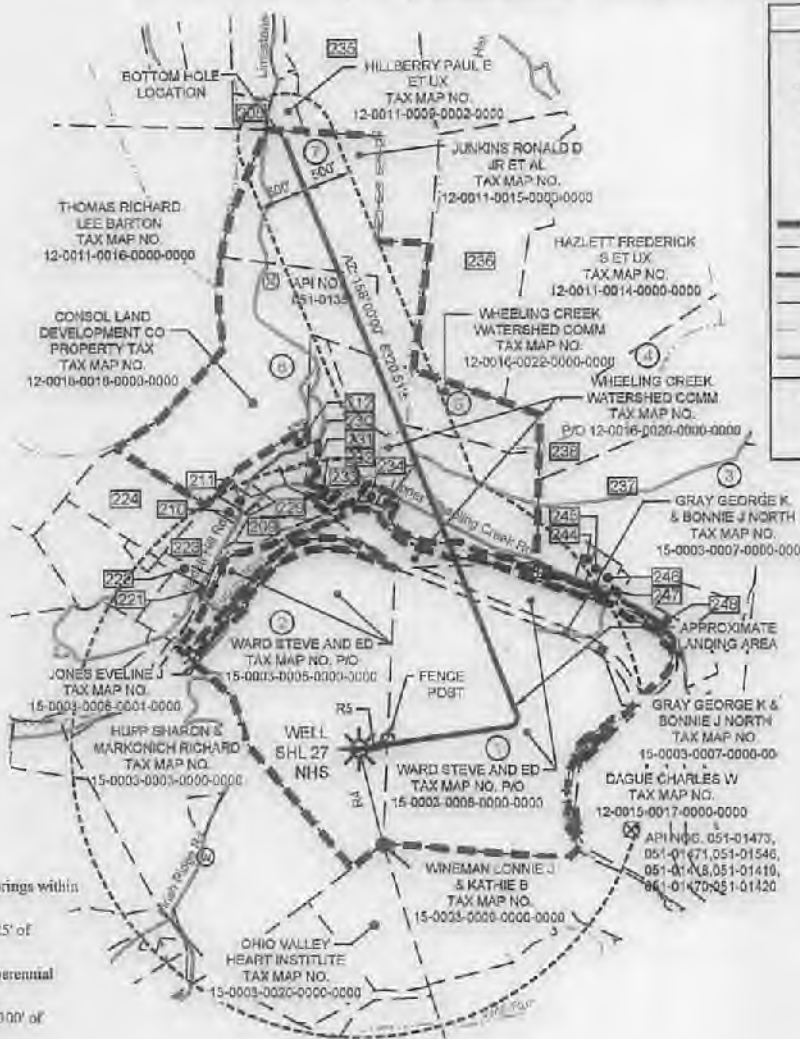

**LEGEND**

- SURFACE HOLE LOCATION
- PROPOSED WELL
- WATER SOURCE
- LEASED NUMBER BASED ON ATTACHED WM61 ALL ARE POINTS UNLESS OTHERWISE NOTED
- MINERAL TRACT BOUNDARY
- PARCEL LINES
- PROPOSED HORIZONTAL WELL
- WELL REFERENCE
- STREAM WATERWAY
- ROAD

**WELLS WITHIN 3000'**

- EXISTING GAS WELL
- RECORD GAS WELL

- NOTES:**
- There are no water wells or developed springs within 250' of proposed well.
  - There are no existing buildings within 625' of proposed well.
  - Proposed well is greater than 100' from perennial stream, wetland, pond, reservoir or lake.
  - There are no native trout streams within 300' of proposed well.
  - Proposed well is greater than 1000' from surface/groundwater intake or public water supply.
  - It is not the purpose or intention of this plat to represent surveyed locations of the surface or mineral parcels depicted hereon. The location of the boundary lines, as shown, and based on record deed descriptions, field evidence found and/or tax map position, unless otherwise noted.



**REFERENCE DETAIL**

LINE	BEARING	DISTANCE
R1	N10°59'00"W	312.09'
R2	N26°17'30"W	423.74'
R3	S72°31'50"W	312.09'
R4	N14°07'43"W	1015.67'
R5	S72°31'50"W	312.09'



FILE #: SHL 27 NHS  
 DRAWING #: SHL 27 NHS  
 SCALE: 1"=2000'  
 MINIMUM DEGREE OF ACCURACY: 1/2500  
 PROVEN SOURCE: USGS MONUMENT OF ELEVATION: U 124, 951.16'

I, THE UNDERSIGNED, HEREBY CERTIFY THAT THIS PLAT IS CORRECT TO THE BEST OF MY KNOWLEDGE AND BELIEF AND SHOWS ALL THE INFORMATION REQUIRED BY LAW AND THE REGULATIONS ISSUED AND PRESCRIBED BY THE DEPARTMENT OF ENVIRONMENTAL PROTECTION.

SIGNED: *[Signature]*  
 R.P.E.: \_\_\_\_\_ L.L.S.: P.S. NO. \_\_\_\_\_



(+) DENOTES LOCATION OF WELL ON UNITED STATES TOPOGRAPHIC MAPS WVDEP OFFICE OF OIL & GAS 601 57TH STREET CHARLESTON, WV 25304

WATERSHED: WHEELING CREEK  
 COUNTY/DISTRICT: MARSHALL / WEBSTER  
 SURFACE OWNER: STEVE WARD AND ED WARD  
 OIL & GAS ROYALTY OWNER: BOUNTY MINERALS, LLC

DATE: NOVEMBER 18, 2014 - REV. JULY 20, 2017  
 OPERATOR'S WELL #: SHL 27 NHS  
 API WELL # 47 051 01991  
 STATE COUNTY PERMIT H6A

Well Type:  Oil  Waste Disposal  Production  Deep  
 Gas  Liquid Injection  Storage  Shallow

ELEVATION: 1,153.60'  
 QUADRANGLE: MAJORSVILLE, W. VA  
 ACREAGE: 122.47

DRILL  CONVERT  DRILL DEEPER  REDRILL  FRACTURE OR STIMULATE   
 PLUG OFF OLD FORMATION  PERFORATE NEW FORMATION  PLUG AND ABANDON   
 CLEAN OUT & REPLUG  OTHER CHANGE  (SPECIFY)

TARGET FORMATION: MARGELLUS  
 ESTIMATED DEPTH: TVD: 6,203'± TMD: 13,646'±  
 WELL OPERATOR: HG ENERGY II APPALACHIA, LLC  
 DESIGNATED AGENT: DIANE G. WHITE  
 Address: 5260 DUPONT ROAD  
 City PARKERSBURG State WV Zip Code 26101

03/02/2018

Bottom hole is located on topo map 8824 feet south of Latitude: 40° 00' 00"

Bottom hole is located on topo map 4059 feet west of Longitude: 80° 35' 00"

**LEGEND**

- SURFACE HOLE LOCATION
- PROPOSED WELL
- WATER SOURCE
- LEASED NUMBER BASED ON ATTACHED WMA1 ALL ARE POINTS UNLESS OTHERWISE NOTED
- MINERAL TRACT BOUNDARY
- PARCEL LINES
- PROPOSED HORIZONTAL WELL
- WELL REFERENCE
- STREAM/WATERWAY
- ROAD
- BOTTOM HOLE LOCATION

**WELLS WITHIN 3000'**

- EXISTING GAS WELL
- RECORD GAS WELL

205	HILLBERRY PAUL E JR	TAX MAP NO. 12-0011-0000-0003-0000
210	HOWARD WELDON M ET UX	TAX MAP NO. 12-0016-0009-0000-0000
213	HOWARD WELDON M ET UX	TAX MAP NO. 12-0016-0010-0000-0000
214	WHEELING CREEK WATERSHED COMM	TAX MAP NO. 12-0016-0022-0000-0000
220	KELLER ROBERT LEE & MARY KAY	TAX MAP NO. 15-0003-0004-0002-0000
221	ZACCHEUS PROPERTIES LLC	TAX MAP NO. 12-0016-0006-0000-0000
222	TERRY JOHN G II	TAX MAP NO. 12-0016-0007-0000-0000
225	HOWARD WELDON M ET UX	TAX MAP NO. 12-0016-0006-0000-0000
224	KUPFER PHILLIP A	TAX MAP NO. 12-0016-0002-0003-0000
228	HOWARD WELDON M ET UX	TAX MAP NO. 12-0016-0012-0000-0000
230	NORTH BONNIE J & GEORGE K GRAY	TAX MAP NO. 12-0016-0013-0000-0000
231	NORTH BONNIE J & GEORGE K GRAY	TAX MAP NO. 12-0016-0014-0000-0000
232	HOWARD JACK ET UX	TAX MAP NO. 12-0016-0019-0000-0000
238	HALLER ROY & LISBETH B	TAX MAP NO. 12-0016-0016-0000-0000
234	HALLER ROY & LISBETH B	TAX MAP NO. 12-0016-0021-0000-0000
265	MCCARDLE ARNOLD EDW ET UX	TAX MAP NO. 12-0011-0000-0000-0000
268	RULONG KEVIN D & JENNIFER	TAX MAP NO. 12-0011-0014-0002-0000
267	THOMAS K CLANO	TAX MAP NO. 12-0016-0026-0000-0000
238	WHEELING CREEK WATERSHED COMM	TAX MAP NO. 12-0016-0023-0000-0000
242	JAMES L CLEMONS	TAX MAP NO. 12-0016-0029-0000-0000
245	JAMES L CLEMONS	TAX MAP NO. 12-0016-0030-0000-0000
246	JAMES L CLEMONS	TAX MAP NO. 12-0016-0031-0000-0000
247	JAMES L CLEMONS	TAX MAP NO. 12-0016-0032-0000-0000
248	RICHARD E HARTLEY SR ET UX	TAX MAP NO. 12-0016-0028-0000-0000

- NOTES:
- There are no water wells or developed springs within 250' of proposed well.
  - There are no existing buildings within 625' of proposed well.
  - Proposed well is greater than 100' from perennial stream, wetland, pond, reservoir or lake.
  - There are no native trout streams within 300' of proposed well.
  - Proposed well is greater than 1000' from surface/groundwater intake or public water supply.
  - It is not the purpose or intention of this plat to represent surveyed locations of the surface or mineral parcels depicted herein. The location of the boundary lines, as shown, and based on record deed descriptions, field evidence found and/or tax map position, unless otherwise noted.

Wetland, Contour, Part 31, Suite 101  
2000 Georgetown Blvd  
Demersby, VA 24842

Tel: 724-444-1109  
F: 724-444-1104  
www.pve.com



Civil Engineering | Land Development | Wetlands Design  
Land Planning | Landscape Architecture | Environmental



REFERENCE DETAIL

LINE	BEARING	DISTANCE
R1	N10°59'08"W	312.99'
R2	N20°17'30"W	423.74'
R3	S72°31'50"W	312.00'
R4	N14°07'43"W	1016.87'
R5	S72°31'50"W	312.00'

FILE #: SHL 27 NHS

DRAWING #: SHL 27 NHS

SCALE: 1"=2000'

MINIMUM DEGREE OF ACCURACY: 1/2500

PROVEN SOURCE USGS MONUMENT OF ELEVATION: U 124: 951.16'

I, THE UNDERSIGNED, HEREBY CERTIFY THAT THIS PLAT IS CORRECT TO THE BEST OF MY KNOWLEDGE AND BELIEF AND SHOWS ALL THE INFORMATION REQUIRED BY LAW AND THE REGULATIONS ISSUED AND PRESCRIBED BY THE DEPARTMENT OF ENVIRONMENTAL PROTECTION.

SIGNED: [Signature]  
R.P.E.: \_\_\_\_\_ L.L.S.: P.S. NO. \_\_\_\_\_



(+) DENOTES LOCATION OF WELL ON UNITED STATES TOPOGRAPHIC MAPS WVDEP OFFICE OF OIL & GAS 601 57TH STREET CHARLESTON, WV 25304



DATE: NOVEMBER 18, 2014 - REV. JULY 20, 2017

OPERATOR'S WELL #: SHL 27 NHS

API WELL # 47 051 01991  
STATE COUNTY PERMIT  
HL6A

Well Type:  Oil  Waste Disposal  Production  Deep  
 Gas  Liquid Injection  Storage  Shallow

SHEET: 2 OF 2

WATERSHED: WHEELING CREEK ELEVATION: 1,153.60'  
COUNTY/DISTRICT: MARSHALL / WEBSTER QUADRANGLE: MAJORSVILLE, W VA  
SURFACE OWNER: STEVE WARD AND ED WARD ACREAGE: 122.47  
OIL & GAS ROYALTY OWNER: BOUNTY MINERALS, LLC ACREAGE: 122.47

03/02/2018

DRILL  CONVERT  DRILL DEEPER  REDRILL  FRACTURE OR STIMULATE   
PLUG OFF OLD FORMATION  PERFORATE NEW FORMATION  PLUG AND ABANDON   
CLEAN OUT & REPLUG  OTHER CHANGE  (SPECIFY)

TARGET FORMATION: MARCELLUS ESTIMATED DEPTH: TVD: 6,203' ± TMD: 13,546' ±  
WELL OPERATOR: HG ENERGY II APPALACHIA, LLC DESIGNATED AGENT: DIANE C. WHITE  
Address: 5260 DUPONT ROAD Address: 5260 DUPONT ROAD  
City PARKERSBURG State WV Zip Code 26101 City PARKERSBURG State WV Zip Code 26101